

SWC BLUE DIAMOND RD. & BUFFALO DR. • LAS VEGAS, NV 89178



MOUNTAIN'S EDGE MARKETPLACE

VACANT PADS AVAILABLE



GROUND LEASE OR BTS

Mountain's Edge Marketplace is in the final phase of construction with prominent retail pads still available for lease. The 25-acre, Albertson's anchored shopping center is located at the signalized intersection of Blue Diamond Road and Buffalo Drive, at the entrance to the Mountain's Edge master-planned community. Mountain's Edge Master Planned community is one of the top-selling master-planned communities in Las Vegas.

The shopping center features Ross Dress For Less and Planet Fitness as junior anchor tenants. Mountain's Edge Marketplace also includes key tenants such as Chase Bank, Aveda Salon, Procure Medical Center Edge Dental Group, Burger King, Starbucks, UPS, Tide Cleaners, PT's Gold and many other tenants.

HIGHLIGHTS

- Two Hard Corner Pads up to 4,000 SF and 6,000 SF Available for Ground Lease; perfect for Drive-Thru Uses.
- 4,513 SF Planned Restaurant Space available for BTS.
- Car Wash Site available with Buffalo frontage.
- Join Albertson's, Ross Dress for Less, Planet Fitness and other great tenants.
- Premier southwest grocery anchored retail shopping center located at the signalized intersection of Blue Diamond Rd. and Buffalo Dr.
- Blue Diamond Rd. benefits from high traffic counts of +/- 46,000 CPD.



TOM FEHRMAN - B.0026722.LLC
702.239.8066
tom@remingtonnevada.com



ANDREW FEHRMAN - S.171098
702.835.2995
af@sagebrushcre.com



MOUNTAIN'S EDGE MARKETPLACE • SWC Blue Diamond Rd. & Buffalo Dr. • Las Vegas, NV 89178

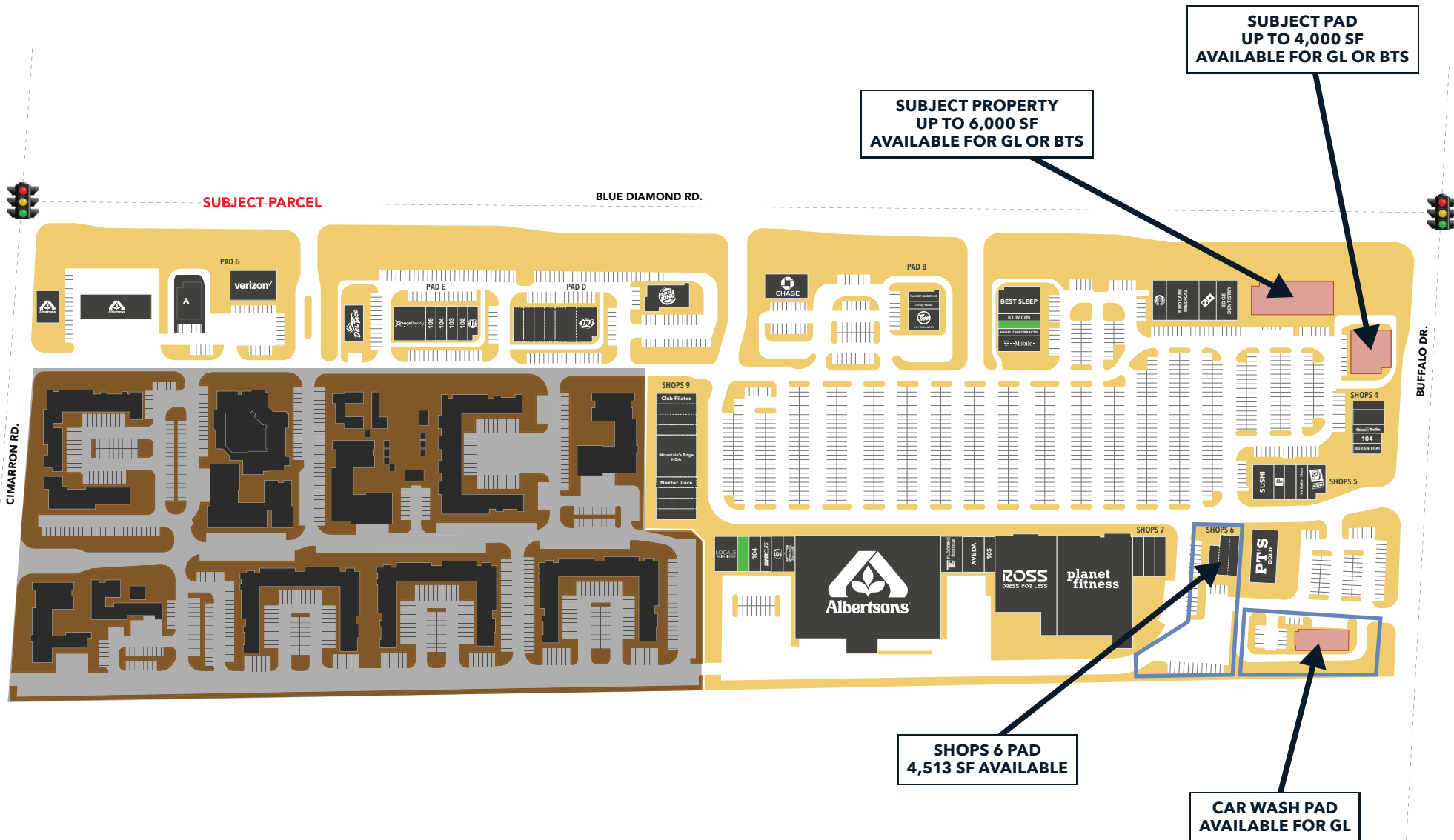

The information contained within these plans is intended to depict design and construction detailing. Images used are for illustrative purposes only and are intended to convey the concept and vision for the development. Remington Nevada reserves the right to modify plans as needed. Information and drawing are submitted subject to error and omissions, change of size, price and all information should be carefully verified. *All measurements quoted herein are approximate and no warranty or representation, expressed or implied, is made to the information contained herein.

MOUNTAIN'S EDGE MARKETPLACE • SWC Blue Diamond Rd. & Buffalo Dr. • Las Vegas, NV 89178



TOM FEHRMAN - B.0026722.LLC
 702.239.8066
 tom@remingtonnevada.com



ANDREW FEHRMAN - S.171098
 702.835.2995
 af@sagebrushcre.com



DEMOGRAPHICS

	1 Mile	3 Mile	5 Mile
2022 Population	14,436	126,463	224,615
2027 Population	16,898	148,079	261,300
Employees	11,268	97,972	175,295
Total Businesses	131	1,476	4,692
Avg. HH Income	\$108,856	\$107,474	\$102,390
Med. HH Income	\$87,486	\$90,148	\$84,645
Households	5,264	44,502	80,768
Avg. Housing Value	\$374,281	\$371,111	\$365,052

Mountain's Edge Marketplace, the 25-acre, Albertson's anchored shopping center is located at the signalized intersection of Blue Diamond Road and Buffalo Drive, at the entrance to the Mountain's Edge master-planned community. Mountain's Edge Master Planned community is one of the top-selling master-planned communities in Las Vegas.

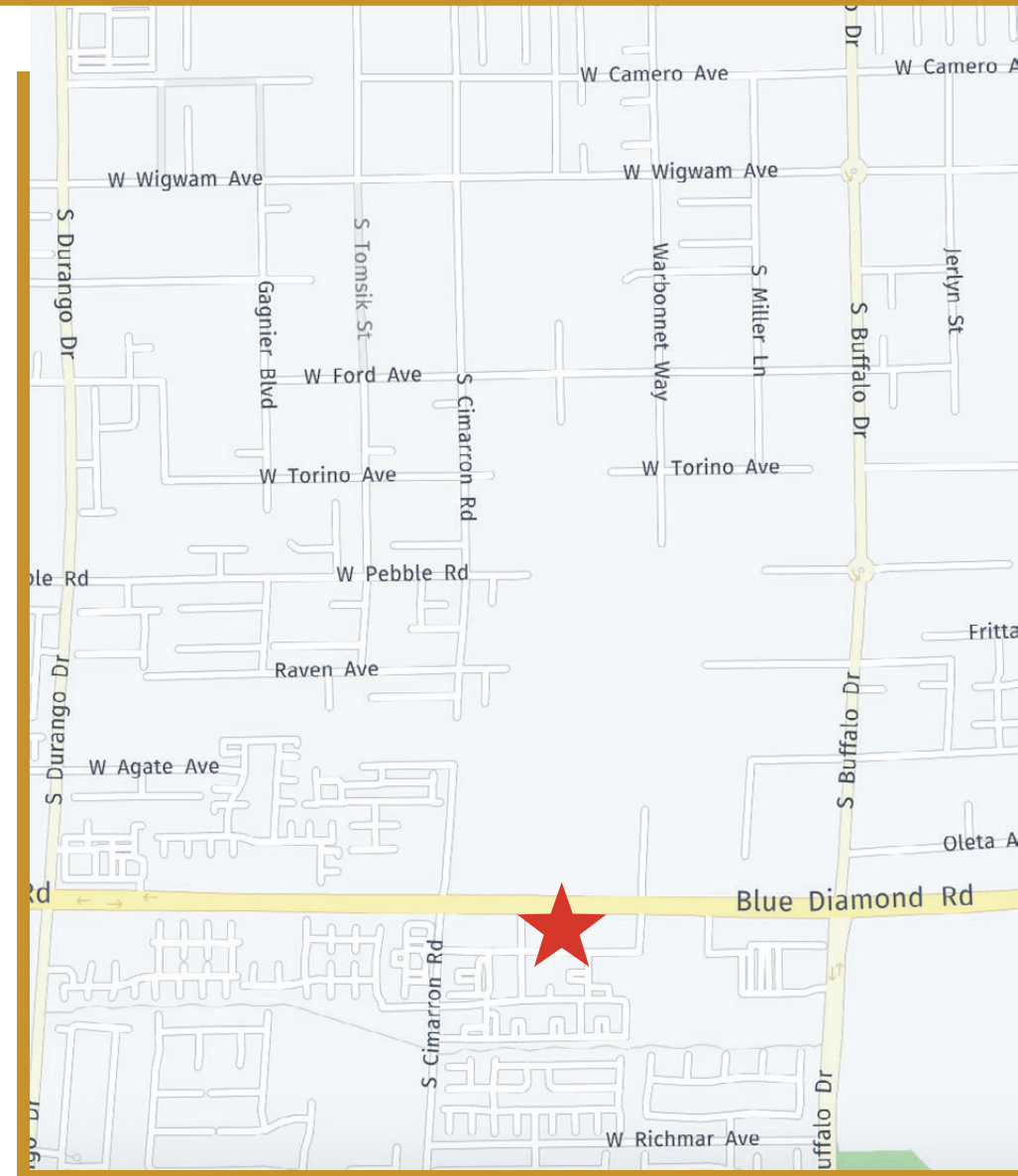

TOM FEHRMAN - B.0026722.LLC
 702.239.8066
 tom@remingtonnevada.com



ANDREW FEHRMAN - S.171098
 702.835.2995
 af@sagebrushcre.com

