

299 E. 17th Street



COSTA MESA, CA

NATALIE WARD | nward@riretail.com | 949.945.6281 LIC# 02153954
MARK MOSER | markmoser@riretail.com | 949.299.5655 LIC# 02223289



299 E. 17TH STREET

Property Highlights

299 E. 17th Street

- ❑ Rare freestanding pad facing 17th Street
- ❑ Hard corner of 17th St and Santa Ana Ave
- ❑ Four exclusive parking stalls
- ❑ Affluent trade area with median incomes within a 1-mile radius of \$144,060
- ❑ Retail destination with 17th Street being home to Ospi, Rye Goods, CAVA, Pitfire Pizza, Mendocino Farms, Nick's, Kit Coffee



Trade Area Aerial



BEAR FLAG FISH CO.



PASEO | 17
OSPI
milligram
Rye Goods



burgerlounge

THE SITE

LEASED



Site Plan

- ❑ Rare freestanding pad
- ❑ Single Tenant
- ❑ Four exclusive parking stalls
- ❑ Excellent street signage facing 17th St.

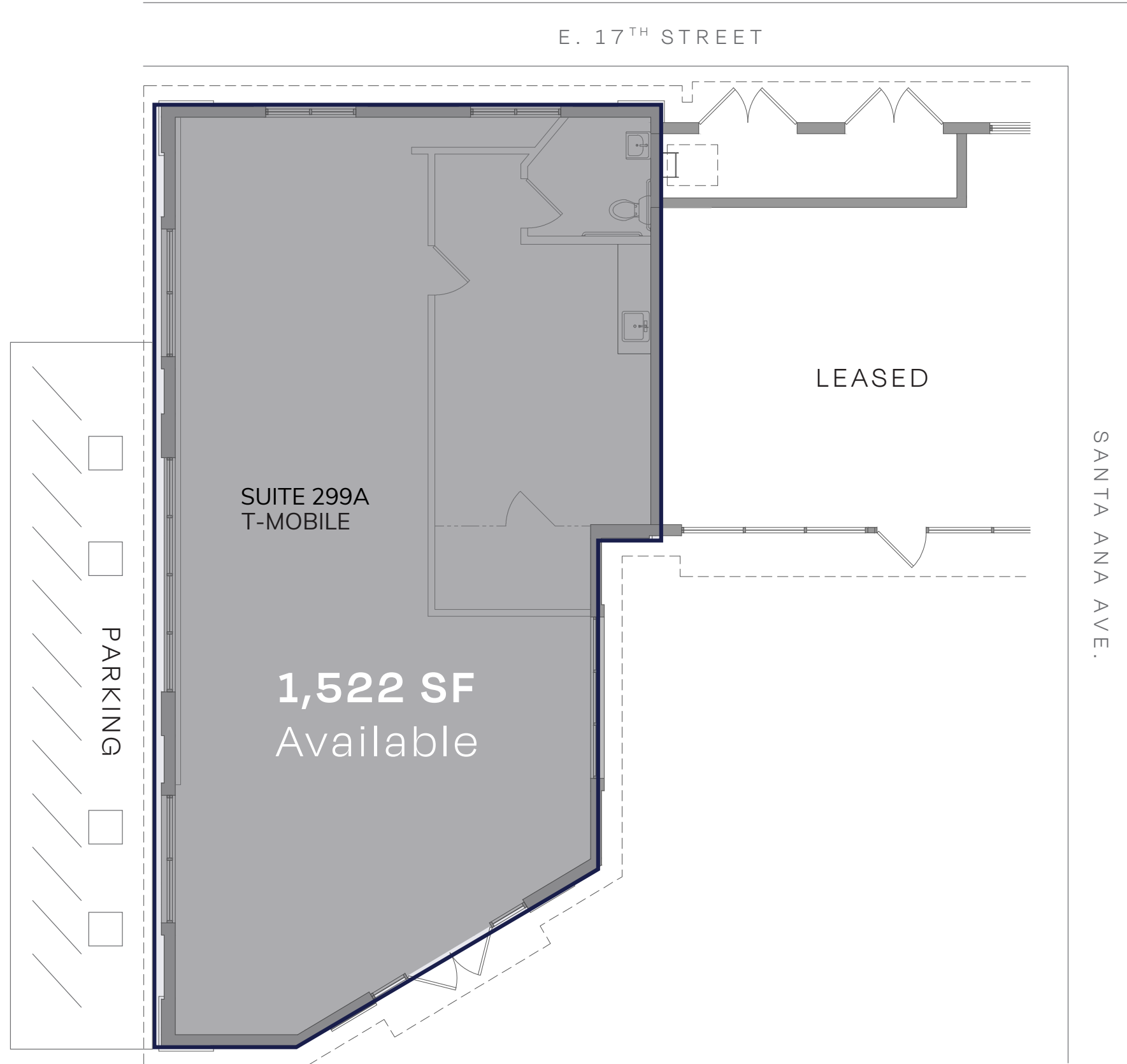

299 E. 17TH STREET

Property Photos

COSTA MESA, CA



299 E. 17TH STREET

The Neighborhood



OSPI COSTA MESA



RYE GOODS



NICK'S



MILLIGRAM



GRIT CYCLE



ART OF JIU JITSU



PITFIRE PIZZA

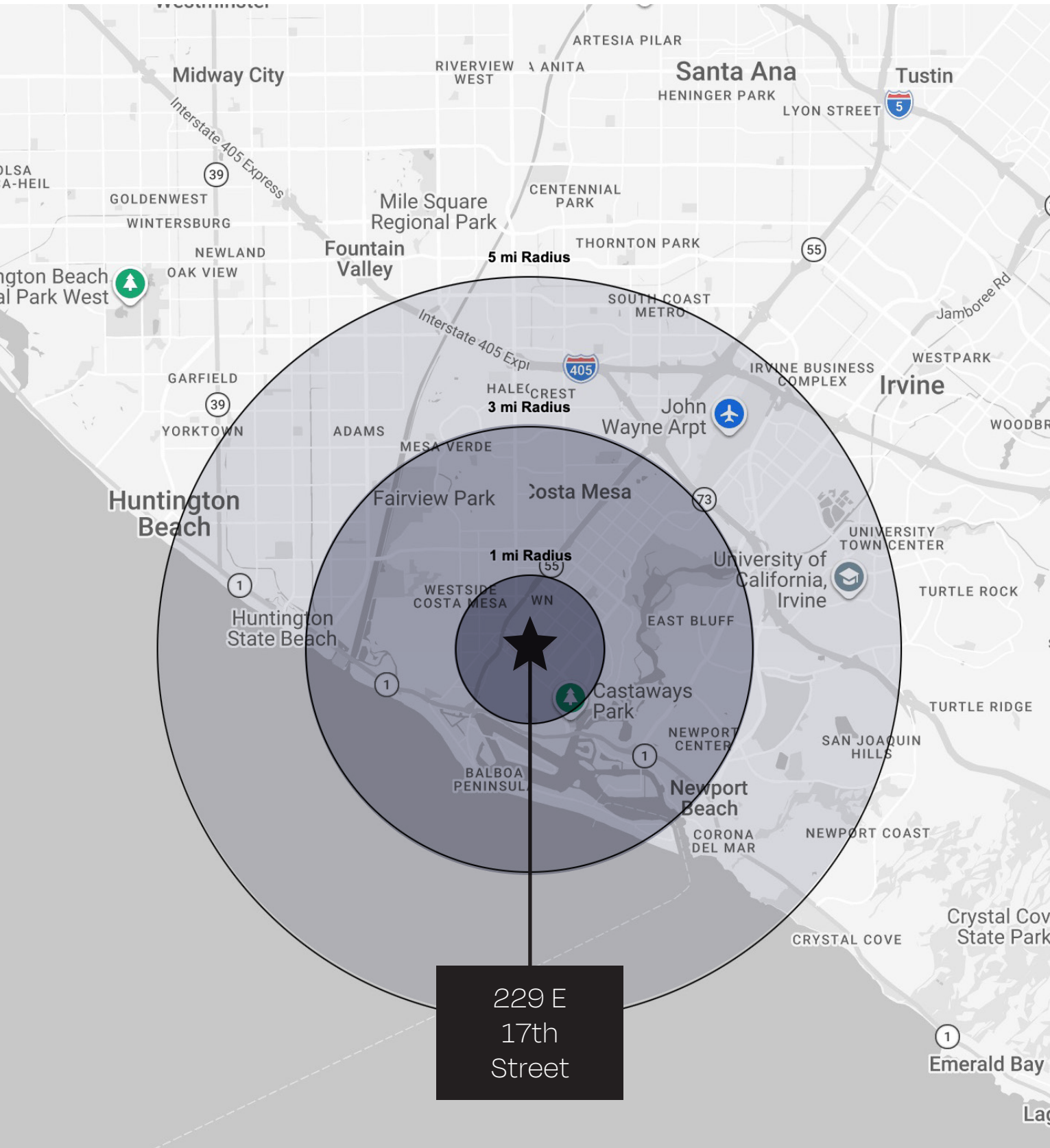

Demographics

COSTA MESA | CALIFORNIA

Population	1 Mile	3 Mile	5 Mile
Estimated Population	26,870	140,935	299,356
Forecasted Population (2030)	25,812	136,509	290,263

Daytime Demos	1 Mile	3 Mile	5 Mile
Total Daytime Population	22,485	119,140	253,708

Median Household Income	1 Mile	3 Mile	5 Mile
Estimated Median Household Income	\$144,060	\$139,557	\$139,814
Projected Median Household Income (2030)	\$144,538	\$139,782	\$140,046

Average Household Income	1 Mile	3 Mile	5 Mile
Estimate Average Household Income	\$200,365	\$196,488	\$188,179
Projected Average Household Income (2030)	\$200,965	\$196,515	\$188,175

The information above has been obtained from sources believed to be reliable. While we do not doubt its accuracy, we have not verified it and make no guarantee, warranty or representation about it. It is your responsibility to independently confirm its accuracy and completeness. Any projections, opinions, assumptions or estimates used are for example only and do not represent the current or future performance of the property



299 E 17th Street

COSTA MESA, CA

RI RETAIL INSITE

405 S Hwy 101, Ste 150, Solana Beach, CA 92075
lic. 01206760 t. 858 523 2090 w. riretail.com

NATALIE WARD

nward@riretail.com

949.945.6281 LIC# 02153954

MARK MOSER

markmoser@riretail.com

949.299.5655 LIC# 02223289

