

1156 Fulton Street

Bedford-Stuyvesant

Retail for Lease
1,100 SF



Interior Rendering

SUMMARY

Situated on bustling Fulton Street between Franklin Ave and Bedford Ave is this new and thoughtfully renovated retail space with yard and basement storage.

Just around the corner from the recently rezoned Atlantic Avenue Mixed-Use Plan, this prime location is easily accessible and is just a short walk to Prospect Park and adjacent neighborhoods (Clinton Hill, Crown Heights, and Prospect Heights).

Features:

- Wide Frontage
- Bathroom
- HVAC
- Rear Yard
- Basement Storage

LEASABLE AREA

Ground Level: 1,100 SF
Lower-Level Storage: 1,200 SF
Rear Yard: 770 SF

CEILING HEIGHTS

10 feet

CROSS STREETS

Franklin Ave & Bedford Ave

PRICING & TERMS

Available upon request

AVAILABILITY

Immediate

TRANSPORTATION



NEARBY TENANTS



For more information, contact exclusive agents:

Darlene Lee
Associate
dlee@terraarg.com

Nelson Kim
Associate
nkim@terraarg.com

Kyle Williams
Director
kwilliams@terraarg.com

Peter Schubert
Managing Director
pschubert@terraarg.com

(718) 768-7788
terraarg.com

1156 Fulton Street

Bedford-Stuyvesant

Retail for Lease
1,100 SF



Storefront



Interior Facing Front - Rendering

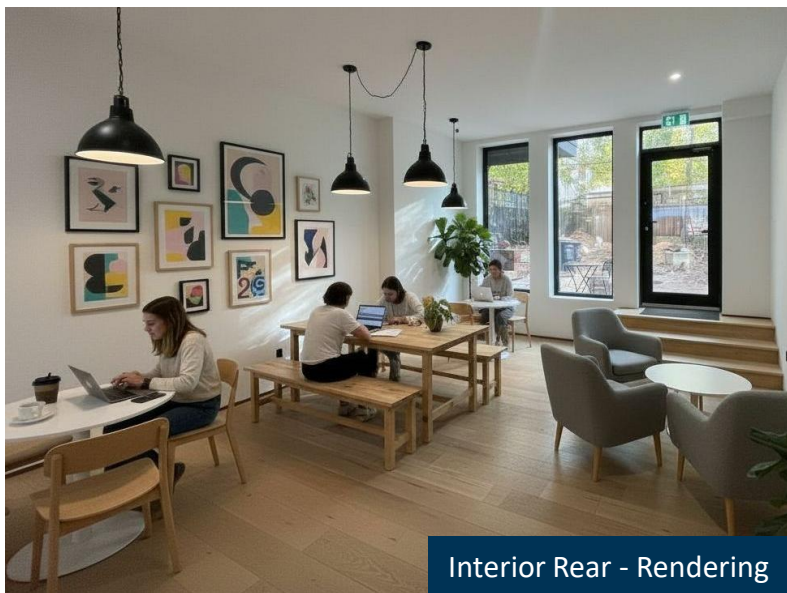

Interior Rear - Rendering



Interior Facing Rear

Select images have been *virtually staged or digitally enhanced* for marketing purposes and may not reflect the property's current condition. Information provided is from sources deemed reliable but not guaranteed. All details, including zoning, square footage, and permitted uses, should be independently verified. Prospective buyers and tenants are encouraged to consult their own legal and financial advisors before making decisions.

For more information, contact exclusive agents:

Darlene Lee
Associate
dlee@terraccrg.com

Nelson Kim
Associate
nkim@terraccrg.com

Kyle Williams
Director
kwilliams@terraccrg.com

Peter Schubert
Managing Director
pschubert@terraccrg.com

(718) 768-7788
terraccrg.com



1156 Fulton Street

Bedford-Stuyvesant

Retail for Lease
1,100 SF

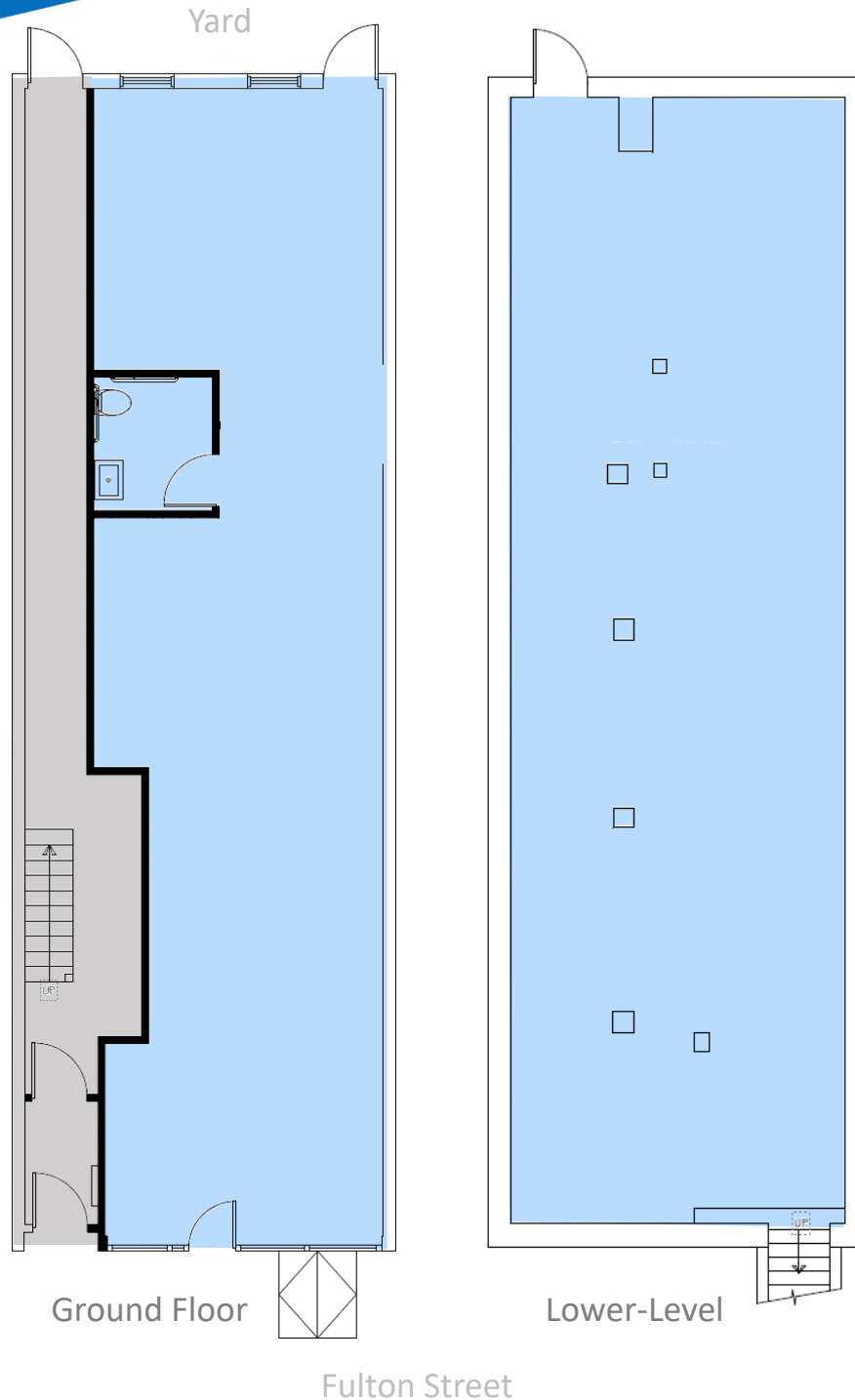

The information provided herein has either been given to us by the owner of the property or was obtained from sources we deem reliable. We do not guarantee the accuracy of any information. All zoning, existing square feet of buildings, available buildable square feet, permitted uses and any other information provided herein must be independently verified. The value of any real estate investment is dependent upon a variety of factors including income, vacancy rates, expense estimates, tax brackets and general market assumptions, all of which should be evaluated by your tax advisor and/or legal counsel. Prospective buyer and tenants should carefully verify each item of information herein.

For more information, contact exclusive agents:

Darlene Lee
Associate
dlee@terraccrg.com

Nelson Kim
Associate
nkim@terraccrg.com

Kyle Williams
Director
kwilliams@terraccrg.com

Peter Schubert
Managing Director
pschubert@terraccrg.com

(718) 768-7788
terraccrg.com



1156 Fulton Street

Bedford-Stuyvesant

Retail for Lease
1,100 SF

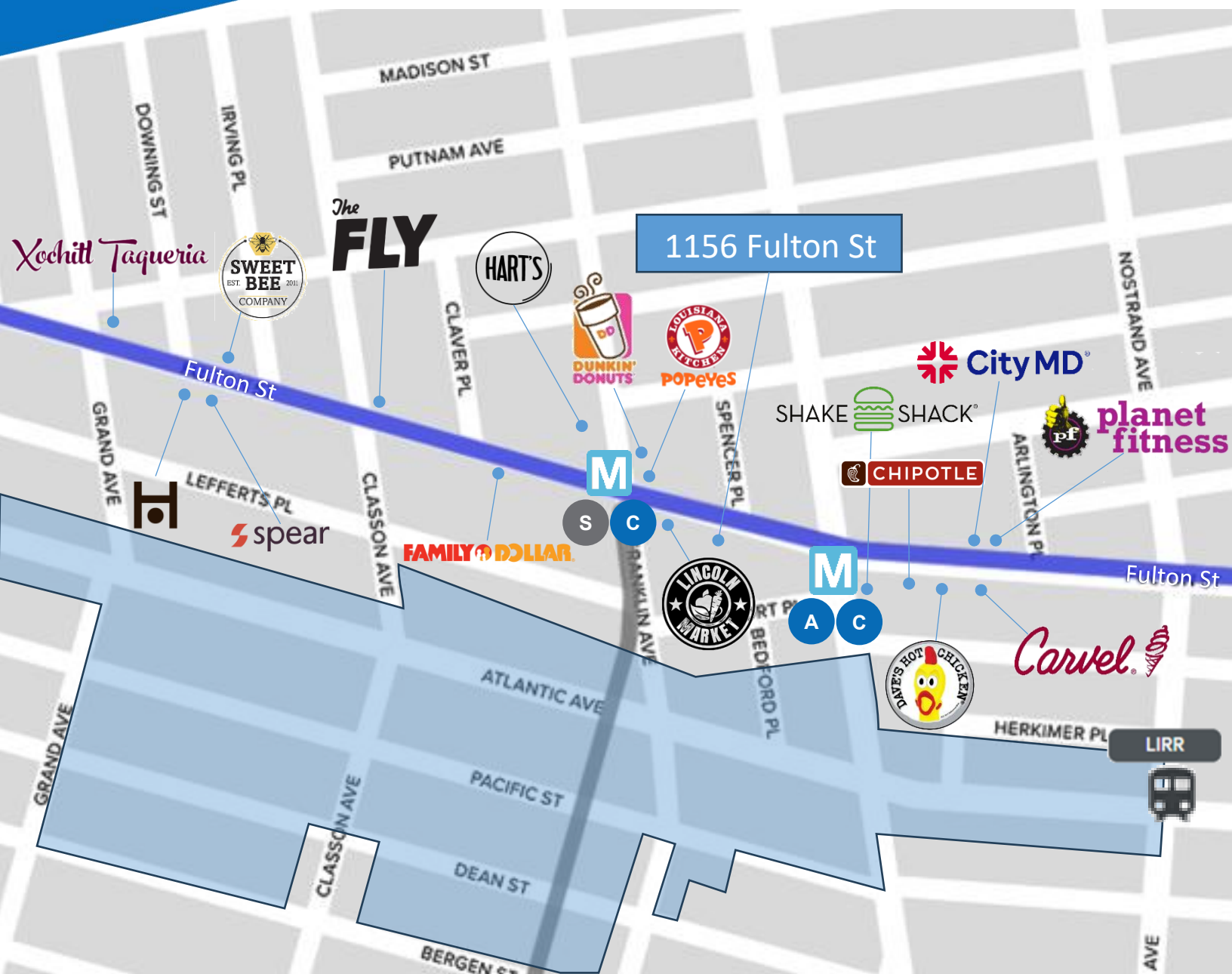

Atlantic Avenue Mixed-Use Plan (AAMUP) Rezoning

For more information, contact exclusive agents:

Darlene Lee
Associate
dlee@terraccrg.com

Nelson Kim
Associate
nkim@terraccrg.com

Kyle Williams
Director
kwilliams@terraccrg.com

Peter Schubert
Managing Director
pschubert@terraccrg.com

(718) 768-7788
terraccrg.com

