

# 425

## PHILLIPS BOULEVARD

Ewing | New Jersey

**FOR LEASE** 72,000 SF  
FLEX / INDUSTRIAL BUILDING



## SITE PLAN

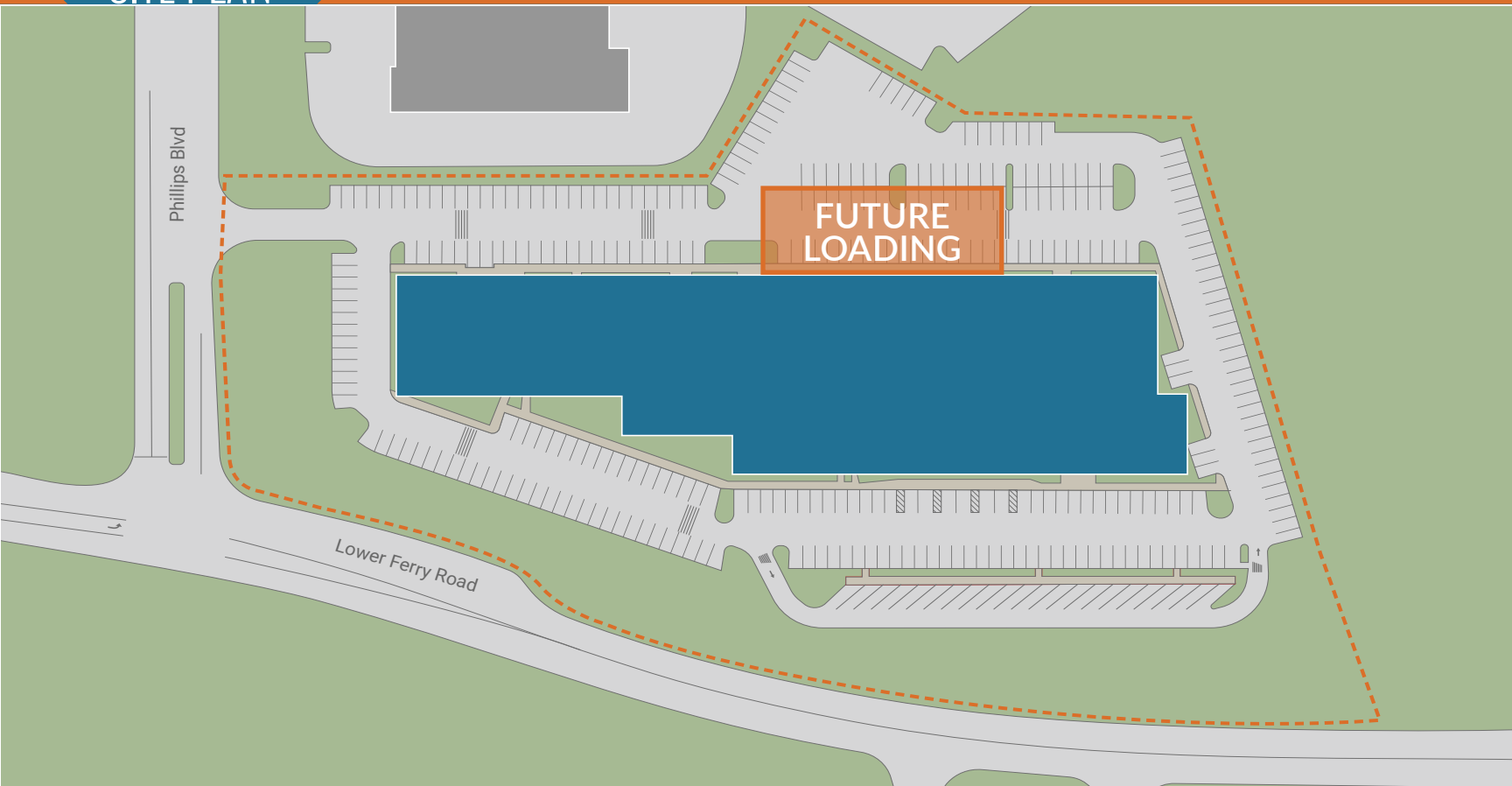

### PROPERTY SPECS



**72,000 SF**  
Available Space



**225.02/52**  
Block/Lot



**6.58 Acres**  
Lot Size



**1994**  
Built



**2017-2021**  
Renovated



**16'**  
Clear to the Deck



**Fully Sprinklered**



**Fully Air Conditioned**  
HVAC



**Full Building**  
Generator



**330 spaces**  
Car Parking



**IP-I Industrial**  
Zoning



# FLOOR PLAN

## 1ST FLOOR

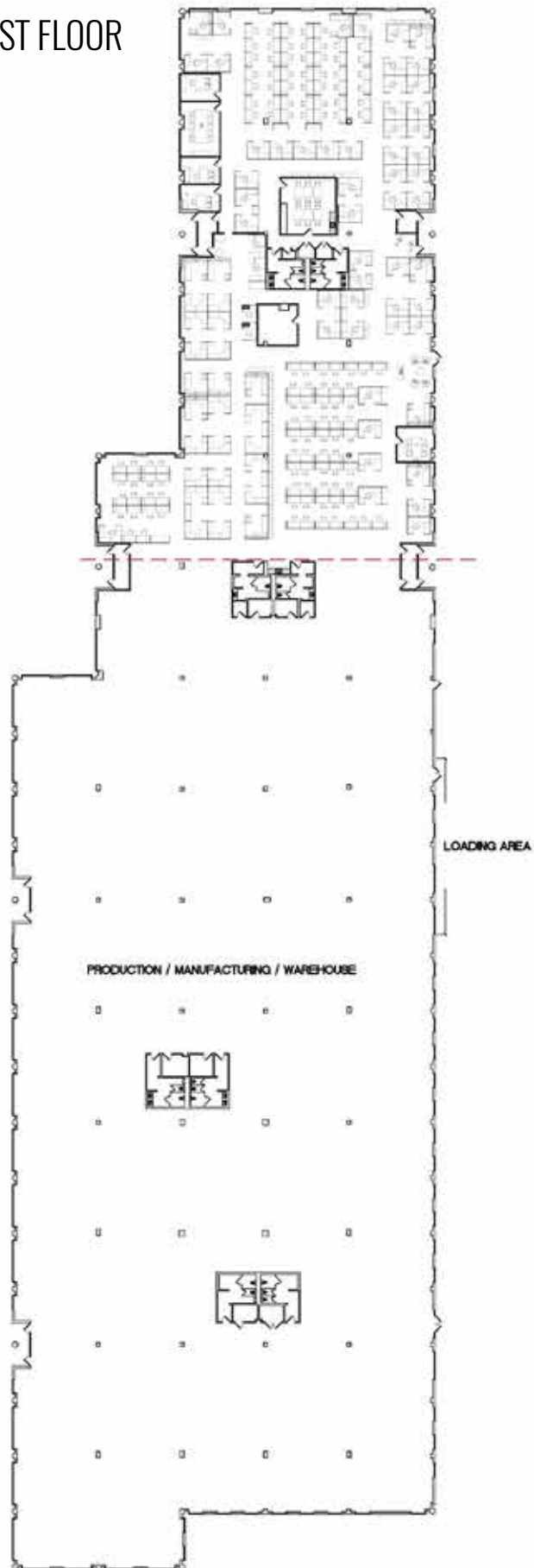

# FLOOR PLAN

## 2ND FLOOR

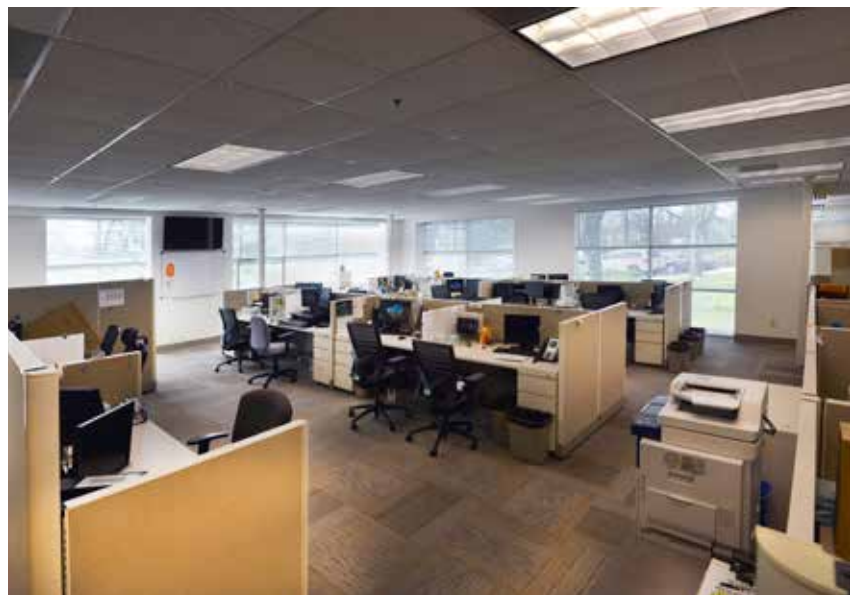
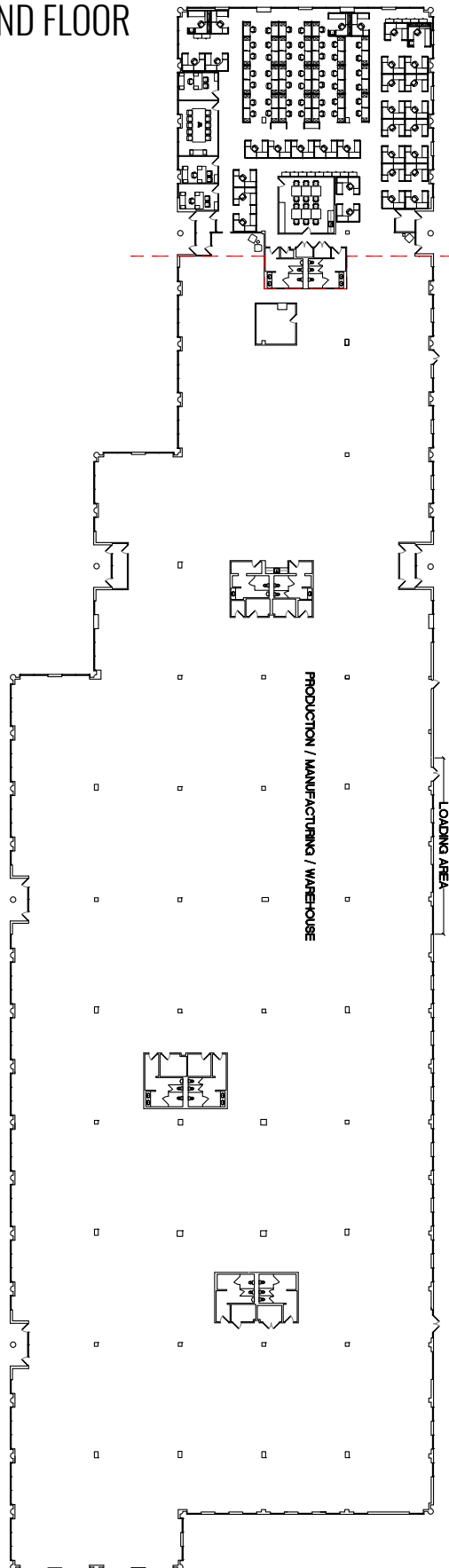



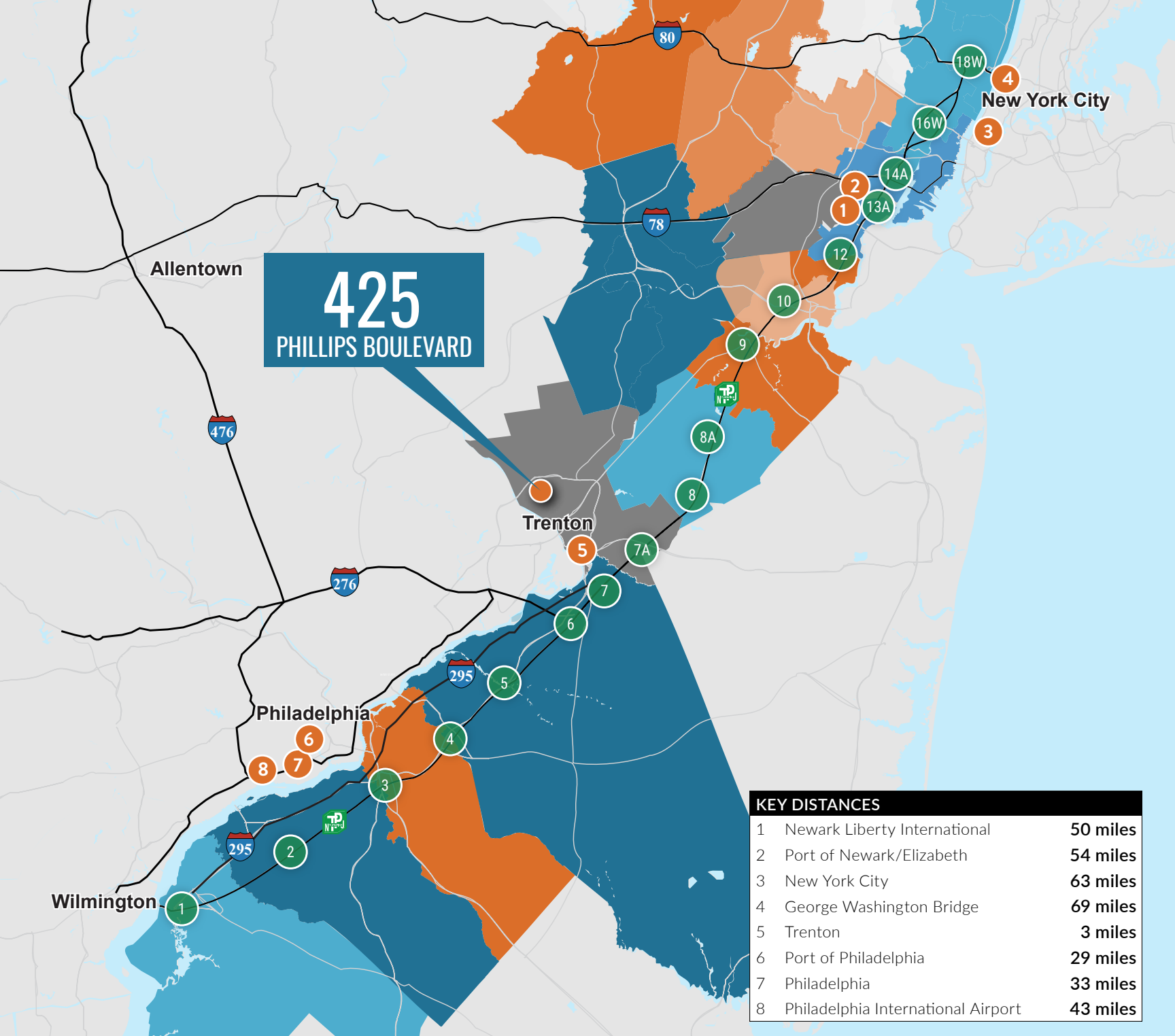



## KEY ACCESS POINTS

- ACCESS TO INTERSTATE 78 1.5 MILES
- ← ACCESS FROM NJ TURNPIKE 1.5 MILES

Trenton-Mercer  
Airport

425  
PHILLIPS BOULEVARD

## KEY DISTANCES

1	Route 1	6.5 miles
2	PA Turnpike	13.0 miles
3	NJ Turnpike	17.5 miles

## EXCLUSIVE MARKETING AGENT

### STEVE TOLKACH

Executive Managing Director  
t 732-867-9550  
stephen.tolkach@nmrk.com

### ROBERT LODERSTEDT

Managing Director  
t 973-998-1093  
robert.loderstedt@nmrk.com

### KYLE EATON, SIOR

Senior Managing Director  
t 908-902-8354  
kyle.eaton@nmrk.com

Newmark | Licensed Real Estate Broker | One Tower Center Boulevard, Suite 1201, East Brunswick, NJ 08816 | t 732-867-9001

The information contained herein has been obtained from sources deemed reliable but has not been verified and no guarantee, warranty or representation, either express or implied, is made with respect to such information.  
Terms of sale or lease and availability are subject to change or withdrawal without notice.

**NEWMARK**

[www.nmrk.com](http://www.nmrk.com)