

# FOR LEASE

7676 N. GLEN HARBOR DR. | GLENDALE | AZ 85307



**76,356 SF AVAILABLE**

For More Information, Contact:

JERRY HILLERY  
VICE PRESIDENT  
P: 602.575.2313 | C: 602.524.0487  
jerry.hillery@daumcommercial.com

RICH SICA  
EXECUTIVE VICE PRESIDENT  
C: 602.430.2974  
rich.sica@daumcommercial.com



Although all information is furnished regarding for sale, rental or financing is from sources deemed reliable, such information has not been verified and no express representation is made nor is any to be implied as to the accuracy thereof, and it is submitted subject to errors, omissions, changes of price, rental or other conditions, prior sale, lease or financing, or withdrawal without notice. D/AQ Corp. # 01129558

# 76,356 SF

MANUFACTURING/INDUSTRIAL BUILDING

7676 N. GLEN HARBOR DR.  
GLENDALE | AZ | 85307



## PROPERTY HIGHLIGHTS

- 76,356 SF: warehouse 71,756 SF  
office 4,600 SF
- 24' clear
- Built in 1998
- Masonry construction
- Potential for paved yard
- Landlord replaced 14 evap coolers and down drafts
- Newly painted building
- Lease Rate \$0.95 NNN  
(nets are \$0.16 PSF)

Although all information is furnished regarding for sale, rental or financing is from sources deemed reliable, such information has not been verified and no express representation is made nor is any to be implied as to the accuracy thereof, and it is submitted subject to errors, omissions, changes of price, rental or other conditions, prior sale, lease or financing, or withdrawal without notice. D/AQ Corp. # 01129558

# 76,356 SF

## MANUFACTURING/INDUSTRIAL BUILDING

7676 N. GLEN HARBOR DR.  
GLENDALE | AZ | 85307

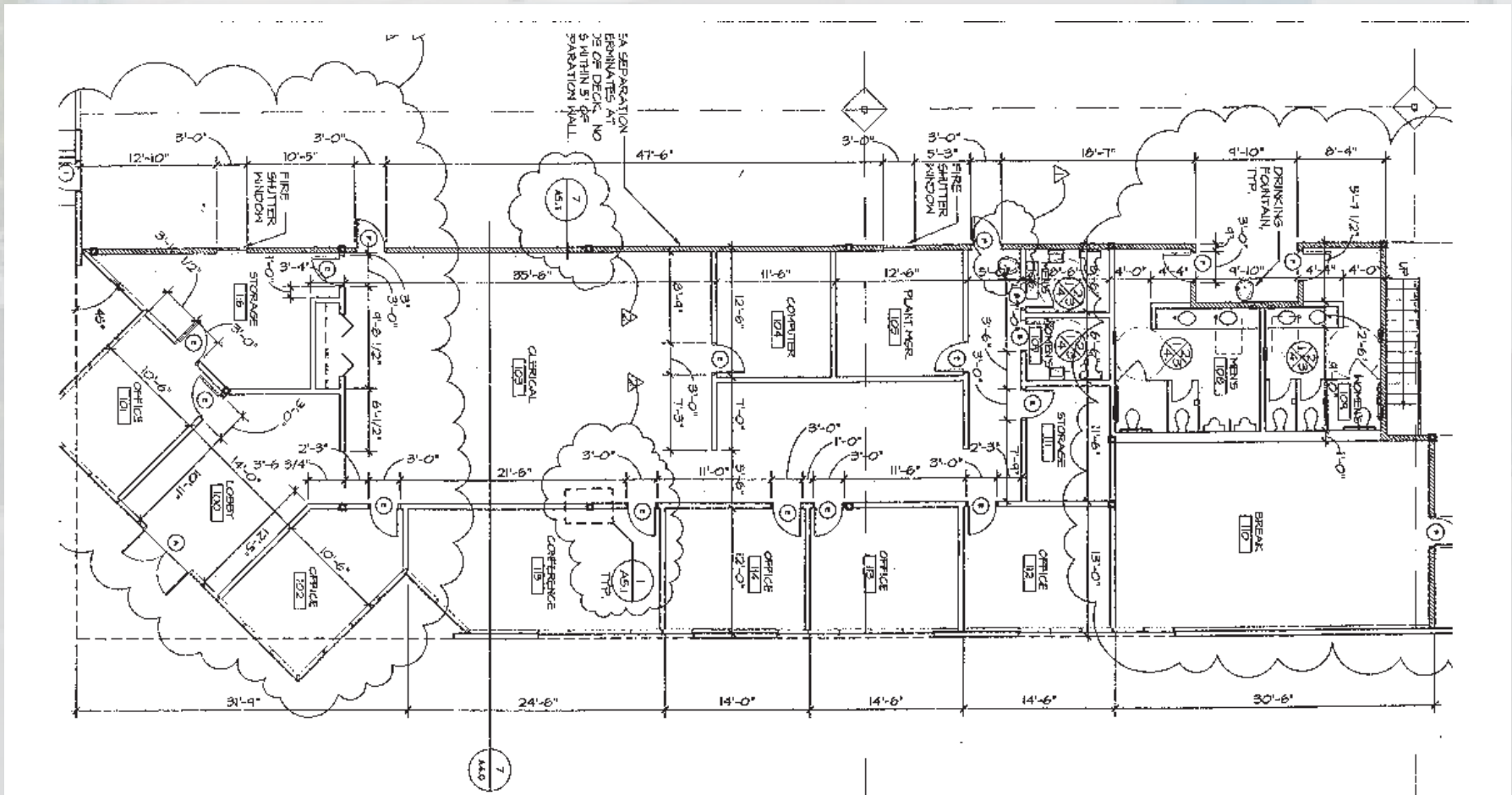

Although all information is furnished regarding for sale, rental or financing is from sources deemed reliable, such information has not been verified and no express representation is made nor is any to be implied as to the accuracy thereof, and it is submitted subject to errors, omissions, changes of price, rental or other conditions, prior sale, lease or financing, or withdrawal without notice. D/AQ Corp. # 01129558

# 76,356 SF

MANUFACTURING/INDUSTRIAL BUILDING

7676 N. GLEN HARBOR DR.  
GLENDALE | AZ | 85307



Although all information is furnished regarding for sale, rental or financing is from sources deemed reliable, such information has not been verified and no express representation is made nor is any to be implied as to the accuracy thereof, and it is submitted subject to errors, omissions, changes of price, rental or other conditions, prior sale, lease or financing, or withdrawal without notice. D/AQ Corp. # 01129558

**DAUM**  
COMMERCIAL REAL ESTATE SERVICES

# 76,356 SF

## MANUFACTURING/INDUSTRIAL BUILDING

# 7676 N. GLEN HARBOR DR. GLENDALE | AZ | 85307

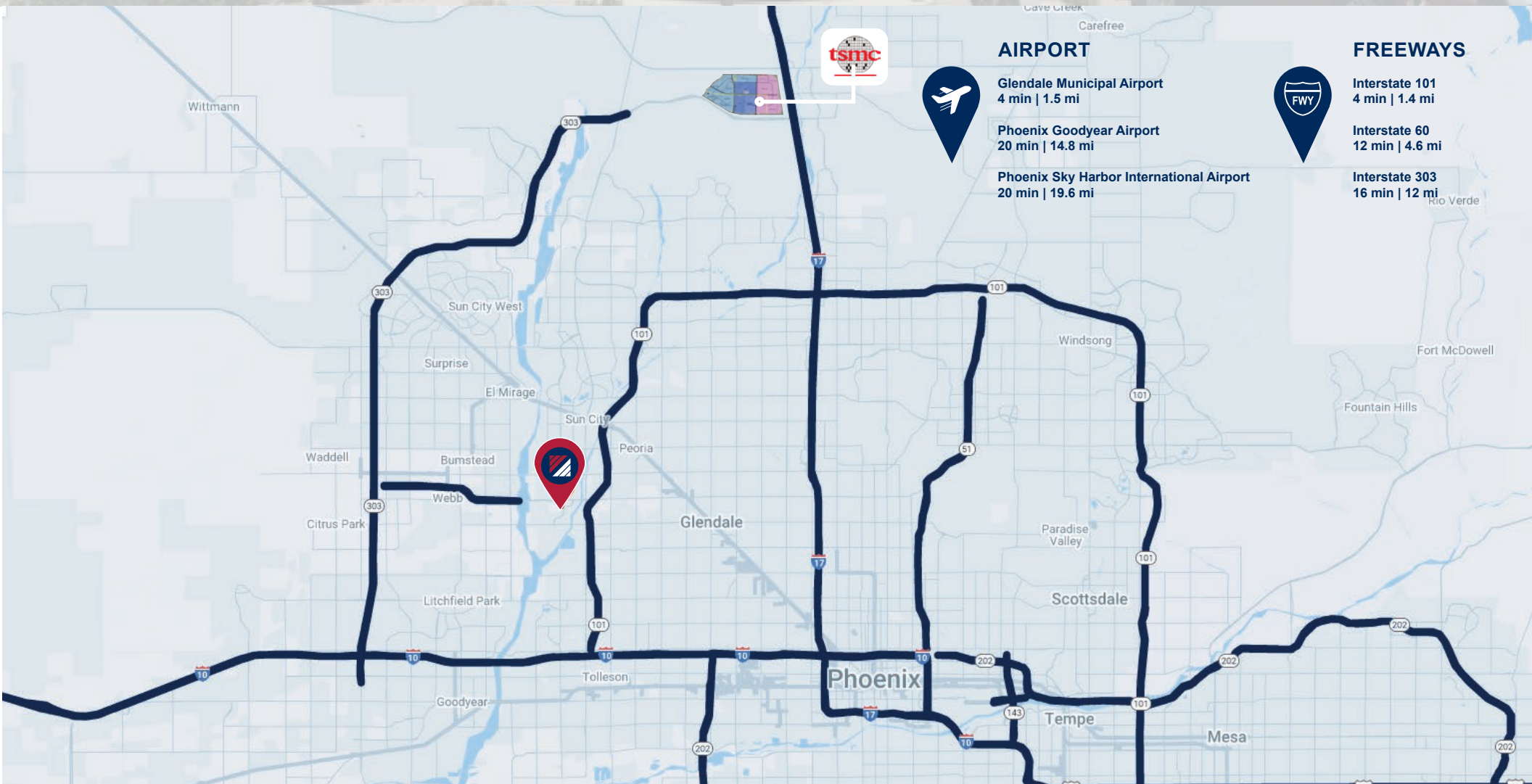

Although all information is furnished regarding for sale, rental or financing is from sources deemed reliable, such information has not been verified and no express representation is made nor is any to be implied as to the accuracy thereof, and it is submitted subject to errors, omissions, changes of price, rental or other conditions, prior sale, lease or financing, or withdrawal without notice. D/AQ Corp. # 01129558

