 **JLL** SEE A BRIGHTER WAY

For sublease

1000 River Road, Conshohocken
5,000 - 127,300 SF availability

Property specifications

- 5,000 - 127,300 SF sublease availability
- Term through October 31, 2029
- Ample parking surrounding the building
- Neighbors SEPTA Regional Rail Station - Miquon Station
- Direct access to Schuylkill River Trail - onsite showers
- Access to private balcony overlooking Schuylkill River
- Recent upgrades to reception area and 2nd floor spaces
- High ceilings, loading dock and freight elevator

1000 River Road Conshohocken

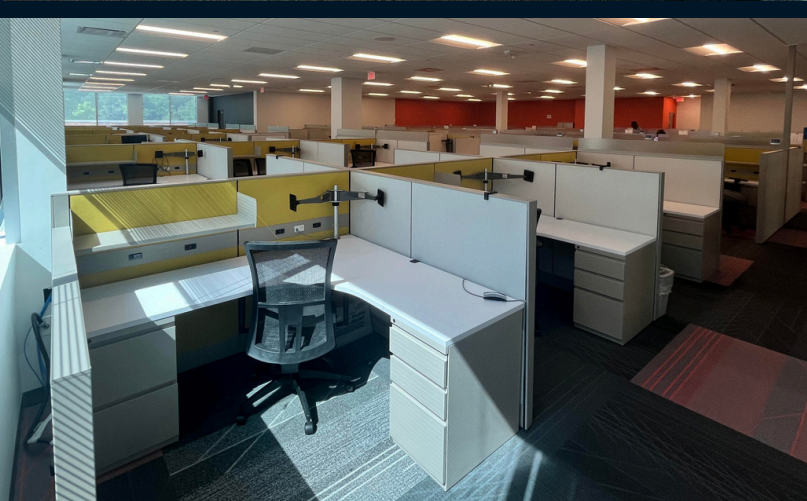

1st floor - 76,332 SF



2nd floor - 23,260 SF

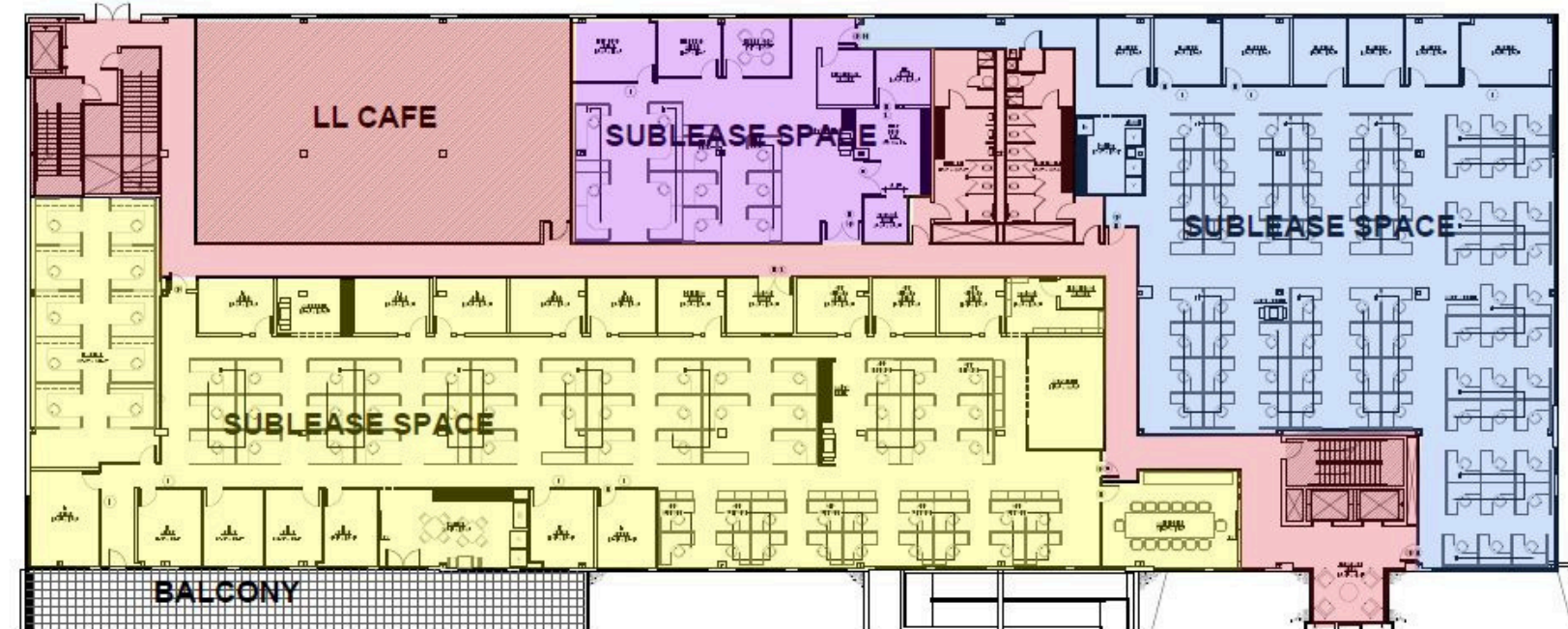

3rd floor - 27,707 SF

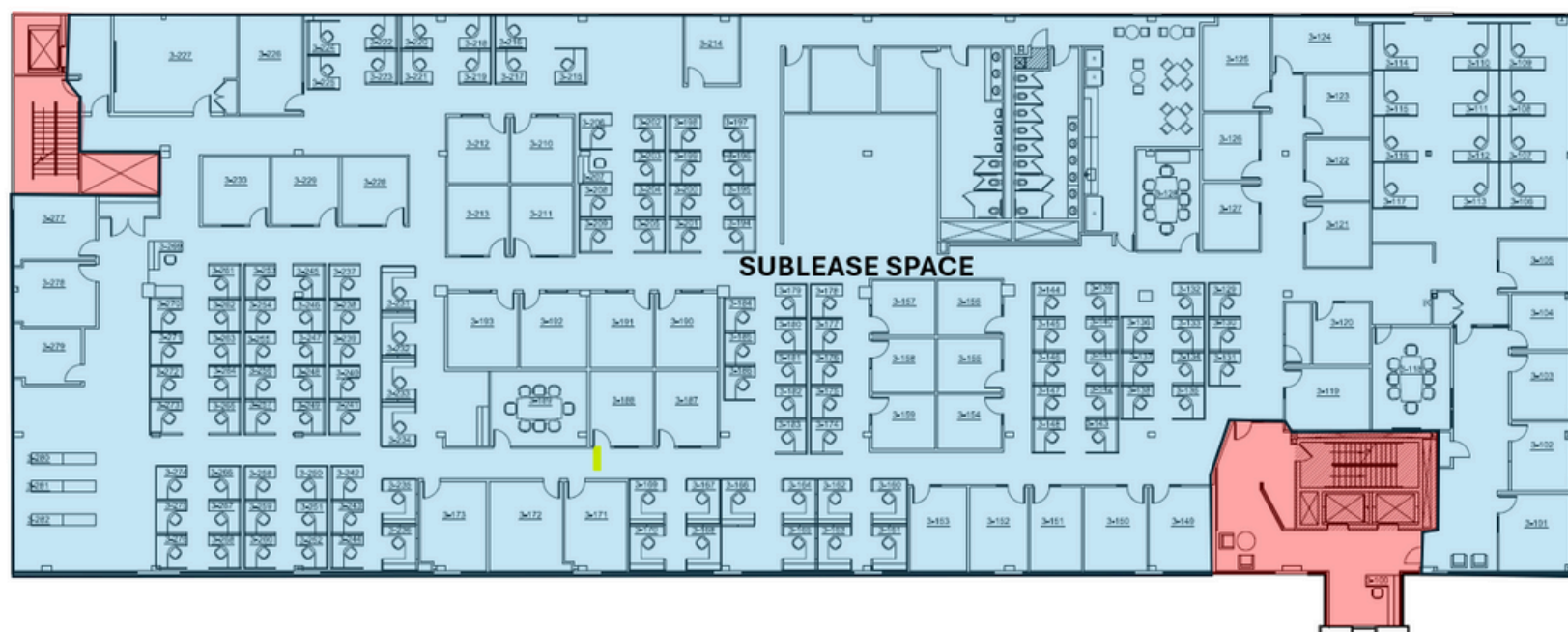



1000 River Road Conshohocken



Adam Shute
adam.shute@jll.com
+1 610 574 3869

Phil Butler
phillip.butler@jll.com
+1 267 475 3990

Jones Lang LaSalle Brokerage, Inc.
550 E. Swedesford Road, Suite 260, Wayne, PA 19087
+1 610 249 2255