

# GIFFORD BUSINESS PARK

765-791 S Gifford Ave. and 750-760 E Central Ave. San Bernardino, Ca



## GIFFORD BUSINESS PARK

765-791 S Gifford Ave. and 750-760 E Central Ave.

San Bernardino, Ca. 92408

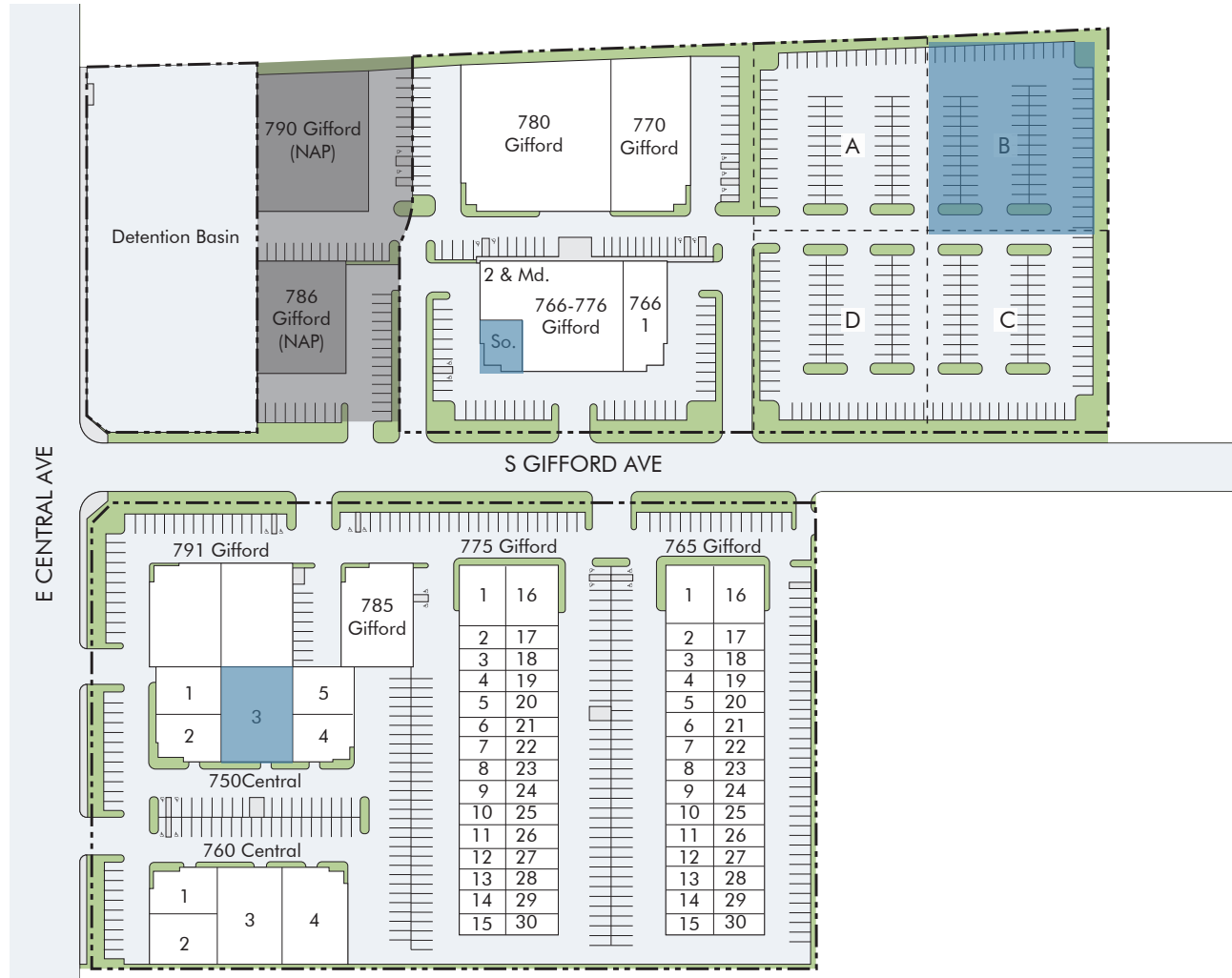

ADDRESS	UNIT	SQ FT.	Asking Rate	AVAILABLE
750 E Central Ave.	03	± 5,280 SF	\$1.50 MG + \$0.11 CAM	30 Day Notice
776 S Gifford Ave	So.	± 2,750 SF	\$1.20 MG + \$0.11 CAM	30 Day Notice
Yard Space	B	± 30,176 SF	\$5,000/Month	30 Day Notice

### Wes Jones

Executive Vice President  
+1 909 418 2070  
wes.jones@cbre.com  
Lic. 01783489

### James Toomarian

Vice President  
+1 909 418 2083  
james.toomarian@cbre.com  
Lic. 02030414

### Andrew Chaffee

Associate  
+1 909 418 2098  
andrew.chaffee@cbre.com  
Lic. 02168894