

Price: \$469,000
Land For Sale

4174 Stringfellow Rd

4140 Stringfellow Rd

PROPERTY HIGHLIGHTS

- Direct road frontage on Stringfellow Road
- Good access and visibility
- Located near the preserve trailhead
- Land is mostly cleared
- Limited supply of vacant land available for sale in the immediate trade area

**4.58 acres with
main road
frontage**
Property Details - 4174 Stringfellow Rd.
Property Details - 4140 Stringfellow Rd.

Strap#	26-45-22-01-00000.0170	Strap#	26-45-22-01-00000.0180
Assessed Value	\$99,317 (Lee County Appraiser)	Assessed Value	\$100,188 (Lee County Appraiser)
Land Acreage	2.28 Acres	Land Acreage	2.30 Acres
Land SF	99,317 SF	Land SF	100,188 SF
Zoning	Ag-2 CS-1	Zoning	Ag-2 CS-1

For more information, please contact:

GARY TASMAN
 CEO & Principal Broker
 239.489.3600
 gtasman@cpswfl.com

LANE BOY
 Director
 239.675-3215
 lboy@cpswfl.com

 5220 Summerlin Commons Blvd. Ste. 500
 Fort Myers, FL 33907
 239.489.3600
 www.cpswfl.com

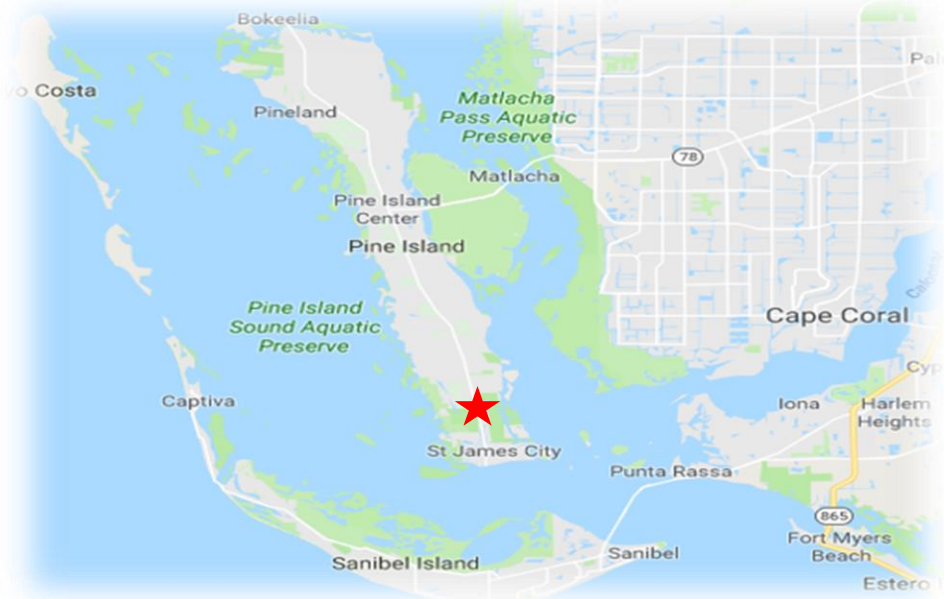

Traffic Count

Stringfellow Rd – North of Castillo Rd
2017 – Annual Average Daily Traffic: 4,600

\$2.35 per Square Foot

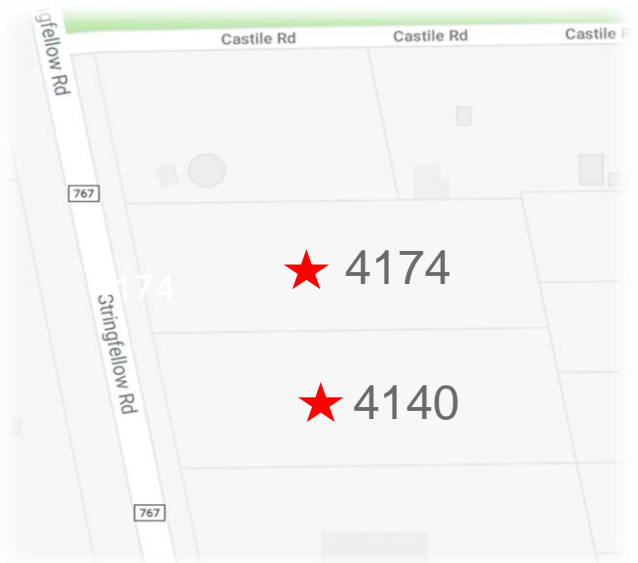

For more information, please contact:

GARY TASMAN
CEO & Principal Broker
239.489.3600
gtasman@cpswfl.com

LANE BOY
Director
239.675-3215
lboy@cpswfl.com

5220 Summerlin Commons Blvd. Ste. 500
Fort Myers, FL 33907
239.489.3600
www.cpswfl.com