

**Interstate 5  
Commercial Buildings  
66th Avenue West  
Neighboring Commercial Building**



2DFLOORPLANS.COM

371 NW Gilman Blvd.  
Suite 140  
Issaquah, WA 98027  
425-677-7511

This drawing is an instrument of service and is the sole property of the client listed. Any alteration of this drawing without removal of references to 2-D As-Built Floor Plans, Inc. is prohibited.

Drawing scale and dimensions are provided for reference only. Refer to CAD files for exact measurements.

©2010 2-D As-Built Floor Plans, Inc. All Rights Reserved.

Area Analysis performed in accordance with ANSI/BOMA Z65.2 - 2019 Standard.

Project: C24-877

Date	Action
10/22/2024	Initial Building Measure
C24-877	

**Client:**  
HRK Investments, LLC

**Site:**  
Industrial Building  
21307 67th Avenue West  
Lynnwood, WA 98118

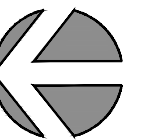

**Lease Plan**



**Floor**

212th Street Southwest  
Neighboring Commercial Buildings

Neighboring Commercial Buildings  
216th Street Southwest  
Commercial Buildings  
220th Street Southwest

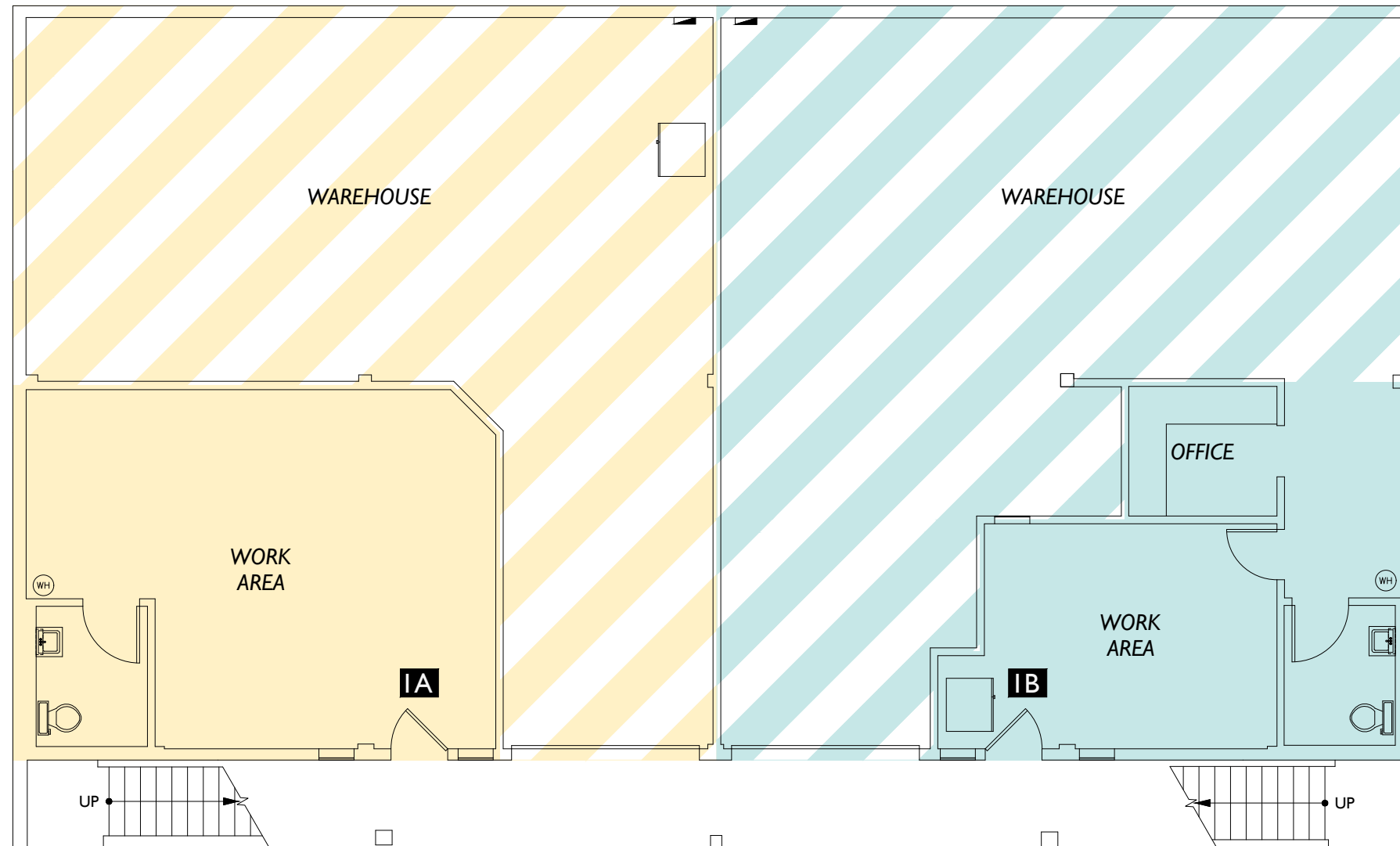

Floor Summary	SQ. FT.
Total Rentable Area	3,000.03
Total Occupant Area	3,000.03
Load Factor	1.00

Floor Service Area	0
Building Service Area	0
Total Vertical	0

Suite #	Occupant Area	Rentable Area
Suite IA	513.59	513.59
Suite IA WH	991.85	991.85
Suite IB	424.06	424.06
Suite IB WH	1,070.53	1,070.53

**Parking Lot & Loading Area  
67th Avenue West  
Commercial Buildings  
Pacific Highway WA-99**

