

SFC LEASING, L.P.

— COMMERCIAL REAL ESTATE —

FOR LEASE

11280 Sunrise Park Drive, Suite B
Rancho Cordova, CA 95742

Highlights

- 2,916 SF Total with 752 SF office & Two, 12'x14' Grade Level Doors
- Clear Height 16"
- Power: 200 Amps/230 Volt/3-Phase
- Built in 2004 / updated
- Zoned M-2, City of Sacramento



SFC LEASING, L.P.

— COMMERCIAL REAL ESTATE —

Floor Plan

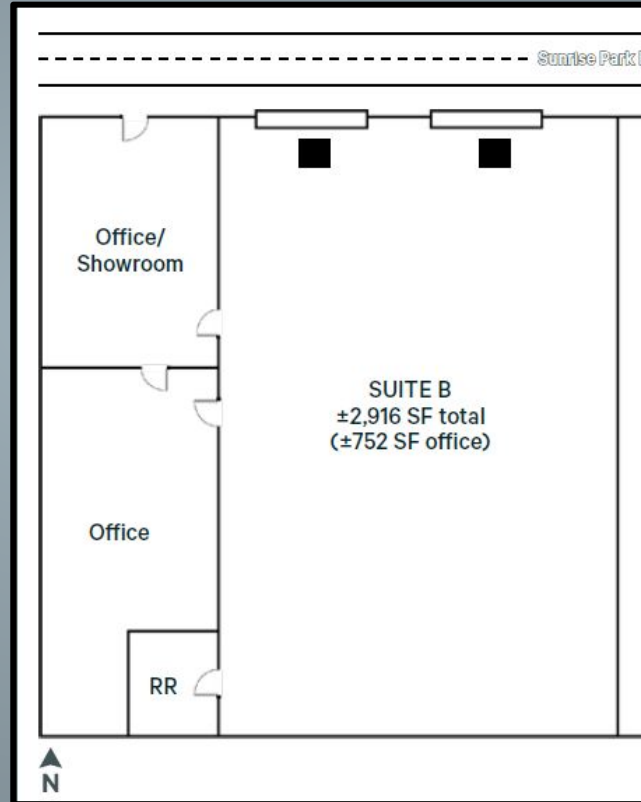

SFC LEASING, L.P.

— COMMERCIAL REAL ESTATE —



SFC LEASING, L.P.

— COMMERCIAL REAL ESTATE —

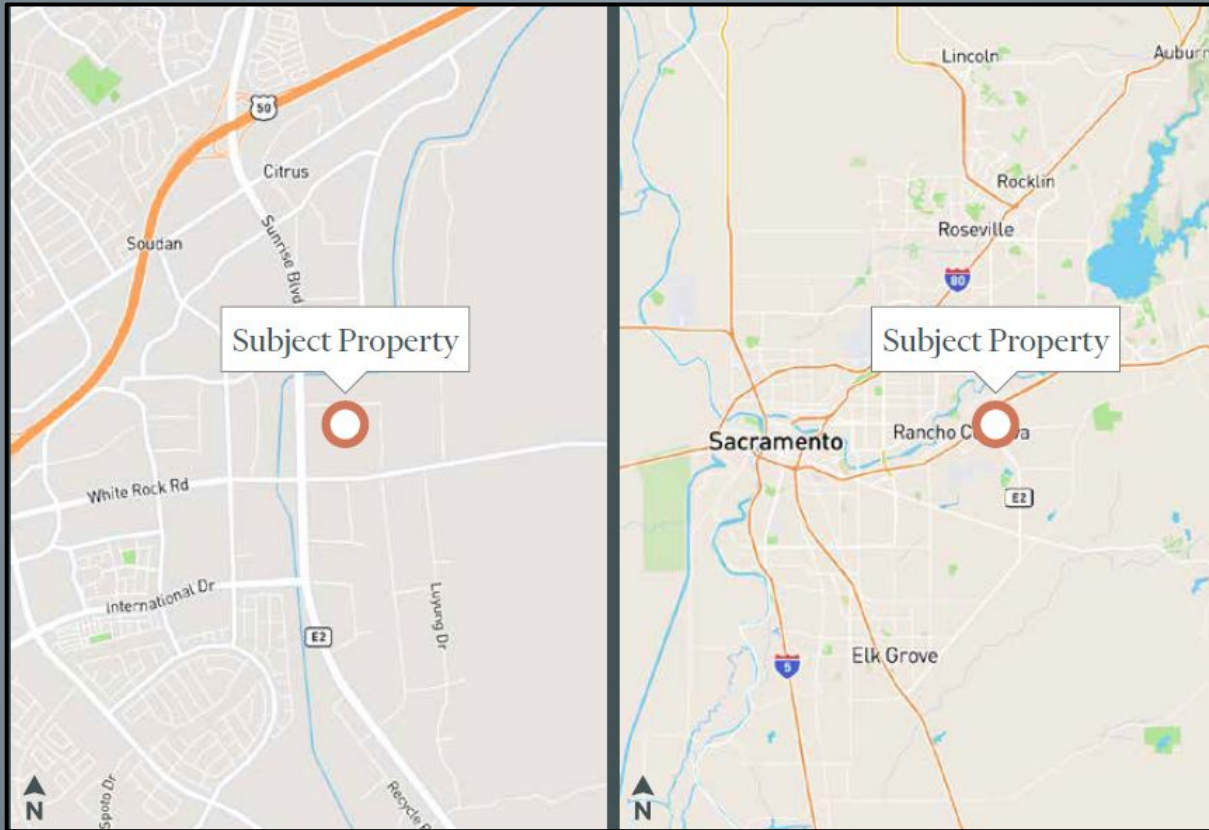

SFC PROPERTIES

— COMMERCIAL REAL ESTATE —

CONTACT KELLY URATA FOR INQUIRES

CELL: 916-316-3399

kelly@urataproperties.com