

H I L A N D  
C O M M E R C I A L

6665-6685 Delmar Blvd.  
St. Louis, MO 63130

# LOUIS LONDON ANNEX

Premier  
Office Space  
For Lease

capacity  
capacity

# PROPERTY HIGHLIGHTS

Premier Office Space For Lease in the historic Loop District

Newly renovated building with high-end finishes throughout

Move-in ready, fully furnished space available

Creative office space with exposed ceilings and abundant natural light

Perfect for professional office, creative office or medical tenants

Ample surface parking available on-site

Walking distance to multiple restaurants and other retail amenities

Prominent building signage opportunities

Easily accessible from I-64/40 and I-170

Premier office suites available up to 12,000 rsf

Lease Rate: \$20.50 PSF FSG





Up to 12,000 SF  
**FOR LEASE**

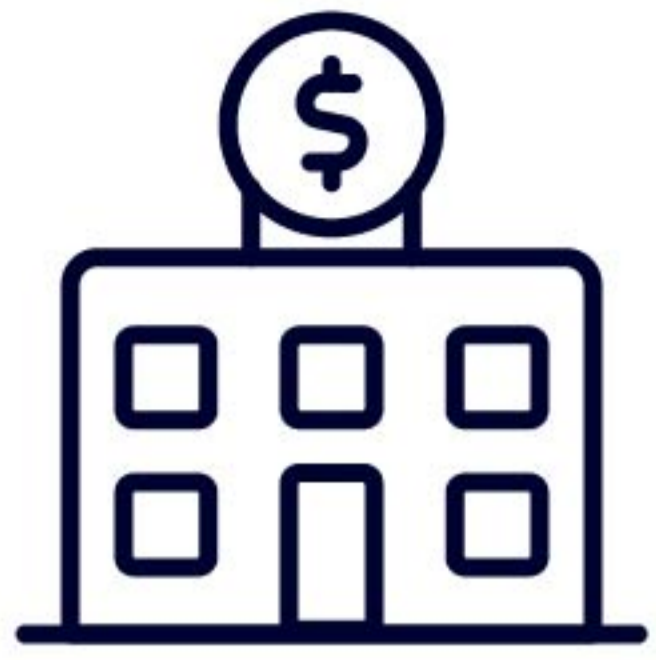

**\$20.50**

PSF FSG

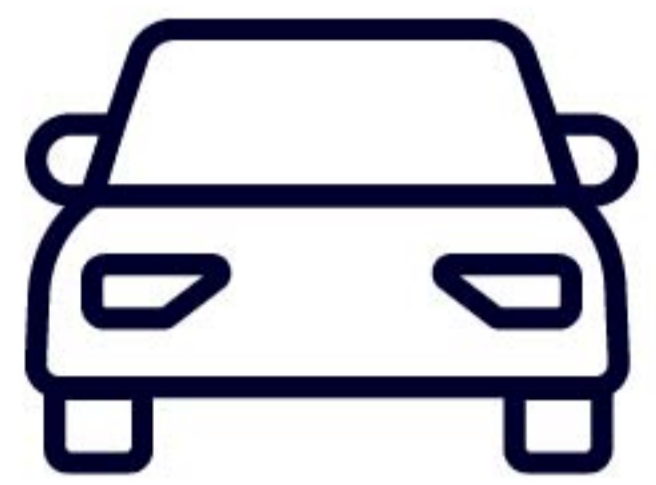

**3/1,000**

PARKING RATIO

**3**

STORY BUILDING

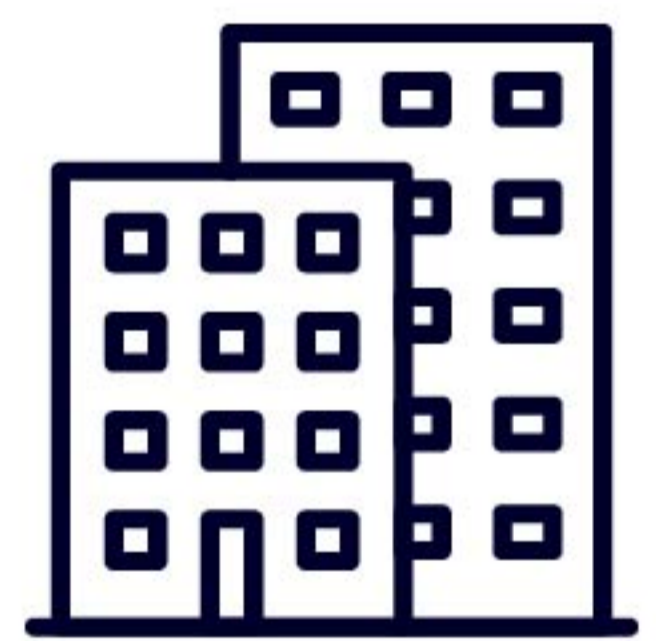

**B+**

CLASS BUILDING

**2026**

RENOVATION

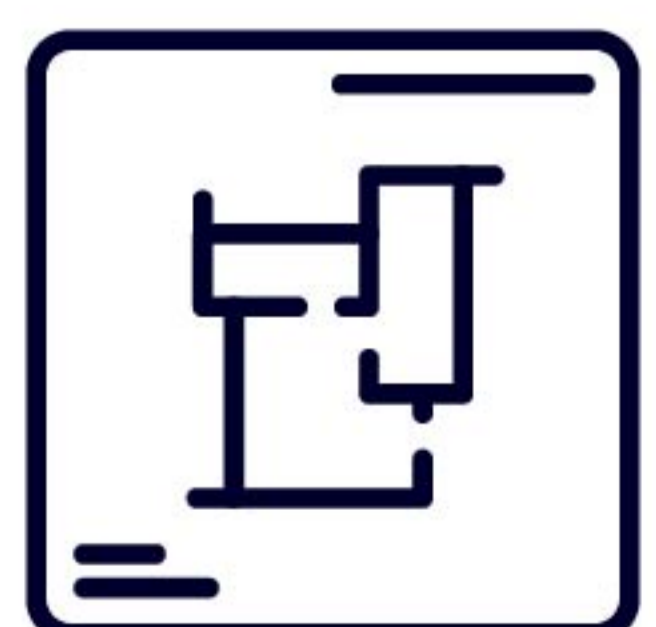

**3,581**

SF MIN AVAILABLE

**12,000**

SF MAX COMBINED





TOUS les JOURS

TURMERIC

HITEA  
BAR & RESTAURANT

REGAL TACO

LOCATION







6665 - 6685 Delmar Blvd  
St. Louis, MO 63130

*For Additional Information, Please Contact*

**PAM HINDS**

[phinds@hilandcommercial.com](mailto:phinds@hilandcommercial.com)

314.802.6226 x2

**TIM LAWLOR, SIOR, CCIM**

[tlawlor@hilandcommercial.com](mailto:tlawlor@hilandcommercial.com)

314.802.6226 x1

8001 FORSYTH BLVD, SUITE 975  
ST. LOUIS, MO 63105  
[WWW.HILANDCOMMERCIAL.COM](http://WWW.HILANDCOMMERCIAL.COM)

**H I L A N D**  
C O M M E R C I A L