



5612 Carder Road

Property Highlights

5612 Carder Road consists of two, one-story industrial buildings totaling 31,132± sf. The property is located within close proximity to Interstate 4 (I-4) , John Young Parkway (SR 423) , and Orange Blossom Trail (SR 441).

Building SF:	31,132± SF
Available SF:	5,190± SF
Parking:	2.0/1,000 SF
Zoning:	I-4 / Orange County

**For further
information**

Lisa Bailey, SIOR
Principal
+1 407 440 6645
lisa.bailey@avisonyoung.com

avisonyoung.com

Location Map - 5612 Carder Road

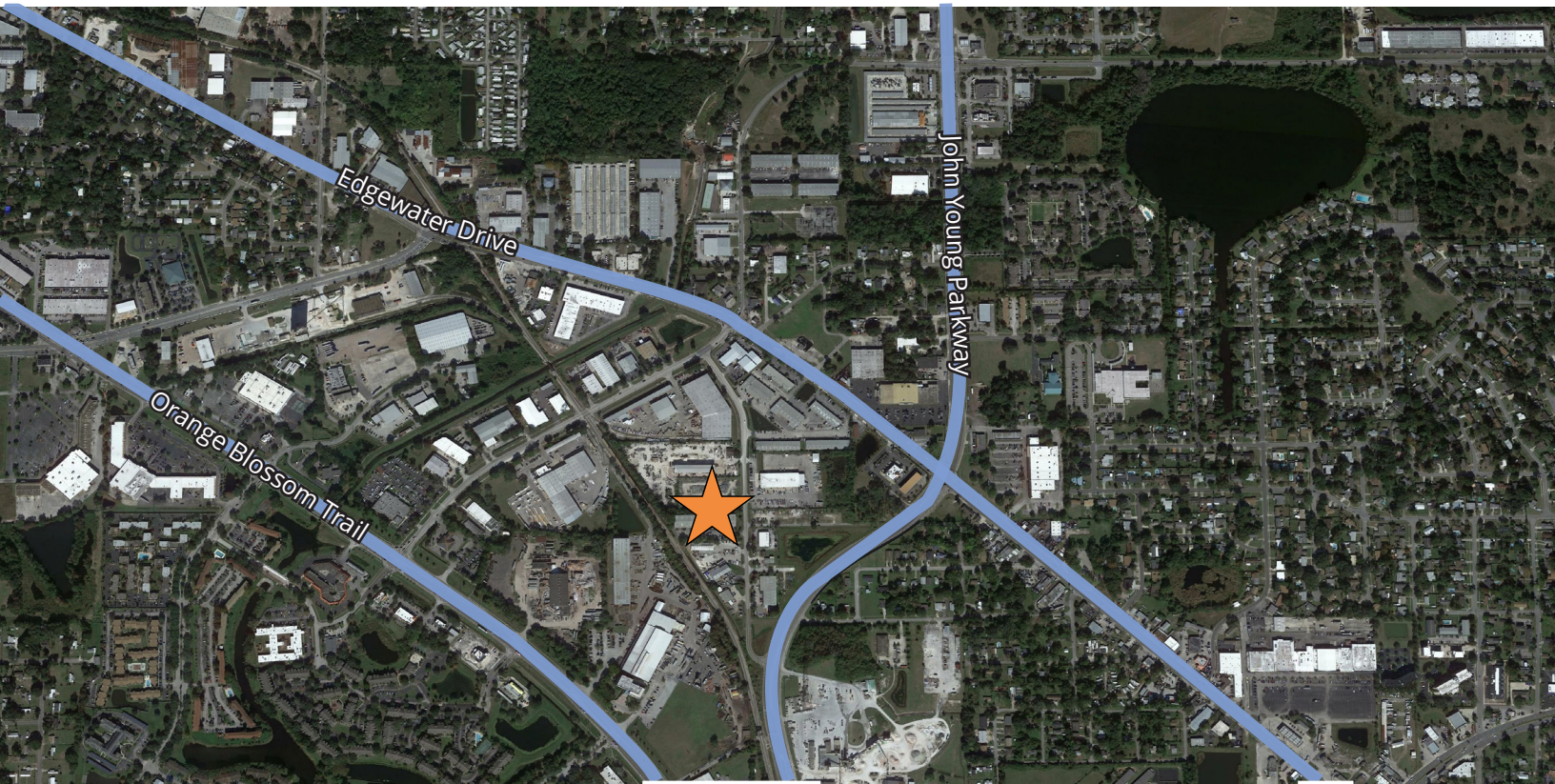

Nearby Amenities



**For further
information**

Lisa Bailey, SIOR
Principal
+1 407 440 6645
lisa.bailey@avisonyoung.com

avisonyoung.com

Floor Plan

Suite A | 5,190± SF | Warehouse

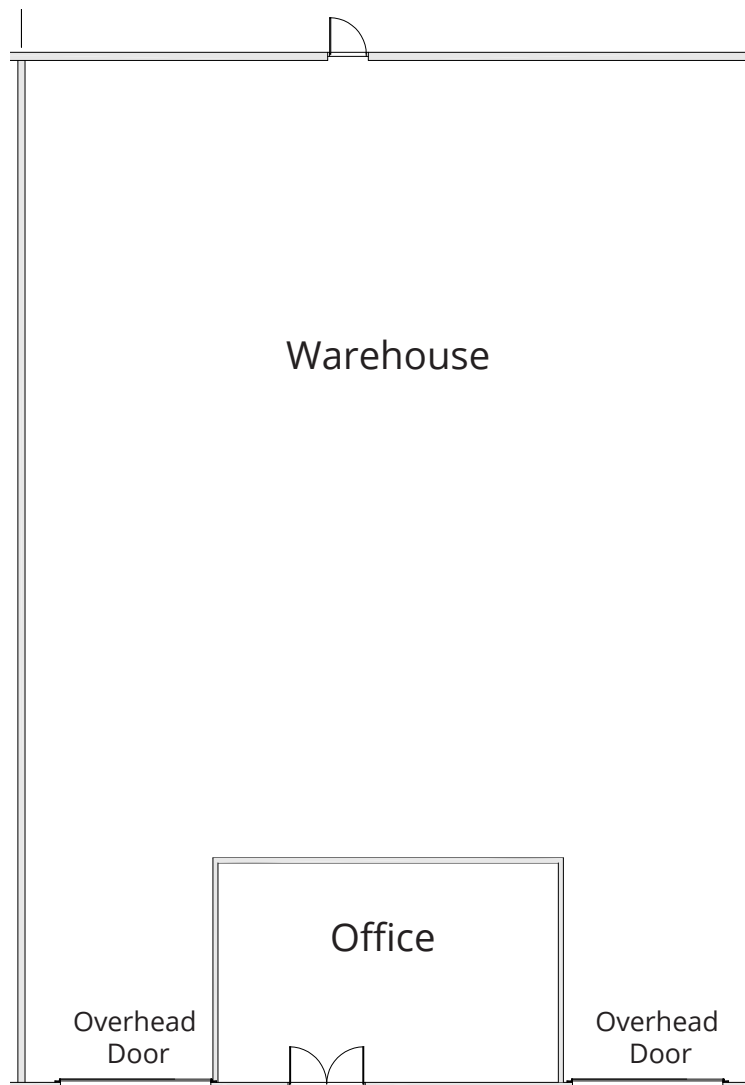

**For further
information**

Lisa Bailey, SIOR
Principal
+1 407 440 6645
lisa.bailey@avisonyoung.com

avisonyoung.com