

LEGACY REALTY & DEVELOPMENT
COMMERCIAL DIVISION

AVAILABLE

7106 TIMBERLAKE ROAD LYNCHBURG, VA 24502

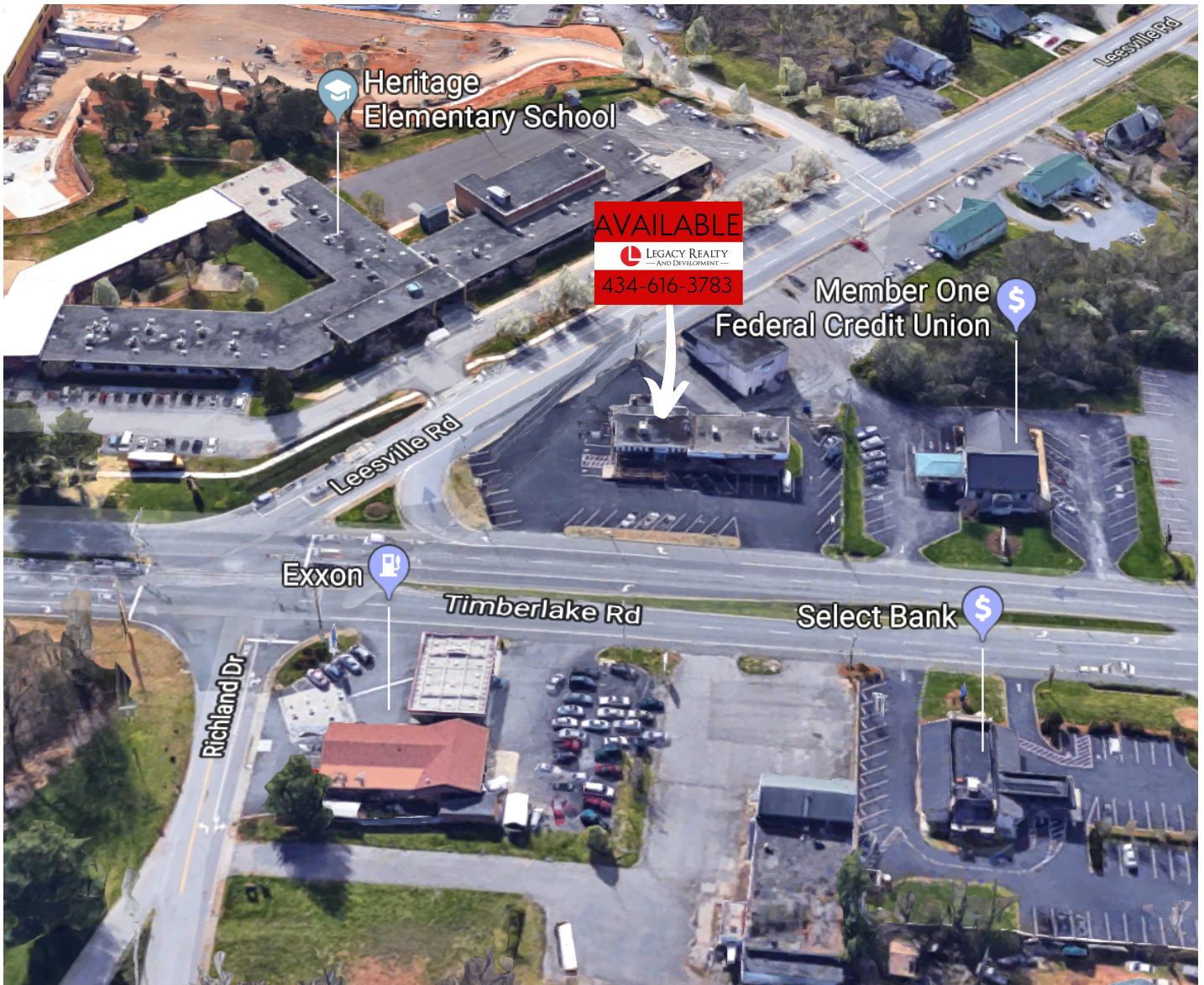

JUNE SMITH-Principal Broker/Owner
434-616-3783 (O) | 804-402-3725 (M)
June@LegacyLynchburg.com



Information has been obtained from sources believed to be reliable but has not been verified for accuracy. Legacy Realty and Development makes no representation as to its accuracy and such information is subject to errors and omissions

106 TRADEWYND DRIVE, LYNCHBURG, VA 24502
WWW.LEGACYLYNCHBURG.COM

A V A I L A B L E



LEGACY REALTY
— AND DEVELOPMENT —



7106 TIMBERLAKE ROAD LYNCHBURG, VA 24502

- GROUND LEASE OPPORTUNITY
- PRIME CORNER LOT
- IDEAL FOR GAS STATION OR FAST FOOD
- ONE OF BUSIEST INTERSECTIONS IN CITY
- ZONED COMMERCIAL

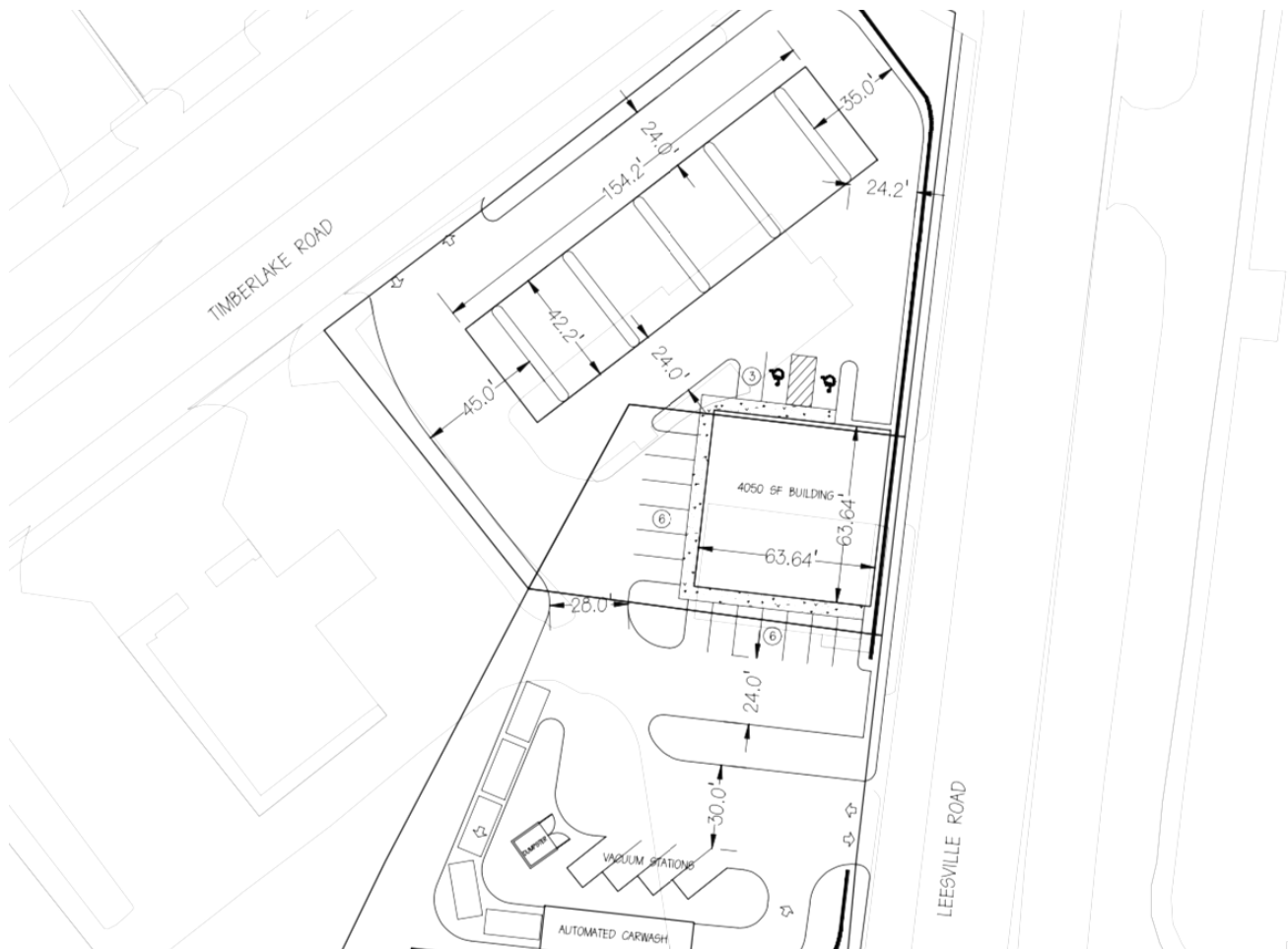

JUNE SMITH-Principal Broker/Owner
434-616-3783 (O) | 804-402-3725 (M)
June@LegacyLynchburg.com



LEGACY REALTY
— AND DEVELOPMENT —

Information has been obtained from sources believed to be reliable but has not been verified for accuracy. Legacy Realty and Development makes no representation as to its accuracy and such information is subject to errors and omissions

106 TRADEWYND DRIVE, LYNCHBURG, VA 24502
WWW.LEGACYLYNCHBURG.COM