

Office/Medical Office Space Available for Purchase 6912 Fern Loop Shreveport, La.



2,359 SF to 10,630 SF
Design & Build-Out Your
Interior Space to Suit Your Needs!

For Additional Information, Contact:

Beth King | 318-453-6066 | Beth@BethKingRealEstate.com

333 Texas Street, Suite 2280, Shreveport, Louisiana 71101

ALL INFORMATION CONTAINED HEREIN IS BELIEVED TO BE ACCURATE, BUT IS NOT WARRANTED AND NO LIABILITY OF ERRORS OR OMISSIONS IS ASSURED BY EITHER THE PROPERTY OWNER OR BETH KING REAL ESTATE, LLC. PRICES AS STATED HEREIN AND PRODUCT AVAILABILITY IS SUBJECT TO CHANGE AND/OR SALE OR LEASE WITHOUT PRIOR NOTICE, AND ALL SIZES AND DIMENSIONS ARE SUBJECT TO CORRECTION OR CHANGE. 01/01/23

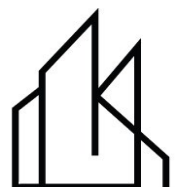

BETHKING
REAL ESTATE, LLC

Outstanding Location!

Immediate access to E. 70th Street and just minutes to I-49, Youree Drive and Ind. Loop

- Own your own office/medical office space!
- Up to 10630 square feet available in three contiguous spaces. Suites B & C are each 2,359 square feet. Suite D is 5,912 square feet.
- Additional 976 sf of covered open area next to Suite D.
- Property is fully developed with building exterior, parking, walkways and landscaping.
- Available suites are in 'shell' condition and ready for interior build-out.
- Walking distance to restaurants and shopping and adjacent to Whole Foods Center.

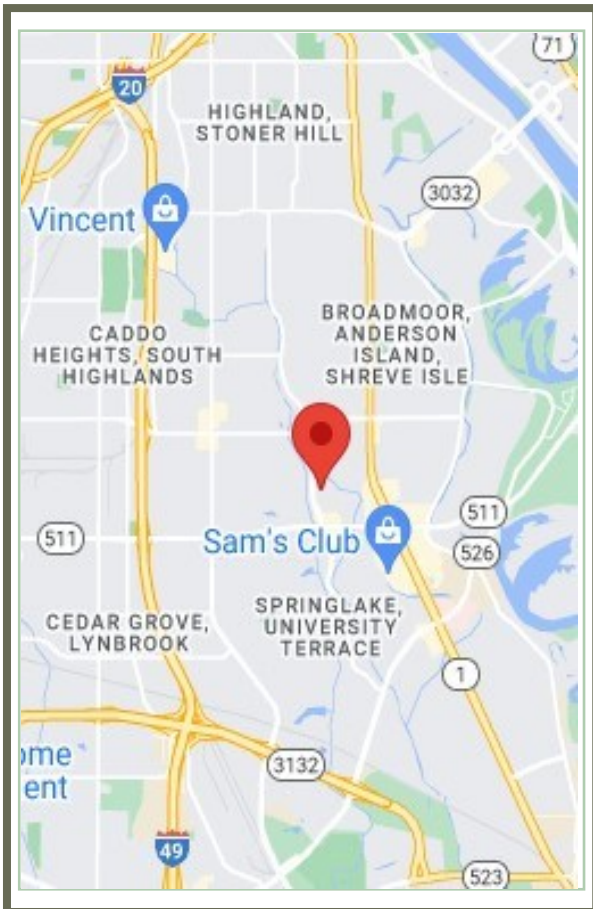

Front View of Suites B & C

For Additional Information Contact:

Beth King | 318-453-6066 |

Beth@BethKingRealEstate.com

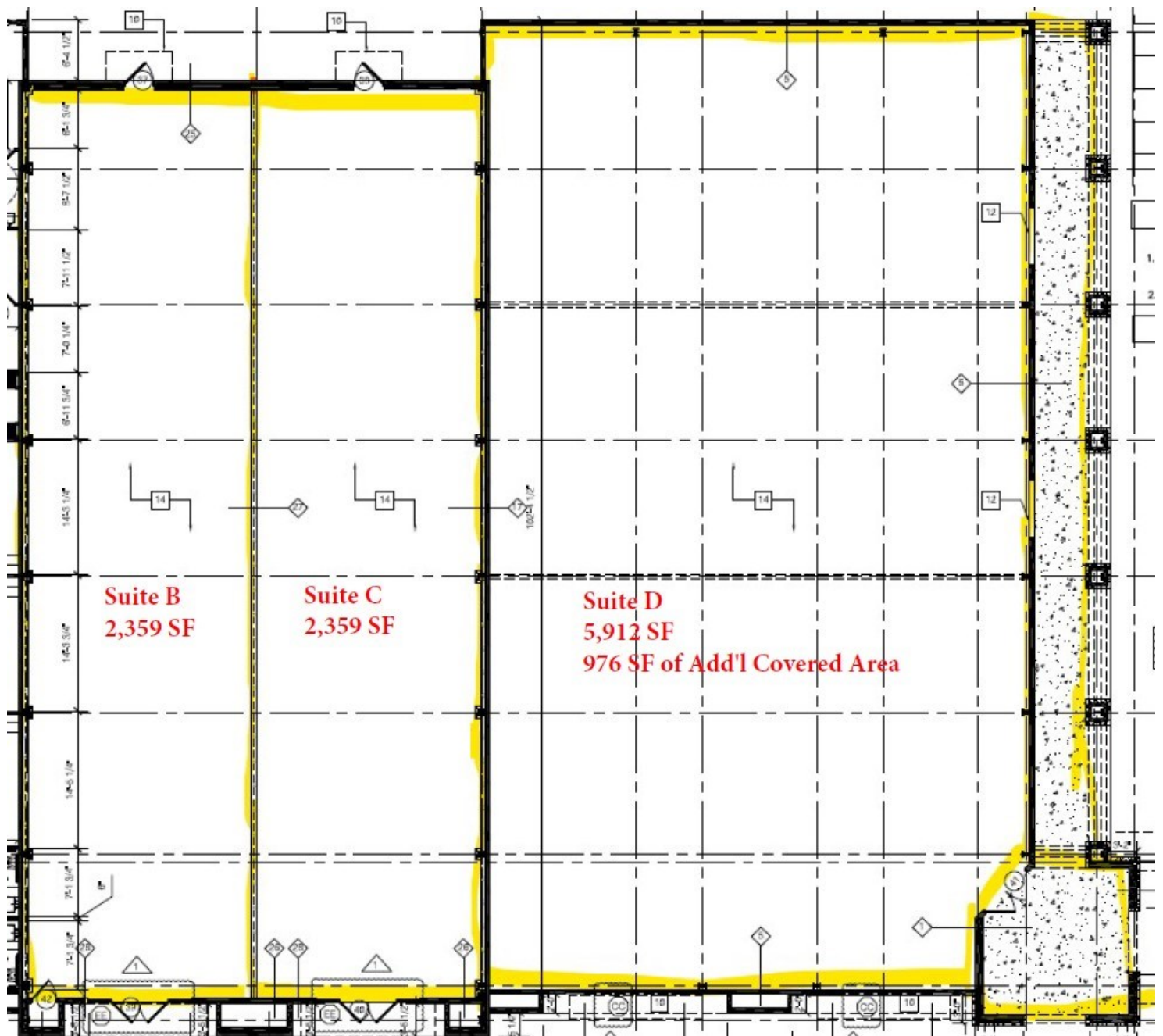

For Additional Information, Contact:

Beth King | 318-453-6066 |

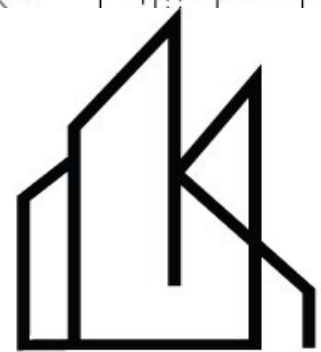

BETHKING

REAL ESTATE, LLC



Photos of adjacent finished space—not part of sale.

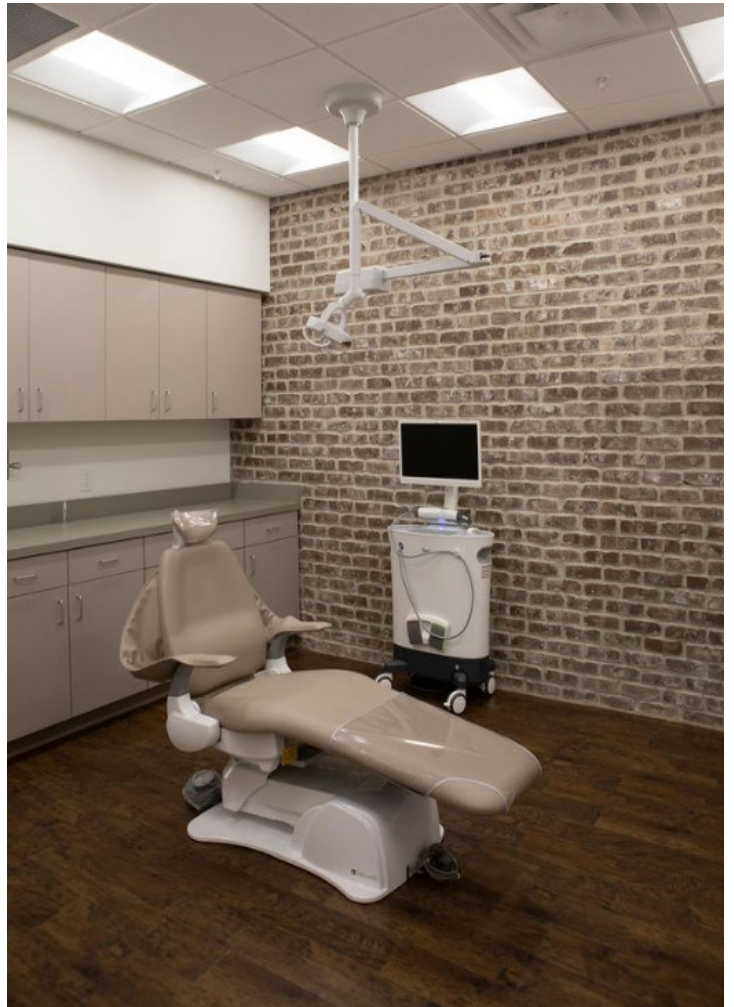

For Additional Information, Contact:

Beth King | 318-453-6066 |

Beth@BethKingRealEstate.com

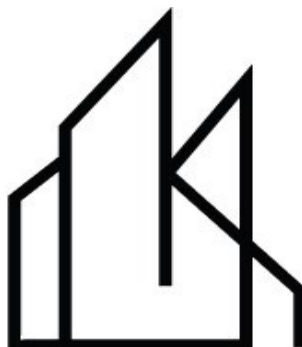

BETHKING

REAL ESTATE, LLC