

FOR LEASE

INSITE
36,224 SQUARE FEET



8648 GLENMONT, SUITE 120, HOUSTON, TX

- 36,224 SF total
- 1,529 SF office / 34,695 SF warehouse
- Front Load (9 docks / 1 ramp)
- 24' clear height
- ESFR Sprinklers
- Located in SW Houston, immediate access to Westpark Tollway



CONTACT INFORMATION

LOGAN GREER
lgreer@insiterealty.com
713.339.5363

DAYNE WUNDERLICH
dwunderlich@insiterealty.com
713.339.5329

FOR LEASE

8648 GLENMONT, SUITE 120, HOUSTON, TX

INSITE

36,224 SQUARE FEET

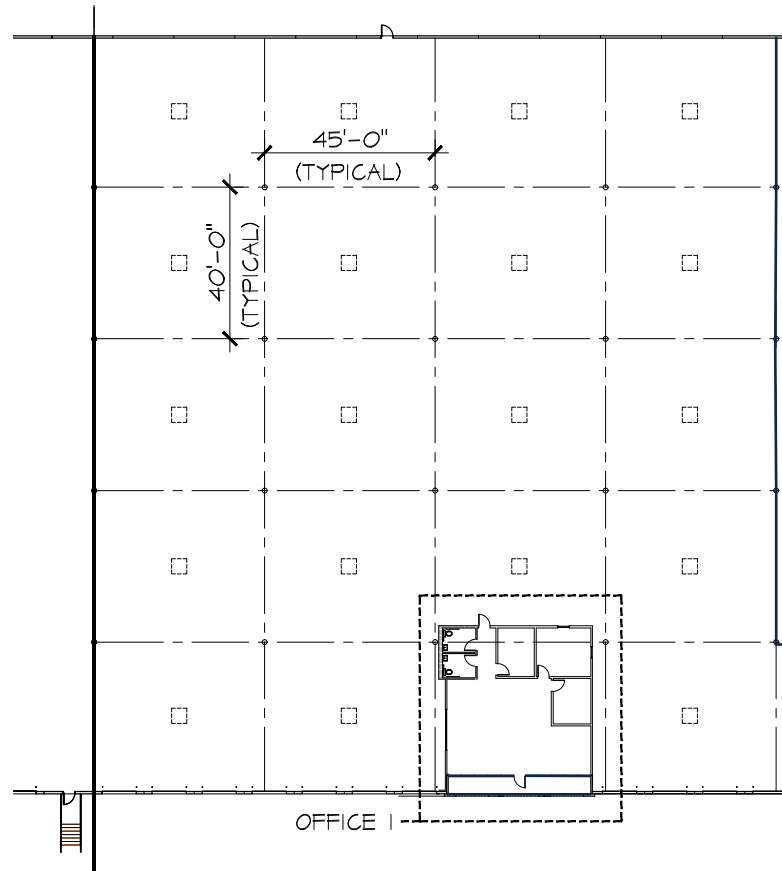

CONTACT INFORMATION

LOGAN GREER
lgreer@insiterealty.com
713.339.5363

DAYNE WUNDERLICH
dwunderlich@insiterealty.com
713.339.5329

FOR LEASE

8648 GLENMONT, SUITE 120, HOUSTON, TX

INSITE

36,224 SQUARE FEET

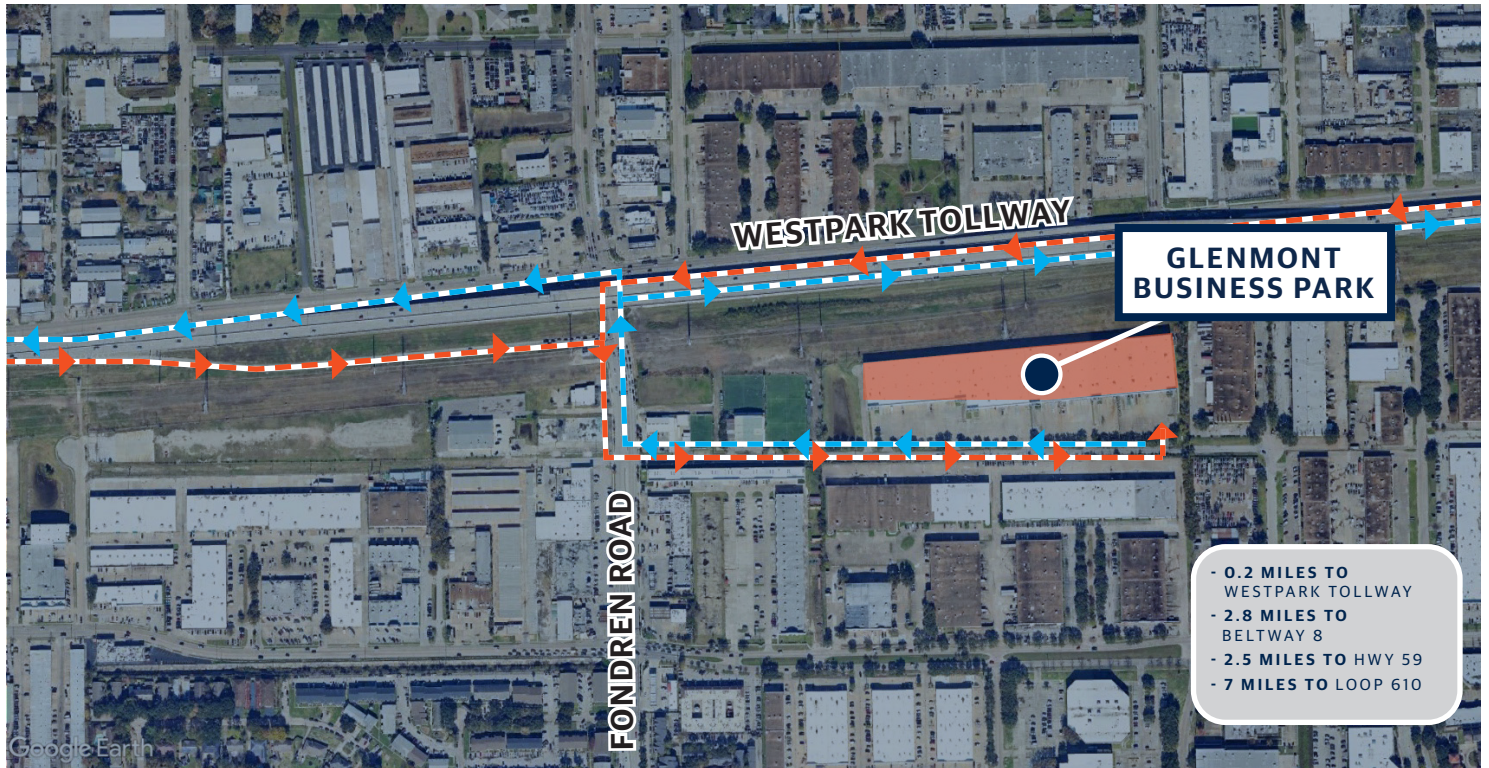

CONTACT INFORMATION

LOGAN GREER
lgreer@insiterealty.com
713.339.5363

DAYNE WUNDERLICH
dwunderlich@insiterealty.com
713.339.5329