

Johns Creek Walk

11030 Medlock Bridge Road
Johns Creek, GA 30097

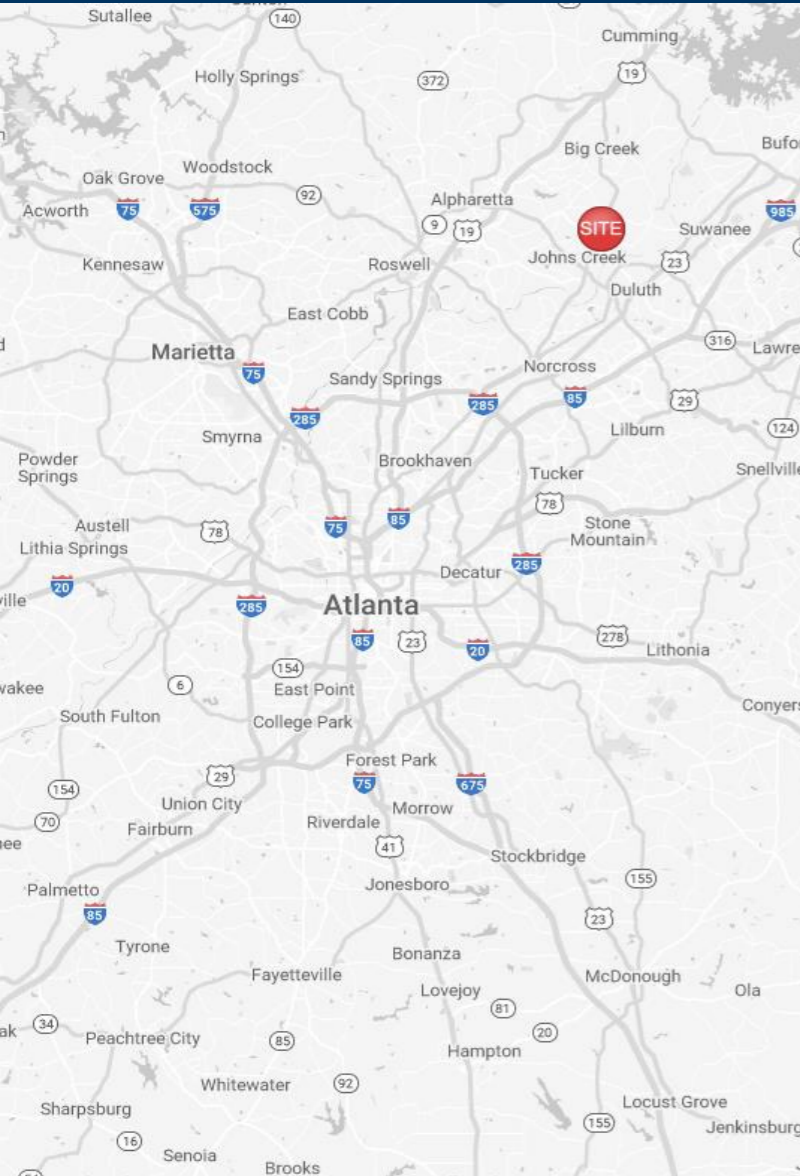

RIVERWOOD
PROPERTIES, LLC

Property Highlights

- Johns Creek Walk is located on Medlock Bridge Road (GA 141) with daily traffic counts over 41,000 vehicles.
- Johns Creek Walk consists of multi-family units, a senior living community, private residences, senior living apartments, and professional offices/retail.
- The retail shopping center is conveniently located near Johns Creek Parkway which is the home of several Fortune 500 companies within the Technology Park business district.
- Retail Spaces Available | 1,000-5,500 SF
- Zoned C4-Commerical Small Tracts

Leasing Contacts

Allie Hodge Motz
678-501-5342
allie@riverwoodproperties.com

Site Access: Property is accessible via two curb cuts on Medlock Bridge Road.

Johns Creek Walk

TENANTS

10-20	Francis Fong Martial Arts	4,200
30	The Parlor Beauty	1,400
40	Pharmacy	1,400
50	Shwarma Press	1,400
60	W.E. Music Academy	1,750
70	Coldwell Banker	5,007
110	Restaurant Space Available	5,500
120	F45	3,212
130	Retail Space Available	1,000
140	MAX Family Vision	1,400
150	Throom Thai and Sushi	1,400
160	Restaurant Space Available	2,800
210	Restaurant Space Available	3,575
230	100 Percent Chiropractic	1,755
240	Papa's Dumpling	1,300
250	Beauty Skin Laser	1,300
260	Studio 108	1,820
270	Pearl's Tea	1,400
280	Dry Cleaners	1,500
	GLA:	43,119

Availability: 1,000 - 5,500 SF

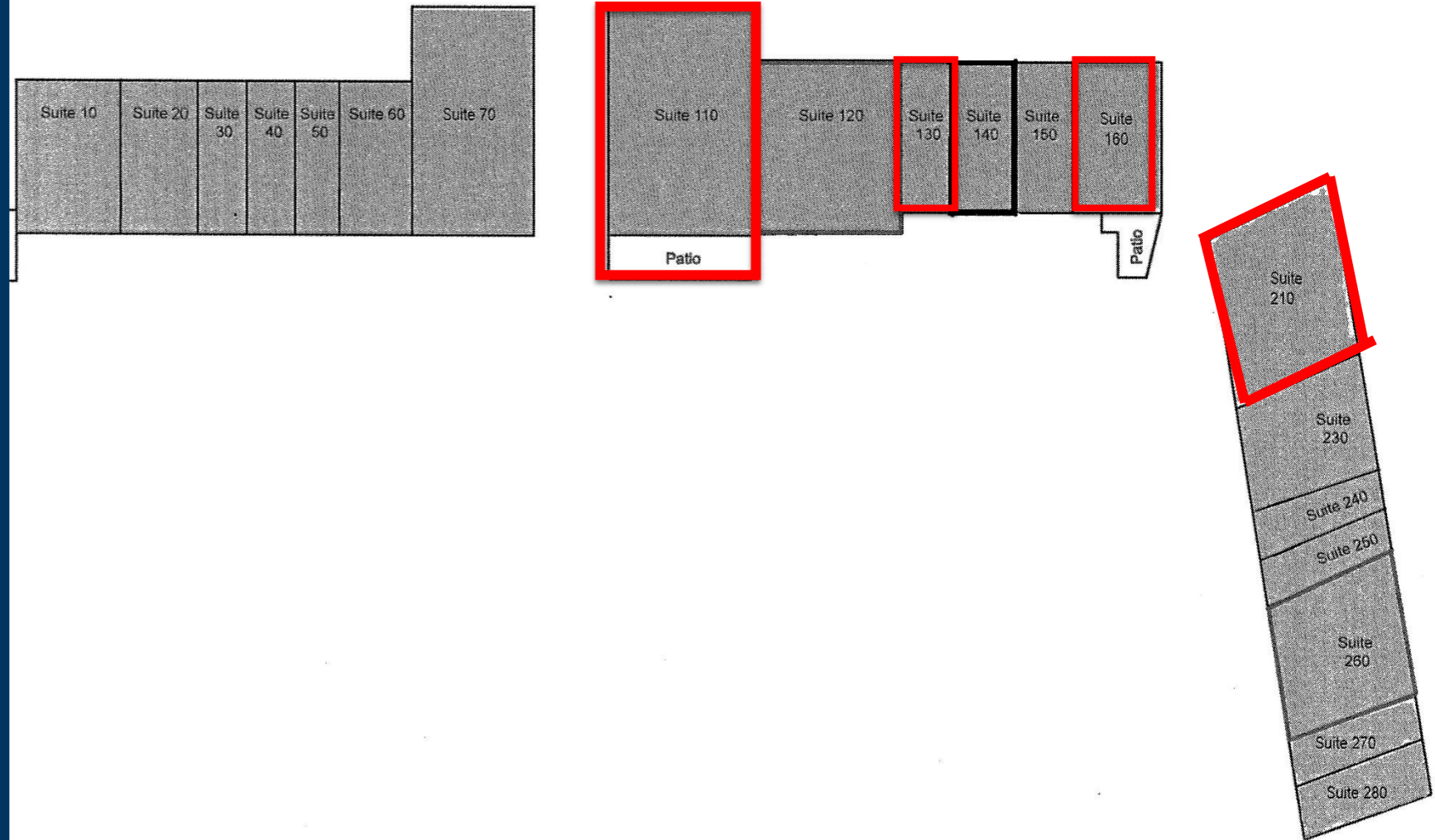

JOHNS CREEK WALK
Site Plan

AREA DEMOGRAPHICS



2023
Population

1 MILE	9,565
3 MILE	78,351
5 MILE	187,457



2023 Daytime
Population

1 MILE	5,696
3 MILE	35,451
5 MILE	96,046



Household 2023

1 MILE	3,281
3 MILE	25,790
5 MILE	63,216



Household
Income

1 MILE	\$173,683
3 MILE	\$206,261
5 MILE	\$213,838



JOHNS CREEK WALK

Trade Area Overview

