

TOPOGRAPHICAL SURVEY OF ALMONT RESEARCH AND INDUSTRIAL PARK

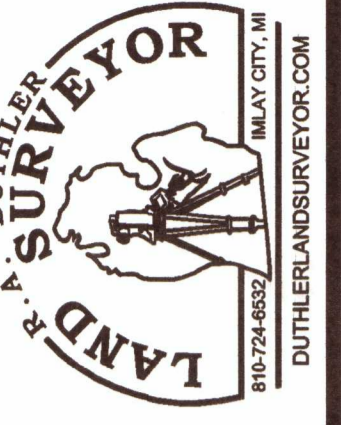

R.A. DUTHLER
LAND SURVEYOR
158 E. THIRD STREET
IMLAY CITY, MICHIGAN 48444
PH. (810) 724-6532
FAX. (810) 724-1551

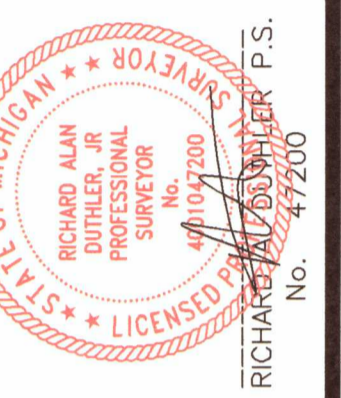

TOPOGRAPHICAL SURVEY
PART OF THE NORTHEAST 1/4 OF SECTION 21, TOWN 6 NORTH,
RANGE 12 EAST, VILLAGE OF ALMONT, LAPEER COUNTY, MICHIGAN.

PREPARED FOR:
MIDWEST COMMERCIAL
CONSTRUCTION
115 EAST CAPAC ROAD
IMLAY CITY, MI. 48444
JOB No. 220328

DRAWN BY: RICHARD DUTHLER/T.S.
DATE: JUNE 8, 2022
SCALE: 1" = 60'
SHEET: 1 OF 1
REVISION DATES:
1 - 2-24

- GENERAL CONSTRUCTION NOTE:**
- IF THERE IS TO BE ANY CONSTRUCTION, IT SHALL BE THE CONTRACTOR'S RESPONSIBILITY TO NOTIFY THE LOCAL TELEPHONE COMPANY, DETROIT EDISON COMPANY, LOCAL GAS COMPANY AND LOCAL MUNICIPALITY TO VERIFY THE LOCATION AND/OR EXISTENCE OF ANY UNDERGROUND UTILITIES WHICH MAY AFFECT CONSTRUCTION.
 - ALL CONSTRUCTION AND MATERIALS SHALL BE IN ACCORDANCE WITH THE CURRENT STANDARDS AND SPECIFICATIONS OF THE LOCAL MUNICIPALITY, DRAIN COMMISSION, AND MICHIGAN DEPARTMENT OF TRANSPORTATION. ALL ELEVATIONS OF THESE PLANS ARE LOCAL DATUM.
 - IT SHALL BE THE CONTRACTOR'S RESPONSIBILITY TO VERIFY AND/OR OBTAIN ANY INFORMATION NECESSARY REGARDING THE PRESENCE OF UNDERGROUND UTILITIES WHICH MIGHT AFFECT THE JOB PRIOR TO COMMENCEMENT OF CONSTRUCTION.
 - ALL ITEMS OF WORK NOT SPECIFICALLY INDICATED AS PAY ITEMS IN THE PROPOSED SHALL BE CONSIDERED INCIDENTAL ITEMS.
 - ALL PROPERTIES OR FACILITIES IN THE SURROUNDING AREAS, INCLUDING FIELD TILES, PUBLIC OR PRIVATE, DESTROYED OR OTHERWISE DISTURBED DUE TO CONSTRUCTION SHALL BE REPLACED AND/OR RESTORED TO THE ORIGINAL CONDITION BY CONTRACTOR.
 - THE CONTRACTOR SHALL REMOVE AND DISPOSE OF ALL ON-SITE TREES, BRUSH, STUMP, ROCKS, STONES, FENCE, WIRE, TRASH, OR OTHER UNWANTED DEBRIS AT THE DEVELOPER'S DIRECTION RESULTING FROM THE CONSTRUCTION AND SHALL BE AN INCIDENTAL ITEM.
 - CONTRACTOR TO CONTACT LOCAL MUNICIPALITY 48 HOURS PRIOR TO CONSTRUCTION SUCH THAT THE PROPER INSPECTIONS CAN BE SCHEDULED.
 - CONTRACTOR SHALL BE RESPONSIBLE FOR FIELD CHECKING ELEVATIONS OF INVERTS PRIOR TO CONSTRUCTION.
 - CONTRACTOR SHALL FIELD VERIFY ALL DIMENSIONS AND ELEVATIONS PRIOR TO CONSTRUCTION.
 - CONTRACTOR SHALL CHECK BENCHMARK RELATIVE TO SITE GRADE PRIOR TO CONSTRUCTION.

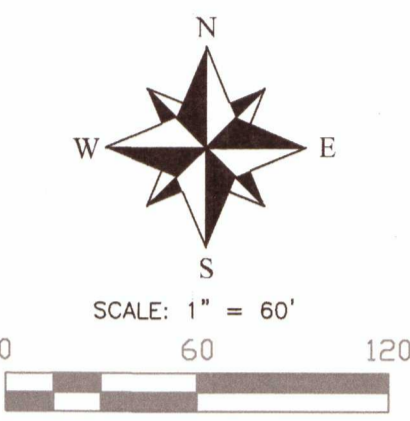
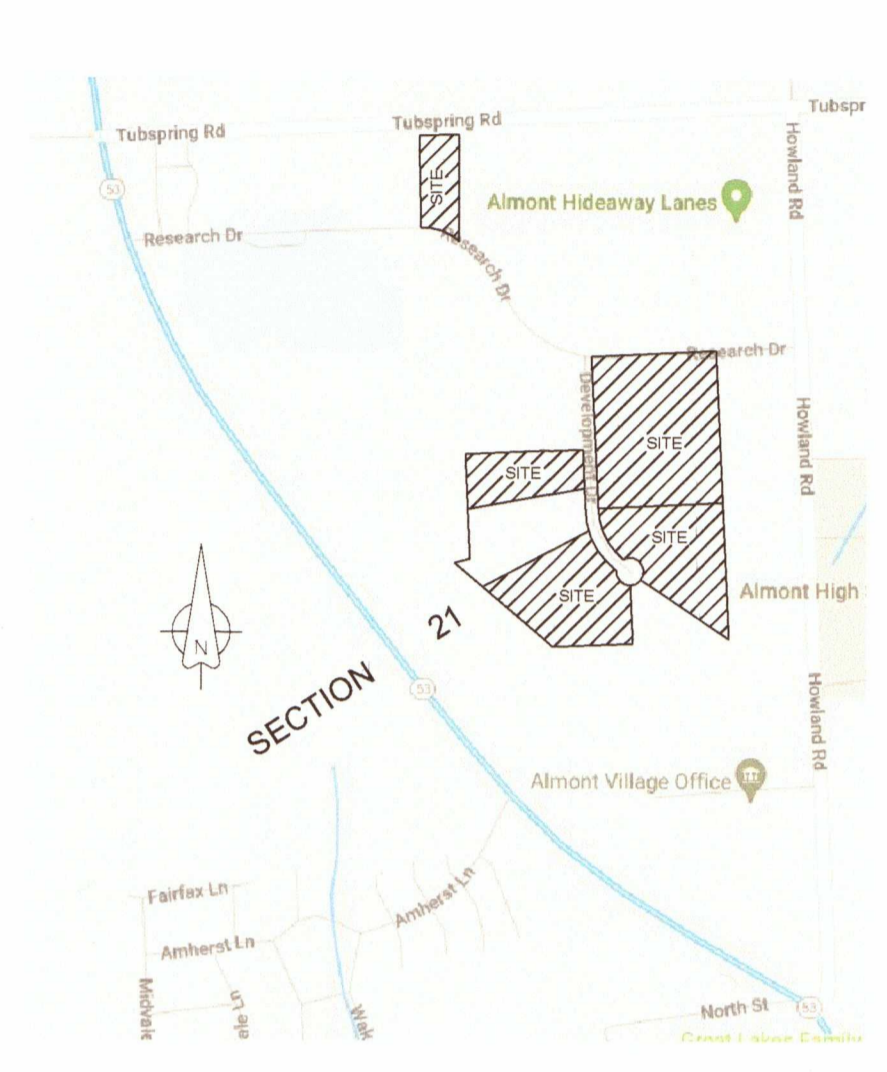

- LEGEND**
- These standard symbols will be found in the drawing.
- ▲ INVERT
 - WATER MAIN MANHOLE
 - STORM MANHOLE
 - ▲ BENCHMARK
 - SQUARE CATCH BASIN
 - STORM BEE-HIVE
 - GUY
 - ⊕ GATE VALVE
 - ⊕ HYDRANT
 - ⊕ UTILITY POLE
 - SANITARY SEWER
 - ⊕ TELEPHONE PEDISTAL
 - UNKNOWN MANHOLE
 - EXISTING WELL
 - ▽ CONTROL POINT

- BENCHMARK #313**
BENCH TIE IN NORTH FACE OF POWER POLE, 5' ± NW. OF SE. CORNER OF LOT 9.
ELEV. = 852.77 NAVD 88
- BENCHMARK #314**
TIP OF ARROW ON HYDRANT ON WEST SIDE OF DEVELOPMENT DRIVE OPPOSITE THE SW. CORNER LOT 9.
ELEV. = 854.07 NAVD 88
- BENCHMARK #315**
TIP OF ARROW ON HYDRANT ON SOUTHEAST CORNER OF DEVELOPMENT DRIVE AND RESEARCH DRIVE.
ELEV. = 851.95 NAVD 88
- BENCHMARK #316**
TIP OF ARROW ON HYDRANT ON SOUTH SIDE OF RESEARCH DRIVE IN FRONT OF LOT 10 OF ALMONT RESEARCH AND INDUSTRIAL PARK.
ELEV. = 849.94 NAVD 88
- BENCHMARK #321**
TIP OF ARROW ON HYDRANT ON SOUTH SIDE OF CUL-DE-SAC END OF DEVELOPMENT DRIVE.
ELEV. = 856.30 NAVD 88
- BENCHMARK #322**
TOP OF WELL CASING, WEST OF LOT 18 PROPERTY LINE.
ELEV. = 848.79 NAVD 88
- BENCHMARK #325**
MAG NAIL IN SOUTH FACE POWER POLE, 90' ± SOUTH OF TUBSPRING ROAD ON WEST LINE OF LOT 6 OF ALMONT RESEARCH AND INDUSTRIAL PARK.
ELEV. = 842.29 NAVD 88
- BENCHMARK #326**
TIP OF ARROW ON HYDRANT ON SOUTH SIDE OF RESEARCH DRIVE IN FRONT OF LOT 6 OF ALMONT RESEARCH AND INDUSTRIAL PARK.
ELEV. = 847.16 NAVD 88

| CURVE | RADIUS | CENTRAL ANGLE | ARC LENGTH | BEARING | LENGTH |
|-------|---------|---------------|------------|---------------|---------|
| C1 | 317.00' | 38°26'08" | 212.65' | S 17°54'04" E | 208.69' |
| C2 | 50.00' | 84°51'15" | 47.87' | N 64°32'45" W | 46.06' |
| C3 | 70.00' | 83°26'13" | 114.15' | S 45°15'17" E | 101.92' |
| C4 | 70.00' | 46°52'56" | 57.28' | S 24°54'17" W | 55.69' |
| C5 | 70.00' | 44°36'21" | 54.50' | S 70°38'55" W | 53.13' |
| C6 | 70.00' | 44°22'51" | 54.22' | N 64°51'29" W | 52.88' |
| C7 | 70.00' | 42°19'17" | 51.71' | S 21°30'27" E | 50.54' |
| C8 | 50.00' | 40°15'11" | 35.13' | S 20°28'22" E | 34.41' |
| C9 | 383.00' | 18°00'10" | 120.34' | S 31°35'52" E | 119.85' |
| C10 | 383.00' | 13°47'45" | 92.22' | N 15°41'49" W | 92.00' |
| C11 | 383.00' | 10°06'59" | 67.62' | N 03°44'29" W | 67.54' |
| C12 | 70.00' | 27°13'39" | 33.86' | S 43°50'26" W | 33.58' |
| C13 | 280.19' | 41°54'57" | 383.00' | N 19°38'28" W | 273.98' |
| C14 | 418.00' | 4°29'00" | 32.71' | S 86°40'30" E | 32.70' |

- GRADING NOTE:**
- ALL PROPOSED GRADING SHALL BE CONTAINED WITHIN THE PROPERTY LINES OF THE LOTS, AND SHALL NOT ENDOURCH UPON ANY ADJACENT PROPERTIES.
 - SOIL EROSION CONTROLS ARE REQUIRED TO BE INSTALLED AROUND THE ENTIRE PERIMETER OF SOIL DISRUPTION PER THE COUNTY.

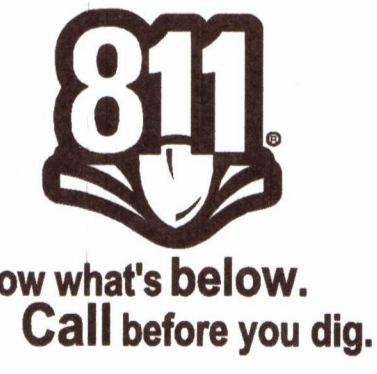

- NOTES:**
- NO TITLE WORK HAS BEEN SUPPLIED BY THE CLIENT FOR PURPOSES OF THIS SURVEY THEREFORE NO GUARANTEE IS MADE THAT ANY OR ALL EASEMENTS, BOTH RECORDED AND UNRECORDED ARE SHOWN ON THIS SURVEY.
 - THE LOCATION OF UTILITIES SHOWN ON THIS SURVEY, BOTH ABOVE AND BELOW GROUND, ARE SHOWN FROM INFORMATION OF RECORD SUPPLIED TO THE SURVEYOR AND A VISUAL INSPECTION OF THE PREMISES; NO GUARANTEE IS GIVEN AS TO THE COMPLETENESS AND ACCURACY THEREOF. EXACT LOCATION SHOULD BE VERIFIED IN THE FIELD WITH THE UTILITY COMPANY PRIOR TO ANY CONSTRUCTION WHICH MAY AFFECT THE UTILITY.

CONTRACTOR NOTE:
The locations of existing underground utilities are shown in an approximate way only. The contractor shall determine the exact location of all existing utilities before commencing work. He agrees to be fully responsible for any and all damages which might be occasioned by his failure to exactly locate and preserve any and all underground utilities.

PROJECT COORDINATE SYSTEM
MICHIGAN STATE PLANE COORDINATE SYSTEM, NAD83 (MI GEOID 18) (GRS80), SOUTH ZONE, INTERNATIONAL FEET, GRID.

