 **JLL** SEE A BRIGHTER WAY

# For lease

5,000 - 21,337 SF available

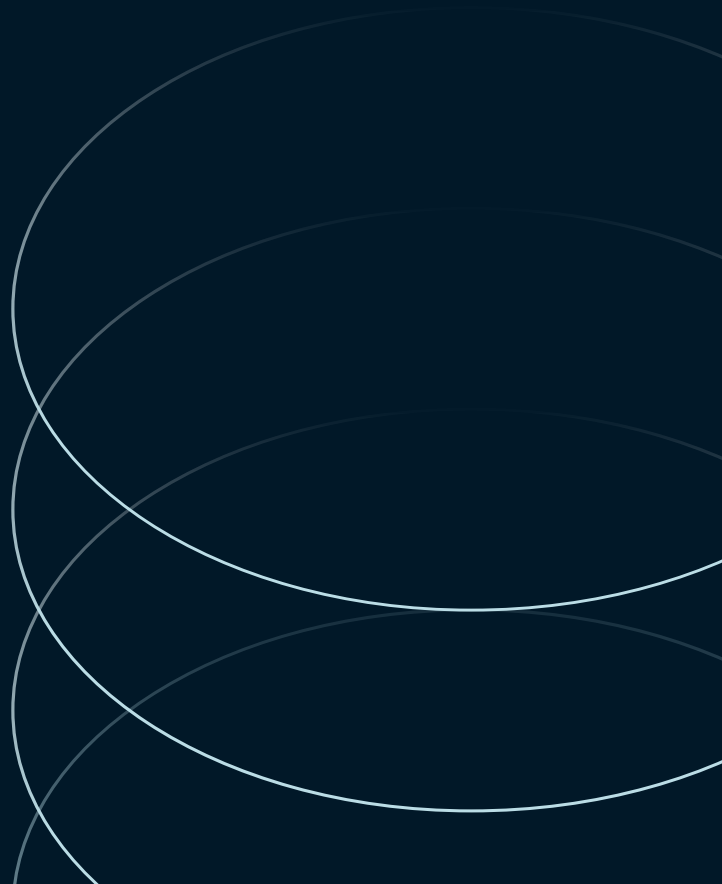



### Property specifications

- 3rd floor - 5,000 - 21,337 SF
- Monument signage available
- New lobby and common area finishes
- Fitness center with showers & lockers
- Grab & Go with outdoor seating
- Close to Routes 30, 202, & 100 and downtown West Chester

## 1475 Dunwoody Drive West Chester, PA







**1475 Dunwoody Drive  
West Chester, PA**

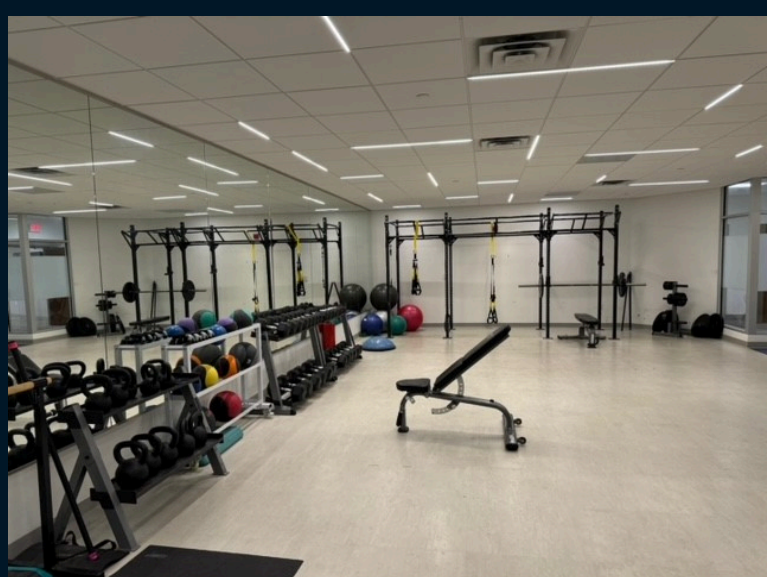



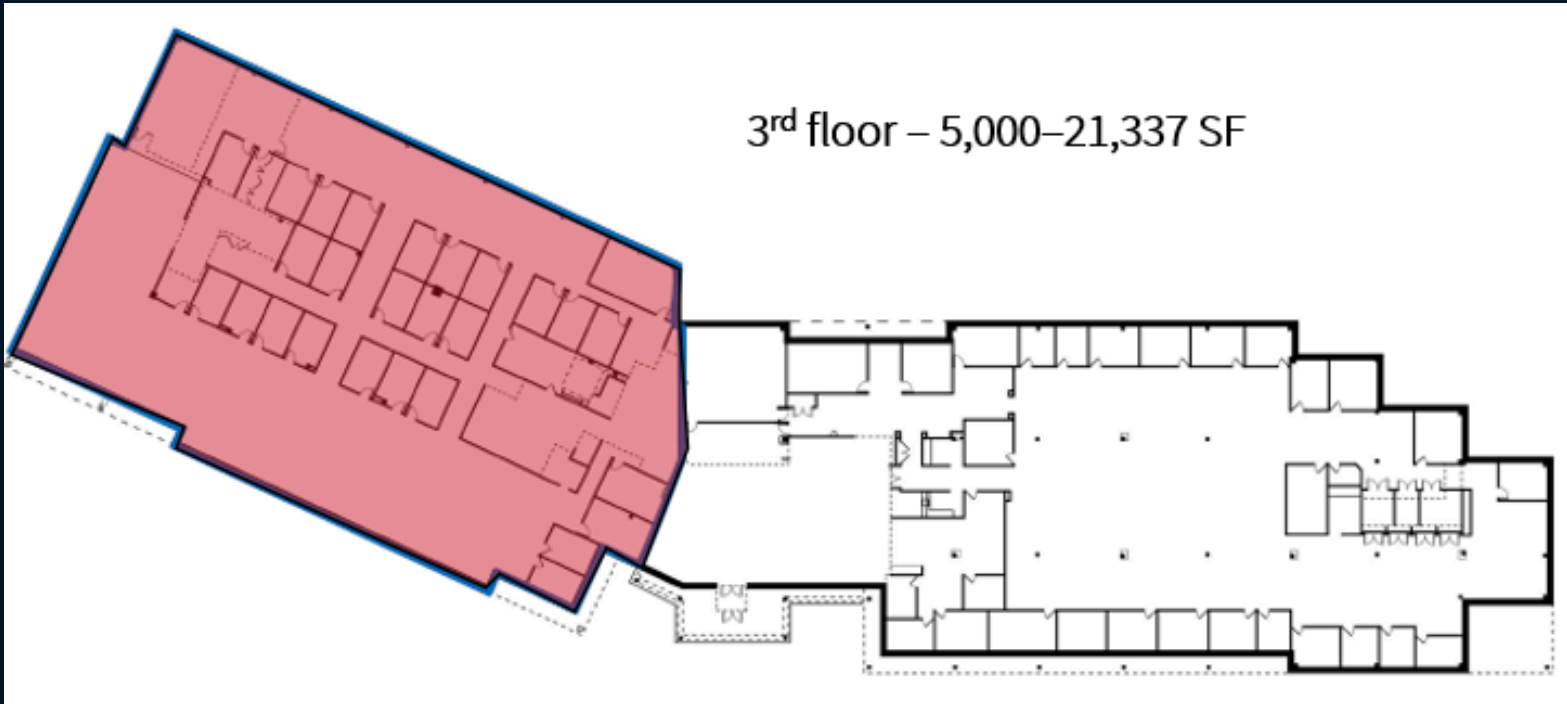

**Scott Williams**  
 Managing Director  
 scottA.williams@jll.com  
 +1 610 721 9912

**Adam Shute**  
 Executive Vice President  
 adam.shute@jll.com  
 +1 610 574 3869

**Jones Lang LaSalle Brokerage, Inc.**  
 550 E. Swedesford Road, Suite 260  
 Wayne, PA 19087  
 +1 610 249 2255