

FOR SALE:
10th St. & Pond Rd.
Ronkonkoma, NY

Last Large Developable Lot This West by the LIE with This Zoning

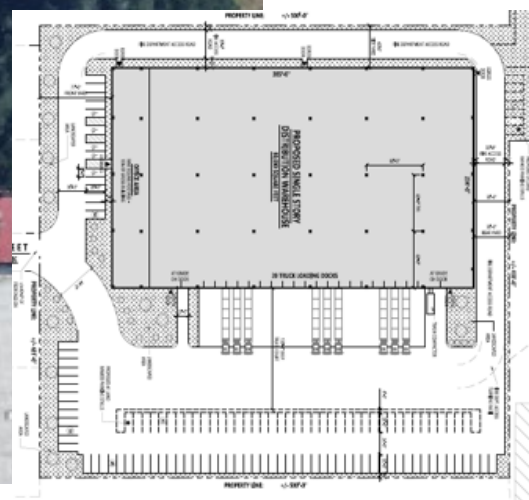

Property Description

- 6 Acres
- Rare L 2 Zoning
- 1 ½ Miles to LIE Exit 59
- Near Islip Airport and Ronkonkoma Hub Both Continuously Evolving

For More Information Contact Exclusive Broker:

MARIO ASARO  **SIOR**

PRESIDENT/ BROKER

📞 Cell: 631.553.7329

☎ Office: 631.694.3500 Ext 301

✉ masaro@industryone.com



SALE PRICING- \$12,495,000

**Specialists in
Office, Industrial, Retail &
Investment Real Estate Since 1985**

All information is from sources deemed reliable, and is submitted subject to errors, omissions, change of price, rental, prior sale and withdrawal without notice.

631-694-3500
www.industryone.com

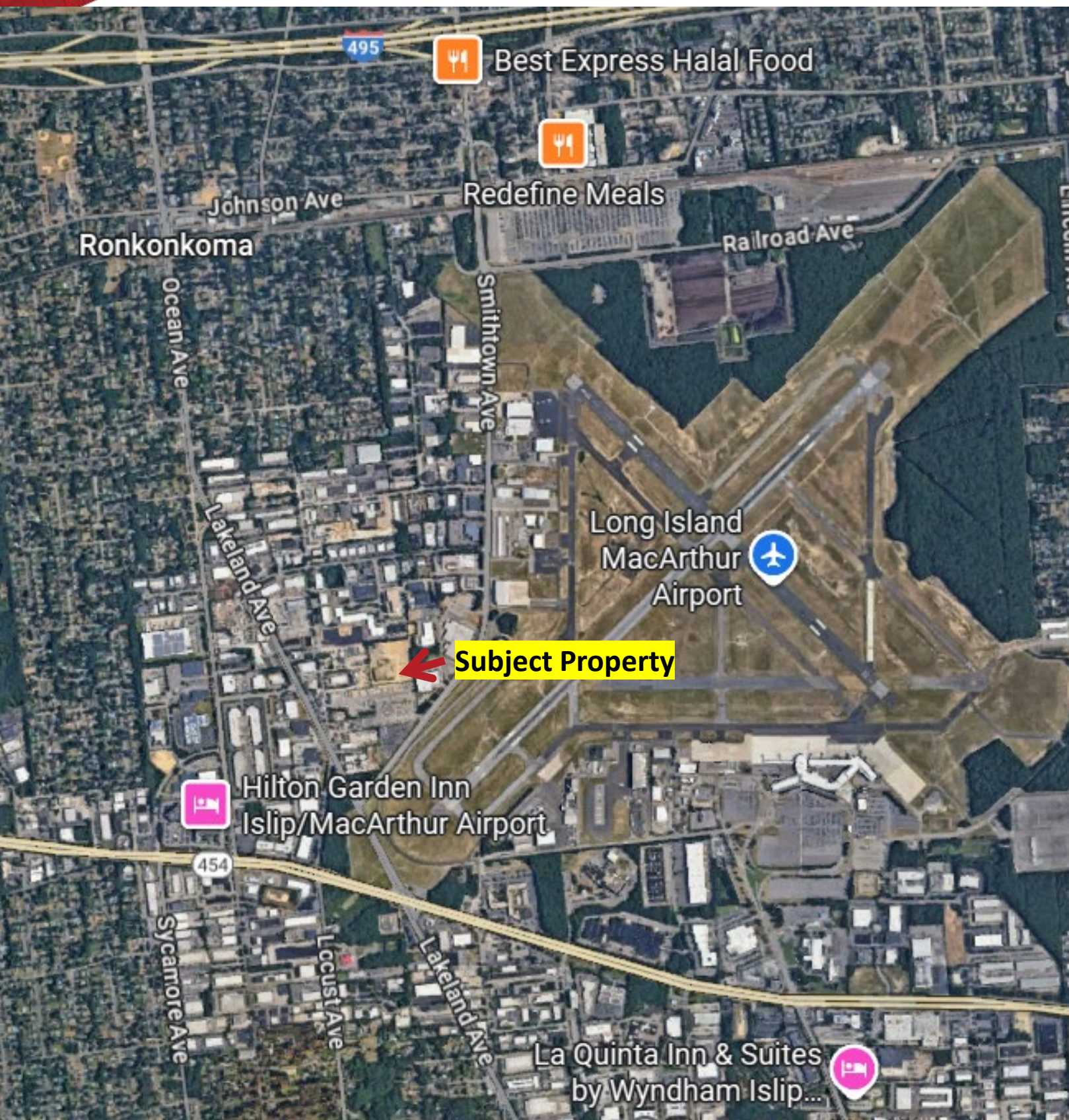

PROPOSED 90,090SF DISTRIBUTION WAREHOUSE

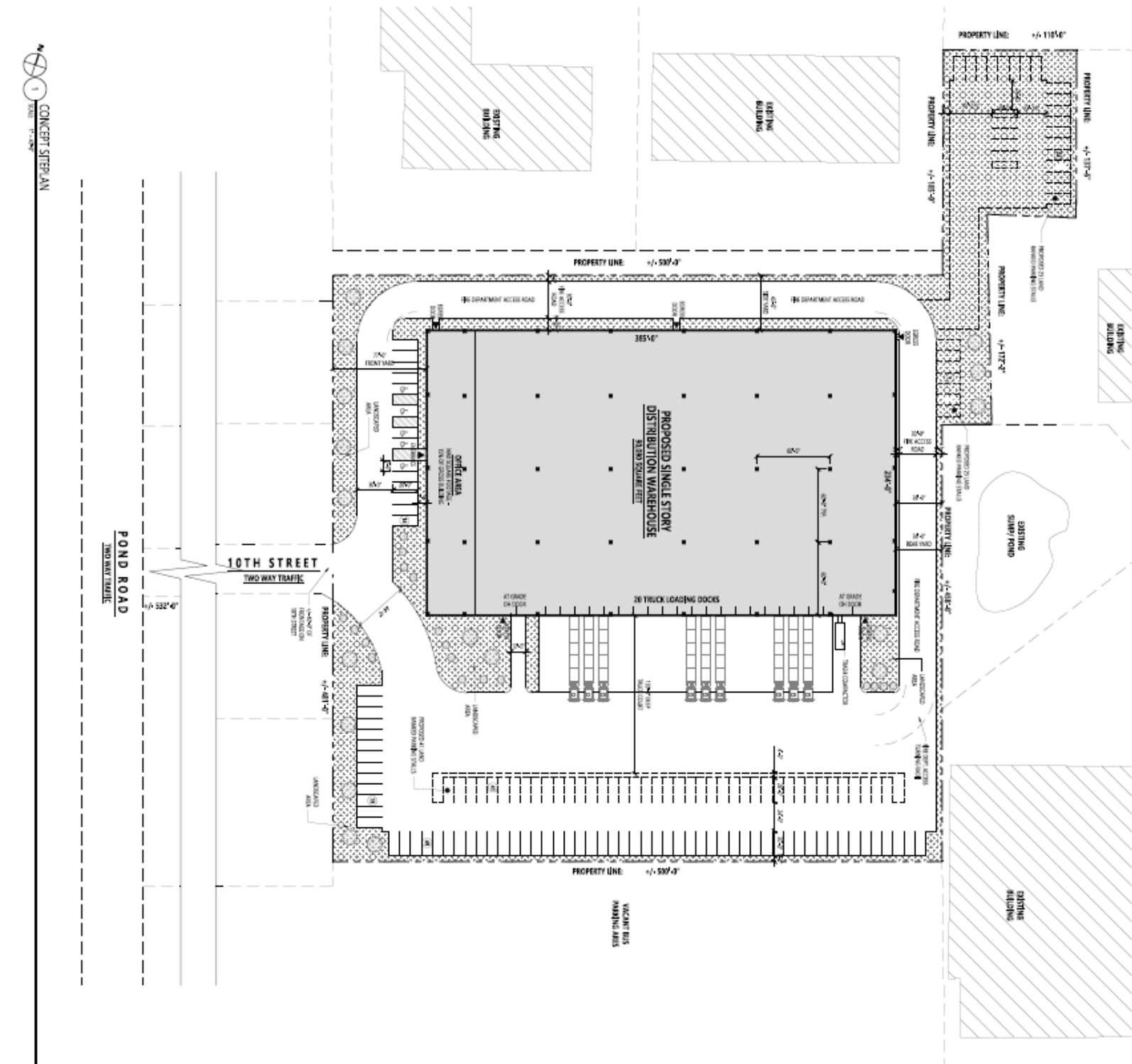

**Specialists in
Office, Industrial, Retail &
Investment Real Estate Since 1985**

All information is from sources deemed reliable, and is submitted subject to errors, omissions, change of price, rental, prior sale and withdrawal without notice.

631-694-3500
www.industryone.com

PROPOSED AUTOMOBILE PARKING FIELD WITH +/- 3,000SF WAREHOUSE



**Specialists in
Office, Industrial, Retail &
Investment Real Estate Since 1985**

*All information is from sources deemed reliable, and is submitted subject to
errors, omissions, change of price, rental, prior sale and withdrawal without notice.*

631-694-3500
www.industryone.com

PROPOSED AUTOMOBILE PARKING FIELD WITH +/- 12,000SF WAREHOUSE



Nearby Amenities A Transformational 53-Acre Development at the Ronkonkoma Hub



LIRR Ronkonkoma HUB



LI MacArthur Main Airport Terminal



**Specialists in
Office, Industrial, Retail &
Investment Real Estate Since 1985**

All information is from sources deemed reliable, and is submitted subject to errors, omissions, change of price, rental, prior sale and withdrawal without notice.

631-694-3500
www.industryone.com