

12102 Washington Blvd, Whittier, CA 90602

FOR SALE

4.62 Acres



PROPERTY FEATURES

- ▶ 4.62 acres available (201,011 SF of land)
- ▶ Close proximity to the 5 & 605 freeways
- ▶ 3 functional metal buildings totaling - 37,883 SF
- ▶ 3 office buildings totaling - 20,336 SF
- ▶ Site access from Washington Blvd & Rivera Rd
- ▶ Large secured yard
- ▶ Power - minimum 800 amps, 277/480 volts (verify)
- ▶ Owner/ User/ Investment/ Development Opportunity
- ▶ Asking Price - \$16,000,000 (\$79.60 per land SF)



**LUKE
MCDANIEL**

Sr. Managing Director
luke.mcdaniel@jll.com
+1 949 885 2974
RE License #01203625

**CAMERON
DRISCOLL**

Sr. Managing Director
cameron.driscoll@jll.com
+1 949 885 2976
RE License #01224141

**ASHLEY
RAMIREZ**

Sr. Associate
ashley.ramirez@jll.com
+1 949 885 2913
RE License #02106273

**ERIN
MCCLOSKEY**

Vice President
erin.mccloskey@jll.com
+1 949 930 7891
RE License #02244405

12102 Washington Blvd, Whittier, CA 90602

FOR SALE

4.62 Acres

SITE PLAN

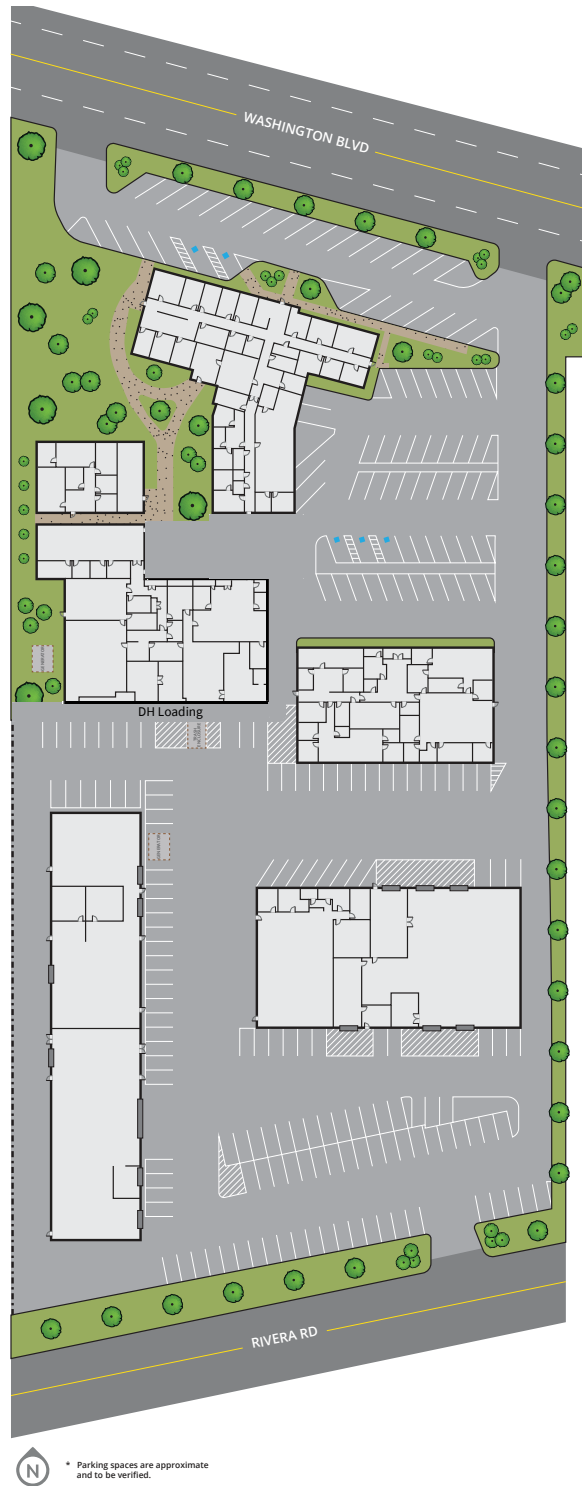

* Parking spaces are approximate and to be verified.



**LUKE
MCDANIEL**

Sr. Managing Director
luke.mcdaniel@jll.com
+1 949 885 2974
RE License #01203625

**CAMERON
DRISCOLL**

Sr. Managing Director
cameron.driscoll@jll.com
+1 949 885 2976
RE License #01224141

**ASHLEY
RAMIREZ**

Sr. Associate
ashley.ramirez@jll.com
+1 949 885 2913
RE License #02106273

**ERIN
MCCLOSKEY**

Vice President
erin.mccloskey@jll.com
+1 949 930 7891
RE License #02244405

12102 Washington Blvd, Whittier, CA 90602

FOR SALE

4.62 Acres



**LUKE
MCDANIEL**

Sr. Managing Director
luke.mcdaniel@jll.com
+1 949 885 2974
RE License #01203625

**CAMERON
DRISCOLL**

Sr. Managing Director
cameron.driscoll@jll.com
+1 949 885 2976
RE License #01224141

**ASHLEY
RAMIREZ**

Sr. Associate
ashley.ramirez@jll.com
+1 949 885 2913
RE License #02106273

**ERIN
MCCLOSKEY**

Vice President
erin.mccloskey@jll.com
+1 949 930 7891
RE License #02244405