

# 281 HANLEY INDUSTRIAL CT BRENTWOOD, MISSOURI

FOR LEASE



LCG  
CAPITAL  
MANAGEMENT

# 281 HANLEY INDUSTRIAL CT

## BUILDING PLAN + DETAILS

**TOMMY LEONARD**

314.408.7400 (OFFICE)

314.675.5240 (MOBILE)

TLeonard@LCGCap.com

**ROB GOLTERMANN**

314.408.7400 (OFFICE)

314.267.7497 (MOBILE)

Rob@LCGCap.com

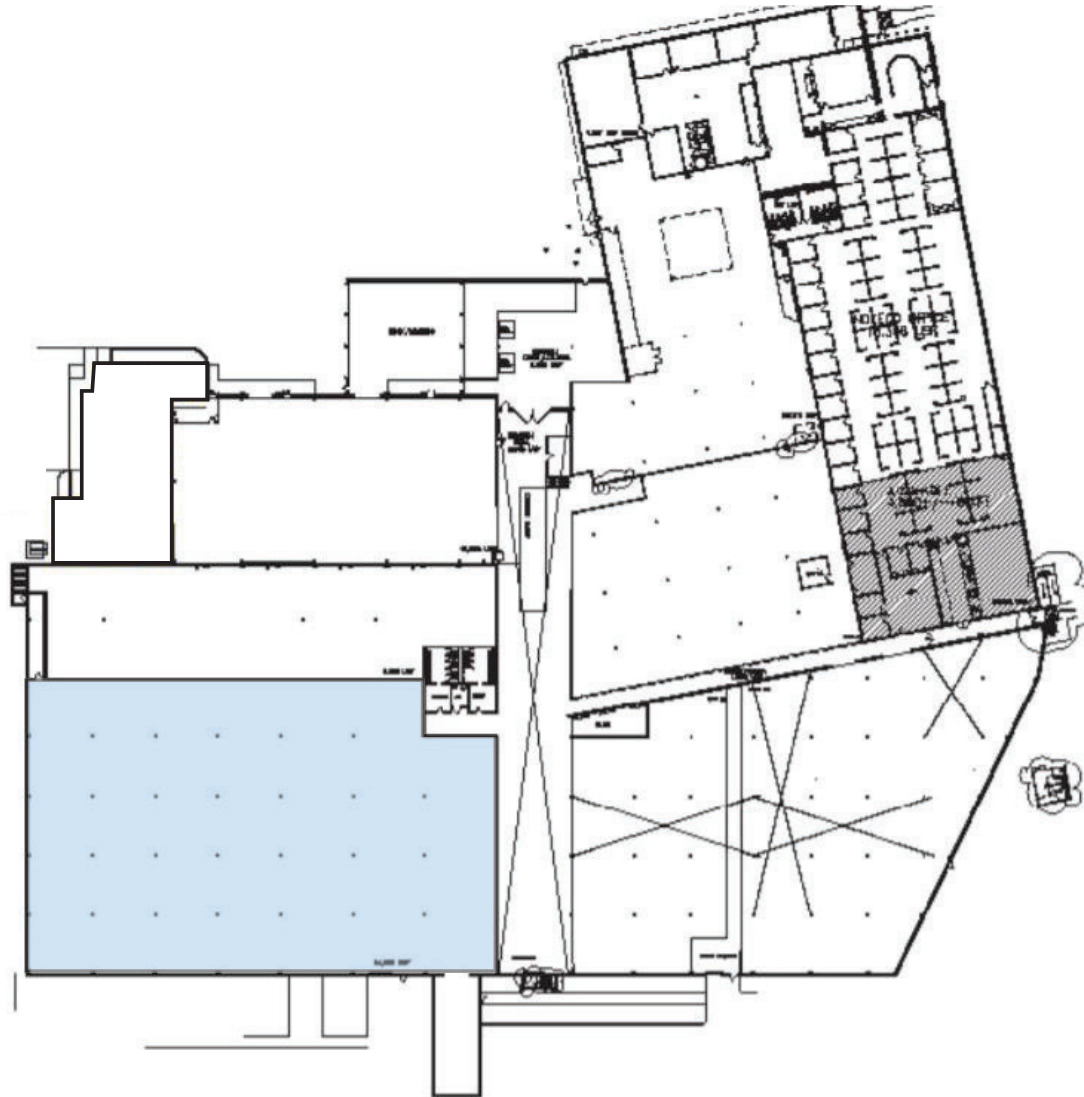

- FOR LEASE: \$7.95 PSF NNN
- 34,118 SF WAREHOUSE/SERVICE CENTER
- 5,163 SF FINISHED OFFICE OR SHOWROOM SPACE
- 28,955 SF WAREHOUSE SPACE
- MONUMENT SIGNAGE AVAILABLE
- 2 LOADING DOCKS
- 1 DRIVE-IN
- 24' CLEAR CEILING
- LOCATED IN HANLEY INDUSTRIAL PARK, NEAR I-64 & HANLEY ROAD
- 1 MILLION PEOPLE IN A 10 MILE RADIUS
- \$110,000 AVERAGE HOUSEHOLD INCOME IN 2 MILES
- CLOSE PROXIMITY TO CLAYTON BUSINESS DISTRICT, METROLINK, RESTAURANTS, APARTMENTS AND OTHER AMENITIES

**LCG CAPITAL  
MANAGEMENT**

[www.LCGCap.com](http://www.LCGCap.com)

THE INFORMATION IN THIS FLYER HAS BEEN OBTAINED FROM SOURCES BELIEVED RELIABLE. WHILE WE DO NOT DOUBT ITS ACCURACY, WE HAVE NOT VERIFIED IT AND MAKE NO GUARANTEE ABOUT IT. IT IS YOUR RESPONSIBILITY TO INDEPENDENTLY CONFIRM ITS ACCURACY AND COMPLETENESS. ANY PROJECTIONS, OPINIONS, ASSUMPTIONS OR ESTIMATES USED ARE FOR EXAMPLE ONLY AND DO NOT REPRESENT THE CURRENT OR FUTURE PERFORMANCE OF THE PROPERTY. THE VALUE OF THIS TRANSACTION TO YOU DEPENDS ON TAX AND OTHER FACTORS WHICH SHOULD BE EVALUATED BY YOUR TAX, FINANCIAL AND LEGAL ADVISORS. YOU AND YOUR ADVISORS SHOULD CONDUCT A CAREFUL, INDEPENDENT INVESTIGATION OF THE PROPERTY TO DETERMINE TO YOUR SATISFACTION THE SUITABILITY OF THE PROPERTY FOR YOUR NEEDS.

# 281 HANLEY INDUSTRIAL CT

## MARKET AERIAL

**TOMMY LEONARD**

314.408.7400 (OFFICE)  
 314.675.5240 (MOBILE)  
 TLeonard@LCGCap.com

**ROB GOLTERMANN**

314.408.7400 (OFFICE)  
 314.267.7497 (MOBILE)  
 Rob@LCGCap.com

