

FOR SALE

6.49-ACRES LOT with APN: 8276-001-023

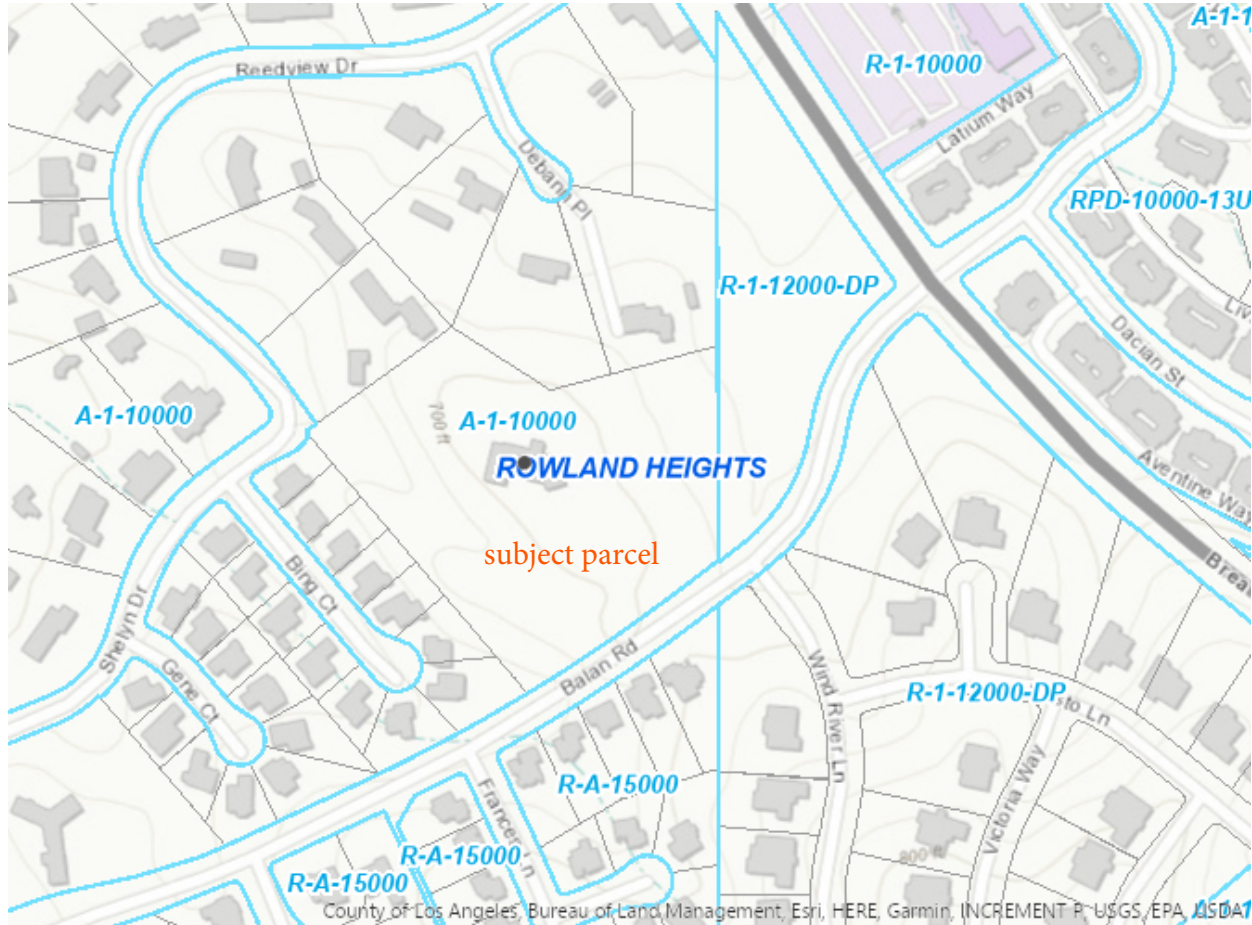

19650 Reedview Dr. | ROWLAND HEIGHTS, CA 91748

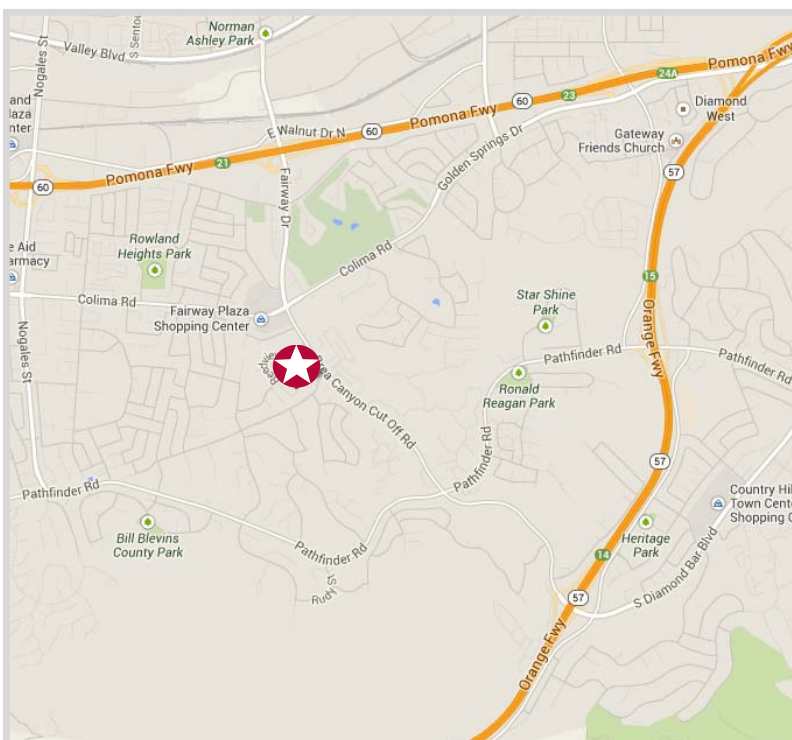

OVERVIEW

- High-End SFR Neighborhood, across from Hilltop Estate by K. Hovnanian
- Walking Distance to Fairway Plaza Shopping Center at Colima Rd. & Brea Canyon Cutoff
- Under New East San Gabriel Valley Area Plan
- LA County Zoning: A-1-10000
- Rare Development Site with Potential View Lots & A Gated Community
- Adjacent 3.5 A Land is Also Available

CONTACT

For More Information, Please Contact:

Shan Lee/Principal email: slee@kanderpacific.com

(O): 626.839.6689 (C): 626.823.1580

CA BRE # 02014105/00999585



REALTY • INVESTMENT • MANAGEMENT