



INDUSTRIAL WAREHOUSE

26609

NEWBANKS ROAD

Abingdon, VA 24210

CBRE

Affiliated Business Disclosure

© 2025 CBRE, Inc. (“CBRE”) operates within a global family of companies with many subsidiaries and related entities (each an “Affiliate”) engaging in a broad range of commercial real estate businesses including, but not limited to, brokerage services, property and facilities management, valuation, investment fund management and development. At times different Affiliates, including CBRE Global Investors, Inc. or Trammell Crow Company, may have or represent clients who have competing interests in the same transaction. For example, Affiliates or their clients may have or express an interest in the property described in this Memorandum (the “Property”) and may be the successful bidder for the Property. Your receipt of this Memorandum constitutes your acknowledgment of that possibility and your agreement that neither CBRE nor any Affiliate has an obligation to disclose to you such Affiliates’ interest or involvement in the sale or purchase of the Property. In all instances, however, CBRE and its Affiliates will act in the best interest of their respective client(s), at arms’ length, not in concert, or in a manner detrimental to any third party. CBRE and its Affiliates will conduct their respective businesses in a manner consistent with the law and all fiduciary duties owed to their respective client(s).

Confidentiality Agreement

Your receipt of this Memorandum constitutes your acknowledgment that (i) it is a confidential Memorandum solely for your limited use and benefit in determining whether you desire to express further interest in the acquisition of the Property, (ii) you will hold it in the strictest confidence, (iii) you will not disclose it or its contents to any third party without the prior written authorization of the owner of the Property (“Owner”) or CBRE, Inc. (“CBRE”), and (iv) you will not use any part of this Memorandum in any manner detrimental to the Owner or CBRE.

If after reviewing this Memorandum, you have no further interest in purchasing the Property, kindly return it to CBRE.

Disclaimer

This Memorandum contains select information pertaining to the Property and the Owner and does not purport to be all-inclusive or contain all or part of the information which prospective investors may require to evaluate a purchase of the Property. The information contained in this Memorandum has been obtained from sources believed to be reliable, but has not been verified for accuracy, completeness, or fitness for any particular purpose. All information is presented “as is” without representation or warranty of any kind. Such information includes estimates based on forward-looking assumptions relating to the general economy, market conditions, competition and other factors which are subject to uncertainty and may not represent the current or future performance of the Property. All references to acreages, square footages, and other measurements are approximations. This Memorandum describes certain documents, including leases and other materials, in summary form. These summaries may not be complete nor accurate descriptions of the full agreements referenced. Additional information and an opportunity to inspect the Property may be made available to qualified prospective purchasers. You are advised to independently verify the accuracy and completeness of all summaries and information contained herein, to consult with independent legal and financial advisors, and carefully investigate the economics of this transaction and Property’s suitability for your needs. ANY RELIANCE ON THE CONTENT OF THIS MEMORANDUM IS SOLELY AT YOUR OWN RISK.

The Owner expressly reserves the right, at its sole discretion, to reject any or all expressions of interest or offers to purchase the Property, and/or to terminate discussions at any time with or without notice to you. All offers, counteroffers, and negotiations shall be non-binding and neither CBRE, Inc. nor the Owner shall have any legal commitment or obligation except as set forth in a fully executed, definitive purchase and sale agreement delivered by the Owner.

CONTENTS

- 01 Investment Summary
- 02 Building Overview
- 03 Building Photos
- 04 Racking Plan
- 05 Floor Plan
- 06 Site Plan & Aerials
- 07 Location Overview

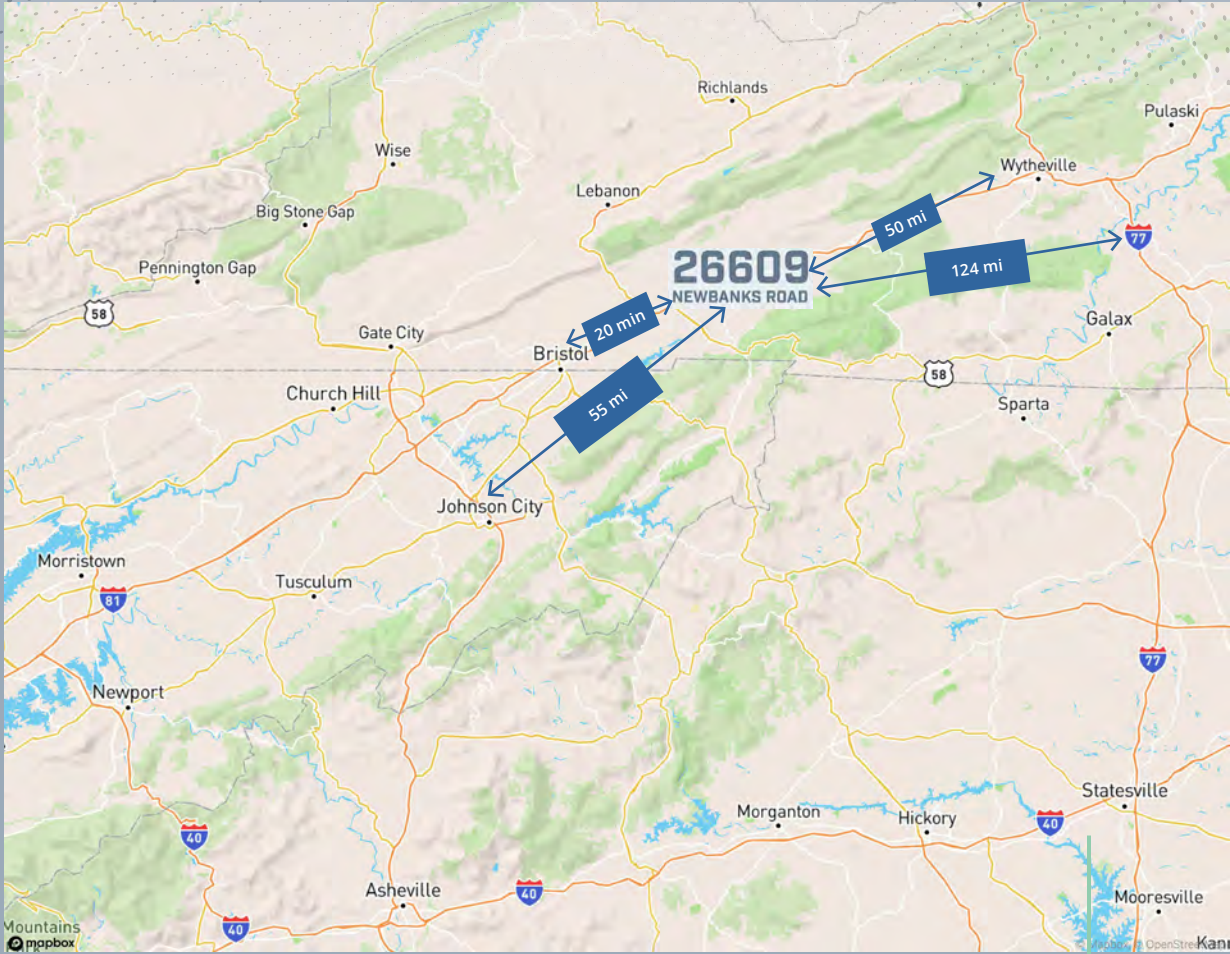

26609

NEWBANKS ROAD



01

INVESTMENT SUMMARY

INVESTMENT SUMMARY

Investment Highlights

HEAVY FREIGHT AND LOGISTICS HUB

- Situated less than 1-mile from Interstate 81 (which sees over 44,300 vehicles per day) the property benefits from being geographically central to the Eastern markets.

MULTIPLE USE WAREHOUSE

- The Subject Property was a former fully frozen warehouse. With the insulation and flooring in place to sustain sub 0 temperature ranges, the building can easily be converted to a refrigerated/frozen warehouse again. New Freon refrigeration can be installed at the close of escrow, providing a below replacement cost cold storage warehouse.

DYNAMIC MULTI MARKET LOCATION

- Abington is Included in the Kingsport-Bristol (TN)- Bristol (VA) Metropolitan Statistical Area Which is Home to 309,544 Residents.

WORKFORCE GROWTH FOCUSED MARKET

- A new 87,000 sq ft Regional Workforce and Child Development Hub was announced in 2024 by The Innovate Fund (TIF) with a \$5.5M investment to further support EO Companies, a Virginia-based 501c3 non-profit organization with a mission to research, pilot, and scale innovative solutions so that communities are thriving and people are well. EO has a 60-year history of developing innovative programs, including the Regional Workforce and Child Development Hub, the Rural Summit, and Ignite Career Commons. EO challenges the status quo and brings positive change to local economies by working with private, public, and philanthropic partner.



PRICING
\$2,100,000



BUILDING SF
± 34,000 SF



LOT SIZE
2.98 acres



YEAR BUILT
2000



02

BUILDING
OVERVIEW

BUILDING OVERVIEW



PROPERTY ADDRESS
26609 Newbanks Rd
Abingdon, VA 24210



BUILDING SF
±34,000 SF



YEAR BUILT
2000



TOTAL AREA
129,809 SF (2.98 AC)



ZONING
M-1 - Light Industrial



CONSTRUCTION TYPE
Prefabricated Metal



COLUMNS
60'W



DOCK DOORS
4 (8' x 12')



DRIVE INS
1 Tot. / 14' W x 12' H



PARKING
± 15 spaces



CLEAR HEIGHTS
30'



POWER
400-1,800A /
120-208V 3P 4W Heavy



REFRIGERATION SYSTEM
Freon*



PALLET POSITIONS
±1,853



CUBIC FEET
741,000



03

BUILDING
PHOTOS

INTERIOR PHOTOS

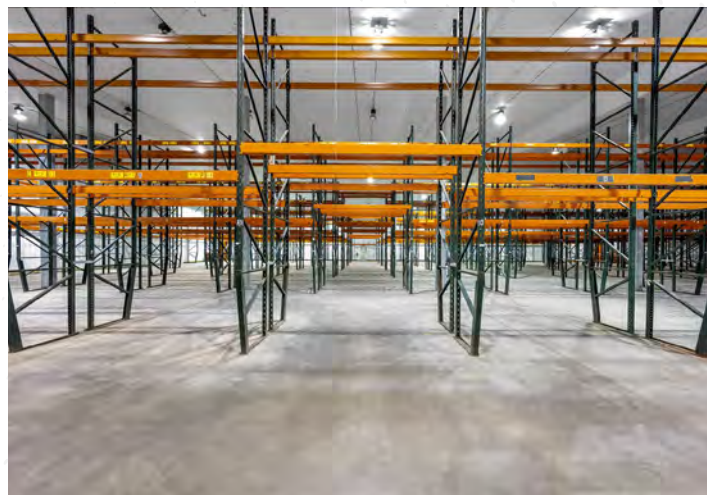

EXTERIOR PHOTOS





04

RACKING
PLAN

RACKING PLAN

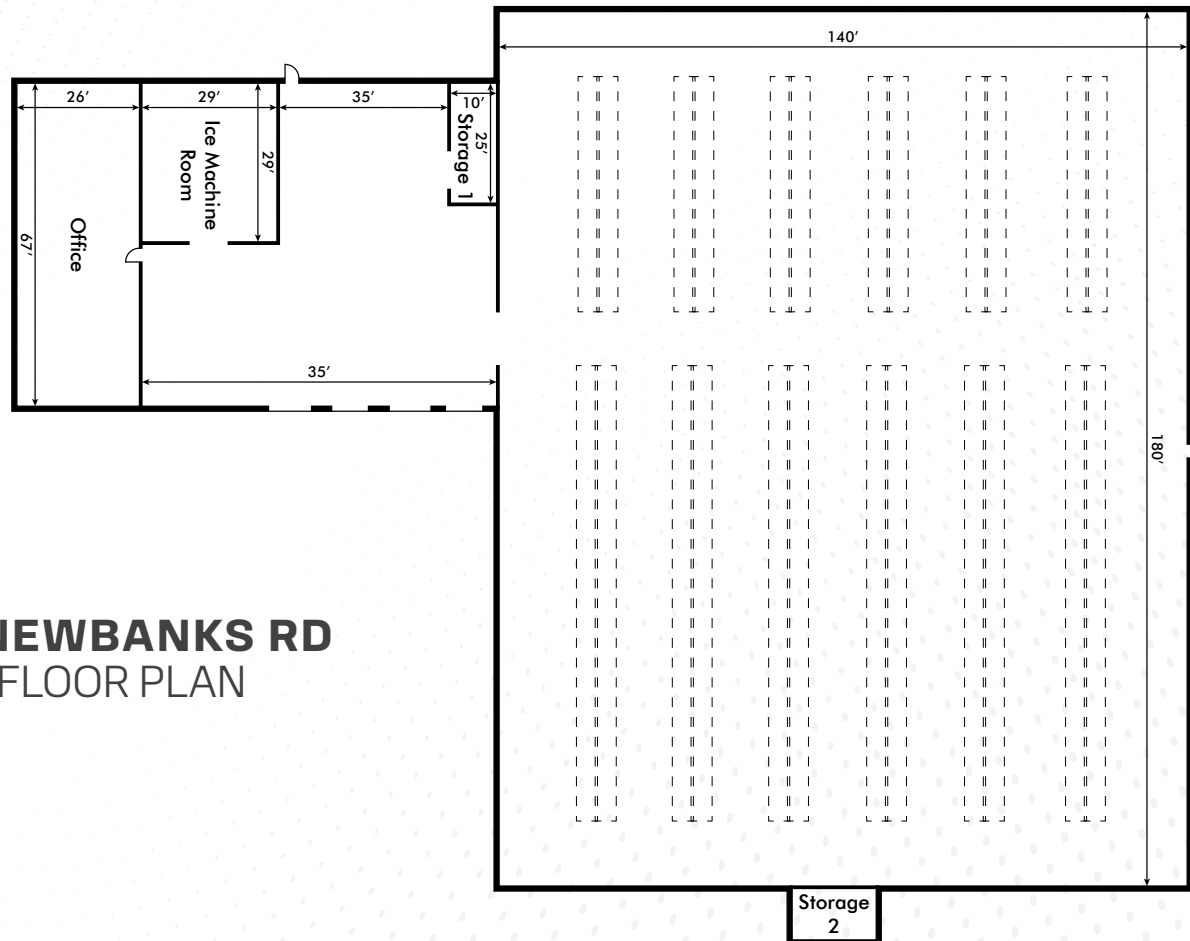

26609 NEWBANKS RD
RACKING FLOOR PLAN



05

FLOOR
PLAN

FLOOR PLAN

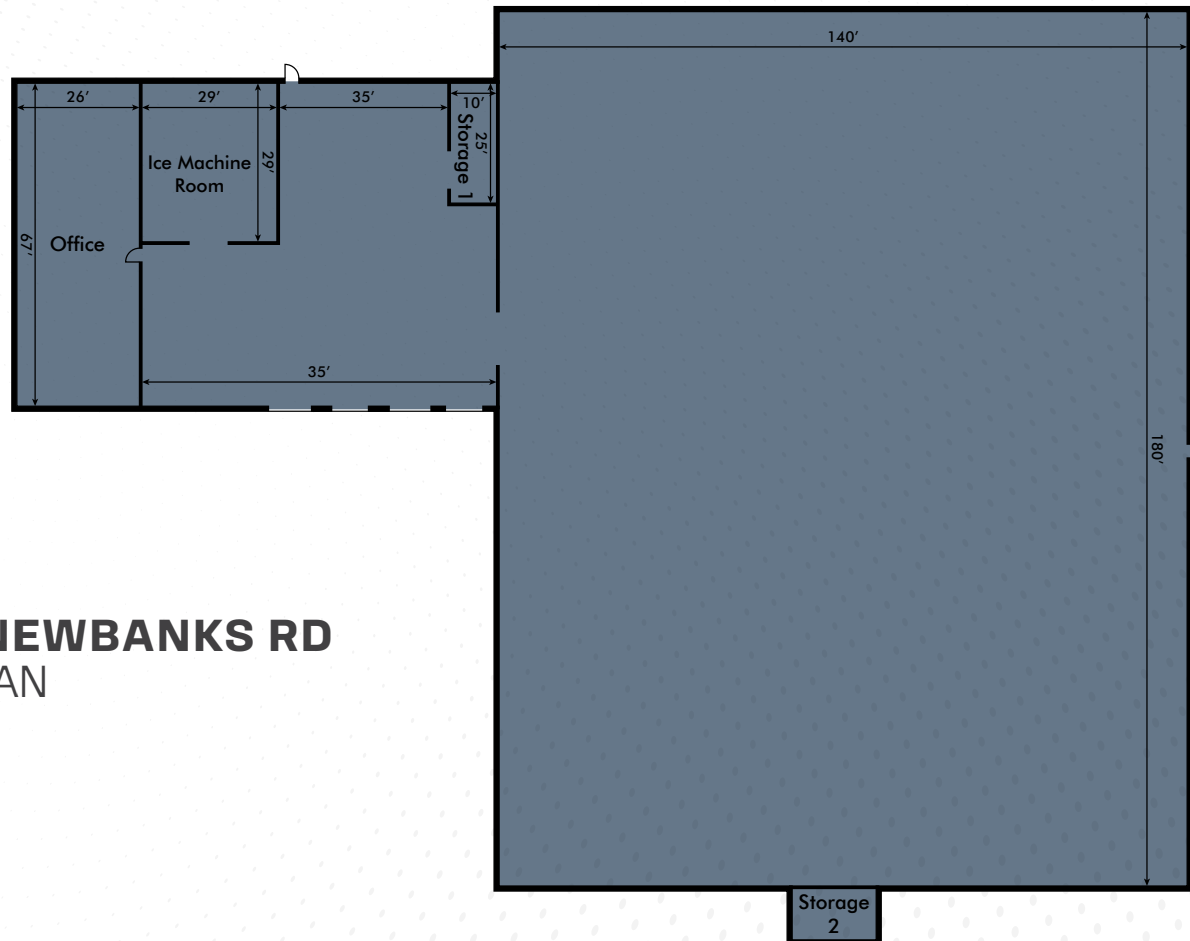

26609 NEWBANKS RD
FLOOR PLAN



06

SITE PLAN &
AERIALS

SITE PLAN

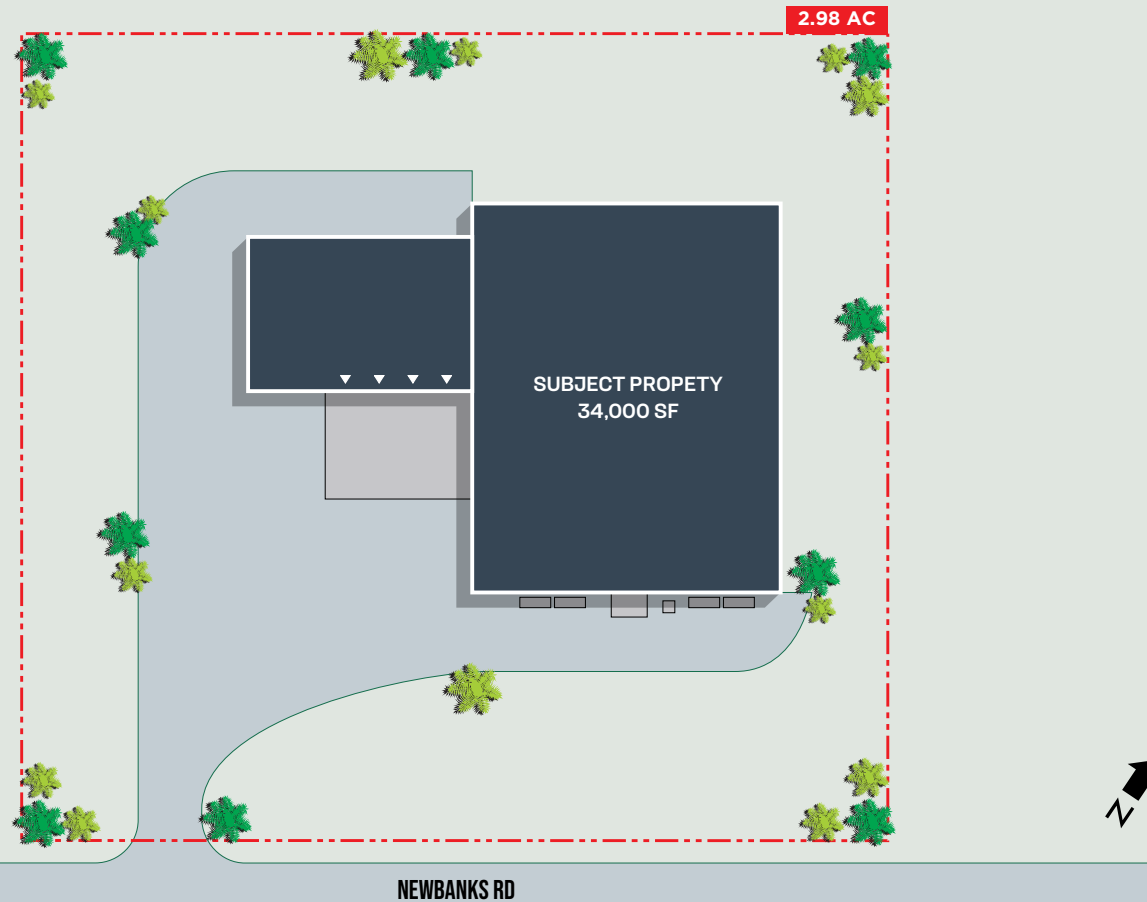

AERIALS



(40,000 VPD)

Newbanks Rd

26609
NEWBANKS ROAD



AERIALS



Newbanks Rd



26609
NEWBANKS ROAD

0.5 MI	0.7 MI
0.8 MI	0.8 MI
0.9 MI	1.1 MI
0.9 MI	



07

LOCATION
OVERVIEW

LOCATION OVERVIEW

OVERVIEW

Abingdon is a town in Washington County, VA. The small town is located 133 Miles southwest of Roanoke. The population was estimated to be around 8,295 residents in the 2025 census. The town is the county seat of Washington County. The town encompasses several historically significant sites and features a fine arts and crafts scene centered on the galleries and museums along Main Street. Abingdon is part of the Kingsport–Bristol (TN)–Bristol (VA) Metropolitan Statistical Area, which is a component of the Johnson City–Kingsport–Bristol, TN–VA Combined Statistical Area – commonly known as the “Tri-Cities” region.

Due to the city’s close proximity, Kingsport, TN affects Abingdon’s economy. Kingsport is the headquarters of Eastman Chemical Company which produces a broad range of advanced materials, chemicals and fibers for everyday purposes. Domtar operates the Kingsport Mill at which the company produces uncoated freesheet. The city is also home to the Holston Army Ammunition Plant operated by BAE Systems’ Ordnance Systems, Inc. manufactures a wide range of secondary detonating explosives for the Department of Defense. The city is also home to branch campuses of the following institutions: East Tennessee State University, King University, Lincoln Memorial University, Milligan College and Northeast State Community College.

Major manufacturing and distribution entities in the Abingdon/Washington County Region include Bristol Compressors (hermetic compressors), Mid Mountain Foods (Grocery Distribution), K-VA-T/Food City (Corporate HQ and operations), Universal Fibers (Synthetic yarn manufacturing) and numerous other house hold names.

Abingdon is about a 35 minute drive to Kingsport, TN, which is a perfect place to spend the day. Kingsport is home to Bays Mountain Park which is a 3,550 acres nature park and planetarium. The park features cross-cut viewing sections of beaver dams, bee hives, cave systems, a nature center and outdoor native animal displays. The city is also near the Gray Site which is a Pliocene–epoch assemblage of fossils. The city is home to the Kingsport Carousel and Park which was a park that included picnic tables, a playground and a carousel for families to enjoy. The city also includes the Kingsport Greenbelt which is a trail through the forests where people can walk, run and bike. The trail passes by lakes where people can enjoy fishing.

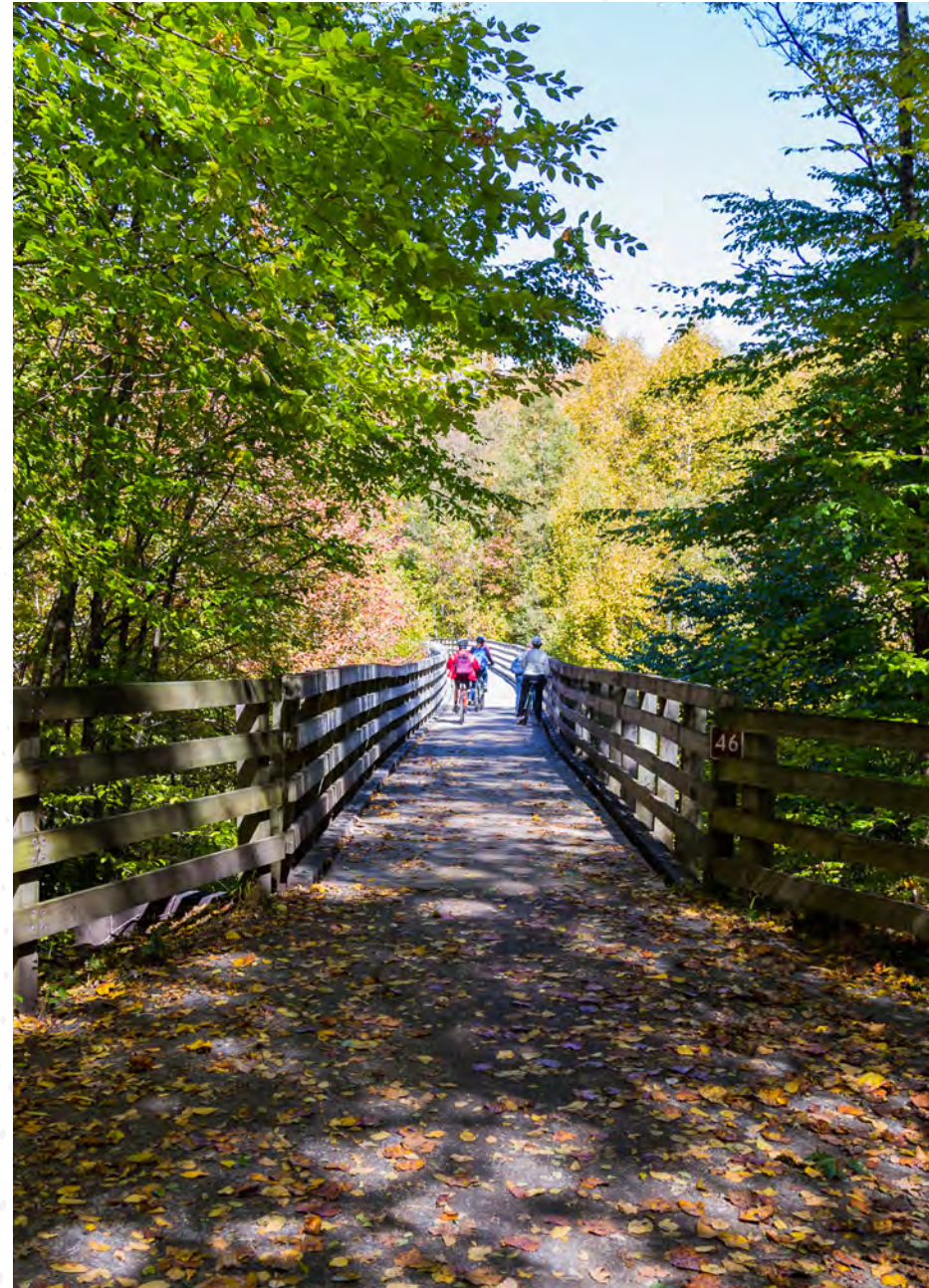

DEMOGRAPHICS

POPULATION

	1 MILE	3 MILES	5 MILES
2029 Projection	1,851	14,131	35,702
2024 Estimate	1,872	14,238	32,915
2020 Census	1,959	14,662	36,706
Growth 24' - 29'	- 0.2%	- 0.2%	- 0.1%
Growth 20' -24'	- 1.1%	- 0.7%	- 0.5%

HOUSEHOLDS

	1 MILE	3 MILES	5 MILES
2029 Projection	773	5,627	14,934
2024 Estimate	781	5,673	15,026
2020 Census:	817	5,861	15,378
Growth 24' - 29'	- 0.2%	- 0.2%	- 0.1%
Growth 20' -24'	- 0.6%	- 0.1%	- 0.2%
Average Income	\$72,457	\$75,307	\$76,182
Median Income	\$55,853	\$57,195	\$57,256



26609
NEWBANKS ROAD



INVESTMENT CONTACTS

James Watkins

Associate
+1 661 904 9401
Lic. 02123733
james.watkins@cbre.com

Tony Anderson

Senior Vice President
+1 310 303 9870
Lic. 01936642
t.anderson@cbre.com

Richard Brehaut

Senior Vice President
+1 909 560 3010
Lic. 01934760
richard.brehaut@cbre.com

Nate Barnes

Senior Associate
+1 818 255 8865
Lic. 01908103
nate.barnes@cbre.com

Kent Presson

Senior Transaction Manager
+1 916 471 8780
Lic. 02076597
kent.presson@cbre.com

BROKER OF RECORD

Jason L. Hetherington, SIOR

Senior Vice President
+1 804 301 0599
Lic. 0225063421
jason.hetherington@cbre.com

Doug Tice

Senior Associate
+1 804 280 2252
Lic. 0225247834
doug.tice@cbre.com

CBRE

© 2025 CBRE, Inc. CBRE, Inc. All rights reserved. This information has been obtained from sources believed reliable but has not been verified for accuracy or completeness. CBRE, Inc. makes no guarantee, representation or warranty and accepts no responsibility or liability as to the accuracy, completeness, or reliability of the information contained herein. You should conduct a careful, independent investigation of the property and verify all information. Any reliance on this information is solely at your own risk. CBRE and the CBRE logo are service marks of CBRE, Inc. All other marks displayed on this document are the property of their respective owners, and the use of such logos does not imply any affiliation with or endorsement of CBRE. Photos herein are the property of their respective owners. Use of these images without the express written consent of the owner is prohibited.