

LEGACY AT UNIVERSITY PARK



WEST ELEVATION



EAST ELEVATION

FOR LEASE

980 S. University Park Blvd., Clearfield, UT 84015

Lease Rate: \$30.00/SF NNN

- 8,012 SF class A office at University Park
- Approximately 2,893 SF available for lease
- Now leasing | delivery October 1, 2026
- Eyebrow signage available | direct entrance suite
- Approximately two miles between I-15 and Hill Air Force Base
- Located directly across the street from Weber State Davis Campus

SURROUNDING AMENITIES



BRAXTON WILLIE, CCIM
bwillie@newmarkmw.com
direct 801.803.3334
[View Profile](#)

CHRIS FALK, CCIM, SIOR
cfalk@newmarkmw.com
direct 801.499.6514
[View Profile](#)

**FULL SERVICE
COMMERCIAL REAL ESTATE**
1410 S University Park Blvd, Ste 120
Clearfield, Utah 84015
Office 801.578.5580
www.newmarkmw.com

LEGACY AT UNIVERSITY PARK

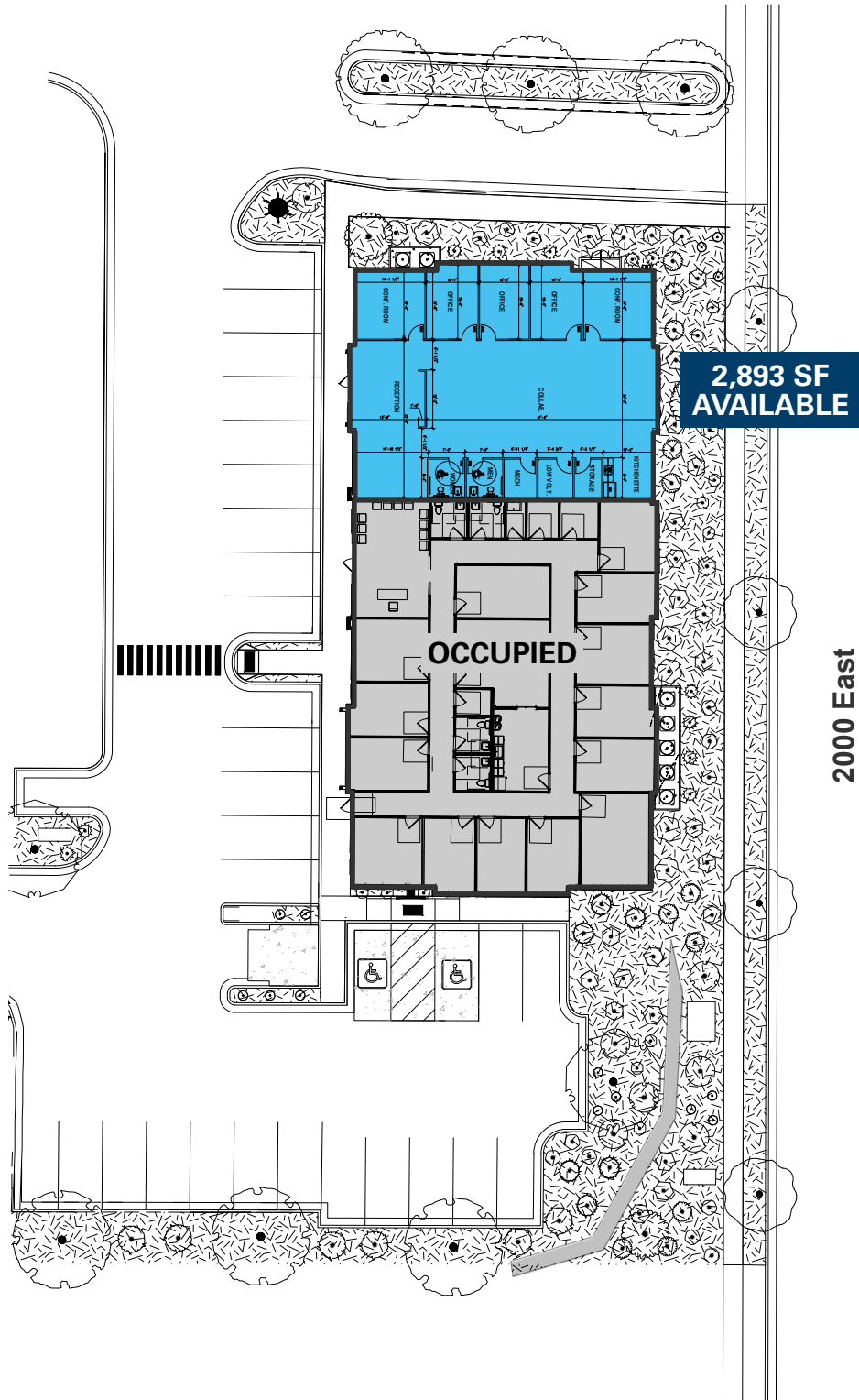

BRAXTON WILLIE, CCIM
bwillie@newmarkmw.com
direct 801.803.3334
[View Profile](#)

CHRIS FALK, CCIM, SIOR
cfalk@newmarkmw.com
direct 801.499.6514
[View Profile](#)

**FULL SERVICE
COMMERCIAL REAL ESTATE**
1410 S University Park Blvd, Ste 120
Clearfield, Utah 84015
Office 801.578.5580
www.newmarkmw.com



BRAXTON WILLIE, CCIM
 bwillie@newmarkmw.com
 direct 801.803.3334
[View Profile](#)

CHRIS FALK, CCIM, SIOR
 cfalk@newmarkmw.com
 direct 801.499.6514
[View Profile](#)

**FULL SERVICE
 COMMERCIAL REAL ESTATE**
 1410 S University Park Blvd, Ste 120
 Clearfield, Utah 84015
 Office 801.578.5580
www.newmarkmw.com