

THE OPPORTUNITY

Positioned at the epicenter of one of Central Texas's explosive growth regions, this 14.82-acre tract offers a rare opportunity for visionary development. Surrounded by leading industries, cutting-edge innovation hubs, and one of the region's strongest employment corridors, the site truly sits at "the hole in the donut" of Round Rock's dynamic business landscape.

This premier location allows a major employer or developer to control their own destiny—whether expanding operations or establishing a flagship presence in one of Texas's most vibrant markets. The area's deep talent pool, combined with immediate access to exceptional retail, dining, and lifestyle amenities, ensures both workforce satisfaction and long-term value.

Capitalize on Central Texas's momentum and position your business at the center of innovation, growth, and opportunity.

The District
(Development
in Progress)

.8 Miles to SH-45

IDEA Round Rock Tech

14.82 Acres

.9 miles to IH-35

ASSET PROFILE

ADDRESS: 3401 GREENLAWN BLVD
ROUND ROCK, TX 78664

SITE SIZE: 14.82 ACRES

UTILITIES: Water: City of Round Rock
Wastewater: Windemere
IDEA Water & Wastewater
Located on the east side of the tract

PRICE: Contact Agent

HIGHLIGHTS

- Unmatched accessibility in the heart of Round Rock’s business corridor
- PUD Agreement with the City of Round Rock to be amended
- Quick access to IH-35, SH-45, with easy access to Loop 1 (Mopac) and 130
- Ideal for mixed-use development

DEMOGRAPHICS	1 MILE	3 MILES	5 MILES
Total Households	4,202	44,203	102,642
Total Population	10,019	108,338	261,276
Average HH Income	107,483	115,043	126,452

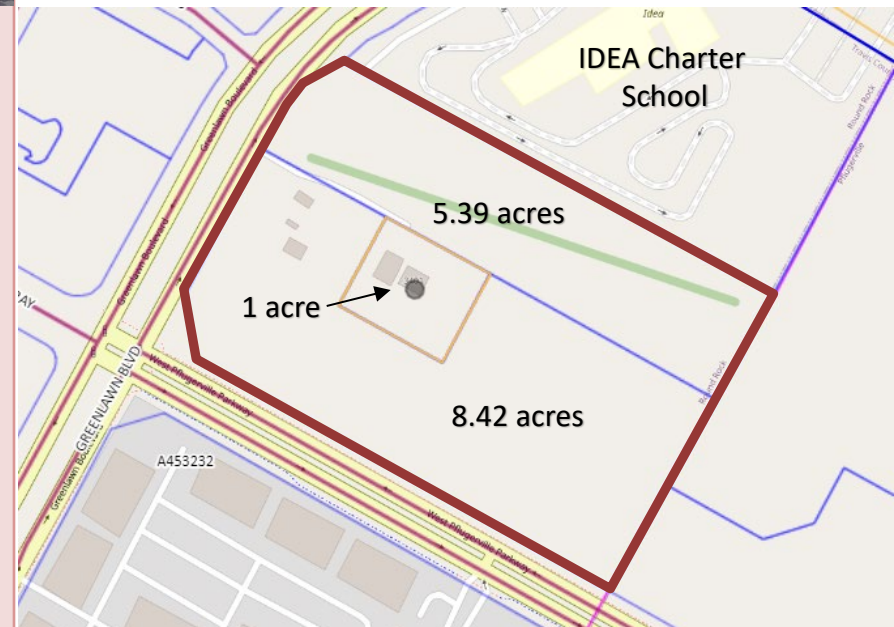



ZONING EXHIBIT

SHEET 3 OF 3

LEGEND

- (WC) WILLIAMSON COUNTY
- (TC) TRAVIS COUNTY
- DR DEED RECORDS
- OPR OFFICIAL PUBLIC RECORDS
- CM CONTROLLING MONUMENT
- PR PLAT RECORDS
- P.O.B. POINT OF BEGINNING

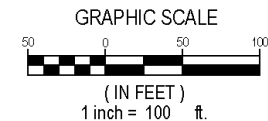

GREENLAWN BOULEVARD
(120' R.O.W.)

LOT 2, BLOCK A
LOT 1, BLOCK A
IDEA GREENLAWN SUBDIVISION
DOCUMENT NO. 2019082713, OPR

REMAINDER OF 43 ACRES
1/3 INTEREST VOL. 985, PG. 442, DR (WC)
1/3 INTEREST DOC. 2010099769, OPR (TC)
1/3 INTEREST DOC. NO. 2010099770, OPR (TC)

KAREN ALICE LEPPIN JONES
1 ACRE
VOLUME 7619, PAGE 982, DR (TC)

14.4 ACRES

DAVID WILSON LEPPIN
REMAINDER OF 16 ACRES
VOLUME 7489, PAGE 534, DR (TC)

P.O.B.

W PFLUGERVILLE PARKWAY
(120' R.O.W.)

SOCRATES' DARING SURVEY NO. 102
ABSTRACT NO. 232, TRAVIS CO., TX

REFERENCE IS HEREBY MADE TO THE METES AND BOUNDS DESCRIPTION OF THIS TRACT ACCOMPANYING THIS SKETCH.

THIS DOCUMENT WAS PREPARED UNDER 22 TAC §663.21, DOES NOT REFLECT THE RESULTS OF AN ON THE GROUND SURVEY, AND IS NOT TO BE USED TO CONVEY OR ESTABLISH INTERESTS IN REAL PROPERTY EXCEPT THOSE RIGHTS AND INTERESTS IMPLIED OR ESTABLISHED BY THE CREATION OR RECONFIGURATION OF THE BOUNDARY OF THE POLITICAL SUBDIVISION FOR WHICH IT WAS PREPARED



Cunningham|Allen

Engineers • Surveyors

TBPELS REG # F-284 FIRM # 10000900
© COPYRIGHT 2020 CUNNINGHAMALLEN, INC.

3103 Bee Cave Road
Suite 202
Austin, Texas 78746
Tel.: (512) 327-2946
Fax: (512) 327-2973

TECH

Drawing Path: S:\640101\Drawings\640101_Base.dwg P: 02/26/2020 1:06:31 PM Layout: 6x11 Page Size: ANSI Full bleed A (8.50 x 11.00 inches), 1:1



CONCEPT PLAN – NOT CITY OF RR APPROVED

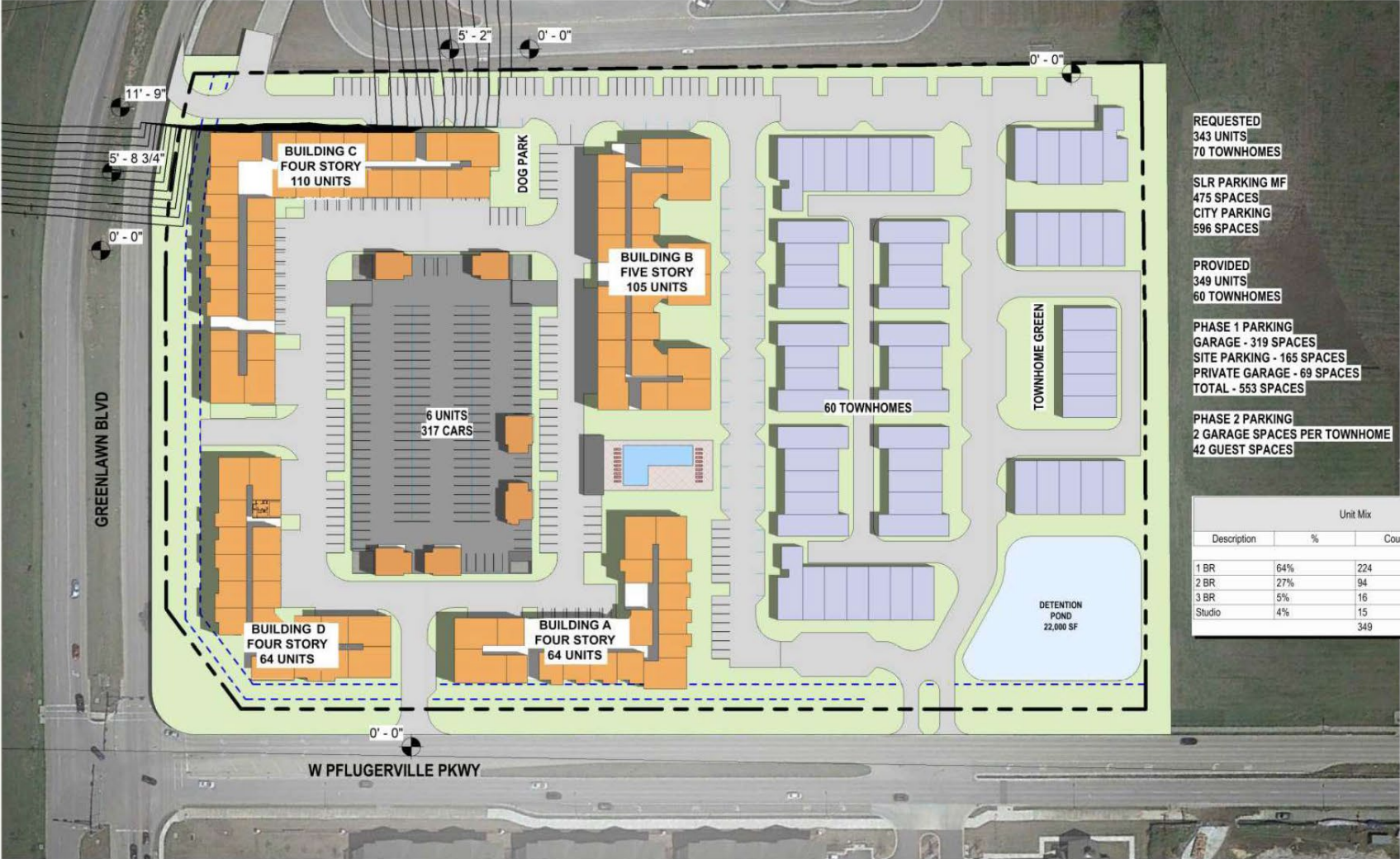

REQUESTED
 343 UNITS
 70 TOWNHOMES

SLR PARKING MF
 475 SPACES
CITY PARKING
 596 SPACES

PROVIDED
 349 UNITS
 60 TOWNHOMES

PHASE 1 PARKING
 GARAGE - 319 SPACES
 SITE PARKING - 165 SPACES
 PRIVATE GARAGE - 69 SPACES
TOTAL - 553 SPACES

PHASE 2 PARKING
 2 GARAGE SPACES PER TOWNHOME
 42 GUEST SPACES

Unit Mix			
Description	%	Count	NRSF
1 BR	64%	224	167792 SF
2 BR	27%	94	117063 SF
3 BR	5%	16	25984 SF
Studio	4%	15	8568 SF
		349	319407 SF

DISCLAIMER

Educational Communication

- The views expressed within are presented only for educational and informational purposes and are subject to change in the future. This presentation is confidential. By accepting the memorandum, you agree (i) that you hold and treat the contents in the strictest confidence, (ii) that you will not photocopy or duplicate any part of the memorandum, (iii) that you will not disclose the memorandum or any of its contents to any other entity without the prior written authorization of CCI, and (iv) that you will not use the memorandum in any fashion or manner detrimental to the interest of CCI. The terms and conditions stated in this section will relate to all of the sections of the package as if stated independently therein.

Not Advice

- Interested parties are advised and encouraged to conduct their own comprehensive review and analysis of the information contained in this memorandum and make their own determination as to how they would choose to use this information.. This memorandum is based on our business judgment, its experience, and the information available to us at this time. We are not licensed or certified as an appraiser by the State of Texas or any other state. No information contained in this memorandum is an appraisal as that term is defined in the Texas Occupations Code.

The material contained in this presentation is confidential and to be used solely for informational purposes. Neither The Whitfield Co., nor any of their affiliates, officers, employees or agents (collectively "TWC"), make any representation or warranty, express or implied, as to the completeness or the accuracy of the material contained in this memorandum or any of its contents, and no legal commitments or obligations shall arise by reason of this memorandum or any of its contents. Interested parties are advised (i) that changes may have occurred in the condition of the real estate described in the memorandum since the time of this memorandum and that (ii) all financial projections are provided for general reference purposes only in that they are based on assumptions relating to the general economy, competition, and other factors beyond the control of TWC and, therefore, are subject to material variation. All references to acreages, square footages, and other measurements are approximations. Some information gathered within this document has been sourced from CoStar and other institutional sources without independent confirmation by TWC. Any user or reviewer of this information is encouraged to independently confirm this information. In this memorandum, certain documents, including leases and other materials, are described in summary form. These summaries do not purport to be complete, nor necessarily accurate descriptions of the full agreements referenced. Interested parties are expected to review all such summaries and other documents of whatever nature independently and not rely on the contents of this valuation in any manner.

Presented By:

Gail Whitfield

512.422.4556 cell

gail@thewhitfieldco.com

Marcus Whitfield

512.656.1622 cell

marcus@thewhitfieldco.com