



CORRIDOR

COMMERCE CENTER

157,450 SQ FEET

AVAILABLE FOR LEASE

18200 Interstate 35 | Buda, TX 78610



DELIVERED & READY FOR OCCUPANCY

PROPERTY HIGHLIGHTS

- New Class A 157,450 SF rear load building with I-35 frontage
- Strategically located along the I-35 corridor between Austin and San Antonio with excellent north and south bound access
- 32' clear with 32 dock high doors and 2 ramps
- Ability to accommodate user between 37,000 SF to 157,450 SF
- Triple Freeport Tax Exemption



Leasing Information

Carter Thurmond
210.255.0644
carter.thurmond@transwestern.com

Nash Frisbie
512.314.5204
nash.frisbie@transwestern.com

BARINGS

T TRANSWESTERN REAL ESTATE SERVICES

The information provided herein was obtained from sources believed reliable; however, Transwestern makes no guarantees, warranties or representations as to the completeness or accuracy thereof. The presentation of this property is submitted subject to errors, omissions, change of price or conditions, prior sale or lease, or withdrawal without notice. Copyright © 2023 Transwestern.



CORRIDOR

COMMERCE CENTER

157,450 SQ FEET

AVAILABLE FOR LEASE

SITE PLAN |

-sizing capabilities

4 BAYS: 51,220 SF

Southern Endcap: 8 Dock Doors 1 Ramp 3,736 SF Spec Office	Northern Endcap: 10 Dock Doors 1 Ramp BTS Spec Office
---	---

5 BAYS: 65,260 SF

Southern Endcap: 12 Dock Doors 1 Ramp 3,736 SF Spec Office	Northern Endcap: 14 Dock Doors 1 Ramp BTS Spec Office
--	---

6 BAYS: 79,300 SF

Southern Endcap: 15 Dock Doors 1 Ramp 3,736 SF Spec Office	Northern Endcap: 17 Dock Doors 1 Ramp BTS Spec Office
--	---

7 BAYS: 93,340 SF

Southern Endcap: 18 Dock Doors 1 Ramp 3,736 SF Spec Office	Northern Endcap: 20 Dock Doors 1 Ramp BTS Spec Office
--	---

8 BAYS: 107,380 SF

Southern Endcap: 22 Dock Doors 1 Ramp 3,736 SF Spec Office BTS Spec Office	Northern Endcap: 24 Dock Doors 1 Ramp BTS Spec Office
---	---



↗ Provides direct access to one of the region's most vital interstates.

SPACE FEATURES

- 157,450 SF | Rear-load
- 32' Clear Height
- 3,736 SF Spec Office
- 2500 Amps
- 54'x50' Typical
- 60' Speed Bay
- 135' Truck Court Depth
- 260' Building Depth
- 32 Dock-high Doors (9'x10')
- 2 Drive-in Ramps 12'x14'
- ±195 Parking Spaces - 1.24/1,000 SF
- ESFR Sprinkler System
- Encap Bay SF: 9,100 SF
- Inline Bay SF: 14,040 SF



CORRIDOR

COMMERCE CENTER

157,450 SQ FEET

AVAILABLE FOR LEASE

SITE PLAN |

SPEC OFFICE
3,736 SF

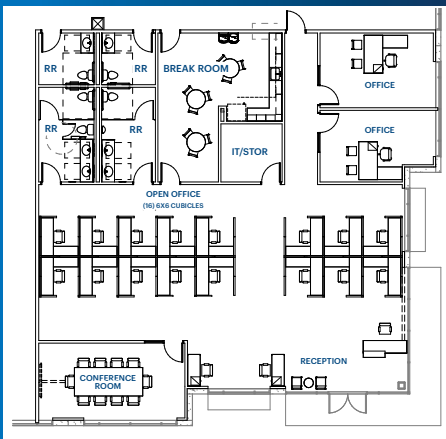

SPEC SUITE



CORRIDOR

COMMERCE CENTER

157,450 SQ FEET

AVAILABLE FOR LEASE



DRIVE TIMES: PROXIMITY TO SELECT CITIES



SAN MARCOS **12 min**

AUSTIN **15 min**

NEW BRAUNFELS **30 min**

SAN ANTONIO **50 min**

HOUSTON **2.5 hrs**

DFW **3.0 hrs**



CORRIDOR

COMMERCE CENTER

157,450 SQ FEET

AVAILABLE FOR LEASE

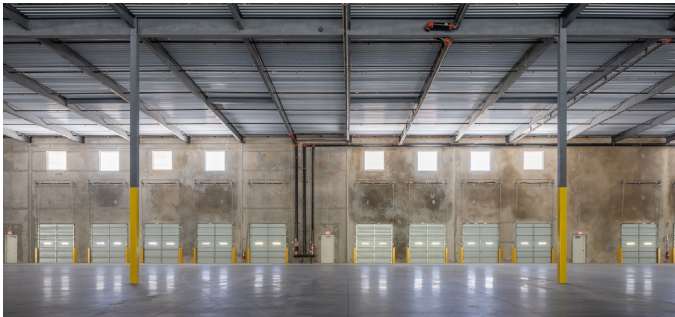

Leasing Information

Carter Thurmond
210.255.0644
carter.thurmond@transwestern.com

Nash Frisbie
512.314.5204
nash.frisbie@transwestern.com

BARINGS

 **TRANSWESTERN** REAL ESTATE SERVICES

The information provided herein was obtained from sources believed reliable; however, Transwestern makes no guarantees, warranties or representations as to the completeness or accuracy thereof. The presentation of this property is submitted subject to errors, omissions, change of price or conditions, prior sale or lease, or withdrawal without notice. Copyright © 2023 Transwestern.



CORRIDOR

COMMERCE CENTER

157,450 SQ FEET

AVAILABLE FOR LEASE



Leasing Information

Carter Thurmond
210.255.0644
carter.thurmond@transwestern.com

Nash Frisbie
512.314.5204
nash.frisbie@transwestern.com

BARINGS

 **TRANSWESTERN** REAL ESTATE SERVICES

The information provided herein was obtained from sources believed reliable; however, Transwestern makes no guarantees, warranties or representations as to the completeness or accuracy thereof. The presentation of this property is submitted subject to errors, omissions, change of price or conditions, prior sale or lease, or withdrawal without notice. Copyright © 2023 Transwestern.