

For Sale or Lease

2001 W. Pennsylvania Avenue
Kansas City, Missouri



Jeff Winters

Senior Vice President
+1 816 556 1109
jeff.winters@colliers.com

Ben Boyd ccm

Vice President
+1 816 556 1161
ben.boyd@colliers.com



Accelerating success.

For Sale or Lease

2001 W. Pennsylvania Avenue

Property Features

Building Size:	9,265± SF
Office Area:	750± SF
Warehouse Area:	Fully air-conditioned
Loading:	1 drive-in door; 1 dock-high door
Zoning:	M1-5
Lease Rate:	\$10.00 PSF, NNN
Sale Price:	\$1,095,000

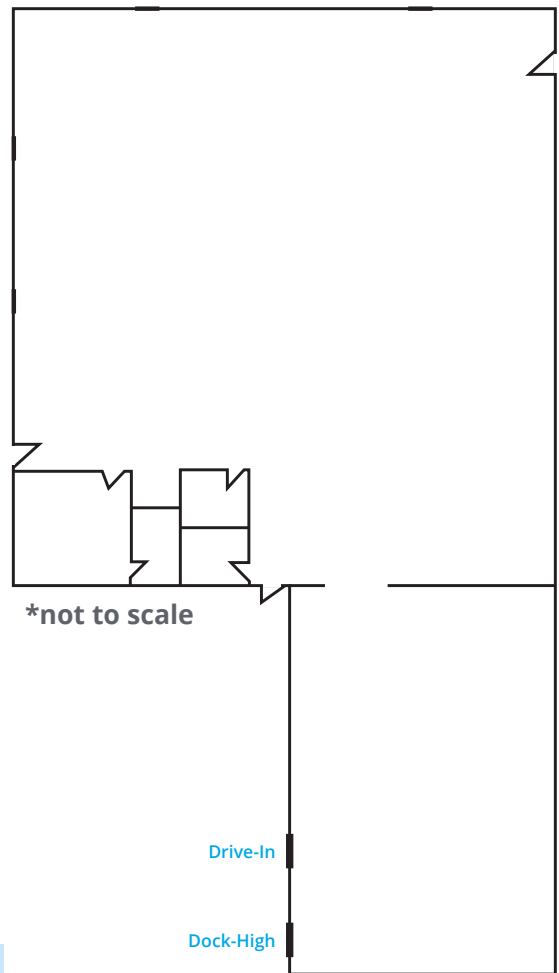

Drive-In
Dock-High



2001 W. Pennsylvania Avenue

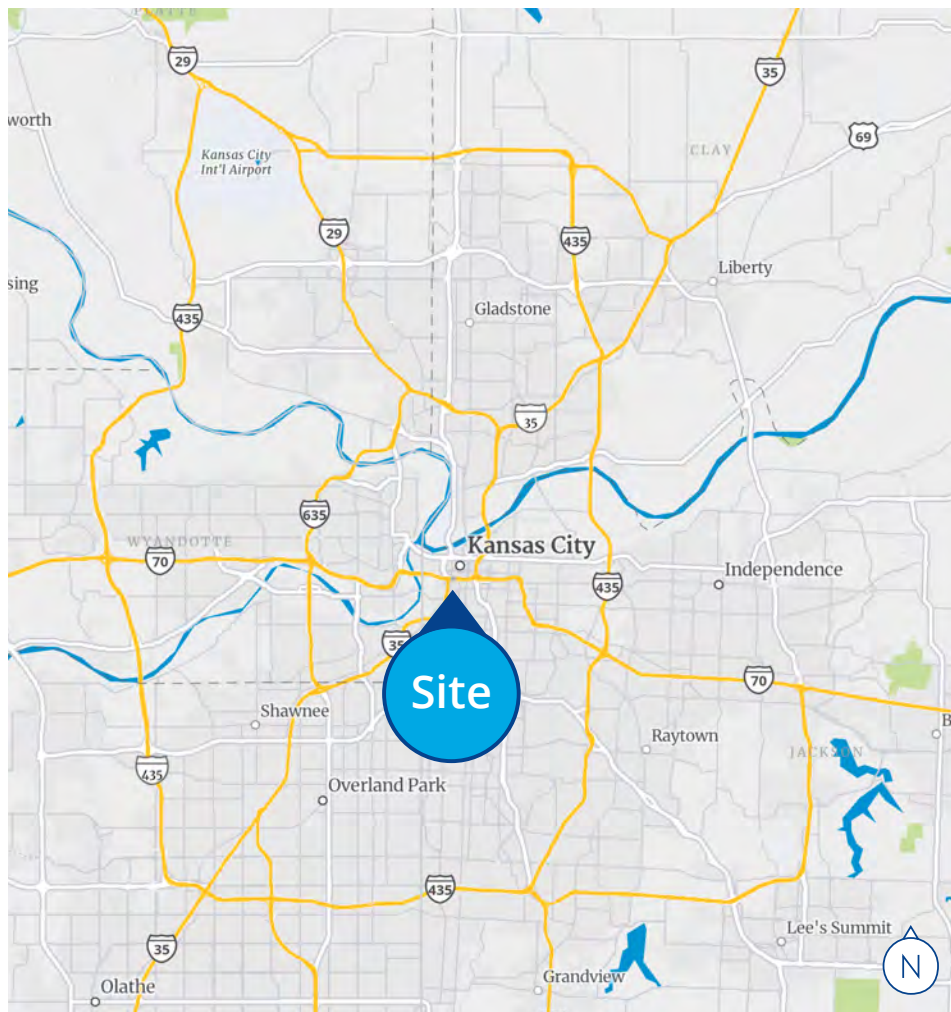
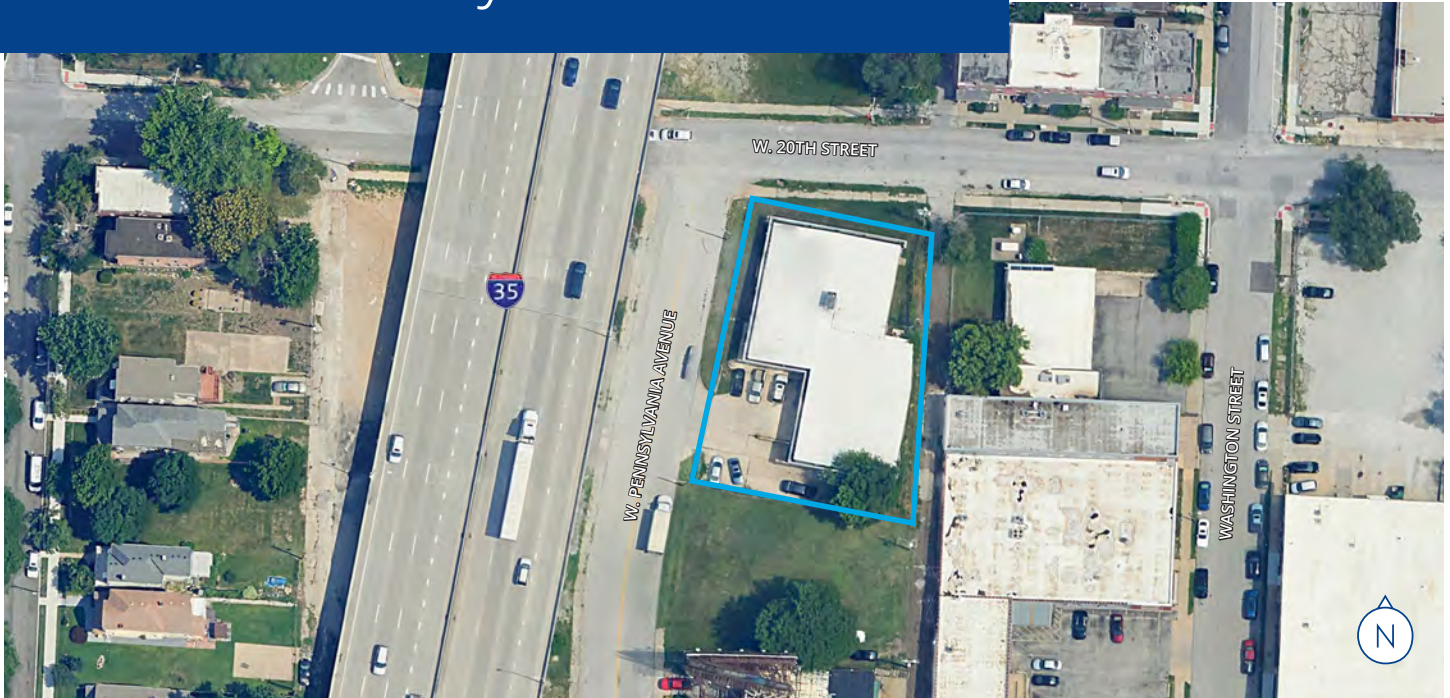

This document has been prepared by Colliers for advertising and general information only. Colliers makes no guarantees, representations or warranties of any kind, expressed or implied, regarding the information including, but not limited to, warranties of content, accuracy and reliability. Any interested party should undertake their own inquiries as to the accuracy of the information. Colliers excludes unequivocally all inferred or implied terms, conditions and warranties arising out of this document and excludes all liability for loss and damages arising there from. This publication is the copyrighted property of Colliers and/or its licensor(s). © 2024. All rights reserved. This communication is not intended to cause or induce breach of an existing listing agreement.

Jeff Winters

Senior Vice President
+1 816 556 1109
jack.higgins@colliers.com

Ben Boyd ccim

Vice President
+1 816 556 1161
ben.boyd@colliers.com

Colliers Kansas City

4520 Main Street, Suite 1000
Kansas City, MO 64111
+1 816 531 5303
colliers.com/kansascity

Colliers