

# Parcels 003 & 004 State Route 25

Oswego, IL 60543

LAND - RESIDENTIAL FOR SALE



# Parcels 003 & 004 State Route 25 | Oswego, IL 60543

LAND - RESIDENTIAL FOR SALE

john greene Commercial | 1311 S Route 59, Naperville, IL 60564 | 630.229.2290



## OFFERING SUMMARY

Sale Price: \$350,000

Lot Size: 6.93 Acres

Zoning: R-3, Kendall County

## PROPERTY OVERVIEW

Rare riverside development opportunity on this nearly 7 acre wooded parcel overlooking Fox River. Site is ideal for multifamily, townhomes, assisted living facility, or detached single family homes. In addition to all recreational river activities, this location is contiguous to the expansive Fox River Trail, Violet Patch Park and Eagle Ridge Disc Golf Course. Sanitary sewer is on site with other utilities available. Property is immediately adjacent to incorporated Oswego, currently zoned R3 in unincorporated Kendall County.

### Mike Waseen

mikewaseen@johngreenecommercial.com

630.360.1196

### Terry Anderson

TerryAnderson@johngreeneRealtor.com

630.294.6378

The information contained herein is from sources john greene Real Estate deems reliable, but is not guaranteed. This offer may be withdrawn from the market or be subject to a change in price or terms without advance notice. Seller reserves the right to reject any and all offers. Duplication is expressly prohibited. 2019



# Parcels 003 & 004 State Route 25 | Oswego, IL 60543

LAND - RESIDENTIAL FOR SALE

john greene Commercial | 1311 S Route 59, Naperville, IL 60564 | 630.229.2290

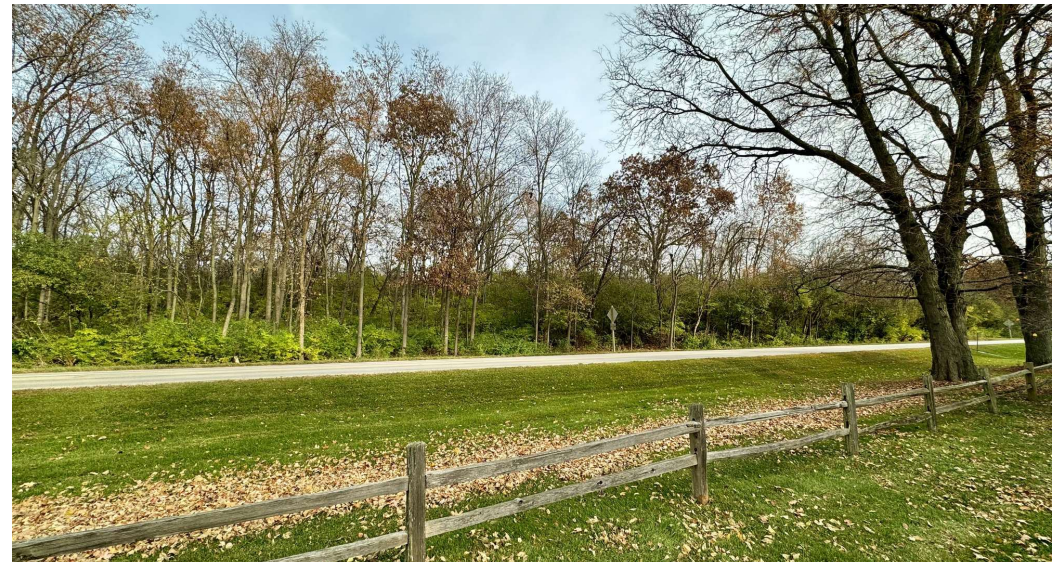

**Mike Waseen**

[mikewaseen@johngreenecommercial.com](mailto:mikewaseen@johngreenecommercial.com)

630.360.1196

**Terry Anderson**

[TerryAnderson@johngreeneRealtor.com](mailto:TerryAnderson@johngreeneRealtor.com)

630.294.6378

The information contained herein is from sources john greene Real Estate deems reliable, but is not guaranteed. This offer may be withdrawn from the market or be subject to a change in price or terms without advance notice. Seller reserves the right to reject any and all offers. Duplication is expressly prohibited. 2019

john  
greene  
COMMERCIAL

# Parcels 003 & 004 State Route 25 | Oswego, IL 60543

LAND - RESIDENTIAL FOR SALE

John Greene Commercial | 1311 S Route 59, Naperville, IL 60564 | 630.229.2290

## POPULATION

	1 MILE	3 MILES	5 MILES
Total Population	2,619	40,298	116,842
Average Age	52.0	42.1	41.0
Average Age (Male)	48.0	41.5	40.0
Average Age (Female)	53.6	42.4	41.2

## HOUSEHOLDS & INCOME

	1 MILE	3 MILES	5 MILES
Total Households	1,058	15,740	41,794
# of Persons per HH	2.5	2.6	2.8
Average HH Income	\$197,103	\$132,672	\$134,010
Average House Value	\$523,804	\$353,583	\$335,259

2020 American Community Survey (ACS)

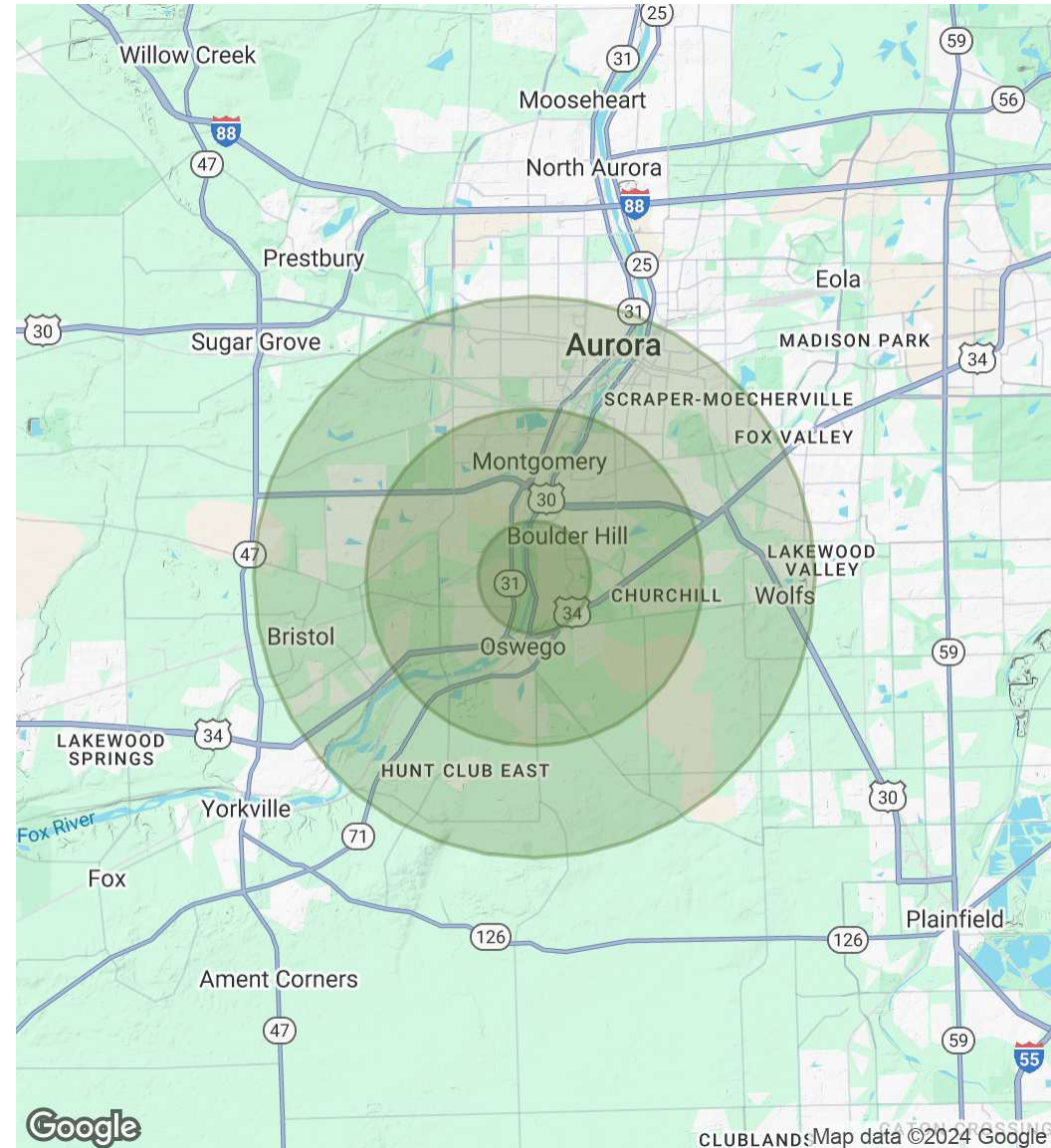

**Mike Waseen**

mikewaseen@johngreenecommercial.com

630.360.1196

**Terry Anderson**

TerryAnderson@johngreeneRealtor.com

630.294.6378

The information contained herein is from sources John Greene Real Estate deems reliable, but is not guaranteed. This offer may be withdrawn from the market or be subject to a change in price or terms without advance notice. Seller reserves the right to reject any and all offers. Duplication is expressly prohibited. 2019

