

# 2ND + SENECA SUBLEASE

1191 2nd Ave | Suite 450 | Seattle WA 98101





## Call Brokers for Rates

 4,300 SF

 Open floor plan with 3 private offices and 1 large conference room

 Kitchenette

 Lots of natural light

 On-site bike storage, fitness center & shower facilities

 Expiration date: 1/31/2029

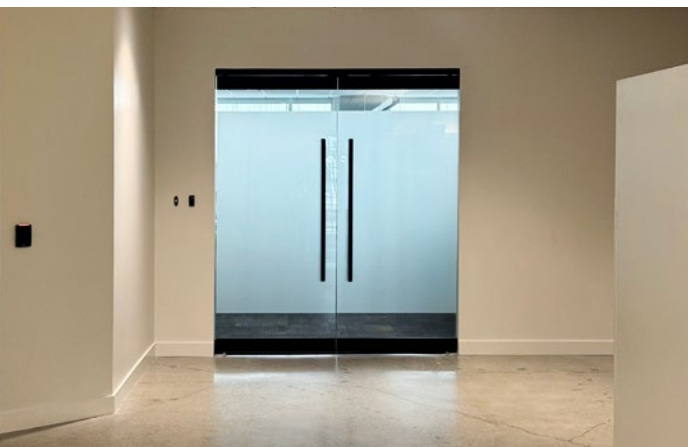

# 2ND + SENECA SUBLEASE

1191 2nd Ave | Suite 450 | Seattle WA 98101

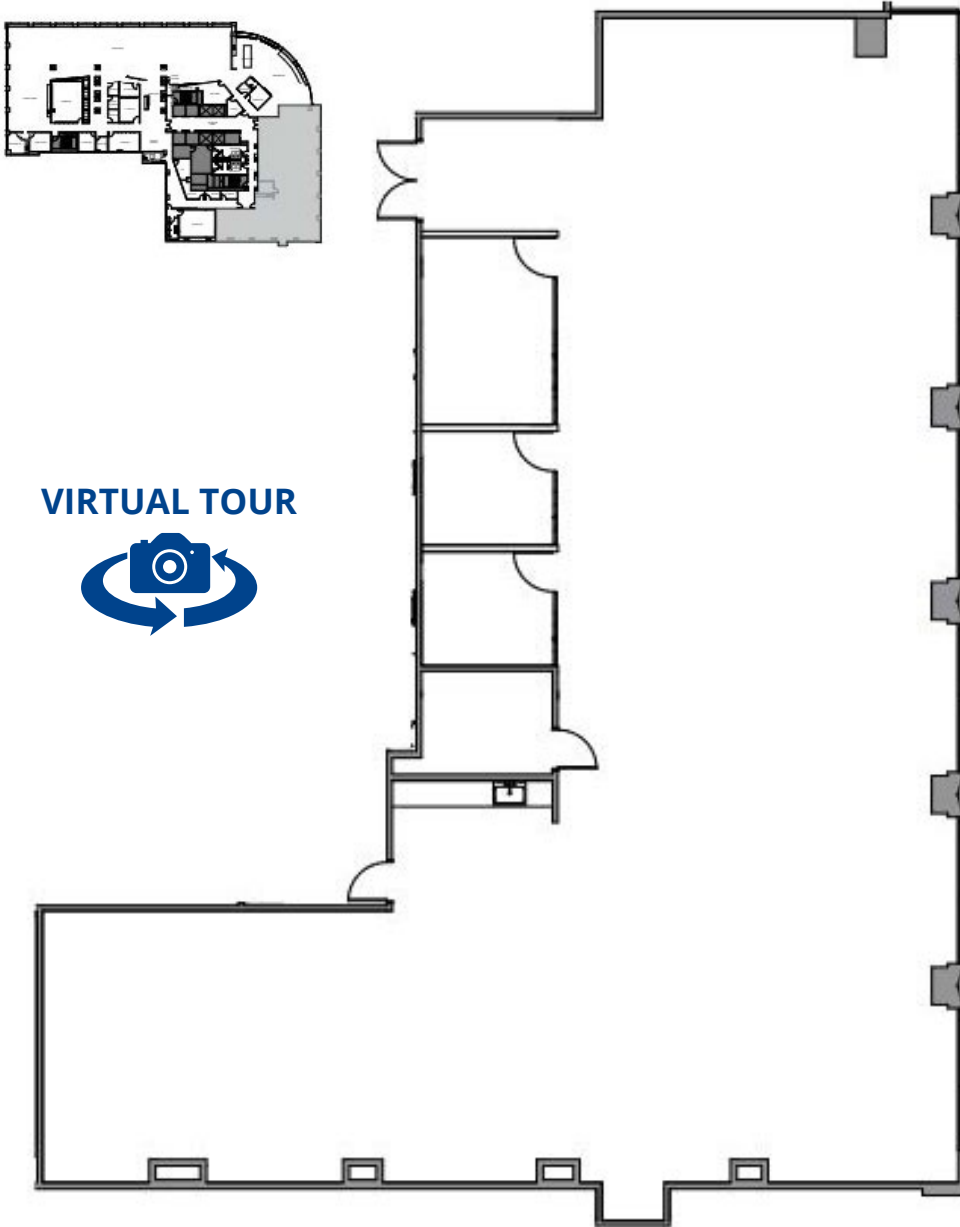

VIRTUAL TOUR

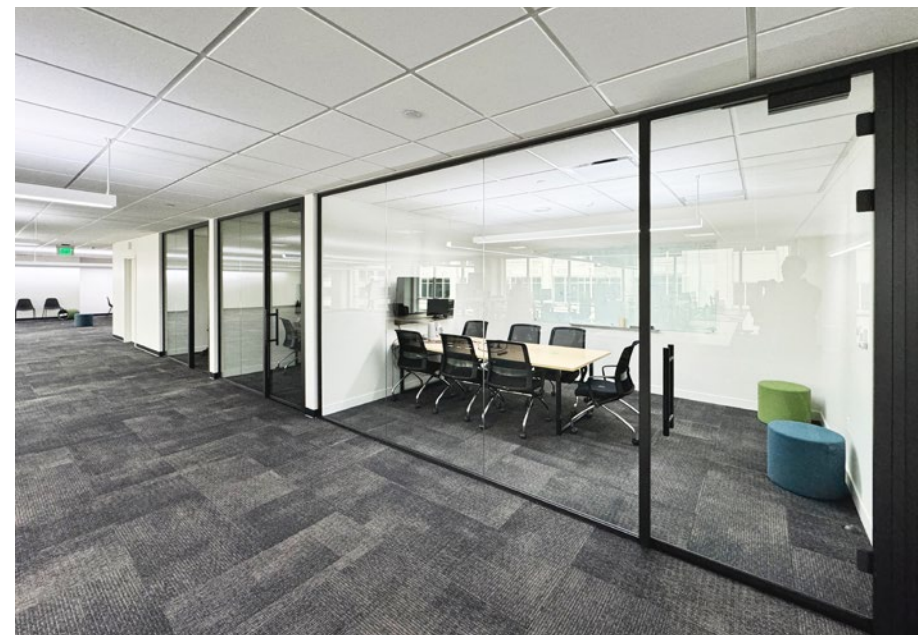

# BE IN THE HEART OF DOWNTOWN SEATTLE

Place your company amongst a wide variety of amenities, including shopping, dining, museums, theaters, and other entertainment and cultural venues. Downtown Seattle's walkable layout and ample options for public transportation provide easy access to activity hubs, the waterfront, and surrounding neighborhoods.



## JOE CONNER

Senior Associate  
+1 425 698 7142

joe.conner@colliers.com

## CONNOR MCCLAIN

Senior Vice President  
+1 206 624 7417

connor.mcclain@colliers.com

## COLLIERS SEATTLE

601 Union Street, Suite 5300  
Seattle, WA 98101  
colliers.com

