

MIRAMAR
CENTER
BUSINESS PARK

15501 SW 29th ST
Miramar, FL
33027

±60,000 – ±152,573 SF
SPACE AVAILABLE





TRANSWESTERN
REAL ESTATE
SERVICES



BELOW MARKET SUBLEASE

- SIZE: ± 60,000 SF – ± 152,573 SF
 - TERM: ± 5 YEARS
- ASKING RENT: ONLY \$12.95 PSF / NNN
- **AVAILABILITY: IMMEDIATELY**

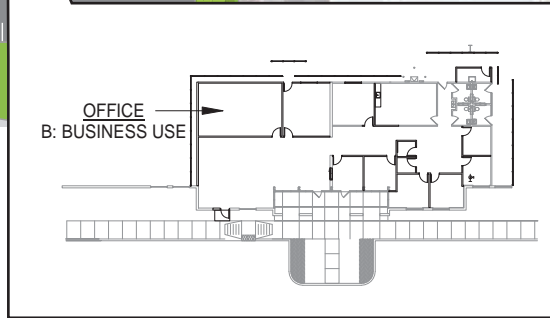
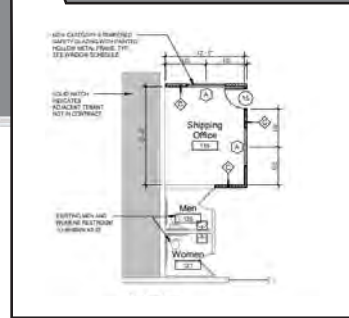
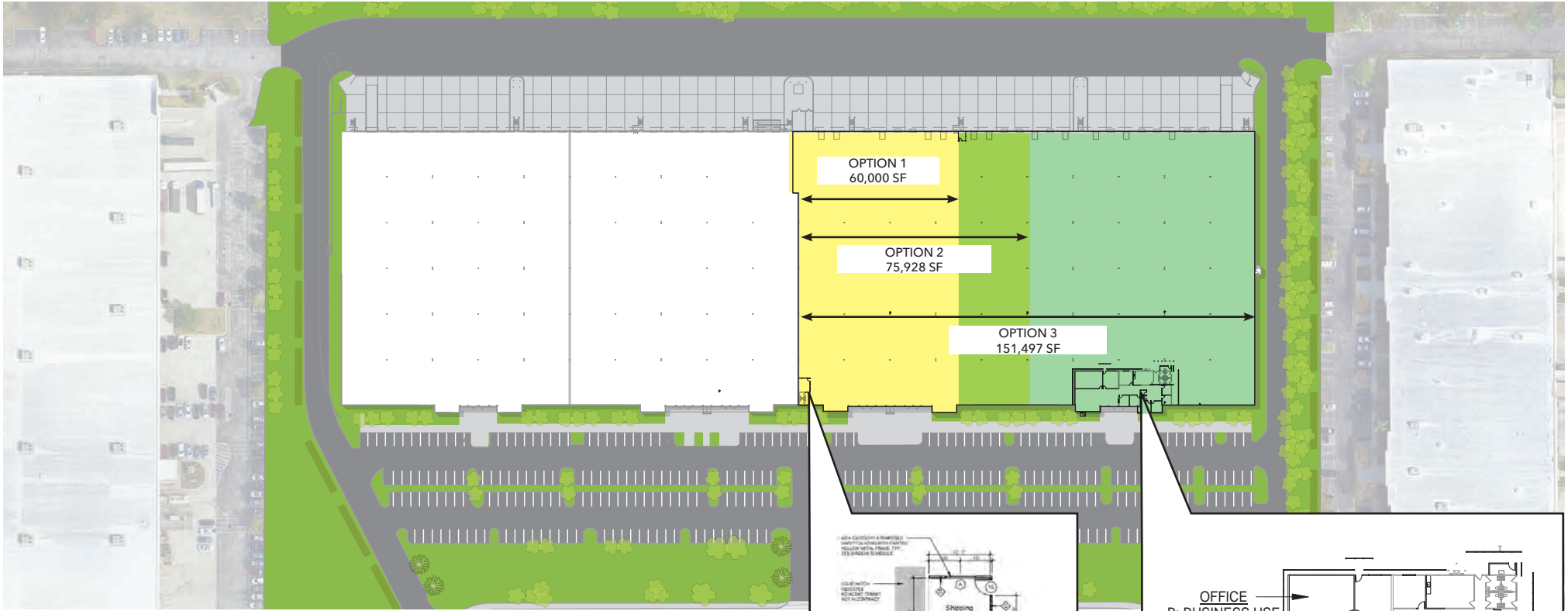
SITE DETAILS



	AVAILABLE:	OPTION 1: ±60,000 SF
		OPTION 2: ± 75,928 SF
		OPTION 3: ± 152,573 SF
	OFFICE:	MAIN OFFICE: ± 3,912 SF
		SHIPPING OFFICE: ± 180 SF
	CEILING HEIGHT:	± 32' CLEAR
	LOADING:	UP TO 23 DH DOORS (9' X 10') – 6 (35,000 LB LEVELER), 17 EDGE OF DOCK LEVELER & 1 STREET OVERSIZED RAMP
	COLUMN SPACING:	50' D X 50' W

	POWER:	800 A / 480V 3P HEAVY 9 FORKLIFT BATTERY CHARGING STATIONS
	TRUCK COURT:	± 120'
	PARKING:	± 1.20 / 1,000 SF
	SUBLEASE RATE:	\$12.95 SF/NNN
	OPERATING EXPENSES:	\$5.15 PSF
	AVAILABILITY :	IMMEDIATE

LOCATION DETAILS

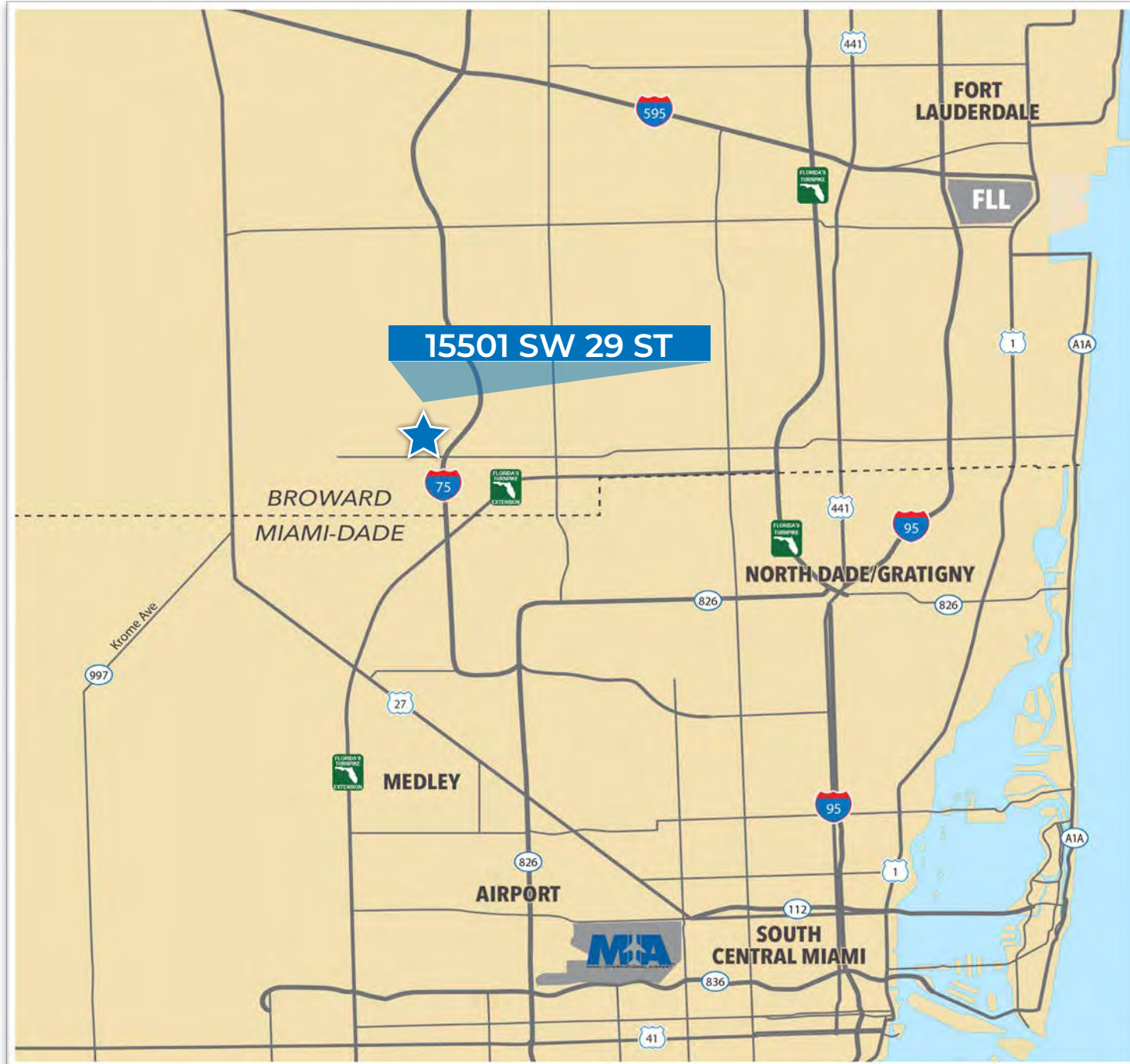

IMMEDIATE ACCESS TO
I-75



IMMEDIATE ACCESS TO
MIRAMAR PKWY



FLORIDA'S TURNPIKE
±11.2 MILES



PORT OF MIAMI
±24.0 MILES
36 MINUTES



PORT EVERGLADES
±26.0 MILES
29 MINUTES



MIA AIRPORT
±21.0 MILES
25 MINUTES

AERIAL OF PARK

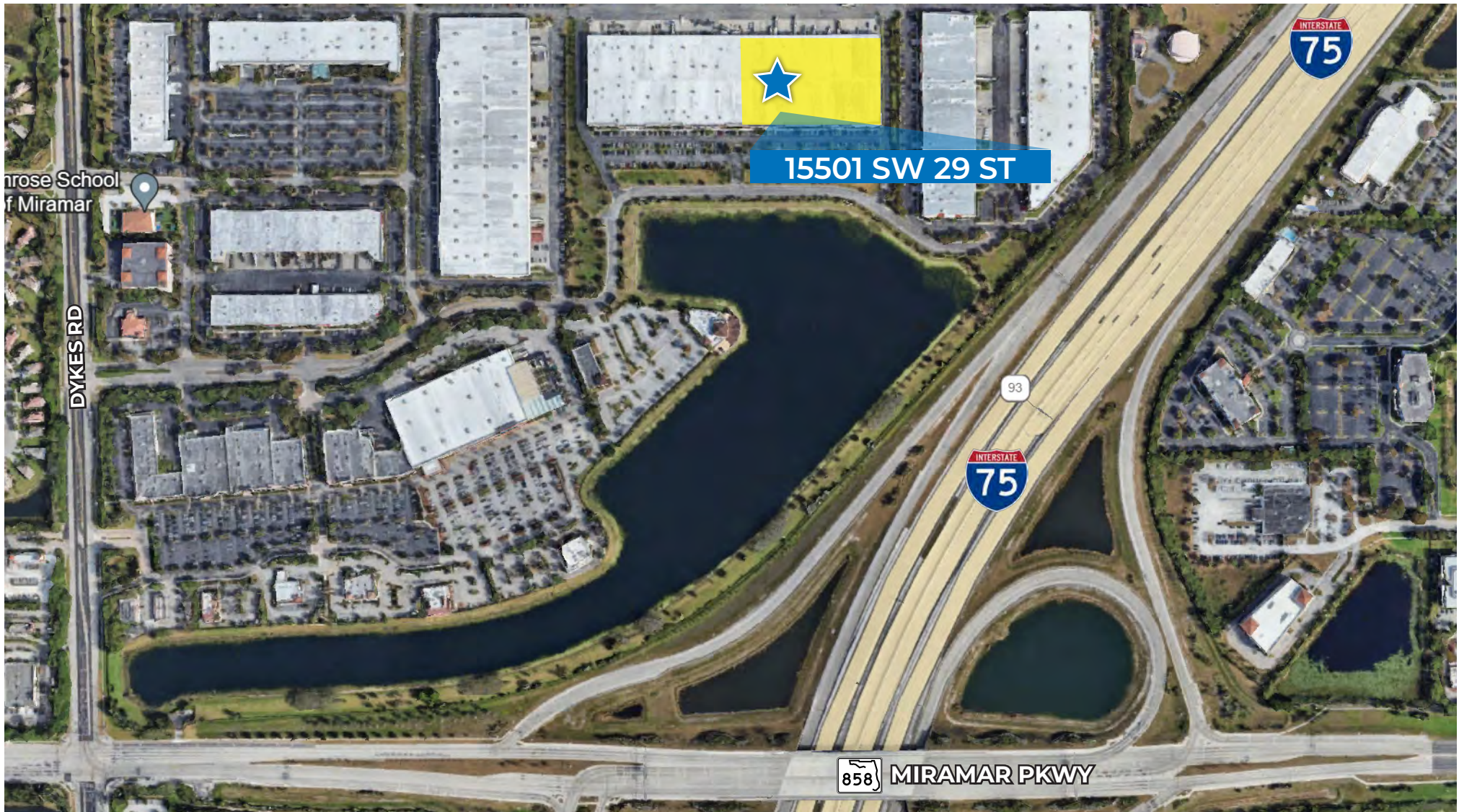

FOR MORE INFORMATION, CONTACT



WALTER BYRD
EXECUTIVE MANAGING DIRECTOR
305.808.7825
walter.byrd@transwestern.com

BEN EISENBERG
EXECUTIVE MANAGING DIRECTOR
305.808.7826
ben.eisenberg@transwestern.com

CARLOS GAVIRIA
SENIOR VICE PRESIDENT
305.808.7313
carlos.gaviria@transwestern.com

THOMAS KRESSE
EXECUTIVE MANAGING DIRECTOR
305.808.7827
thomas.kresse@transwestern.com

The information provided herein was obtained from sources believed reliable; however, Transwestern makes no guarantees, warranties or representations as to the completeness or accuracy thereof. The presentation of this property is submitted subject to errors, omissions, change of price or conditions, prior sale or lease, or withdrawal without notice. Copyright © 2023 Transwestern Licensed Real Estate Broker.