

2007 S Sycamore Street  
Petersburg, VA

For Lease



## Features

- Great visibility located by South Crater Road and South Sycamore Street
- Sub-Lease—formerly Octapharma Plasma, Inc. which was used as a medical facility
- Approximately 8,600 square feet
- Large waiting/reception area, multiple offices, several large open rooms and storage areas
- Lease Price—\$6,809.73 currently + CAM



**Specter**

Properties, Inc.

P.O. Box 2455  
Chesterfield, VA 23832  
(804) 777-7070

Principal Broker

Mark B. Specter

[mspecter@specterproperties.com](mailto:mspecter@specterproperties.com)

Associate Broker

Kevin Y. Specter

[kspecter@specterproperties.com](mailto:kspecter@specterproperties.com)

All information furnished to Specter Properties, Inc. is from sources judged to be reliable. However, no warranty or representation is made as to its accuracy or completeness. This applies to all pages within this document.

# 2007 S. Sycamore Street



All information furnished to Specter Properties, Inc. is from sources judged to be reliable. However, no warranty or representation is made as to its accuracy or completeness. This applies to all pages within this document.

# FLOOR PLAN

2007 S. Sycamore Street, Suite B  
Petersburg, VA 23805

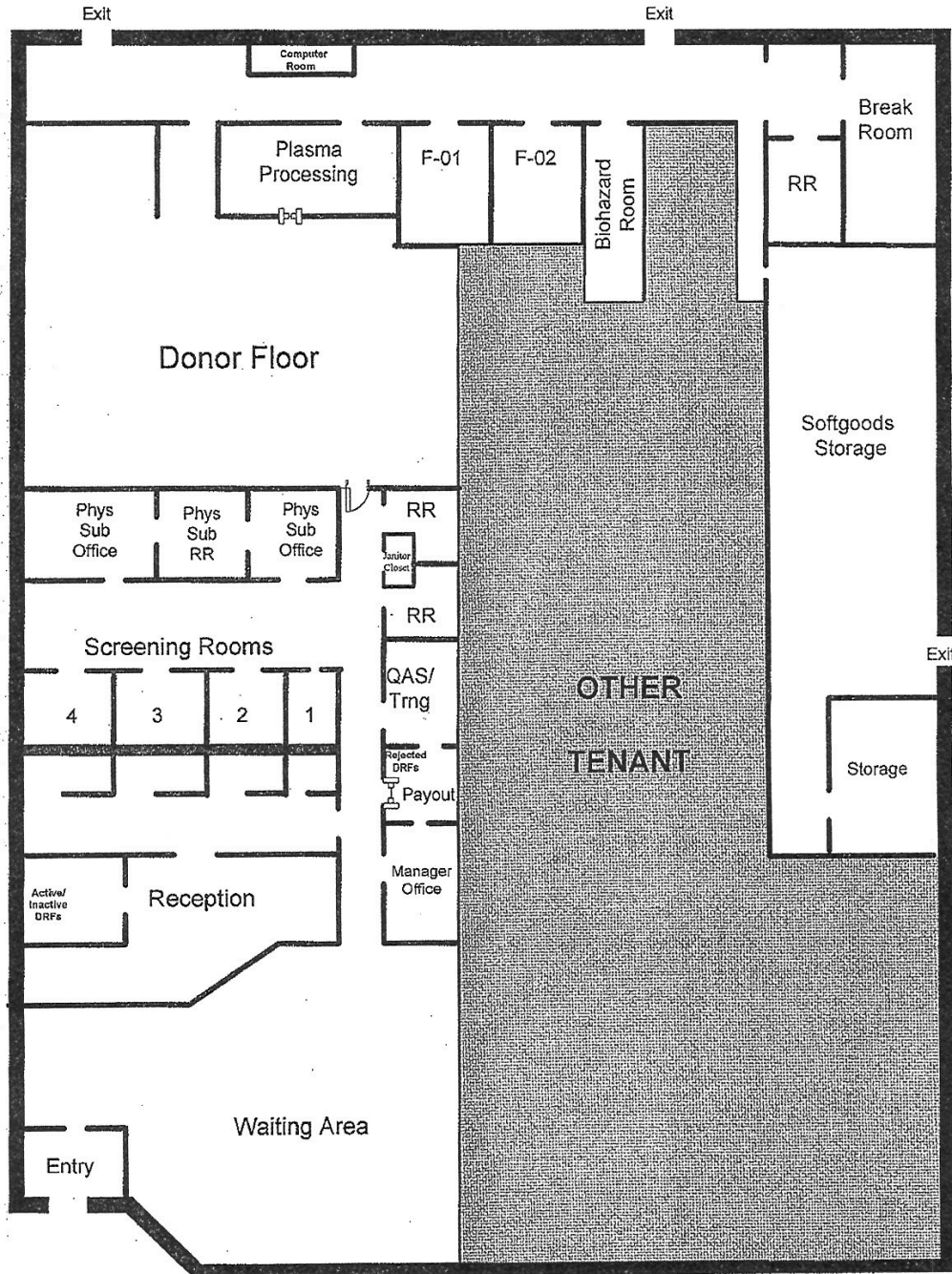

Updated  
31 Mar 08

Floor plan may have been modified slightly

All information furnished to Specter Properties, Inc. is from sources judged to be reliable. However, no warranty or representation is made as to its accuracy or completeness. This applies to all pages within this document.