



Prime North Charleston class A flex space opportunity

- ±5,252 sf available for sublease; with frontage on Palmetto Commerce Parkway
- 1600 sf of office space consisting of 4 private offices, 1 conference room and kitchenette and bullpen area
- Zoned PD & B1, suitable for industrial and commercial flex uses
- 24' clear heights, ESFR sprinklers, and high bay linear LED lighting
- Grade-level 12x14' roll up door with access to parking behind the space



Frontage on Palmetto Commerce Pkwy offers unmatched visibility



Built for flexibility – accommodate small to large tenant requirements



Class A specs with LED lighting, ESFR sprinklers & 24' ceiling



Multiple access points, front and rear parking, and easy access to I-26

For further information

Alex Irwin
Sr. Vice President
+1 843 637 5013

Don Lewis
Associate
+1 901 626 7943

Gray Wilson
Associate
+1 803 608 5688

avisonyoung.com

8439 Palmetto Commerce Pkwy,
North Charleston, SC

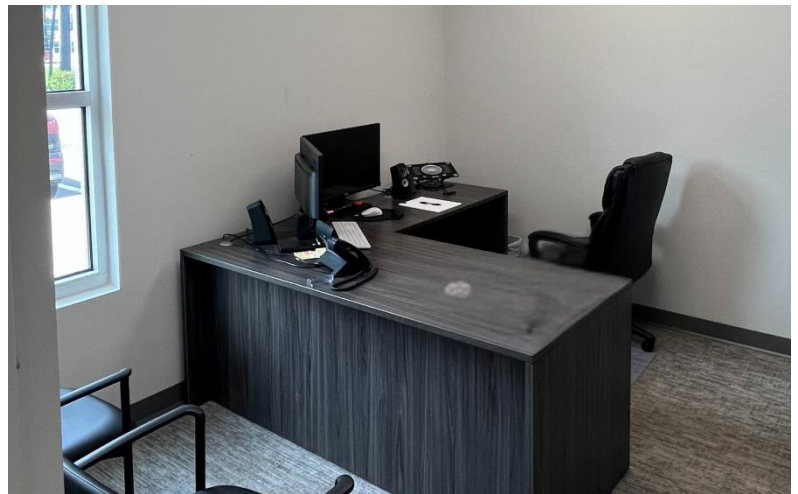
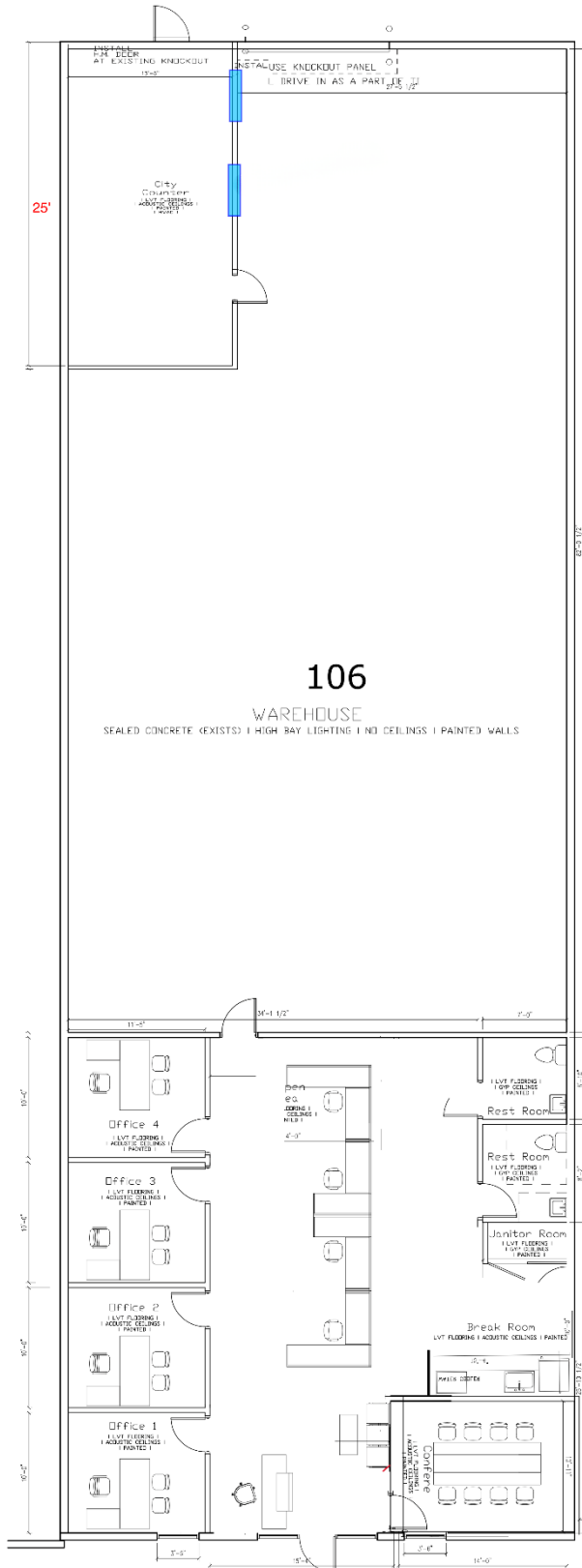

Alex Irwin

Sr Vice President
+1 843 637 5013

Don Lewis

Associate
+1 901 626 7943

Gray Wilson

Associate
+1 803 608 5688

**AVISON
YOUNG**