

BAYSIDE REALTY PARTNERS PRESENTS

# Westborough Professional Center

2400 Westborough Boulevard, South San Francisco



TRASK LEONARD  
President and CEO  
650.533.2591  
[tleonard@baysiderp.com](mailto:tleonard@baysiderp.com)  
DRE#01152101



ROGER MARTINS  
Property Director  
925.260.2084  
[RMartins@baysiderp.com](mailto:RMartins@baysiderp.com)  
DRE#01942657



# Westborough Professional Center

## 2400 Westborough Boulevard, South San Francisco

### LOCATION

- Great location close to the Westborough Square shopping center with Walgreens, Pacific Market and various restaurants
- Near the corner of Westborough and Gellert Boulevards
- Easy freeway access from I-280 both north and south directions
- Ample on-site parking and private parking garage



### BUILDING

- Two-story building
- Visible monument signage

### SPACE

- Space located in the basement level; Ideal for business/ administrative use or medical/dental use
- Large open waiting room and reception area
- 4 offices/exam rooms. 1 private office. Private Restroom
- Large floor-to-ceiling windows in two of the rooms/offices.

# Westborough Professional Center

2400 Westborough Boulevard, South San Francisco



# Westborough Professional Center

## 2400 Westborough Boulevard, South San Francisco



**2400 Westborough  
Boulevard  
South San Francisco**

**WESTBOROUGH SQUARE  
SHOPPING CENTER**  
Walgreens • Pacific Market •  
Philz Coffee • Paris Baguette Café •  
Five Guys • Chase

# Westborough Professional Center

2400 Westborough Boulevard, South San Francisco

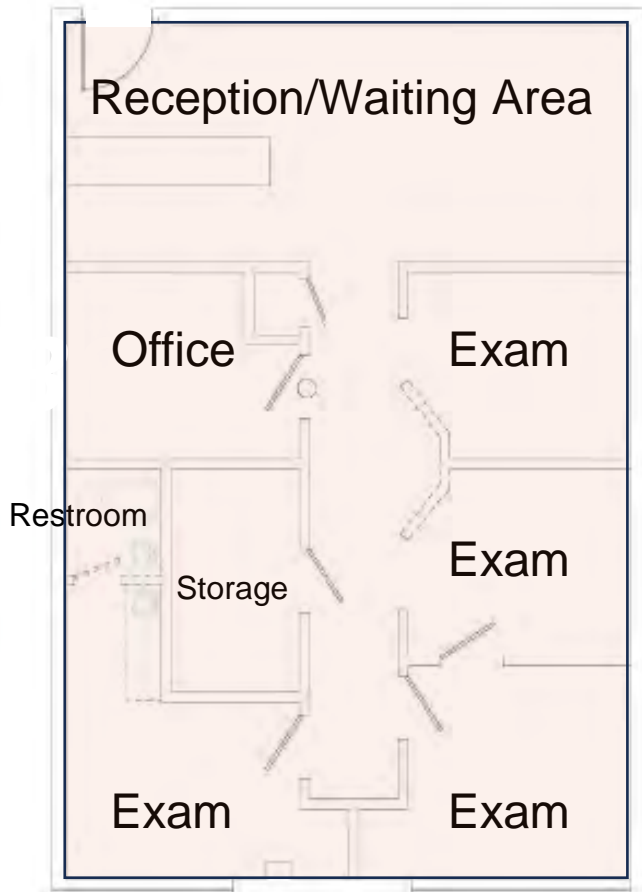

Suite 2      1,011 RSF  
**BASEMENT LEVEL**

Large open reception/waiting room area, 4 exam/office rooms, one private office, a storage room or kitchen/break room, and a private restroom.

Can be used as medical, dental or business office.

# Meet Your Expert Team



TRASK LEONARD

President and CEO

650.533.2591

[tleonard@baysiderp.com](mailto:tleonard@baysiderp.com)

DRE#01152101



ROGER MARTINS

Property Director

925.260.2084

[RMartins@baysiderp.com](mailto:RMartins@baysiderp.com)

DRE#01942657

**DOMINANT. EXPERT. INFLUENTIAL.**

# BAYSIDE REALTY PARTNERS

*The preeminent provider of management, leasing, construction management and accounting services for healthcare properties.*



## MARKET LEADER

- Leasing & Property Management
- Investment Sales
- Tenant Representation
- Construction Management
- Property Repositioning



## INFLUENTIAL NETWORK

- Institutional Investors
- Healthcare Systems and Healthcare Districts
- Physicians & Districts
- Private Investors



## DOMINANT FOOTPRINT

- 2 million SF leased & managed
  - 50+ MOB portfolio
  - 10,000-240,000 SF
  - 500,000 SF portfolio
- San Francisco's largest MOBs
- 950+ leases executed
- 500+ medical and dental tenants

**DOMINANT. EXPERT. INFLUENTIAL.**