

FOR LEASE

# CROSTOWN NORTH BUSINESS CENTER II

9210 WYOMING AVENUE NORTH

Brooklyn Park, MN

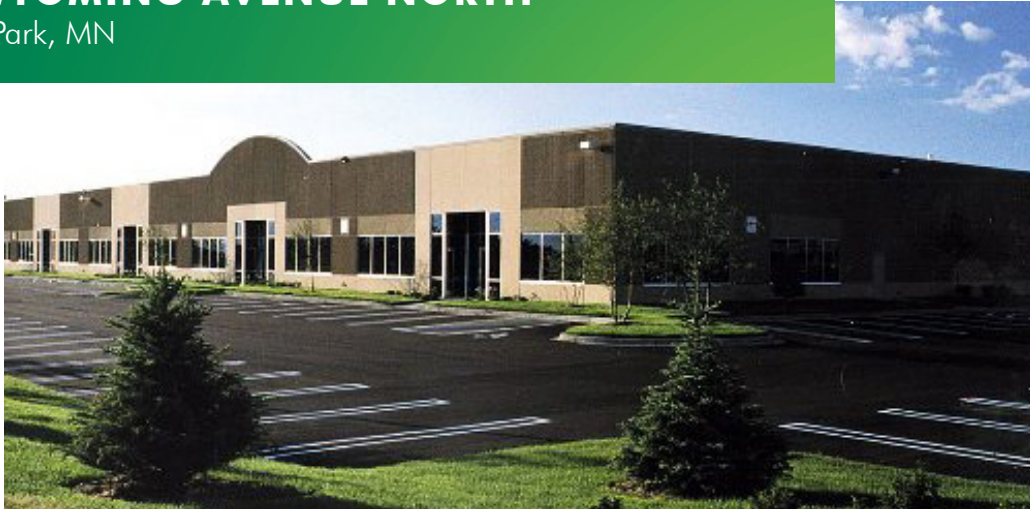

## BUILDING HIGHLIGHTS

### CROSTOWN NORTH BUSINESS CENTER II

- + Part of Crosstown North Business Center
- + Located at 93rd Avenue North and West Broadway (One block from Hwy 610)
- + Flexible bay sizes within 68,292 SF building
- + Full service tax/CAM includes repairs and replacement of HVAC units

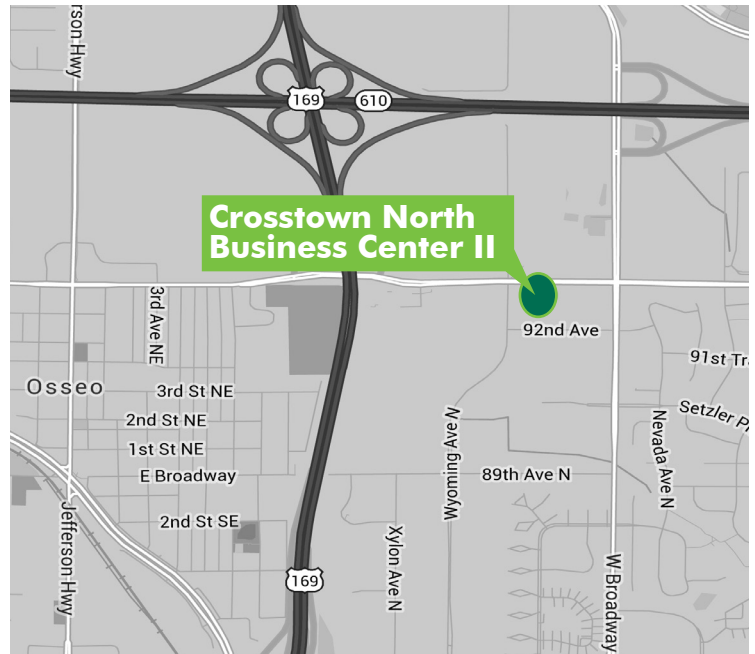

## CONTACT US

### DAN SWARTZ

Senior Vice President  
+1952 924 4652  
dan.swartz@cbre.com

### JOEY DYBEVIK

Associate  
+1612 336 4321  
joey.dybevik@cbre.com

[www.cbre.com/minneapolis](http://www.cbre.com/minneapolis)



**CBRE**

# FOR LEASE CROSTOWN NORTH BUSINESS CENTER II

9210  
WYOMING AVE NORTH  
Brooklyn Park, MN

### 3, Building Information

|                      |   |
|----------------------|---|
| <b>Building Size</b> | 68,292 SF   |
| <b>Clear Height</b>  | 18'   |
| <b>Lease Rates</b>   | \$9.75 PSF Office<br>\$4.75 PSF Warehouse   |
| <b>2018 Tax/CAM</b>  | \$4.20 PSF  |
| <b>Suite 215</b>     | 1,592 SF Office<br>3,880 SF Warehouse<br>5,472 SF Total<br><br>Loading - 2 Docks            |
| <b>Suite 260</b>     | 2,508 SF Office<br>4,207 SF Warehouse<br>6,715 SF Total<br><br>Loading - 1 Dock, 1 Drive-In |



## FLOOR PLAN

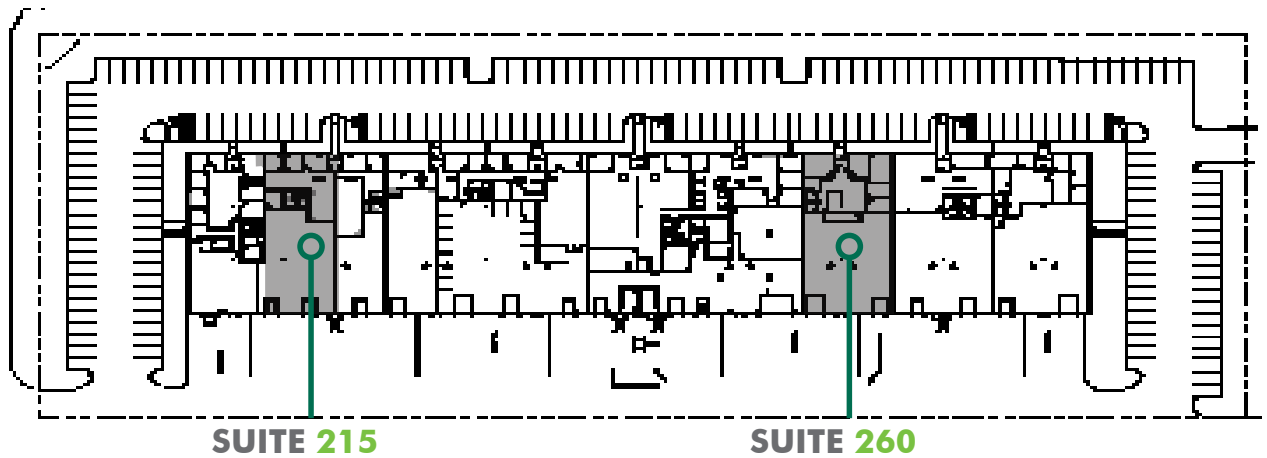

© 2017 CBRE, Inc. The information contained in this document has been obtained from sources believed reliable. While CBRE, Inc. does not doubt its accuracy, CBRE, Inc. has not verified it and makes no guarantee, warranty or representation about it. It is your responsibility to independently confirm its accuracy and completeness. Any projections, opinions, assumptions or estimates used are for example only and do not represent the current or future performance of the property. The value of this transaction to you depends on tax and other factors which should be evaluated by your tax, financial and legal advisors. You and your advisors should conduct a careful, independent investigation of the property to determine to your satisfaction the suitability of the property for your needs.

Photos herein are the property of their respective owners and use of these images without the express written consent of the owner is prohibited.

[www.cbre.com/minneapolis](http://www.cbre.com/minneapolis)



**CBRE**