

# SHAW'S PLAZA RAYNHAM

RAYNHAM, MA



## SIZE

177,324 square feet

## DEMOGRAPHICS

1 mile	3 mile	5 mile
<b>Population</b>		
3,324	48,321	80,820
<b>Households</b>		
1,286	19,301	31,513
<b>Median HH Income (\$)</b>		
110,506	76,612	85,341

## MAJOR TENANT(S)

Marshalls  
PetSmart  
Shaw's Supermarket



## LOCATION

300 New State Highway | Raynham, MA 02767

## PROPERTY HIGHLIGHTS

- Anchored by Shaw's grocery store, a wholly owned subsidiary of Albertsons and co-anchored by Marshalls, PetSmart and CVS
- Located in Raynham, a suburb located 30 miles south of Boston
- Additional national and regional tenants include Five Below, Panera Bread, Bank of America, SuperCuts, T-Mobile and Popeyes
- The center is situated on New State Highway and South St, which benefits from over 32,000 vehicles per day

## LEASING CONTACT

Marissa Visconsi  
Mobile (303) 547-4386  
mvisconsi@phillipsedison.com

## MORE INFO

[www.phillipsedison.com](http://www.phillipsedison.com)



**PHILLIPS EDISON & COMPANY®**

# SHAW'S PLAZA RAYNHAM

300 New State Highway | Raynham, MA 02767

Space	Tenant	SQ. FT.
01	Answer is Fitness Gym	4,767
02	COMING AVAILABLE	1,760
03	T-Mobile	3,000
04	One Foot Spa	2,400
05	Star Nail and Spa	2,400
06	Supercuts	1,600
08	PetSmart	14,000
09	My Village Playhouse	5,560
09A	Dental Dreams	3,840
10	Bank of America	3,500
11	COMING AVAILABLE	15,775
12	Santander Bank	2,274
13	Panera Bread	4,000
14	Shaw's Supermarket	60,748
15	Marshalls	25,752
16	Dragon Nails	3,200
17	Five Below	9,100
18	COMING AVAILABLE	1,537
19	CVS	10,125
OPI	Popeyes	1,986
SHAD1	Bernie and Phyl's Furniture	N/A
Total SQ. FT.		177,324

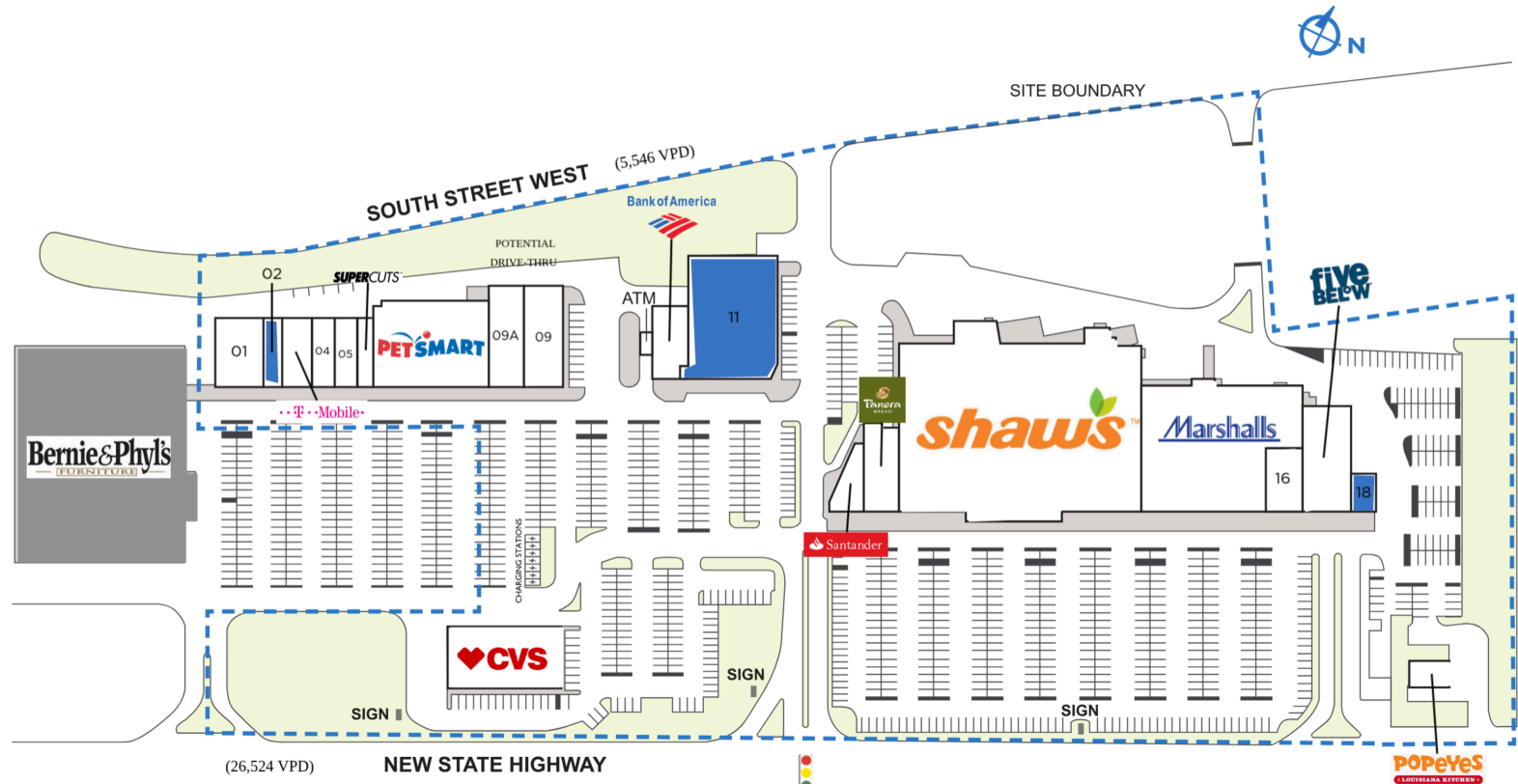

Available
  Occupied
  Coming Available
  Non-Owned
  Site Boundary

DISCLAIMER - This site plan is for general information purposes only and is not intended to constitute representations and warranties by Landlord as to the ownership of the real property depicted herein or the identity or nature of any occupants thereof.

# SHAW'S PLAZA RAYNHAM

300 New State Highway | Raynham, MA 02767

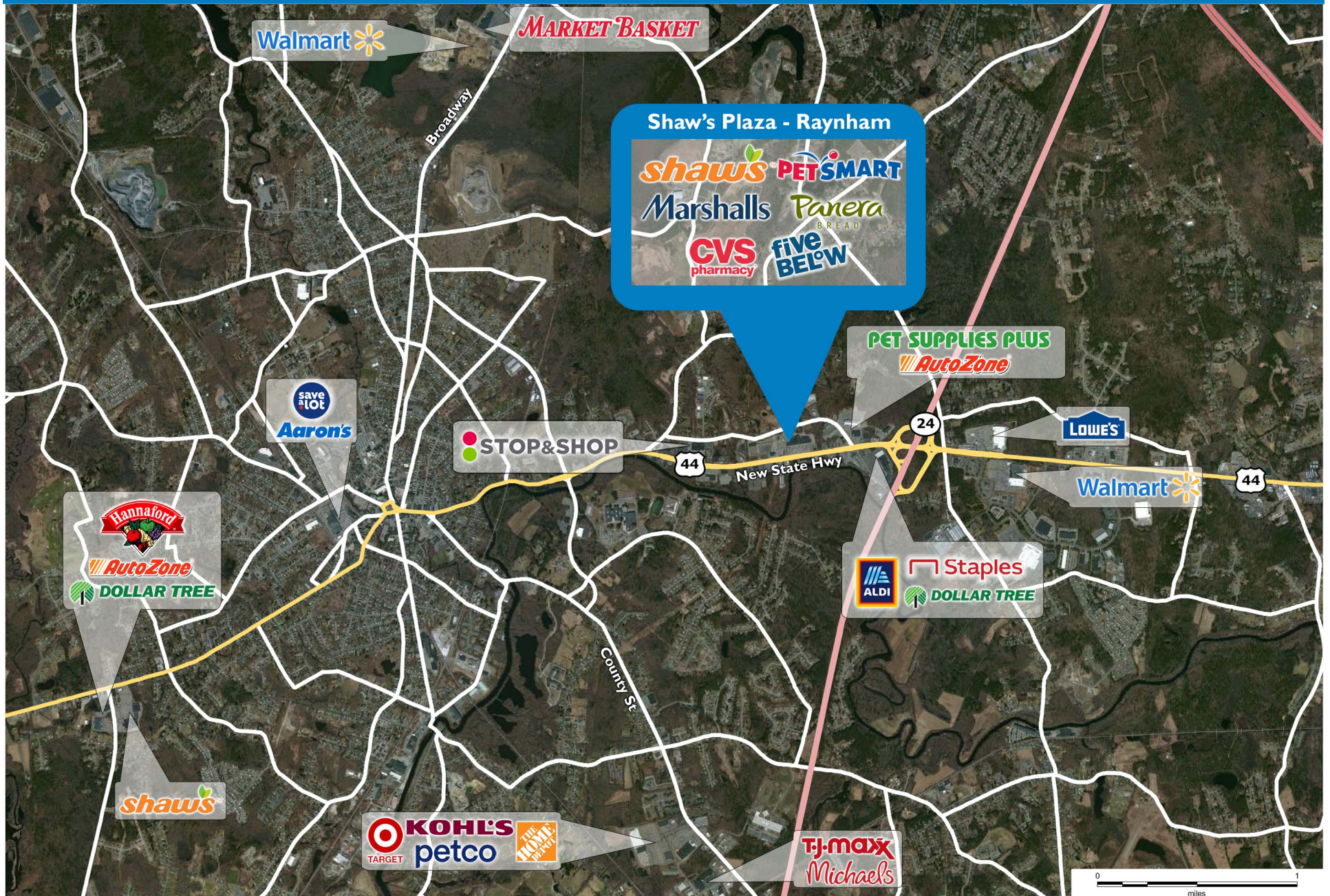

# Demographic Summary Report

1990 - 2000 Census, 2024 Estimates & 2029 Projections

Calculated using TAS Retrieval Retrieval

Jun 2, 2025



Latitude: 41.906768

Longitude: -71.053749

Shaw's Plaza Raynham Raynham, MA		1.00 Mile Radius	3.00 Mile Radius	5.00 Mile Radius
Population	Q4 2024 Estimated Population	2,974	47,643	80,927
	2029 Projected Population	2,999	47,661	81,371
	2010 Census Population	2,640	43,819	73,619
	2000 Census Population	2,530	42,644	71,749
	1990 Census Population	1,929	39,377	63,013
	Historical Annual Growth 1990 to 2000	2.75%	0.80%	1.31%
	Historical Annual Growth 2000 to 2010	0.43%	0.27%	0.26%
	Estimated Annual Growth 2010 to 2024	0.81%	0.57%	0.64%
	Projected Annual Growth 2024 to 2029	0.16%	0.01%	0.11%
	Median Age	47.6	41.8	43.0
Households	Q4 2024 Estimated Households	1,143	19,012	31,541
	2029 Projected Households	1,153	19,012	31,699
	2010 Census Households	992	17,644	28,572
	2000 Census Households	913	16,966	27,422
	1990 Census Households	688	14,928	23,201
	Historical Annual Growth 1990 to 2000	2.87%	1.29%	1.69%
	Historical Annual Growth 2000 to 2010	0.84%	0.39%	0.41%
	Estimated Annual Growth 2010 to 2024	0.96%	0.51%	0.67%
	Projected Annual Growth 2024 to 2029	0.19%	0.00%	0.10%
	Population per Household	2.53	2.47	2.54
Population by Race	White	77.4%	71.4%	76.2%
	Black or African American	6.5%	8.3%	6.7%
	Asian & Pacific Islander	1.6%	1.7%	1.5%
	Other Races	8.8%	10.6%	9.0%
	Hispanic Population	5.7%	7.9%	6.6%
Income	Average Household Income	\$124,316	\$99,159	\$110,331
	Median Household Income	\$113,017	\$76,889	\$85,293
	Per Capita Income	\$48,966	\$40,048	\$43,351
Education (Age 25+)	Elementary	2.9%	6.6%	5.7%
	Some High School	6.2%	7.9%	7.2%
	High School Graduate	30.0%	32.1%	30.6%
	Some College	17.8%	18.4%	18.0%
	Associates Degree Only	10.5%	7.7%	8.5%
	Bachelors Degree Only	22.6%	17.4%	19.7%
	Graduate Degree	10.0%	9.9%	10.3%
Business	Number of Businesses	180	1,795	2,792
	Total Number of Employees	2,488	25,224	36,726
	Employees per Business	13.83	14.05	13.15
	Residential Population per Business	16.53	26.54	28.98

This report was produced using data from private and government sources deemed to be reliable and is herein provided without representation or warranty.