



FOR LEASE

**350-352 Cleveland Place
Virginia Beach, VA**

Ricky Anderson
Executive Vice President
+1 757 217 1892
ricky.anderson@colliers.com

Perry Frazer
Executive Vice President
+1 757 228 1833
perry.frazer@colliers.com

150 West Main Street
Suite 1100
Norfolk, VA 23510
P: +1 757 490 3300

PROPERTY DETAILS

- **BUILDING SIZE:** ±12,800 SF flex building
- **ZONING:** I-1 (Light Industrial District)
- **LOADING:** Each unit has (1) - 9' x 10' roll up door
- **LAYOUT:** Unit dimensions are 38' x 20' with one small office
- **LOCATION:** Centrally located off Cleveland Street near Witchduck Road, minutes to I-264 and Virginia Beach Town Center

Small flex spaces available for lease

	Size	Lease Rate
Available Space		(net utilities + janitorial)
Suite 103	800 SF	\$1,100 per month
Suite 105	800 SF	\$1,100 per month
Suites 112-113	800 SF up to 1,600 SF	\$2,200 per month



FLOOR PLANS

±800 SF Unit

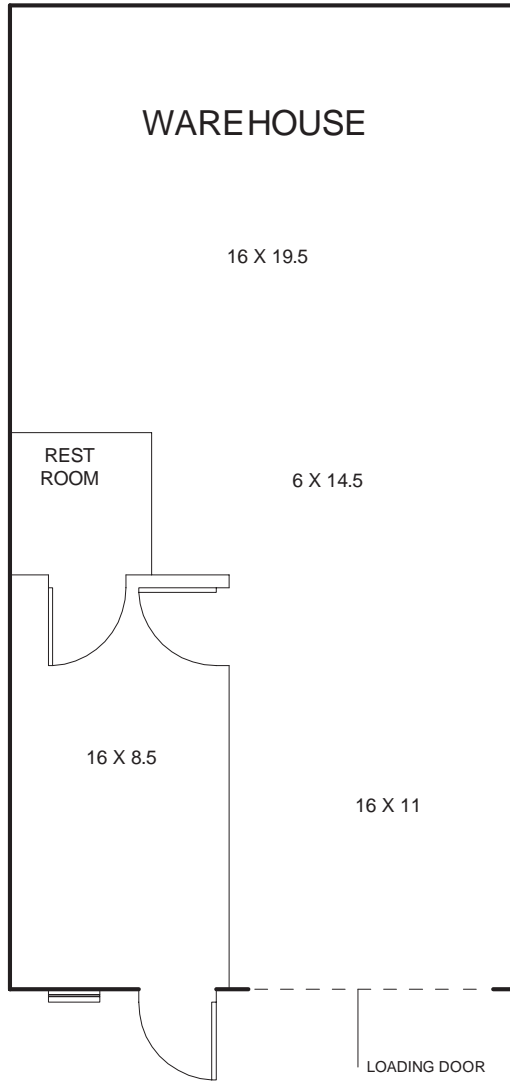

±1,600 SF Unit

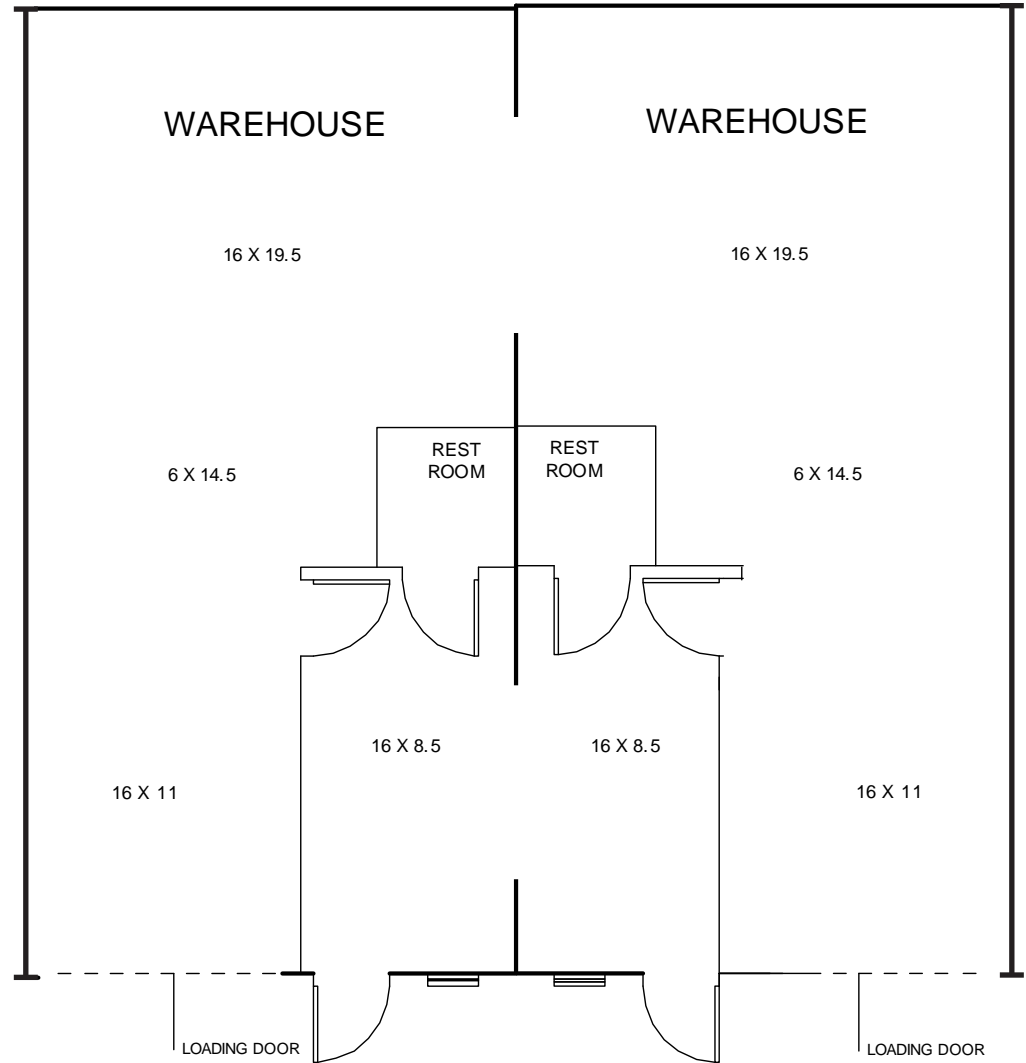

SITE AERIAL



350-352 Cleveland Place, Virginia Beach, VA



Colliers

150 West Main Street
Suite 1100
Norfolk, VA 23510
P: +1 757 490 3300

Ricky Anderson

Executive Vice President
+1 757 217 1892
ricky.anderson@colliers.com

Perry Frazer

Executive Vice President
+1 757 228 1833
perry.frazer@colliers.com

350-352 Cleveland Pl



This document has been prepared by Colliers International for advertising and general information only. Colliers International makes no guarantees, representations or warranties of any kind, expressed or implied, regarding the information including, but not limited to, warranties of content, accuracy and reliability. Any interested party should undertake their own inquiries as to the accuracy of the information. Colliers International excludes unequivocally all inferred or implied terms, conditions and warranties arising out of this document and excludes all liability for loss and damages arising therefrom. This publication is the copyrighted property of Colliers International and/or its licensor(s). ©2026. All rights reserved.