

**FOR LEASE**

# McK Business Park

3010 Mine Road / Fredericksburg, VA. 22408



**CUSHMAN &  
WAKEFIELD**

**THALHIMER**

**VIRGIL NELSON, CCIM**

Senior Vice President

540 322 4150

[virgil.nelson@thalhimer.com](mailto:virgil.nelson@thalhimer.com)

**WILSON GREENLAW, CCIM, SIOR**

First Vice President

540 322 4156

[wilson.greenlaw@thalhimer.com](mailto:wilson.greenlaw@thalhimer.com)

**Industrial Available**

**14,400 – 135,000 SF**

# PROPERTY HIGHLIGHTS



## PROPERTY FEATURES

- Total SF available: 135,000 SF
- Multiple configurations available from 14,400 to 135,000 SF
- Units available with docks and drive-in doors
- Outdoor storage available
- Zoned I2 heavy industrial
- Access to I-95 and Route 301

## CURRENT AVAILABILITIES

Unit	SF	Lease Rate	Timing
B	32,000	\$6.95 PSF NNN (\$0.80)	Now
C	14,400	\$6.95 PSF NNN (\$0.80)	Feb. 2025
F	24,000	\$6.95 PSF NNN (\$0.80)	Aug. 2025
G	45,000	\$6.95 PSF NNN (\$0.80)	Oct. 2024

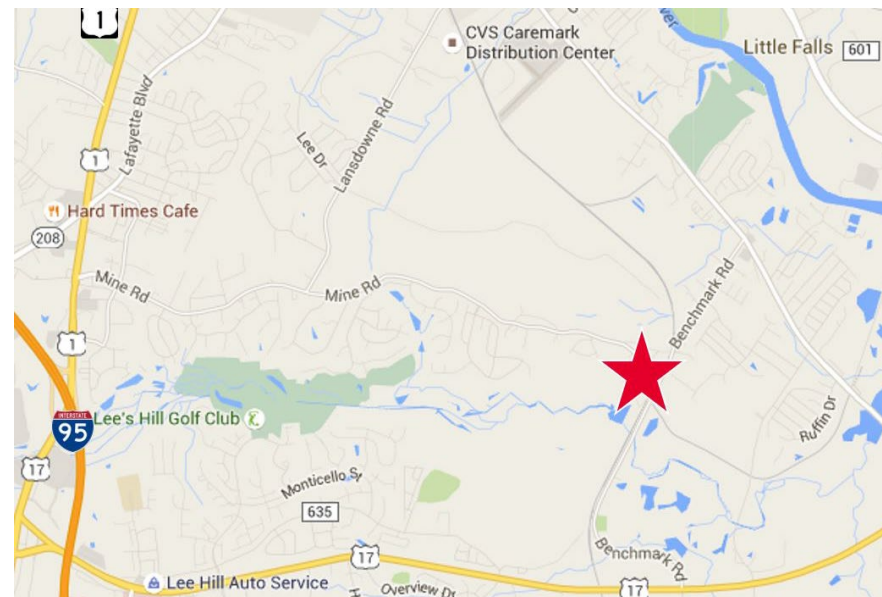

# PROPERTY SITE PLAN

Spaces range from manufacturing to distribution to shop. NNN = \$0.80 PSF. Additional acreage available on-site. Located at the intersection of Benchmark Road and Mine Road, it is convenient to the Route 2 corridor, Lee's Hill and Massaponax. McK Business Park also provides excellent access to I-95 and Route 301.



BUILDING NUMBER & ADDRESS	TOTAL SF	DOCKS	CLEAR HEIGHT	DRIVE-IN DOORS	POWER (AMPS)	PRODUCTION/ WAREHOUSE FACILITY SF	OFFICE SF	BUILT
<b>BUILDING B</b> 3000 Mine Road	32,000 SF	2	19'	3	1,800	32,000	0	1970
<b>BUILDING C</b> 3004 Mine Road	14,400 SF	0	24'	1	1,200	14,400 (Storage Only)	0	1969
<b>BUILDING F</b> 3006 Mine Road	24,000 SF	1	24'	3	1,600	24,000	196	1978/ 1990
<b>BUILDING G</b> 3018 Mine Road	45,000 SF	2	24'	1	4,000	45,000	0	1978

\*Additional options may be available; Inquire with broker

# FLOOR PLANS

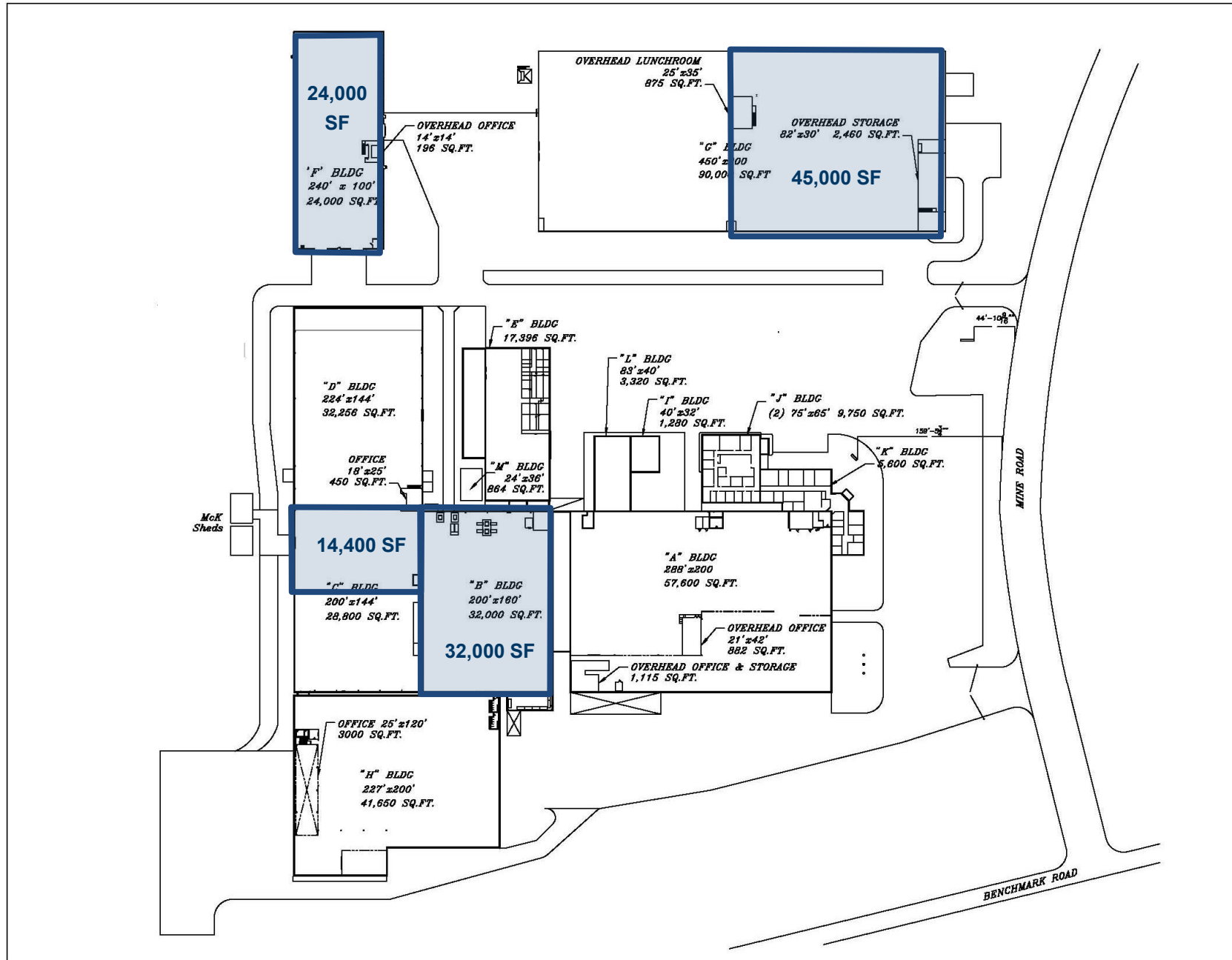

# FLOOR PLANS

**Building B**  
32,000 SF  
19' Clear

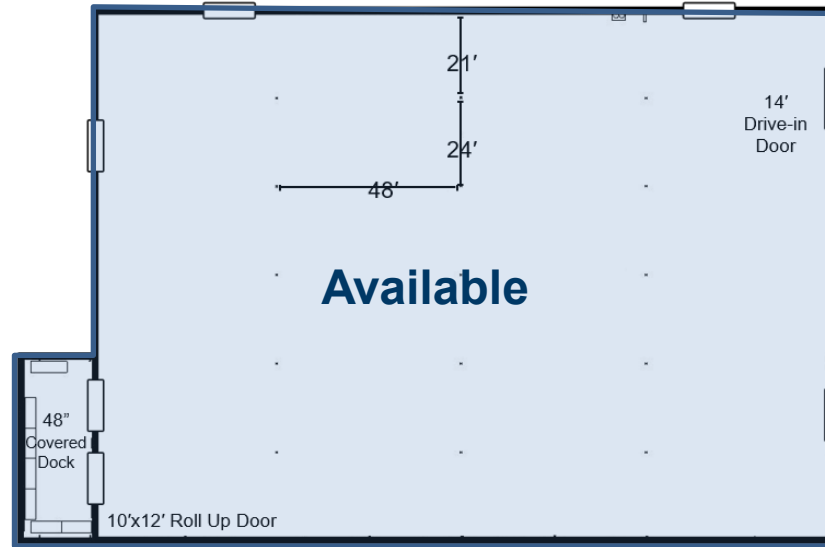

**Building C**  
14,400 SF  
24' Clear



# FLOOR PLANS

**Building F**  
24,000 SF  
24' Clear



**Building G**  
45,000 SF  
24' Clear

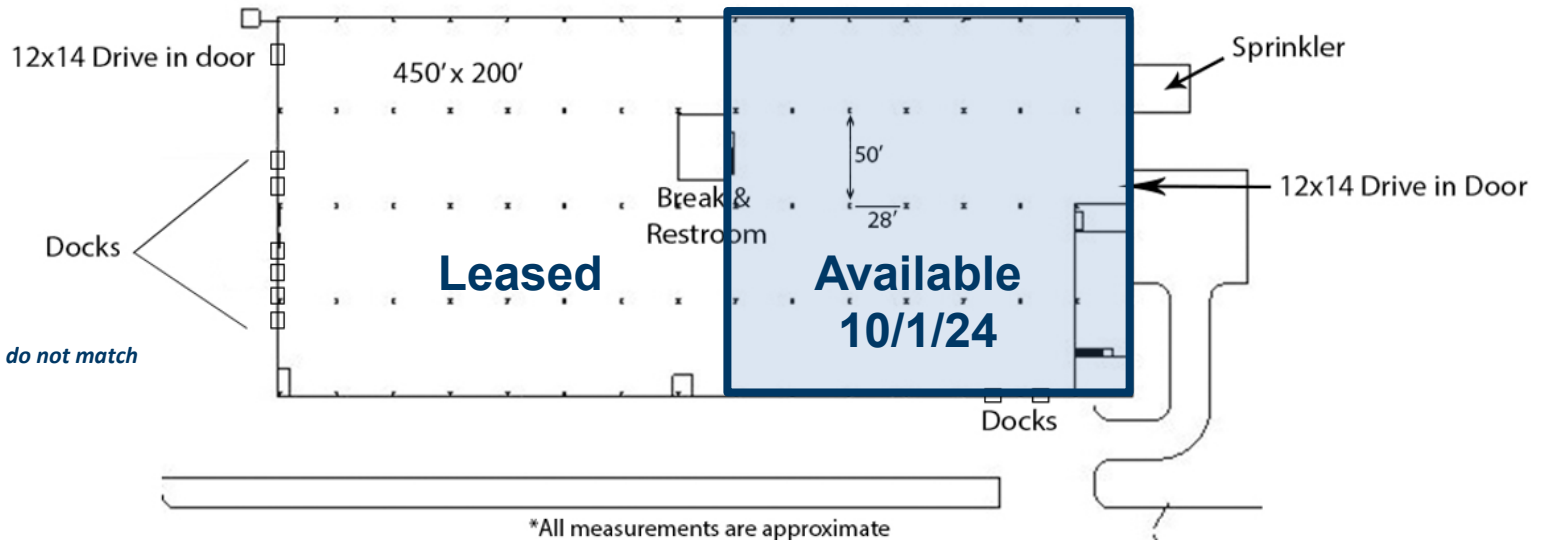

*\*Please Note: Scales do not match*

# PROPERTY AERIAL MAP



3000 – 3020 Mine Road

**VIRGIL NELSON, CCIM**  
Senior Vice President  
540 322 4150  
virgil.nelson@thalhimer.com

**WILSON GREENLAW, CCIM, SIOR**  
First Vice President  
540 322 4156  
wilson.greenlaw@thalhimer.com

1125 Emancipation Hwy. Suite 350  
Fredericksburg, VA 22401  
[www.thalhimer.com](http://www.thalhimer.com)

*Independently Owned and Operated / A Member of the Cushman & Wakefield Alliance*

*Cushman Wakefield | Thalhimer ©2024. No warranty or representation, express or implied, is made to the accuracy or completeness of the information contained herein, and same is submitted subject to errors, omissions, change of price, rental or other conditions, withdrawal without notice, and to any special listing conditions, imposed by the property owner(s). As applicable, we make no representation as to the condition of the property (or properties) in question.*