

GENERAL FLOOR PLAN NOTES:

- A. DO NOT SCALE DRAWINGS - USE DIMENSIONS AND NOTES ONLY.
- B. FIELD VERIFY ANY EXISTING CONSTRUCTION, CONFIGURATION AND DIMENSIONS.
- C. CONTRACTOR TO CONFIRM ALL DIMENSIONS AGAINST ACTUAL SITE CONDITIONS. ANY CONFLICT OR DISCREPANCIES IN DIMENSIONS OR ELEVATIONS SHALL BE RESOLVED WITH THE ARCHITECT PRIOR TO PROCEEDING WITH THE WORK OR PROCUREMENT OF MATERIALS.
- D. GENERAL CONTRACTOR SHALL BE RESPONSIBLE FOR DISTRIBUTION OF COMPLETE SETS OF CONTRACT DOCUMENTS (DRAWINGS & SPECIFICATIONS) TO ALL TRADES. EACH TRADE SHALL REVIEW ALL CONTRACT DOCUMENTS SO AS TO BE AWARE OF ALL ITEMS OF WORK AFFECTING THEIR RESPECTIVE TRADE. NO CLAIMS FOR "EXTRAS" WILL BE HONORED DUE TO FAILURE TO REVIEW COMPLETE SET OF DOCUMENTS.
- E. EGRESS DOORS SHALL NOT LOCK AGAINST THE DIRECTION OF EGRESS TRAVEL.
- F. ALL NEW WOOD FRAMING, SHEATHING, BLOCKING, ETC., SHALL BE FIRE RETARDANT TREATED. PROVIDE FIRE RETARDANT TREATED WOOD BLOCKING AT WALL AND CEILING FRAMING FOR ANCHORAGE OF ELEMENTS TO BE FASTENED OVER FINISHED SURFACES INCLUDING, BUT NOT LIMITED TO: WALL BUMPERS, HANDRAILS, GRAB BARS, WOOD TRIM, TOILET ACCESSORIES, AND WALL MOUNTED EQUIPMENT. INTERIOR DIMENSIONS ARE GIVEN TO THE FINISHED FACE OF WALL CONSTRUCTION, UNLESS NOTED OTHERWISE.
- H. PROVIDE CONTROL JOINTS IN GYPSUM BOARD AT SPACING NOT EXCEEDING 30'-0" O.C. AT LONG STRAIGHT RUNS OF WALL OR SOFFIT. IN FIRE RATED PARTITIONS, PROVIDE FIRE RATED CONTROL JOINTS. DO NOT ALLOW BRACING TO SPAN ACROSS CONTROL JOINTS. CONTROL JOINTS SHALL CONSIST OF DOUBLE STUDS OR DOUBLE FURRING CHANNELS AS PROVIDED BY CONTRACTOR.
- I. GENERAL CONTRACTOR MUST KEEP THE APPROVED SET OF BID DOCUMENTS ON SITE AT ALL TIMES.
- J. REFER TO PLAN FOR FIRE EXTINGUISHER CABINET (FEC) LOCATIONS. SEMI-RECESSED FIRE EXTINGUISHER CABINET AS NOTED IN SPECIFICATIONS. OWNER TO PROVIDE ADDITIONAL FIRE EXTINGUISHER CABINETS (FEC) AS PER FIRE MARSHAL'S REQUEST. COORDINATE ALL LOCATIONS WITH ARCHITECT PRIOR TO INSTALLATION. REPAIR EXISTING SURFACES TO REMAIN AS NEEDED DUE TO THE DEMOLITION OR THE REMOVAL OF CONSTRUCTION. REFER TO DEMOLITION PACKAGE.
- L. REPAIR HOLES IN EXISTING PARTITIONS TO REMAIN WHERE PARTITION MOUNTED ITEMS HAVE BEEN REMOVED.
- M. PATCH AND REPAIR EXISTING UNDERLAYMENT WHERE REQUIRED TO ACCOMMODATE NEW FINISH.
- N. PATCH AND REPAIR ALL EXISTING DOOR FRAMES AS NEEDED.
- O. REFERENCE FINISH SHEET FOR FINISH INFORMATION.

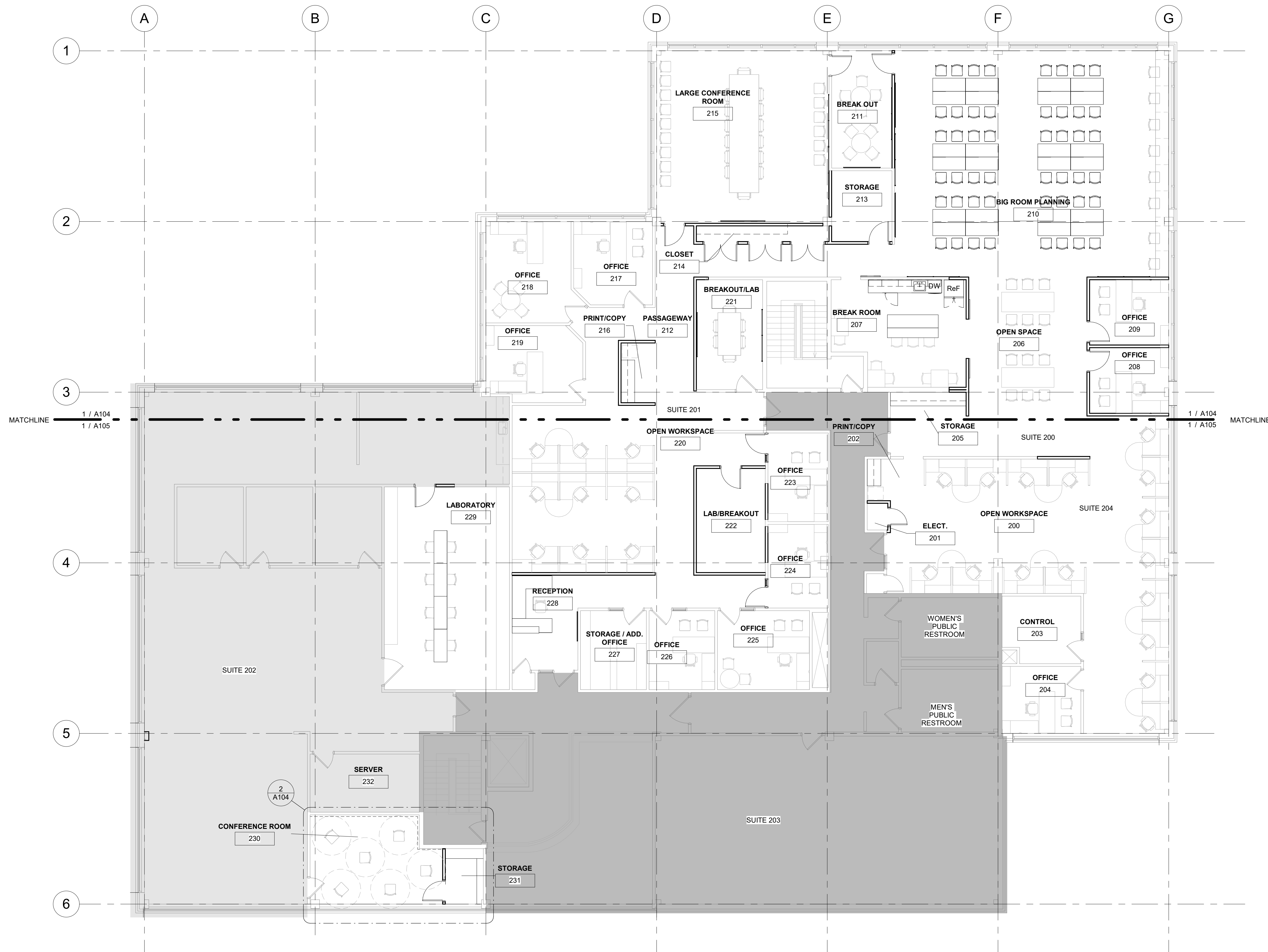

1 SECOND FLOOR - OVERALL
1/8" = 1'-0"

PROJECT: DCS - OFFICE RENOVATION - NASHUA, NEW HAMPSHIRE
 CLIENT: DCS CORPORATION
 OVERALL FLOOR PLAN

NO.	DATE	DESCRIPTION	BY	APP'D
G	02/09/2021	DESIGN REVIEW		
F	02/05/2021	DESIGN DEVELOPMENT 60%		
E	02/02/2021	DESIGN REVIEW		
D	01/26/2021	DESIGN REVIEW		
C	01/22/2021	CONCEPT DESIGN 30%		
B	01/19/2021	DESIGN REVIEW		
A	01/12/2021	DESIGN REVIEW		

NOTE: "THIS SEAL APPLIES ONLY TO THIS DOCUMENT. I DISCLAIM ANY RESPONSIBILITY FOR ALL OTHER DOCUMENTS OR INSTRUMENTS RELATING TO OR INTENDED TO BE USED FOR ANY PART OR PARTS OF THIS PROJECT OR ANY OTHER PROJECT."

VESTAL CORPORATION
 1 The Pines Court, Suite A
 Chesterfield, MO 63141
 Tel: (314) 439-9900
 Fax: (314) 439-9906
 www.vestalcorporation.com
 engineers • architects • construction consultants

DATE	2021.02.09
SCALE	As indicated
PROJECT NUMBER	201310
SHEET	A103
REV	G
APPROVED BY	PS
CHECKED BY	PS

2/12/2021 12:53:43 PM