

# ±3,269 - 29,195 Square Feet Total 5 INDUSTRIAL BUILDINGS FOR SALE



## COMPLETELY REFURBISHED BUILDINGS!

### 10925-10950 VULCAN ST., SOUTH GATE, CA

***Voit***

REAL ESTATE SERVICES

**DAN BERKENFIELD**  
Senior Vice President, Partner  
(562) 833-7011  
dberkenfield@voitco.com  
Lic. # 01706467





**RACHEL BURNERY**  
Associate  
(562) 533-4225  
rburney@voitco.com  
Lic. # 02217852

**MATT PETERS**  
Vice President  
(949) 629-7176  
matt.peters@srsre.com  
Lic. # 02065503





## AVAILABLE UNITS AND SALE PRICES

	Address	Bldg SF	Land SF	Availability	APN	Pricing
	10925 Vulcan St.	±6,478	±15,003	Now	6234-004-021	\$1,710,000
	10935 Vulcan St.	±3,269	±7,770	Now	6234-004-022	\$950,000
	10932 Vulcan St.	±6,478	±17,097	Now	6234-004-032	\$1,725,000
	10940 Vulcan St.	±6,490	±18,923	Now	6234-004-031	\$1,750,000
	10950 Vulcan St.	±6,480	±19,650	Now	6234-004-030	\$1,775,000
<b>Totals</b>		<b>±29,195</b>	<b>±78,443</b>			<b>\$7,910,000</b>



Address:	10925 Vulcan St
Bldg Size:	±6,478 SF
Available:	Now
Pricing:	\$1,710,000

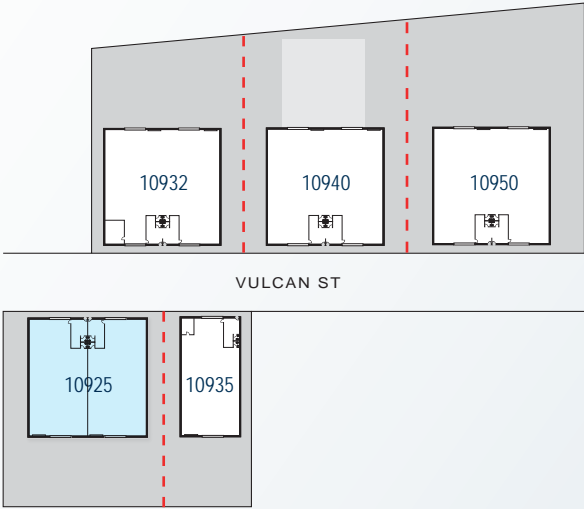

## Building Features



±6,478 SF Building on ±15,003 SF of Land



43% Building Coverage



Minimum 14' Clear Height / Clearspan



Upgrades: LED Lights, Tex-Cote Roof Paint, Interior Finishes, Electrical Upgrades



Four (4) Restrooms



Four (4) Oversized Grade Level Doors (12' x 14')



400 Amps, 240 Volts, 3-Phase Electrical (verify)



Existing Crane



Fenced and Paved Yard with Outdoor Lighting



Drive Through and Drive Around Access



Divisible to Two (2) Clearspan Units, Separately Metered

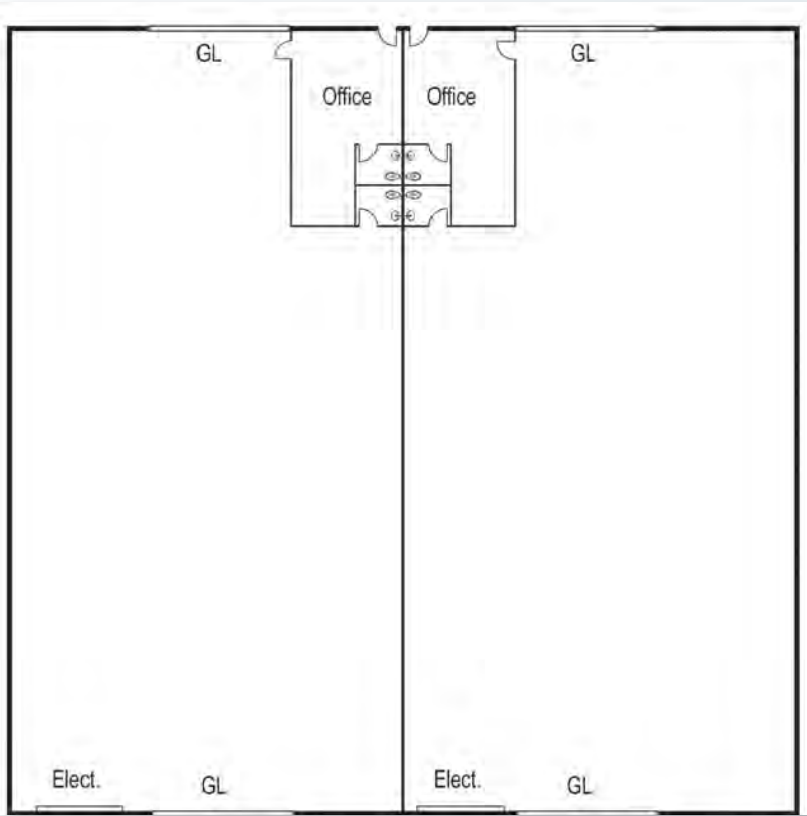

**Address:** 10935 Vulcan St  
**Bldg Size:** ±3,269 SF  
**Available:** Now  
**Pricing:** \$950,000

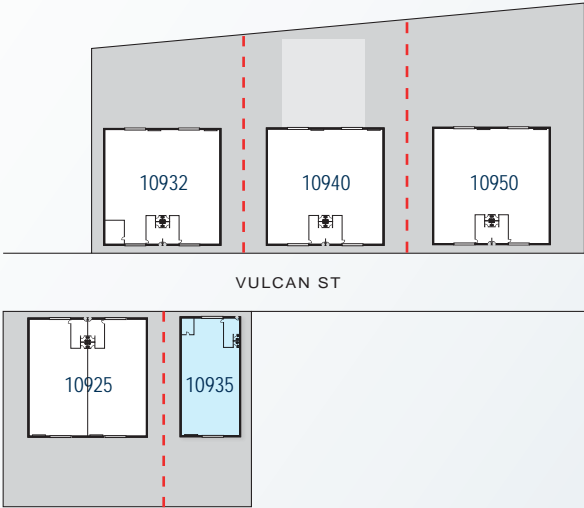

## Building Features



±3,269 SF Building on ±7,770 SF of Land



42% Building Coverage



Minimum 14' Clear Height / Clearspan



Upgrades: LED Lights, Tex Cote Roof Paint, Interior Finishes, Electrical Upgrades



Two (2) Restrooms



Two (2) Oversized Grade Level Doors (12' x 14')



400 Amps, 240 Volts, 3-Phase Electrical (verify)



Existing Crane



Fenced and Paved Yard with Outdoor Lighting



Drive Through



Divisible to Two (2) Clearspan Units, Separately Metered

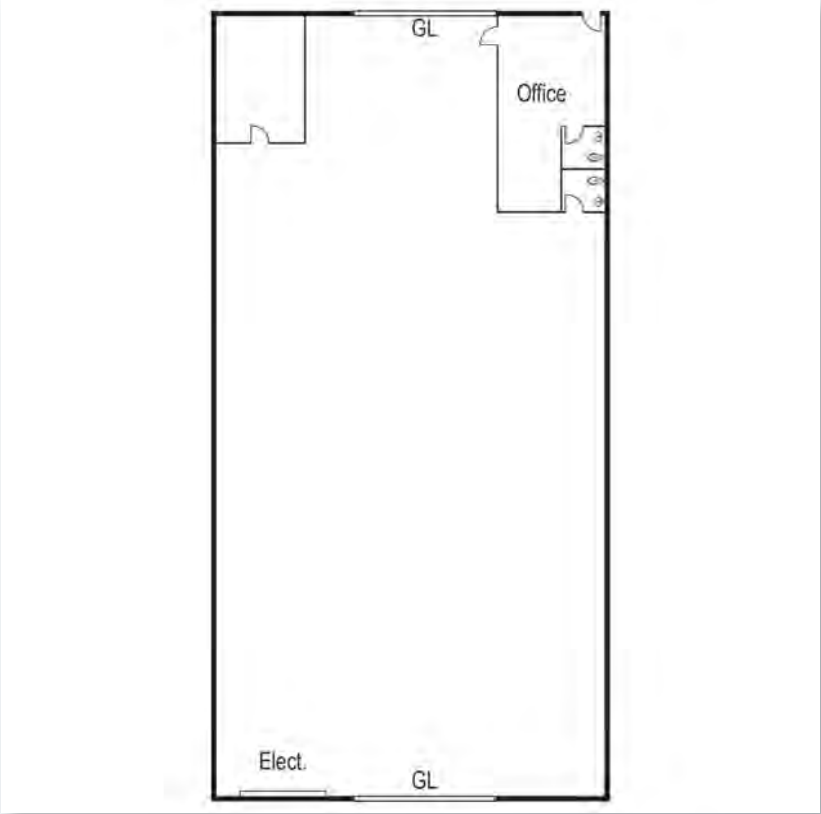

**Address:** 10932 Vulcan St  
**Bldg Size:** ±6,478 SF  
**Available:** Now  
**Pricing:** \$1,725,000

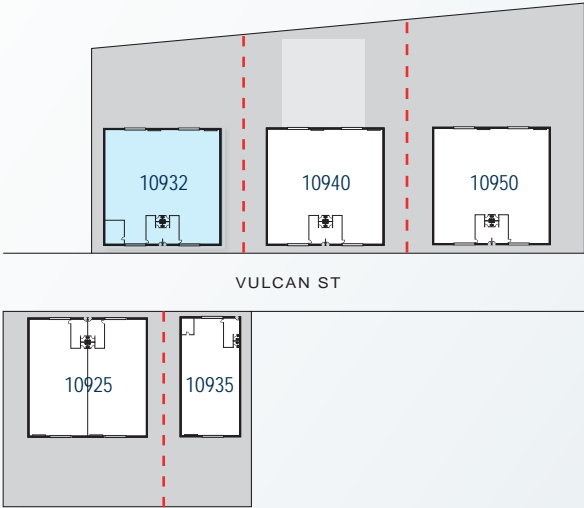

## Building Features



±6,478 SF Building on ±17,097 SF of Land



38% Building Coverage



Minimum 14' Clear Height / Clearspan



Upgrades: LED Lights, Tex Cote Roof Paint, Interior Finishes, Electrical Upgrades



Four (4) Restrooms



Four (4) Oversized Grade Level Doors (12' x 14')



400 Amps, 240 Volts, 3-Phase Electrical (verify)



Fenced and Paved Yard with Outdoor Lighting



Drive Through and Drive Around Access



Divisible to Two (2) Clearspan Units, Separately Metered

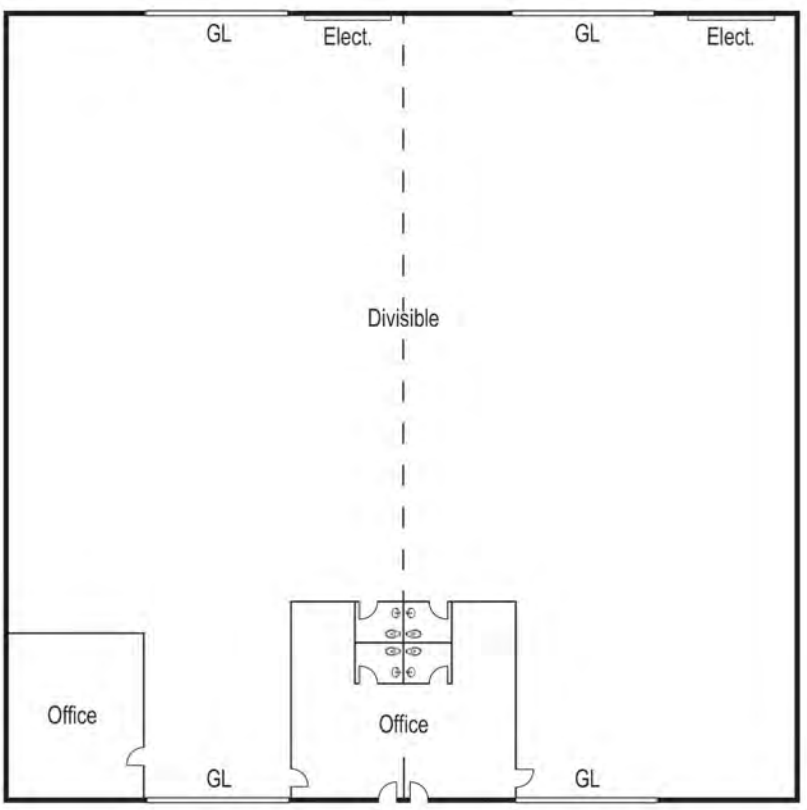

**Address:** 10940 Vulcan St  
**Bldg Size:** ±6,490 SF  
**Available:** Now  
**Pricing:** \$1,750,000

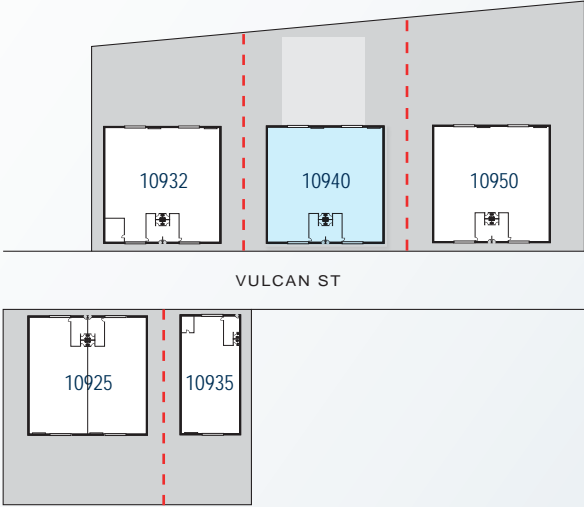

## Building Features



±6,490 SF Building on ±18,923 SF of Land



34% Building Coverage



Minimum 14' Clear Height / Clearspan



Upgrades: LED Lights, Tex Cote Roof Paint, Interior Finishes, Electrical Upgrades



Four (4) Restrooms



Four (4) Oversized Grade Level Doors (12' x 14')



400 Amps, 240 Volts, 3-Phase Electrical (verify)



Fenced and Paved Yard with Outdoor Lighting



Drive Through and Drive Around Access



Divisible to Two (2) Clearspan Units, Separately Metered

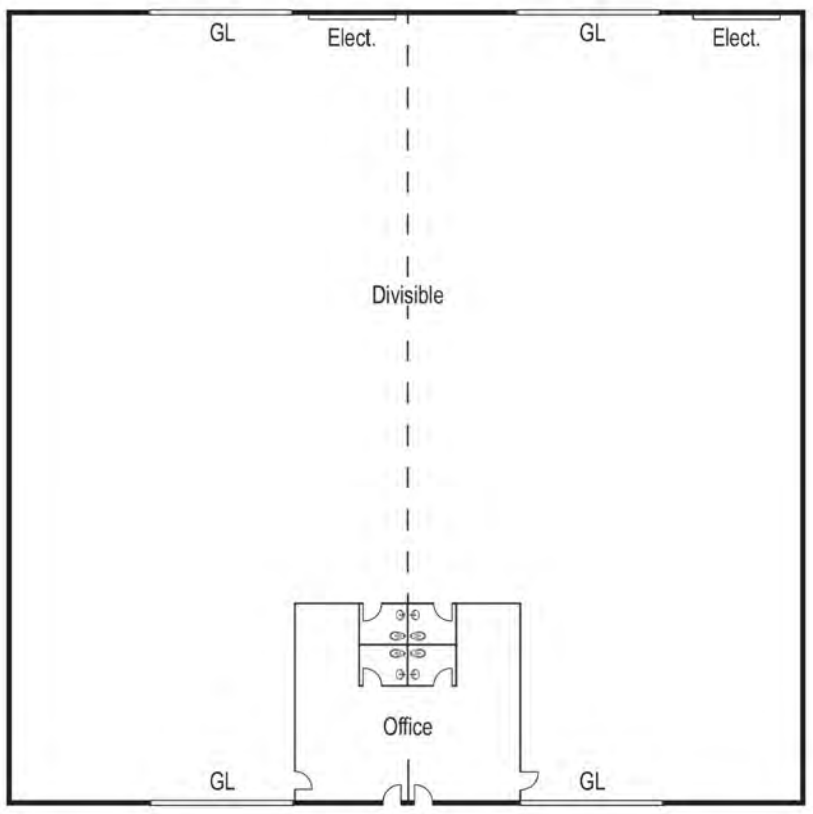

**Address:** 10950 Vulcan St  
**Bldg Size:** ±6,480 SF  
**Available:** Now  
**Pricing:** \$1,775,000

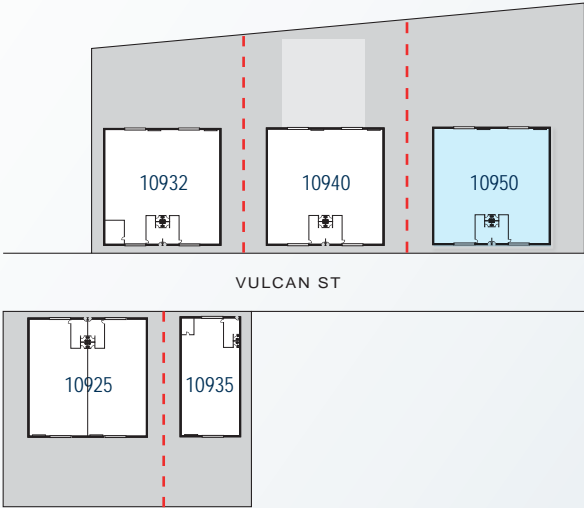

## Building Features



±6,480 SF Building on ±19,650 SF of Land



33% Building Coverage



Minimum 14' Clear Height / Clearspan



Upgrades: LED Lights, Tex Cote Roof Paint, Interior Finishes, Electrical Upgrades



Four (4) Restrooms



Four (4) Oversized Grade Level Doors (12' x 14')



400 Amps, 240 Volts, 3-Phase Electrical (verify)



Fenced and Paved Yard with Outdoor Lighting



Drive Through and Drive Around Access



Divisible to Two (2) Clearspan Units, Separately Metered

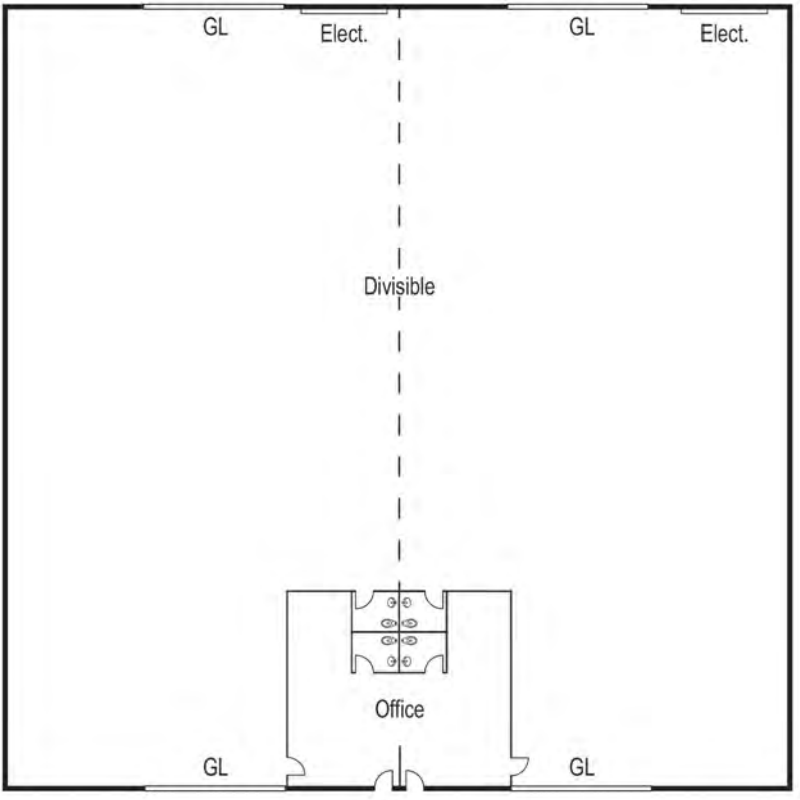











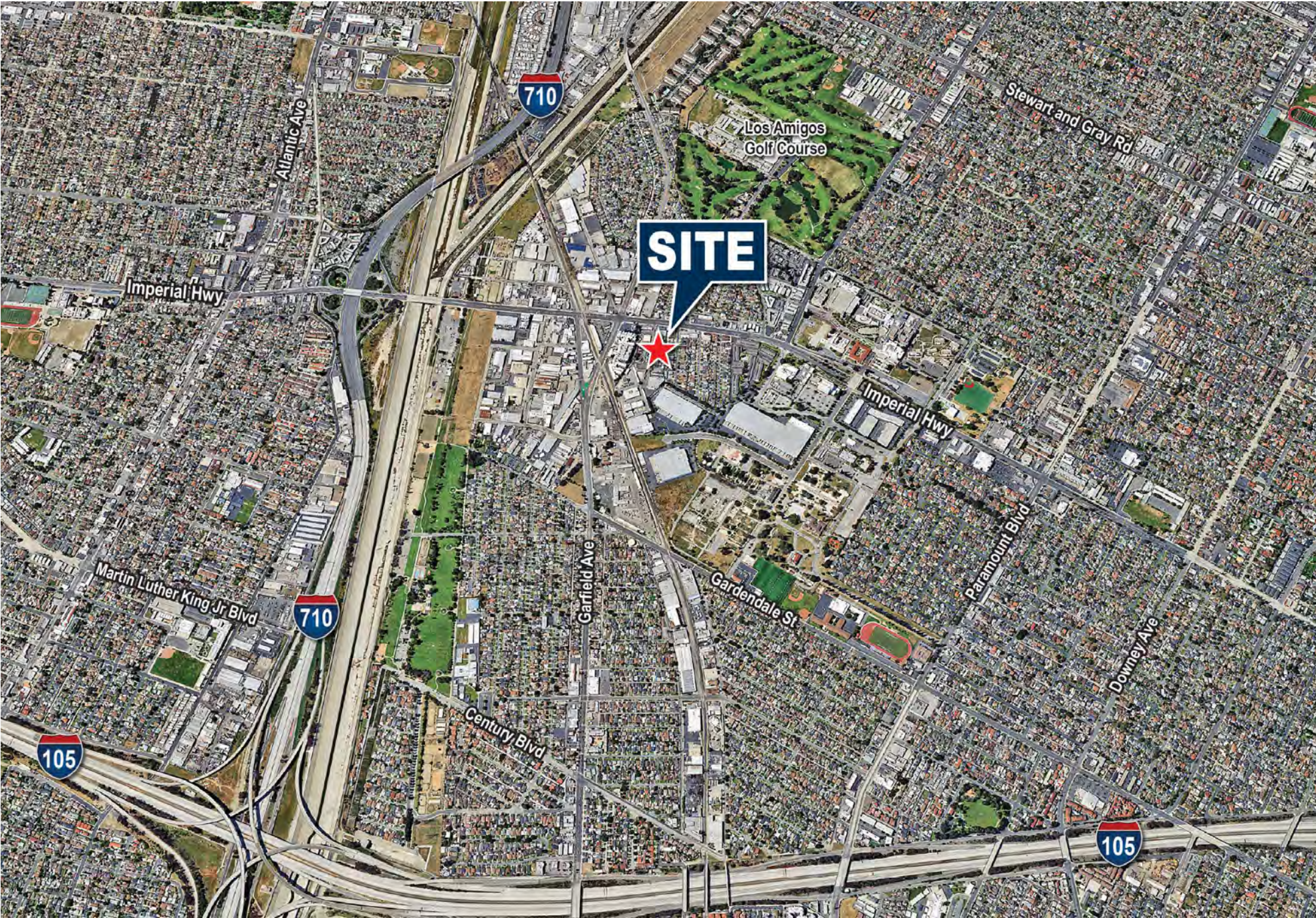



# ±3,269 - 29,195 Square Feet Total 5 INDUSTRIAL BUILDINGS FOR SALE

## 10925-10950 VULCAN ST., SOUTH GATE, CA

*For More Information, Please Contact:*

***Voit***

REAL ESTATE SERVICES

**DAN BERKENFIELD**

Senior Vice President, Partner

(562) 833-7011

[dberkenfield@voitco.com](mailto:dberkenfield@voitco.com)

Lic. # 01706467

**RACHEL BURNERY**

Associate

(562) 533-4225

[rburney@voitco.com](mailto:rburney@voitco.com)

Lic. # 02217852

**MATT PETERS**

Vice President

(949) 629-7176

[matt.peters@srsre.com](mailto:matt.peters@srsre.com)

Lic. # 02065503

