



4063 Salisbury Road
Suite 210
Jacksonville, FL 32216

\$15/SF FS
\$1,080/month

Watson Commercial Realty Inc.
4685 Sunbeam Road, Suite 4
Jacksonville, FL 32257
904-200-1030
Will Messer

 **LoopNet Listing ID #30699274**



4063 Salisbury Road, Suite 210, Jacksonville, FL 32216 Office

Square Footage = 864

• Offices = 4

• Conference Room = 1



4063 Salisbury Road, Suite 210, Jacksonville, FL 32216

Floor plan

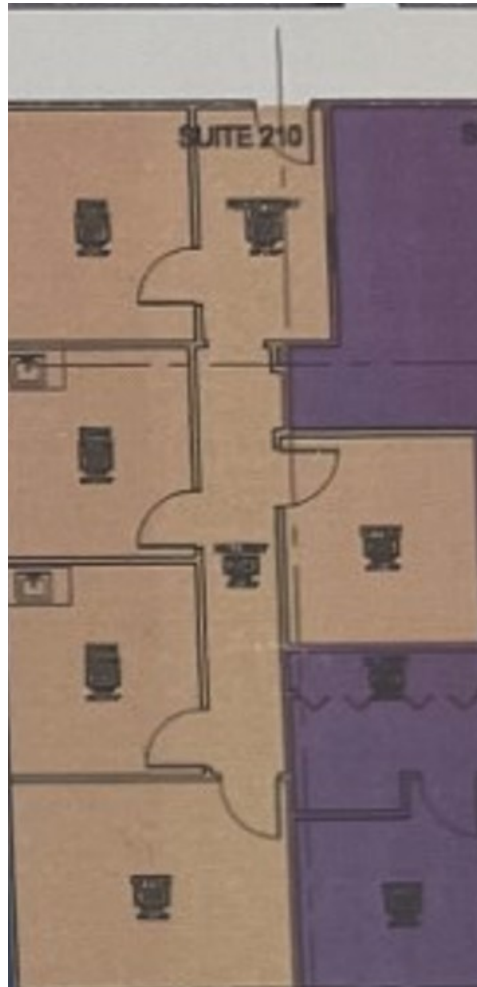

WILL MESSER

Commercial Sales Associate

Mobile: **904-200-1030**

Email: **wmesser@watsoncommercial.com**

Web: **WatsonCommercial.com**

Leading
REAL ESTATE
COMPANIES
OF THE WORLD

4063 Salisbury Road, Suite 210, Jacksonville, FL 32216

Office



WILL MESSER

Commercial Sales Associate

Mobile: **904-200-1030**

Email: **wmesser@watsoncommercial.com**

Web: **WatsonCommercial.com**



4063 Salisbury Road, Jacksonville, FL 32216

Building Overview



Suite Types:	Medical and Professional Offices
Building Size (RSF):	41,102 SF
Parking (#):	190
Lease Rate:	\$15/SF FS

Demographics—CoStar, Census

Proximity:	1 mile	3 miles	5 miles
Total Population:	4,477	66,697	162,624
Average Age:	38.8	38.0	37.6
Households:	2,481	35,077	84,127
2022 Avg. HH Inc.	\$71,686	\$74,815	\$78,896

 LoopNet® Listing ID #30699274



WILL MESSER
Commercial Sales Associate

Mobile: **904-200-1030**
Email: **wmesser@watsoncommercial.com**
Web: **WatsonCommercial.com**



4063 Salisbury Road, Jacksonville, FL 32216

Location

- I-95=.7mi./2 min.
- I-202/JTB=1.3mi./4 min.
- US-1/Philips=1.7mi./4 min.
- St. Johns Town Center=4.6mi./9 min
- I-295=7.5mi./9 min.
- Downtown Jacksonville=6.3mi/10 min



WILL MESSER

Commercial Sales Associate

Mobile: **904-200-1030**
Email: **wmesser@watsoncommercial.com**
Web: **WatsonCommercial.com**

Leading
REAL ESTATE
COMPANIES
OF THE WORLD