



2600 WILLOUGHBY BEACH ROAD

EDGEWOOD, MARYLAND 21040

FOR
SALE



MACKENZIE

COMMERCIAL REAL ESTATE SERVICES, LLC

PROPERTY OVERVIEW

HIGHLIGHTS:

- Rare turnkey ready religious facility available
- Plenty of onsite parking
- 14+ acres of land zoned R3
- Close proximity to Edgewood High School
- Within 2 miles of Route 40



BUILDING SIZE:

15,044 SF ±

LOT SIZE:

14.807 ACRES ±

YEAR BUILT:

1982

ZONING:

R3

SALE PRICE:

\$1,800,000



GOOGLE STREET VIEW

FLOOR PLAN

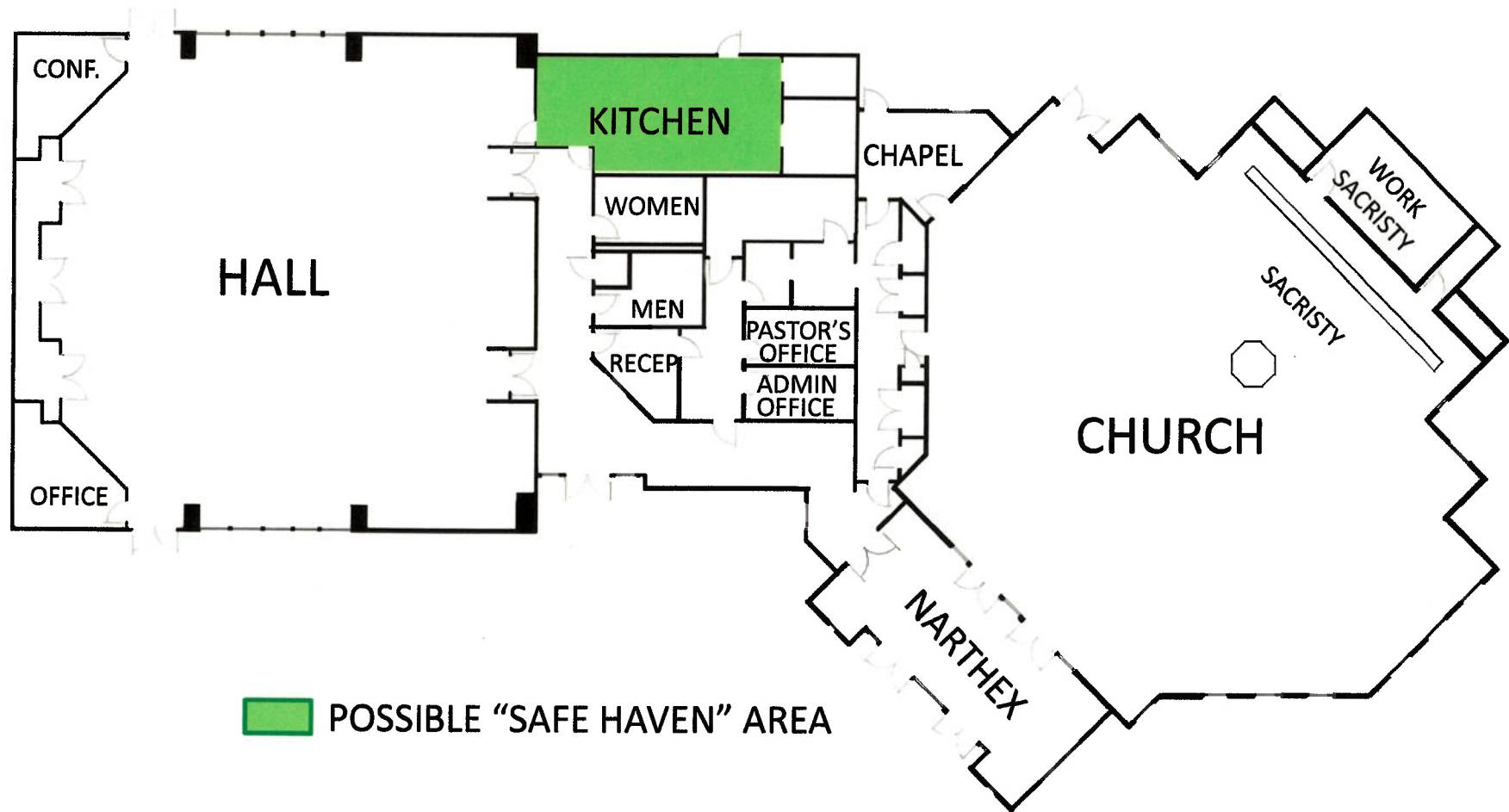

MARKET AERIAL



DEMOGRAPHICS

2025

RADIUS:

1 MILE

3 MILES

5 MILES

RESIDENTIAL POPULATION



8,633

35,633

86,121

DAYTIME POPULATION



6,369

31,344

68,046

AVERAGE HOUSEHOLD INCOME



\$118,338

\$104,600

\$116,550

NUMBER OF HOUSEHOLDS



2,882

13,272

32,745

MEDIAN AGE



39.9

37.3

38.5

FULL DEMOS REPORT



FOR MORE INFO **CONTACT:**



BEETLE SMITH
SENIOR VICE PRESIDENT

443.573.3219
BSMITH@mackenziecommercial.com



TOM MOTTLEY
SENIOR VICE PRESIDENT & PRINCIPAL

443.573.3217
TMOTTLEY@mackenziecommercial.com



JOHN MICHAEL
REAL ESTATE ADVISOR

443.573.3207
JMICHAEL@mackenziecommercial.com



VISIT **PROPERTY PAGE** FOR MORE INFORMATION.



MACKENZIE
COMMERCIAL REAL ESTATE SERVICES, LLC

410-879-1900

3465 Box Hill Corporate Center Drive, Suite F
Abingdon, MD 21009

OFFICES IN: ANNAPOLIS, MD BALTIMORE, MD **BEL AIR, MD** COLUMBIA, MD LUTHERVILLE, MD CHARLOTTESVILLE, VA

www.MACKENZIECOMMERCIAL.com

No warranty or representation, expressed or implied, is made as to the accuracy of the information contained herein, and same is submitted subject to errors, omissions, change of price, rental or other conditions, withdrawal without notice, and to any specific listing conditions imposed by our principals.