

FOUNTAIN VALLEY MEDICAL + CENTER



Contact us:

John Wadsworth

Senior Vice President
Healthcare Services
License No. 01177404
949 724 5528

john.wadsworth@colliers.com

Aaron Phillips

First Vice President
Healthcare Services
License No. 01769480
949 724 5562

aaron.phillips@colliers.com

FOR LEASE | 11100 WARNER AVE | FOUNTAIN VALLEY

Medical Office Space for Lease

On-Campus at Fountain Valley Regional Hospital

Colliers International

3 Park Plaza | Suite 1200
Irvine, CA 92614
P: +1 949 724 5500
F: +1 949 724 5600



Building Features

- › 89,434 SF, three-story medical office building
- › Located on the campus of Fountain Valley Regional Hospital
- › Medical space available from 1,045 – 5,134 SF
- › Strong in-place mix roster of healthcare specialties = “built-in” referral sources for new tenants
- › Pharmacy and full service lab on-site
- › Custom suite build-out available
- › Easy access to 405 freeway via Euclid Ave.
- › Free Surface Parking
- › Professionally owned and managed by Healthcare Realty

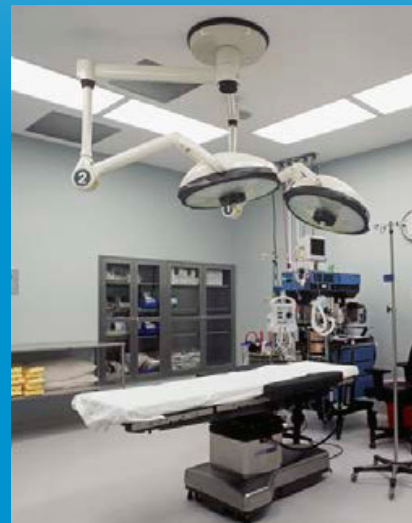

NEW COMMON AREA RENOVATIONS COMPLETE

This document has been prepared by Colliers International for advertising and general information only. Colliers International makes no guarantees, representations or warranties of any kind, expressed or implied, regarding the information including, but not limited to, warranties of content, accuracy and reliability. Any interested party should undertake their own inquiries as to the accuracy of the information. Colliers International excludes unequivocally all inferred or implied terms, conditions and warranties arising out of this document and excludes all liability for loss and damages arising therefrom. This publication is the copyrighted property of Colliers International and/or its licensor(s). ©2017. All rights reserved.



Opened in 1971, Fountain Valley Regional Hospital (FVRH) celebrated its 48 year anniversary in 2019 serving the community of Fountain Valley and surrounding cities. FVRH originally opened as a physician run hospital and now is owned and operated by Tenet Healthcare, a leading provider of healthcare in the US. FVRH is a 413-bed, acute care hospital offering the full spectrum of medical services from a full service emergency department to award winning cardiology care, a comprehensive cancer center, pediatrics and neonatal services including a level III neonatal ICU, OC Institute for orthopedics, imaging and wound care to bariatrics and weight loss. Six medical office buildings are located on the campus of FVRH populated by physician tenants providing a wide range of comprehensive out-patient services, primary and specialty care and wellness programs.

As of 2018, FVRH is the largest employer in the city of Fountain Valley with over 1700 physicians and staff members further reinforcing its commitment to provide quality care to the surrounding community.



Demographics

	1 mile	3 miles	5 miles
2019 Estimate	17,442	258,565	759,574
2024 Projection	18,143	266,972	785,106
% of Population +55	33.36%	25.70%	23.84%
2019 Est. Average Age	42.74	38.27	37.41
Avg. HH Income	\$90,566	\$94,223	\$91,090



FOUNTAIN VALLEY MEDICAL CENTER

FOR LEASE | 11100 WARNER AVE | FOUNTAIN VALLEY



Patient Demand Forecast, Fountain Valley

The Outpatient Market Scenario Planner (MSP), as developed by the Advisory Board, provides current and projected patient utilization estimates for specific specialties in key markets across the US. The MSP tool supports planners, providers and hospital executives to make intelligent business development and strategic decisions to locate or expand programs in targeted markets. The below data is representative of the Fountain Valley zip codes that surround Fountain Valley Medical Center – which include **92683, 92703, 92708, 92704 and 92626**. For more information on the Advisory Board, please visit www.advisory.com.

SERVICE LINES	TODAY'S VOLUME
Urology	13,948
Pulmonology	25,708
Ophthalmology	75,911
Neurology	14,522
Podiatry	13,556
Pain Management	9,482
Orthopedics	37,495
Cosmetic Procedures	7,543
Dermatology	52,975
Gastroenterology	25,114
Endoscopy	46,445
Physical Therapy/Rehabilitation	238,465
Vascular	11,463
ENT	31,780
Nephrology	7,633
Sleep Studies	24,237
Oncology Center	128,804
Ambulatory Surgery	301,063
Psychiatry	131,722
Cardiology	89,584
Oncology	1,922

2021	
5-Year VOLUME	↑
Urology	18,083 29.6%
Pulmonology	33,180 29.1%
Ophthalmology	97,571 28.5%
Neurology	18,554 27.8%
Podiatry	17,127 26.3%
Pain Management	11,942 26.0%
Orthopedics	46,716 24.6%
Cosmetic Procedures	9,394 24.5%
Dermatology	65,877 24.4%
Gastroenterology	31,023 23.5%
Endoscopy	57,124 23.0%
Physical Therapy/Rehabilitation	290,615 21.9%
Vascular	13,953 21.7%
ENT	38,216 20.3%
Nephrology	9,168 20.1%
Sleep Studies	28,958 19.5%
Oncology Center	150,522 16.9%
Ambulatory Surgery	351,132 16.6%
Psychiatry	153,332 16.4%
Cardiology	100,480 12.2%
Oncology	2,149 11.8%

2026	
10-Year VOLUME	↑
Urology	21,444 53.7%
Pulmonology	37,960 47.7%
Ophthalmology	113,388 49.4%
Neurology	21,269 46.5%
Podiatry	20,697 52.7%
Pain Management	13,586 43.3%
Orthopedics	52,412 39.8%
Cosmetic Procedures	10,352 37.2%
Dermatology	76,840 45.0%
Gastroenterology	35,256 40.4%
Endoscopy	64,170 38.2%
Physical Therapy/Rehabilitation	314,548 31.9%
Vascular	16,336 42.5%
ENT	43,167 35.8%
Nephrology	10,369 35.9%
Sleep Studies	32,172 32.7%
Oncology Center	166,269 29.1%
Ambulatory Surgery	387,914 28.8%
Psychiatry	171,516 30.2%
Cardiology	111,620 24.6%
Oncology	2,324 20.9%

This document has been prepared by Colliers International for advertising and general information only. Colliers International makes no guarantees, representations or warranties of any kind, expressed or implied, regarding the information including, but not limited to, warranties of content, accuracy and reliability. Any interested party should undertake their own inquiries as to the accuracy of the information. Colliers International excludes unequivocally all inferred or implied terms, conditions and warranties arising out of this document and excludes all liability for loss and damages arising there from. This publication is the copyrighted property of Colliers International and/or its licensor(s). ©2018. All rights reserved.

This document has been prepared by Colliers International for advertising and general information only. Colliers International makes no guarantees, representations or warranties of any kind, expressed or implied, regarding the information including, but not limited to, warranties of content, accuracy and reliability. Any interested party should undertake their own inquiries as to the accuracy of the information. Colliers International excludes unequivocally all inferred or implied terms, conditions and warranties arising out of this document and excludes all liability for loss and damages arising there from. This publication is the copyrighted property of Colliers International and/or its licensor(s). ©2018. All rights reserved.

FOUNTAIN VALLEY MEDICAL CENTER
FOR LEASE | 11100 WARNER AVE | FOUNTAIN VALLEY



CLOSE PROXIMITY TO 5 OTHER LOCAL HOSPITALS

Orange Coast Memorial Medical Center
2.2 Mi. or 6 Mins.

Huntington Beach Hospital
3.9 Mi. or 9 Mins.

Garden Grove Hospital
5.8 Mi. or 14 Mins.

Western Medical Center
10.7 Mi. or 15 Mins.

Hoag Hospital
9.4 Mi. or 16 Mins.

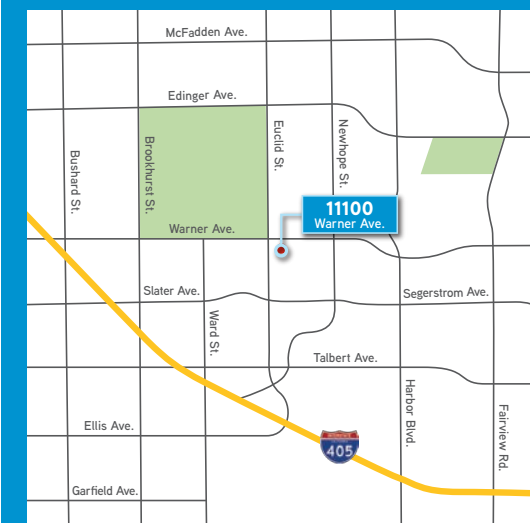

First Floor

EAST

WEST

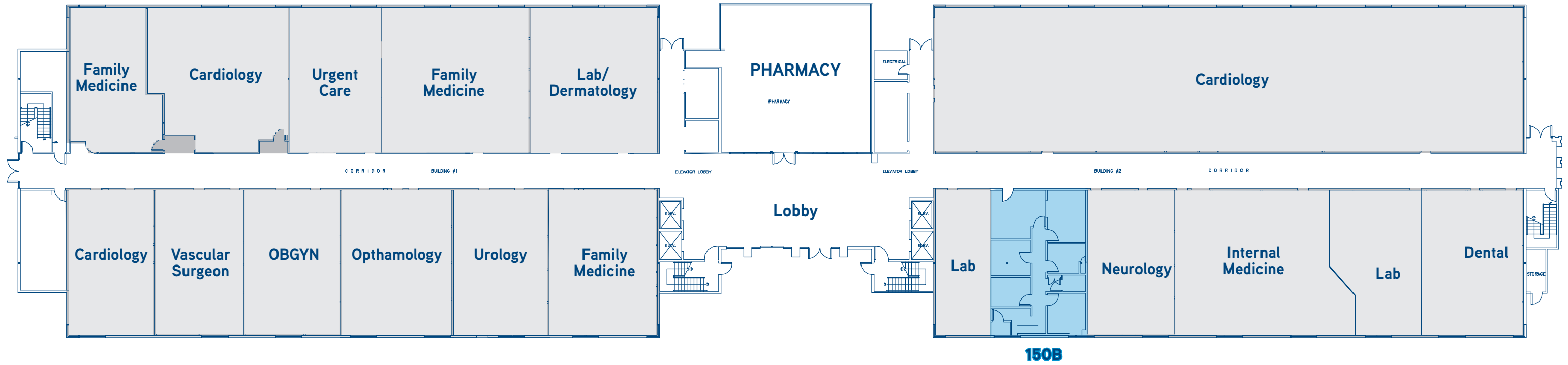

Suite #	Size	Availability
FULLY LEASED		

Suite #	Size	Availability	Former Specialty
150B	1,216 SF	Vacant	OBGYN

Second Floor

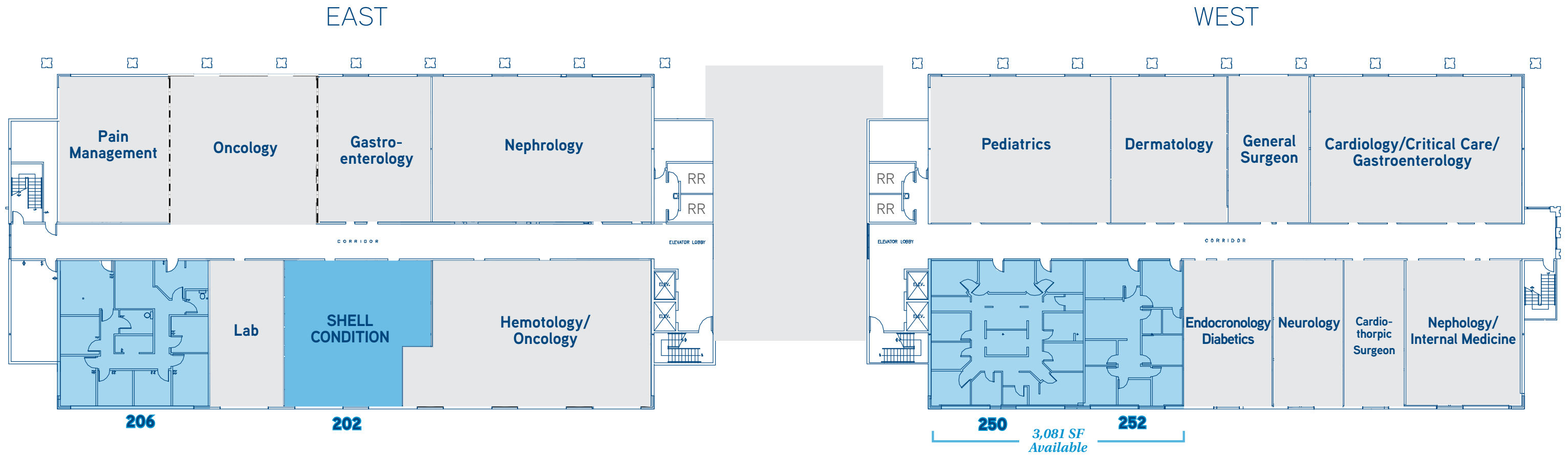

Suite #	Size	Availability
202	1,660 SF	Vacant (Shell Condition)
206	1,822 SF	Vacant
214	1,822 SF	Lease Pending

Suite #	Size	Availability	Former Specialty
250	1,872 SF	Vacant	Rheumatology
252	1,209 SF	Vacant	Pediatrics

Third Floor

EAST

WEST

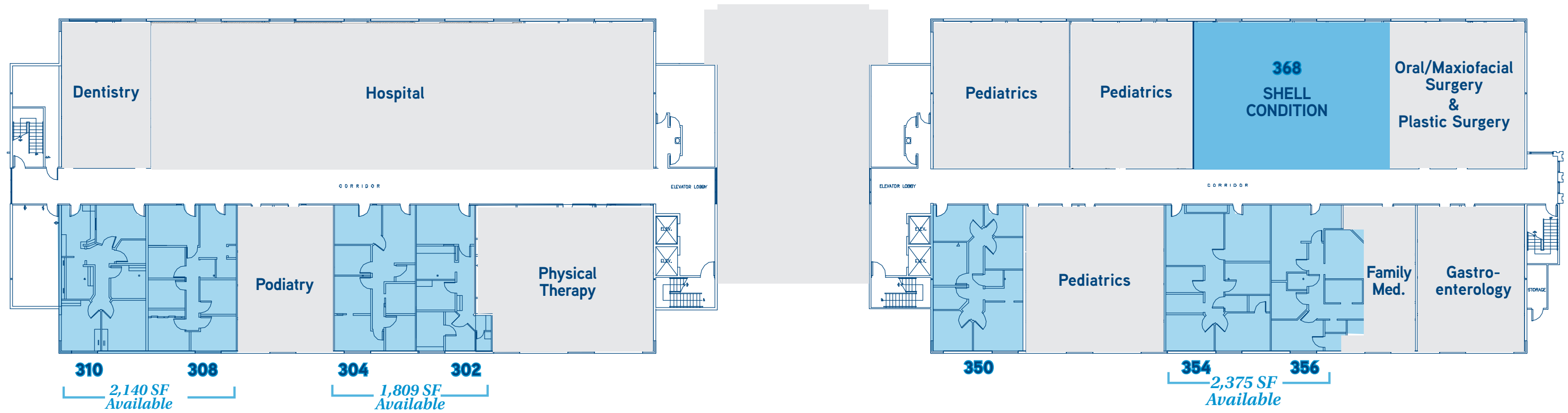

Suite #	Size	Availability	Former Specialty
302	811	Vacant	Internal Medicine
304	998	Vacant	Rheumatology
308	1,095 SF	Vacant	Former ENT
310	1,045 SF	Vacant	Former Cardiology

Suite #	Size	Availability	Former Specialty
350	1,120 SF	Vacant	Cardiology
354	1,257 SF	Vacant	Diabetics
356	1,118 SF	Vacant (New Improvements)	Internal Medicine
368	2,076 SF	Vacant (Shell Condition)	N/A

FOUNTAIN VALLEY MEDICAL CENTER
FOR LEASE | 11100 WARNER AVE | FOUNTAIN VALLEY





Contact us:

John Wadsworth

Senior Vice President
License No. 01177404
949 724 5528
john.wadsworth@colliers.com

Aaron Phillips

First Vice President
License No. 01769480
949 724 5562
aaron.phillips@colliers.com

Colliers International

3 Park Plaza | Suite 1200
Irvine, CA 92614
P: +1 949 724 5500
F: +1 949 724 5600



Accelerating success.

This document has been prepared by Colliers International for advertising and general information only. Colliers International makes no guarantees, representations or warranties of any kind, expressed or implied, regarding the information including, but not limited to, warranties of content, accuracy and reliability. Any interested party should undertake their own inquiries as to the accuracy of the information. Colliers International excludes unequivocally all inferred or implied terms, conditions and warranties arising out of this document and excludes all liability for loss and damages arising there from. This publication is the copyrighted property of Colliers International and/or its licensor(s). ©2017. All rights reserved.