

WHITE CASTLE OFFICE BUILDING

FOR LEASE



MOUNTAIN WEST
COMMERCIAL REAL ESTATE

SHAD WEBB

swebb@mwcre.com
direct 435.459.0212
[View Profile](#)

CODY BLACK

cblack@mwcre.com
direct 385.233.9141
[View Profile](#)

PROPERTY DETAILS

920 EAST STATE STREET, AMERICAN FORK, UT 84003

- Total square feet available: 5,322 SF
- Asking rate: \$16.25/SF/NNN
- NNN: \$2.25/SF
- I-15 access (exit 275/276)
- Ample parking
- Close proximity to amenities and services
- Great State Street signage available
- In the Opportunity Zone for business, a great tax advantage

2025 DEMOS

EST. POPULATION

1 MILE » 19,205
3 MILE » 86,361
5 MILE » 169,382

EST. HOUSEHOLDS

1 MILE » 7,126
3 MILE » 26,536
5 MILE » 49,970

EST. AVERAGE HH INCOME

1 MILE » \$112,119
3 MILE » \$137,535
5 MILE » \$145,606

**FULL SERVICE
COMMERCIAL REAL ESTATE**

2015 West Grove Parkway, Suite J
Pleasant Grove, UT 84062
Office 385.233.9140
www.mwcre.com



MOUNTAIN WEST
COMMERCIAL REAL ESTATE

SHAD WEBB

swebb@mwcre.com
direct 435.459.0212
[View Profile](#)

CODY BLACK

cblack@mwcre.com
direct 385.233.9141
[View Profile](#)

CONCEPTUAL SIGN



**FULL SERVICE
COMMERCIAL REAL ESTATE**

2015 West Grove Parkway, Suite J
Pleasant Grove, UT 84062
Office 385.233.9140
www.mwcre.com

FLOOR PLAN

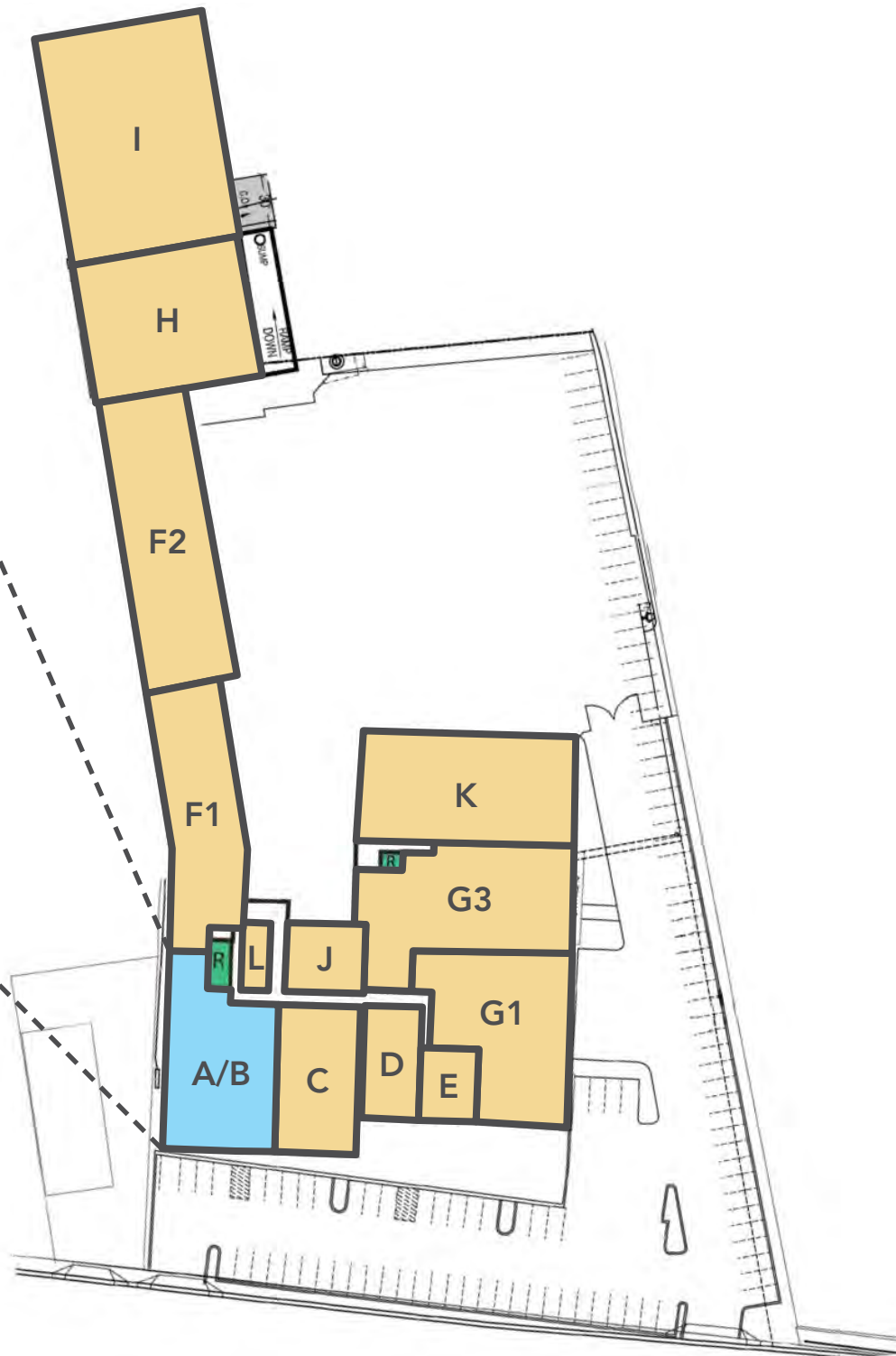
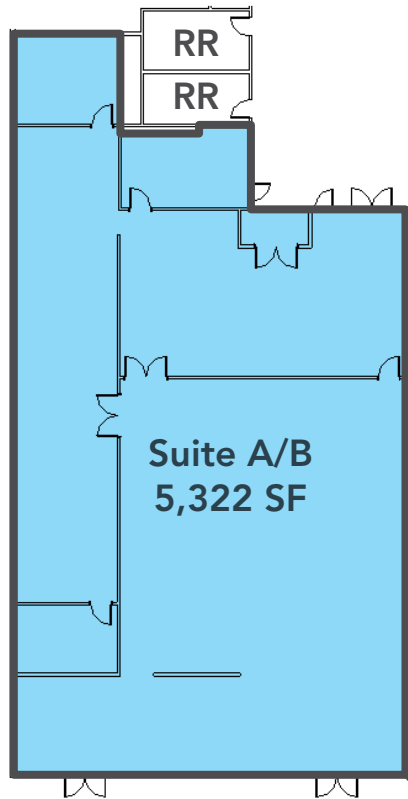

MOUNTAIN WEST
COMMERCIAL REAL ESTATE

SHAD WEBB

swebb@mwcre.com
direct 435.459.0212
[View Profile](#)

CODY BLACK

cblack@mwcre.com
direct 385.233.9141
[View Profile](#)

**FULL SERVICE
COMMERCIAL REAL ESTATE**

2015 West Grove Parkway, Suite J
Pleasant Grove, UT 84062
Office 385.233.9140
www.mwcre.com

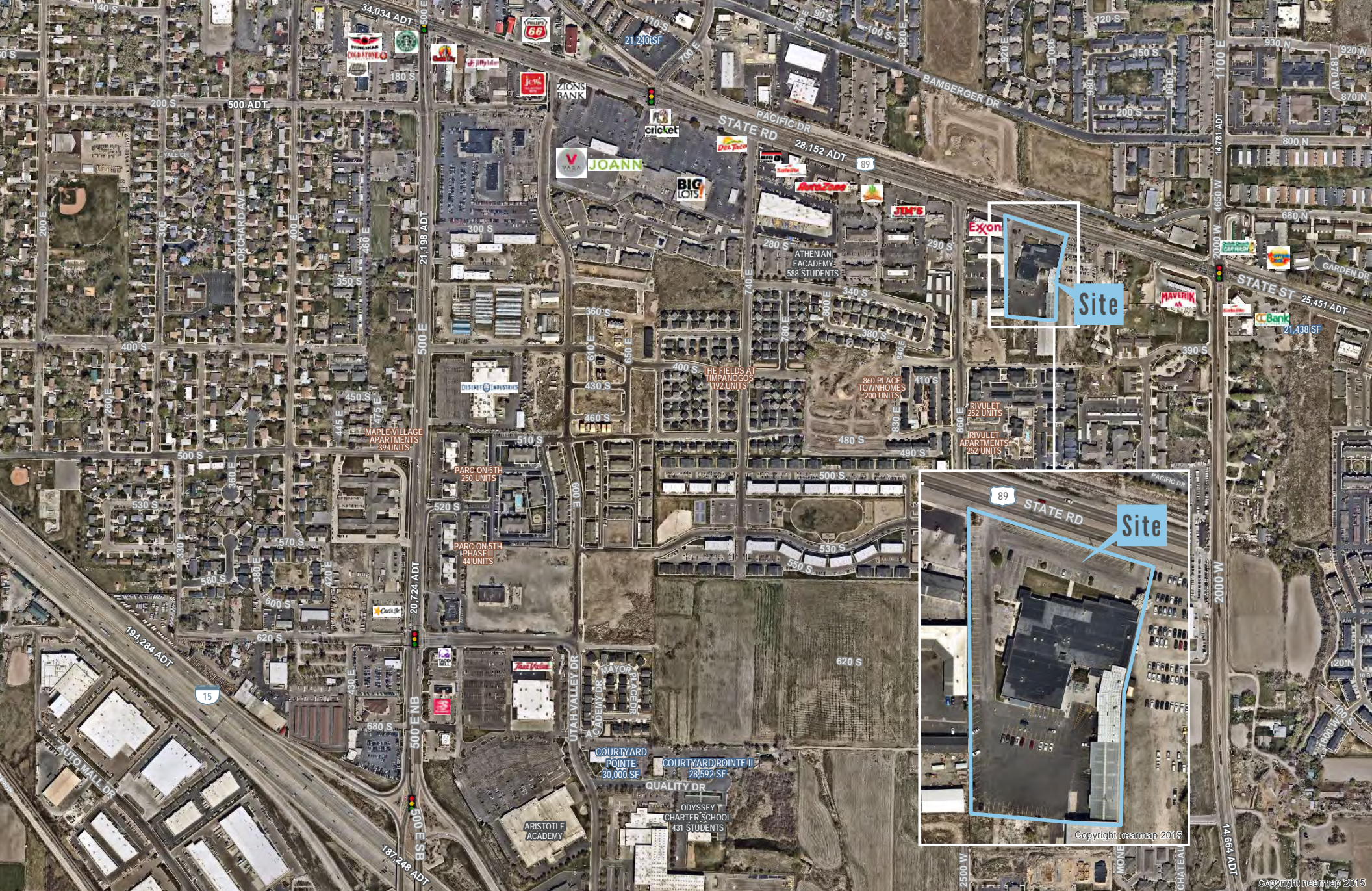

MOUNTAIN WEST
COMMERCIAL REAL ESTATE

SHAD WEBB

swebb@mwcre.com
direct 435.459.0212
[View Profile](#)

CODY BLACK

cblack@mwcre.com
direct 385.233.9141
[View Profile](#)

**FULL SERVICE
COMMERCIAL REAL ESTATE**

2015 West Grove Parkway, Suite J
Pleasant Grove, UT 84062
Office 385.233.9140
www.mwcre.com