

FOR SALE

±6,199 OFFICE BUILDING ON ±0.46 ACRE LOT

27345 ORTEGA HIGHWAY

San Juan Capistrano, CA 92675



PROPERTY HIGHLIGHTS

- ±6,199 Two-Story Office Building on ±0.46 Acre Lot Available
- Built in 2007
- Elevator Served
- Parking Ratio - 3.55/1,000 SF
- Controlled Access & Security System
- Close Proximity to I-5 & CA-74 Freeways

LOCATION MAP

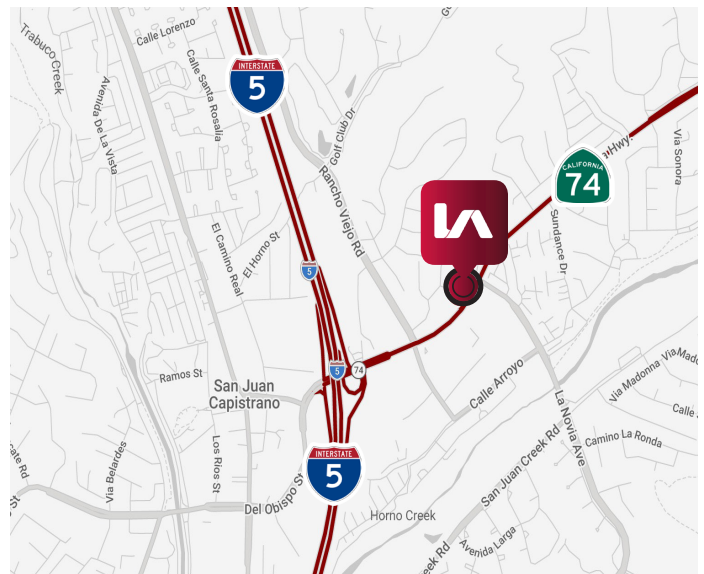

JOHN MARTIN

D 714.307.1250

martin@lee-assoc.com

DRE #01346629

LEE & ASSOCIATES - ONTARIO

3535 Inland Empire Boulevard

Ontario, CA 91764

(909) 989-7771

Corporate ID: 00976995



COMMERCIAL REAL ESTATE SERVICES

FOR SALE

±6,199 OFFICE BUILDING ON ±0.46 ACRE LOT

27345 ORTEGA HIGHWAY

San Juan Capistrano, CA 92675



JOHN MARTIN

D 714.307.1250

jmartin@lee-assoc.com

DRE #01346629

LEE & ASSOCIATES - ONTARIO

3535 Inland Empire Boulevard

Ontario, CA 91764

(909) 989-7771

Corporate ID: 00976995



**LEE &
ASSOCIATES**

COMMERCIAL REAL ESTATE SERVICES

lee-associates.com

All information furnished regarding property for sale, rental or financing is from sources deemed reliable, but no warranty or representation is made to the accuracy thereof and same is submitted to errors, omissions, change of price, rental or other conditions prior to sale, lease or financing or withdrawal without notice. No liability of any kind is to be imposed on the broker herein.

FOR SALE

±6,199 OFFICE BUILDING ON ±0.46 ACRE LOT

27345 ORTEGA HIGHWAY

San Juan Capistrano, CA 92675

FLOOR PLAN

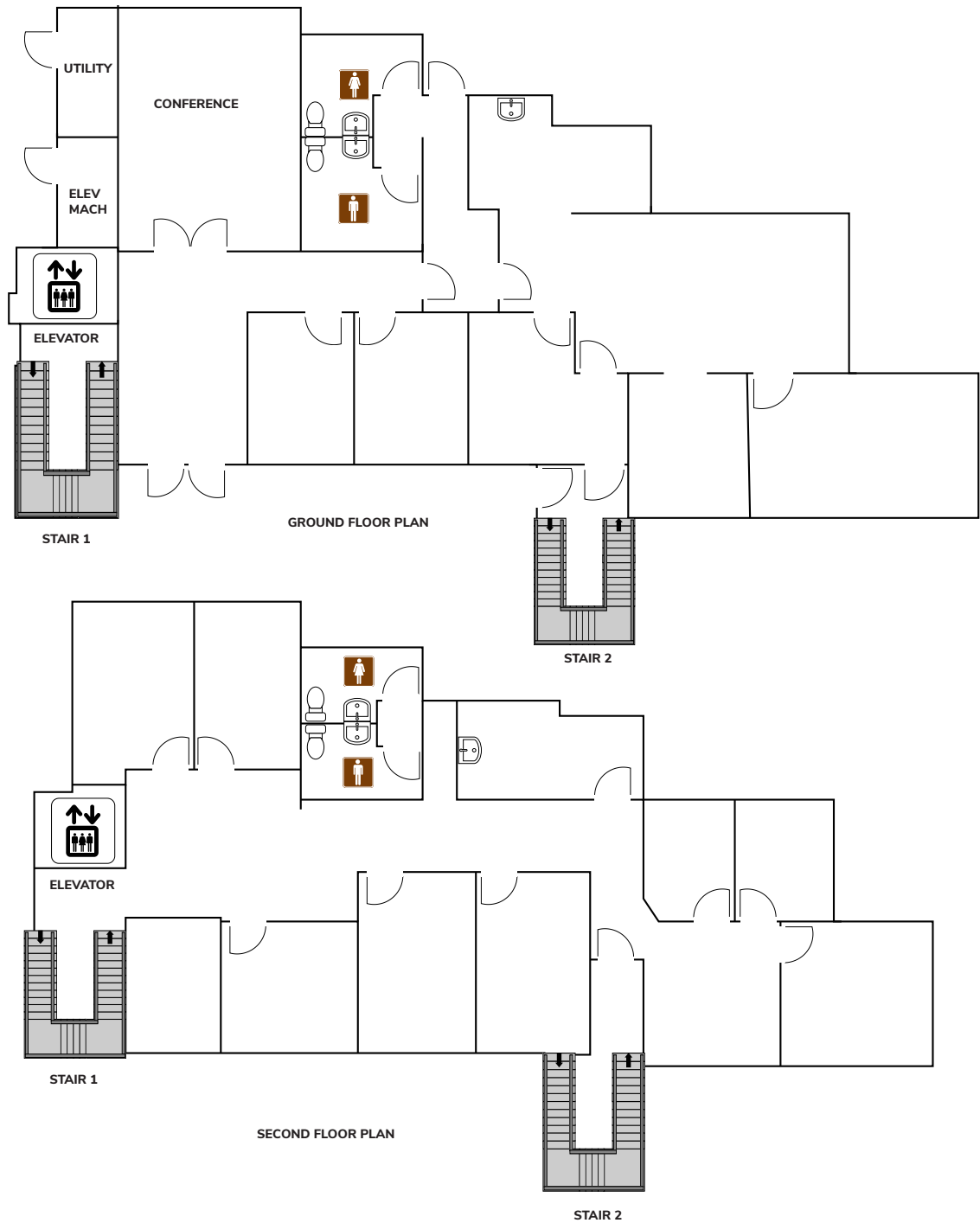

JOHN MARTIN

D 714.307.1250

jmartin@lee-assoc.com

DRE #01346629

LEE & ASSOCIATES - ONTARIO

3535 Inland Empire Boulevard

Ontario, CA 91764

(909) 989-7771

Corporate ID: 00976995



COMMERCIAL REAL ESTATE SERVICES