

FOR SUBLEASE - 37,221 SF
2800 TECHNOLOGY DRIVE - SUITE 100
2800 TECHNOLOGY DRIVE SUITE 100, PLANO, TX 75074



LOCATION DATA

COUNTY: Collin
SUBMARKET: Plano Industrial
SUBMARKET CLUSTER: Northeast Dallas Industrial
YEAR BUILT: 1995

PROJECT DATA

AVAILABLE SF: 37,221 SF
OFFICE SF: 1,627 SF
CLEAR HEIGHT: 28'
LOADING: 7 (9' x 10') Dock doors
1 (9' x 10') Drive in door
COLUMN SPACING: 40'6" x 47'
LIGHTING: TS Lighting
SPRINKLER SYSTEM: ESFR
PARKING: 62 car parks

SUBLEASE EXPIRES: September 30th, 2022

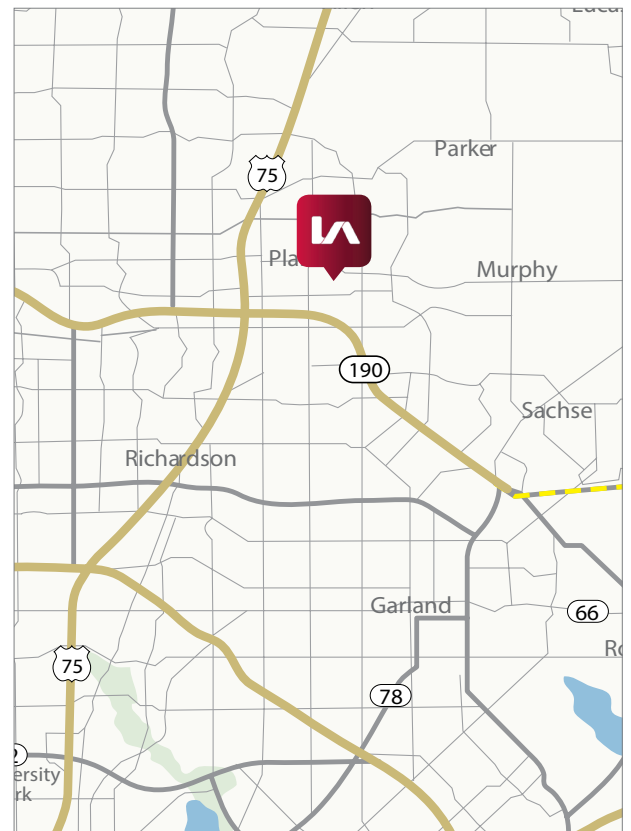

Nathan Denton, SIOR, Principal
ndenton@lee-associates.com
D: (972) 934-4015
C: (214) 228-0611

Stephen Williamson, Director
swilliamson@lee-associates.com
D: (972) 934-4045
C: (817) 705-5470

Matthew Johnson, Associate
mjohnson@lee-associates.com
D: (972) 934-4024
C: (214) 686-1254

All information furnished regarding property for sale, rental or financing is from sources deemed reliable, but no warranty or representation is made to the accuracy thereof and same is submitted to errors, omissions, change of price, rental or other conditions prior to sale, lease or financing or withdrawal without notice. No liability of any kind is to be imposed on the broker herein.

FOR SUBLEASE - 37,221 SF
2800 TECHNOLOGY DRIVE - SUITE 100
 2800 TECHNOLOGY DRIVE SUITE 100, PLANO, TX 75074

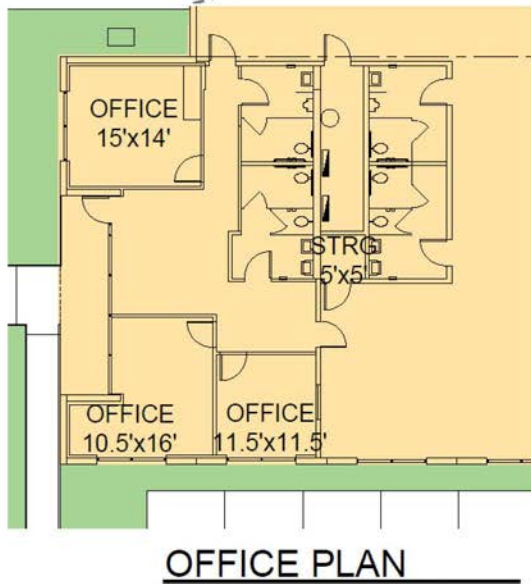
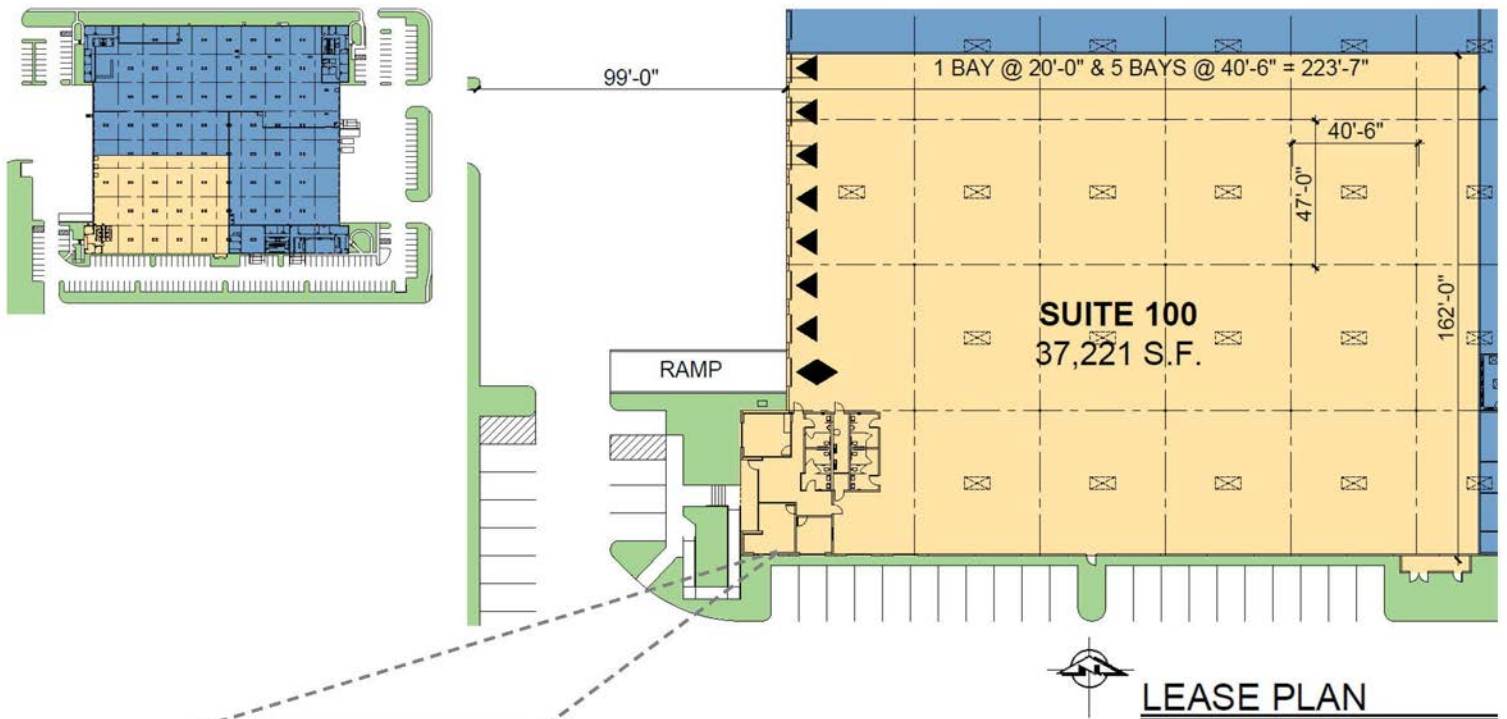

LEGEND:

- = AVAILABLE AREA
- = LEASED AREA
- = BACKGROUND LAND

Nathan Denton, SIOR, Principal
ndenton@lee-associates.com
 D: (972) 934-4015
 C: (214) 228-0611

Stephen Williamson, Director
swilliamson@lee-associates.com
 D: (972) 934-4045
 C: (817) 705-5470

Matthew Johnson, Associate
mjohnson@lee-associates.com
 D: (972) 934-4024
 C: (214) 686-1254

All information furnished regarding property for sale, rental or financing is from sources deemed reliable, but no warranty or representation is made to the accuracy thereof and same is submitted to errors, omissions, change of price, rental or other conditions prior to sale, lease or financing or withdrawal without notice. No liability of any kind is to be imposed on the broker herein.