



.... WET LABS, ROBOTICS LABS,
TECH SPACE AND OFFICES

Coming Spring 2024

The hottest labs and cool office space

Various Lab spaces available at a variety
of sizes and configurations with adjoining
Offices; Suite size and layouts upon inquiry

- > Class "A" Building
- > California Industrial aesthetic
- > Central Atrium with Collaboration Space
- > Off Street Parking
- > 24/7 Security

SOUTH SIDE EAST AT HOT METAL BRIDGE
2516 JANE STREET

LABORATORY INFRASTRUCTURE & AMENITIES

**New high-quality Bio- Safety Level 2
Wet Labs with various layouts and short
or long term leases. Flexible space
and sizing for Start-ups, Grant Related Research,
Pharma, CRO's and Life Sciences**

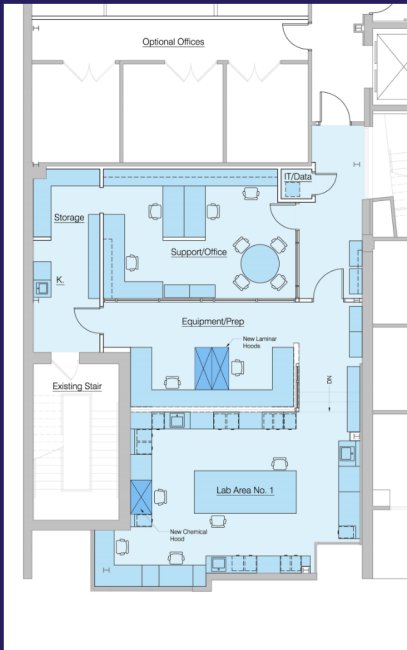

- >Mobile & Fixed Casework Bench
- >Emergency Power
- >Humidity Control
- >Bio Safety Level 2
- >Chem Exhaust and/or Laminar Hoods
- >Specialty HVAC

