

WAYLAND SQUARE

195 – 201 Wayland Avenue
Providence, Rhode Island



Space Available
2,200 RSF
2nd Floor



Space Available
2,168 RSF
2nd Floor

LOCATION: Ideally located in Providence's historic east side, Wayland Square posts one of the strongest demographics for population and income within the State. Not included in the demographics is the affluent student population from nearby Brown University.

TOTAL GLA: 25,000 square feet.

SPACE AVAILABLE: 2,168rsf and 2,200rsf located on the 2nd Floor

TENANTS: lululemon, Green Ink, Fat Face, Pasta Beach, Barre and Soul, Madrid European Bakery and The Laundry Club

AREA TENANTS: Starbucks, CVS, West Elm, European Wax Center Red Stripe, J McLaughlin, Salted Slate, Wendy Brown Home, Haruki, McBride's Pub, Books on the Square and many more

DEMOGRAPHICS

TOTAL POPULATION:	1 Mile 30,000
AVG. HOUSE HOLD INCOME:	\$103,137
PER CAPITA INCOME:	\$40,000
HH EARNING MORE THAN \$150,000:	16%
AVERAGE NET WORTH:	\$575,000
HOLD GRADUATE DEGREE:	35%
AVERAGE HH EXPENDITURE:	\$70,800

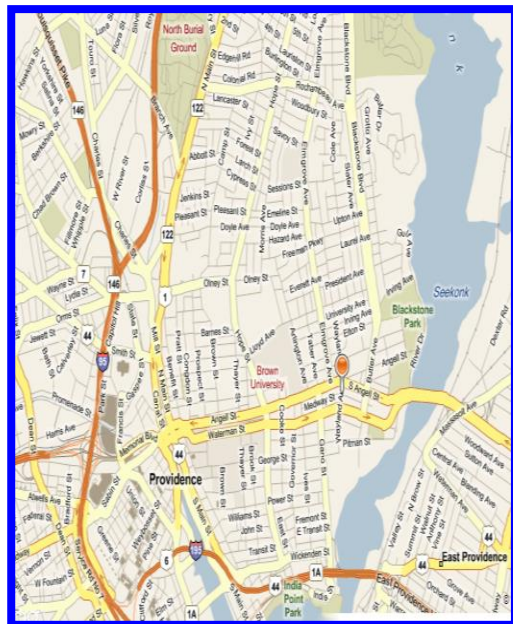

RENT: \$19.50-\$20.00/RSF Modified Gross plus utilities

FOR MORE INFORMATION CONTACT:

Joseph Mardo

THE DISCOVERY GROUP, INC.

UNLOCKING OPPORTUNITIES
ONE INVESTMENT AT A TIME

jmardo@TheDiscoveryGroupInc.com
101 Plain Street, 1st Floor Suite 100, Providence, Rhode Island 02903
(401)729-8000 phone ~ (401)729-4300 fax ~ www.TheDiscoveryGroupInc.com

WAYLAND SQUARE

195 – 201 Wayland Avenue
Providence, Rhode Island

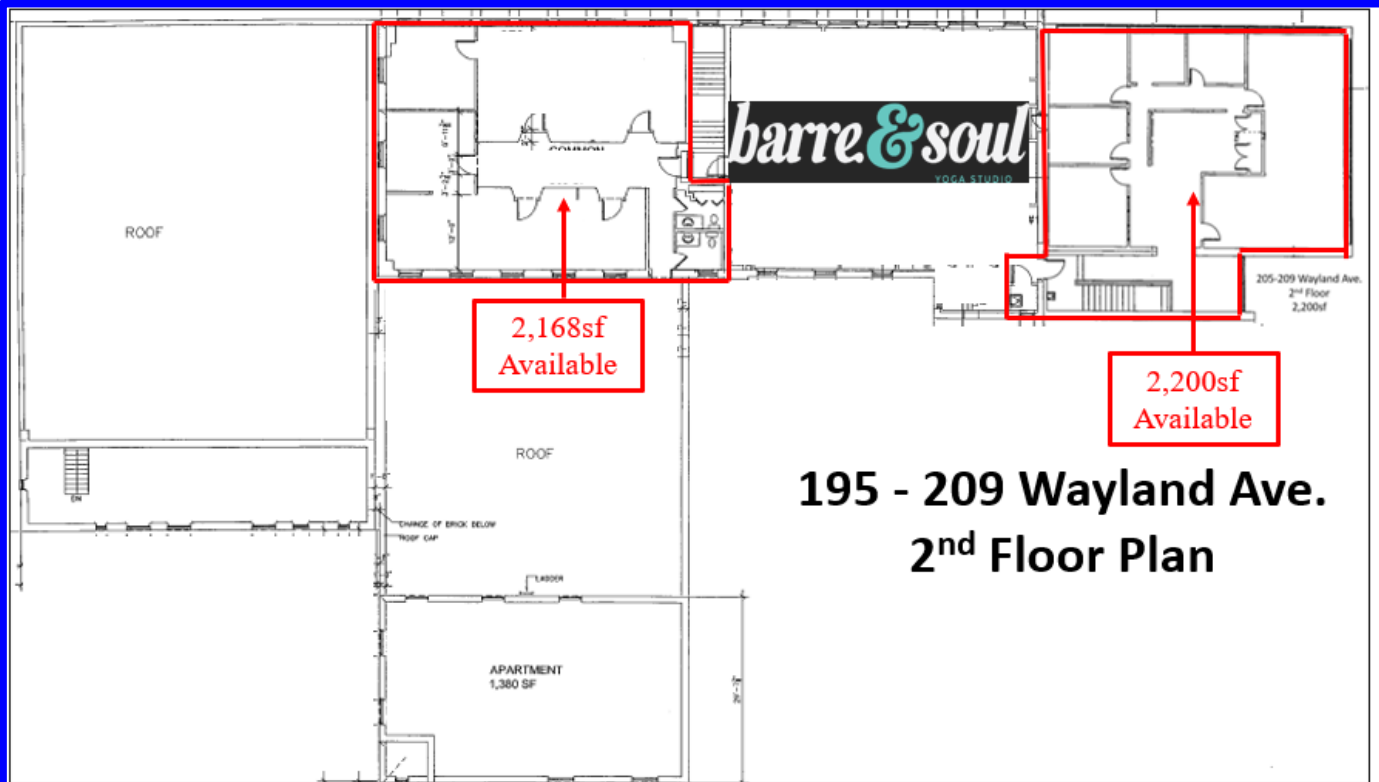

The information contained herein is for informational purposes only and no representations, warranties and/or guarantees are being made as to the current or future conditions of the above property. Current conditions must be independently confirmed. All information is subject to change and verification and no liability for errors or omissions is assumed.

