

FOR LEASE INTERNATIONAL TRADEPORT

BUILDING VII | 13910 ALVAREZ RD | JACKSONVILLE, FL 32218



± 18,000 - ± 27,000 SF AVAILABLE

Located in the International Tradeport of Jacksonville is a premier 425-acre master-planned industrial park strategically located at the nexus of I-95 and I-295, adjacent to Jacksonville International Airport. This prime location offers seamless access to major transportation routes and proximity to JAXPORT's marine terminals, including Blount Island and Dames Point, facilitating efficient global distribution. The area provides flexible solutions for warehousing, logistics, and manufacturing needs. Enhanced by nearby amenities like the River City Marketplace, hotels, and restaurants, the International Tradeport of Jacksonville stands out as a dynamic hub for businesses seeking connectivity, convenience, and a thriving commercial environment.



FOR MORE INFO:
WWW.GIDTRADEPORT.COM

GID
INDUSTRIAL

CUSHMAN &
WAKEFIELD

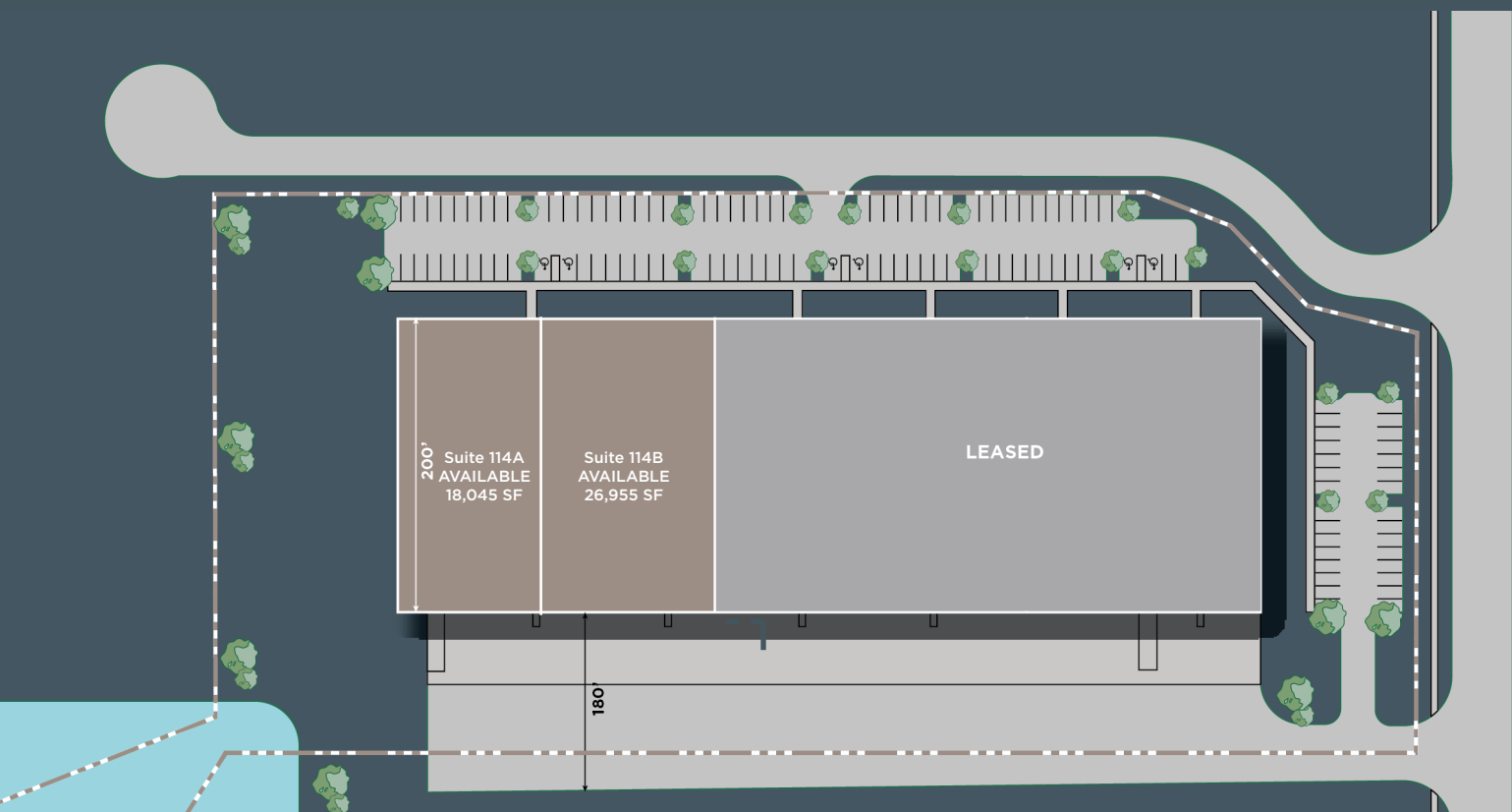

PROPERTY HIGHLIGHTS

| | AVAILABLE SPACE | OFFICE | DOORS | CLEAR HEIGHT | |
|--|-----------------|---|---------------------|--------------|---------------|
| Suite 114 A | ± 18,045 SF | ± 851 SF | 4 Dock / 1 Drive-in | 25' | Available Now |
| Suite 114 B | ± 26,955 SF | ± 1,382 SF (plus ± 4,668 SF Production Area) | 9 Dock | 25' | Available Now |
| <div><div><ul style="list-style-type: none">• ESFR Fire Protection• PUD Zoning</div><div><ul style="list-style-type: none">• Tilt Wall Construction• 225 Amp; 480/277v Power</div><div><ul style="list-style-type: none">• 45'x50' Columns• Rear Load</div></div> | | | | | |

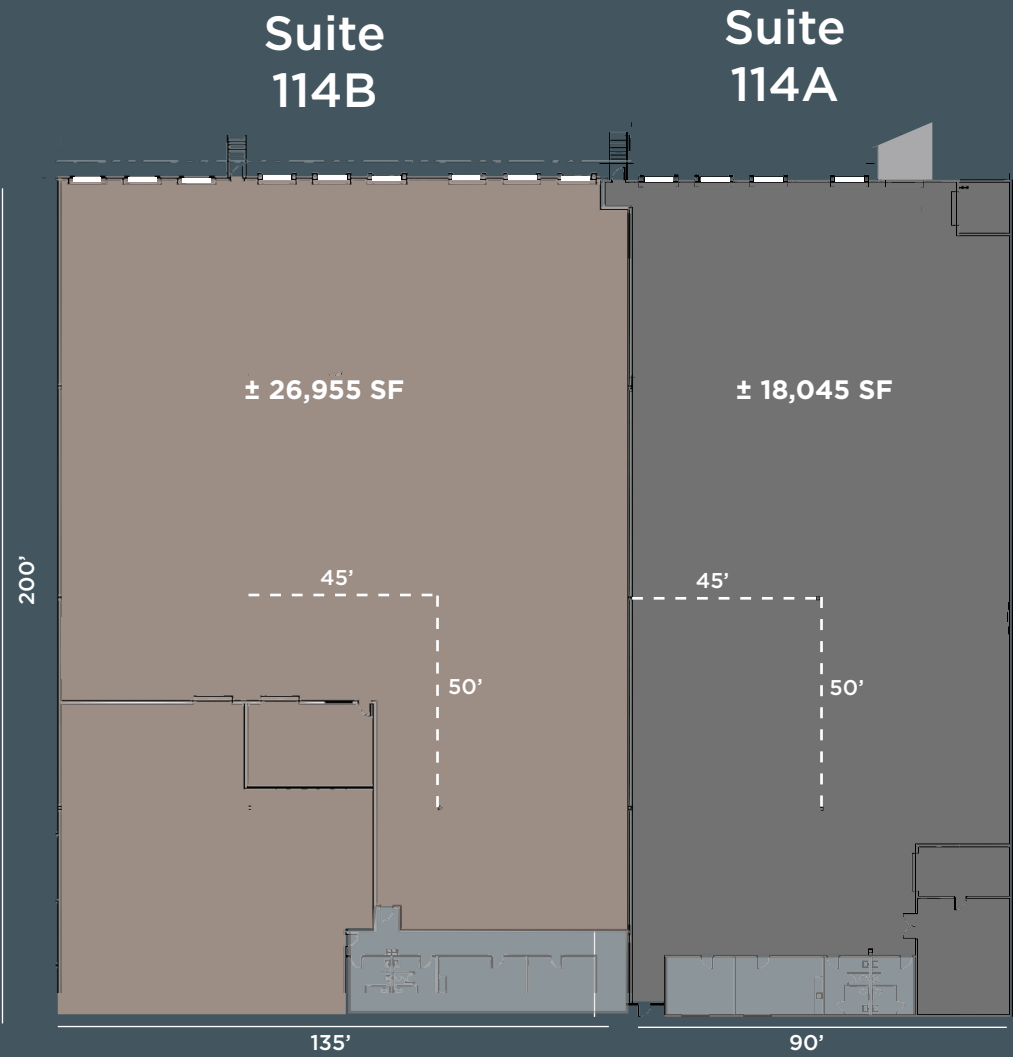

SUITE 114B
Office - 1,382 SF

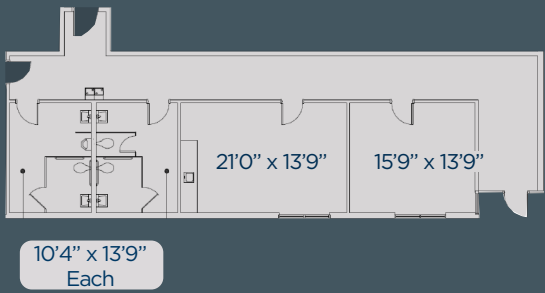

SUITE 114A
Office - 851 SF



FOR LEASE INTERNATIONAL TRADEPORT

BUILDING VII | 13910 ALVAREZ RD | JACKSONVILLE, FL 32218



FOR MORE INFO:
WWW.GIDTRADEPORT.COM



FOR MORE INFORMATION, PLEASE CONTACT:

TYLER NEWMAN

Executive Managing Director

904 380 8336

tyler.newman@cushwake.com

JACOB HORSLEY

Executive Managing Director

904 380 8335

jacob.horsley@cushwake.com



©2025 Cushman & Wakefield. All rights reserved. The information contained in this communication is confidential, may be privileged and is intended for the exclusive use of the above named addressee(s). If you are not the intended recipient(s), you are expressly prohibited from copying, distributing, disseminating, or in any other way using any information contained within this communication. This information has been obtained from sources believed to be reliable but has not been verified. NO WARRANTY OR REPRESENTATION, EXPRESS OR IMPLIED, IS MADE AS TO THE CONDITION OF THE PROPERTY (OR PROPERTIES) REFERENCED HEREIN OR AS TO THE ACCURACY OR COMPLETENESS OF THE INFORMATION CONTAINED HEREIN, AND SAME IS SUBMITTED SUBJECT TO ERRORS, OMISSIONS, CHANGE OF PRICE, RENTAL OR OTHER CONDITIONS, WITHDRAWAL WITHOUT NOTICE, AND TO ANY SPECIAL LISTING CONDITIONS IMPOSED BY THE PROPERTY OWNER(S). ANY PROJECTIONS, OPINIONS OR ESTIMATES ARE SUBJECT TO UNCERTAINTY AND DO NOT SIGNIFY CURRENT OR FUTURE PROPERTY PERFORMANCE. This e-mail may be considered advertising under federal law.