

AVAILABLE FOR LEASE

20595 East Business Parkway, City of Industry, CA



BUILDING FEATURES

- Shipping **Office**: 1,000 SF
- Clearance: 26' @ 1st Column
- Sprinklers: .60 GPM/3,000 SF
- Loading:
10 Dock High
1 Ramp
- Power: 2-1,600 Amps, 277/480 Volt, 3 Ph
- **UPRR Active - 2 Spots**
- **Parking**: 150 Cars
- Lightng: T-5 Lighting w/ Motion Sensors
- Bay Spacing: 40' x 18'

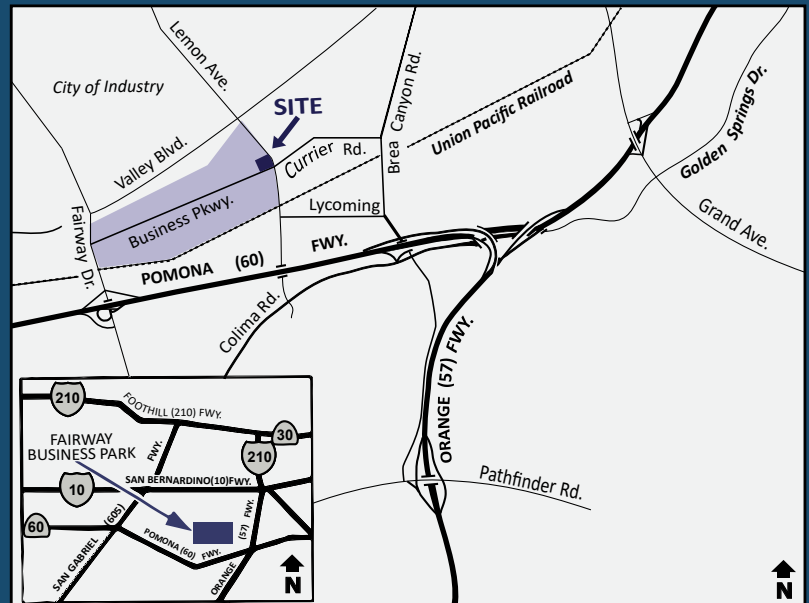

For more information, please contact:

TERRY BAKER
R.E. License #00711593 (CA)
Tel (562) 948-4341
tbaker@majesticrealty.com

KENT VALLEY
R.E. License #00324853 (CA)
Tel (562) 948-4343
kvalley@majesticrealty.com

AVAILABLE FOR LEASE

20595 East Business Parkway, City of Industry, CA

SITE PLAN

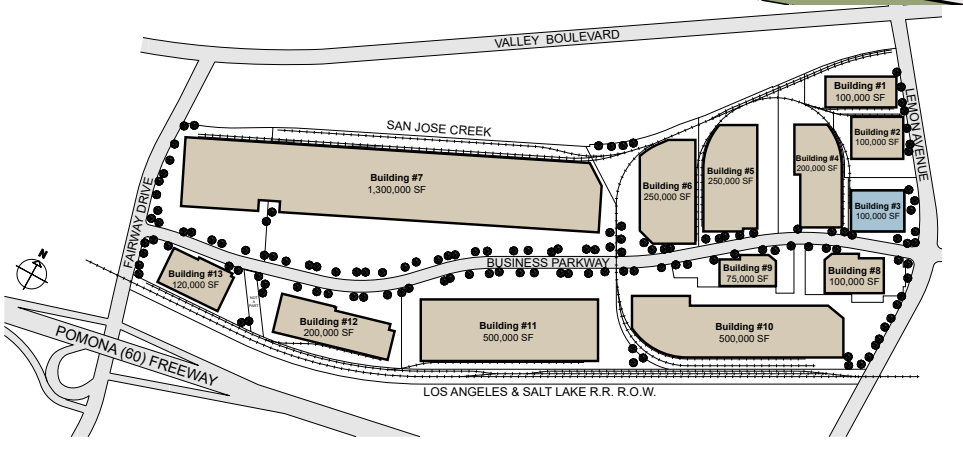
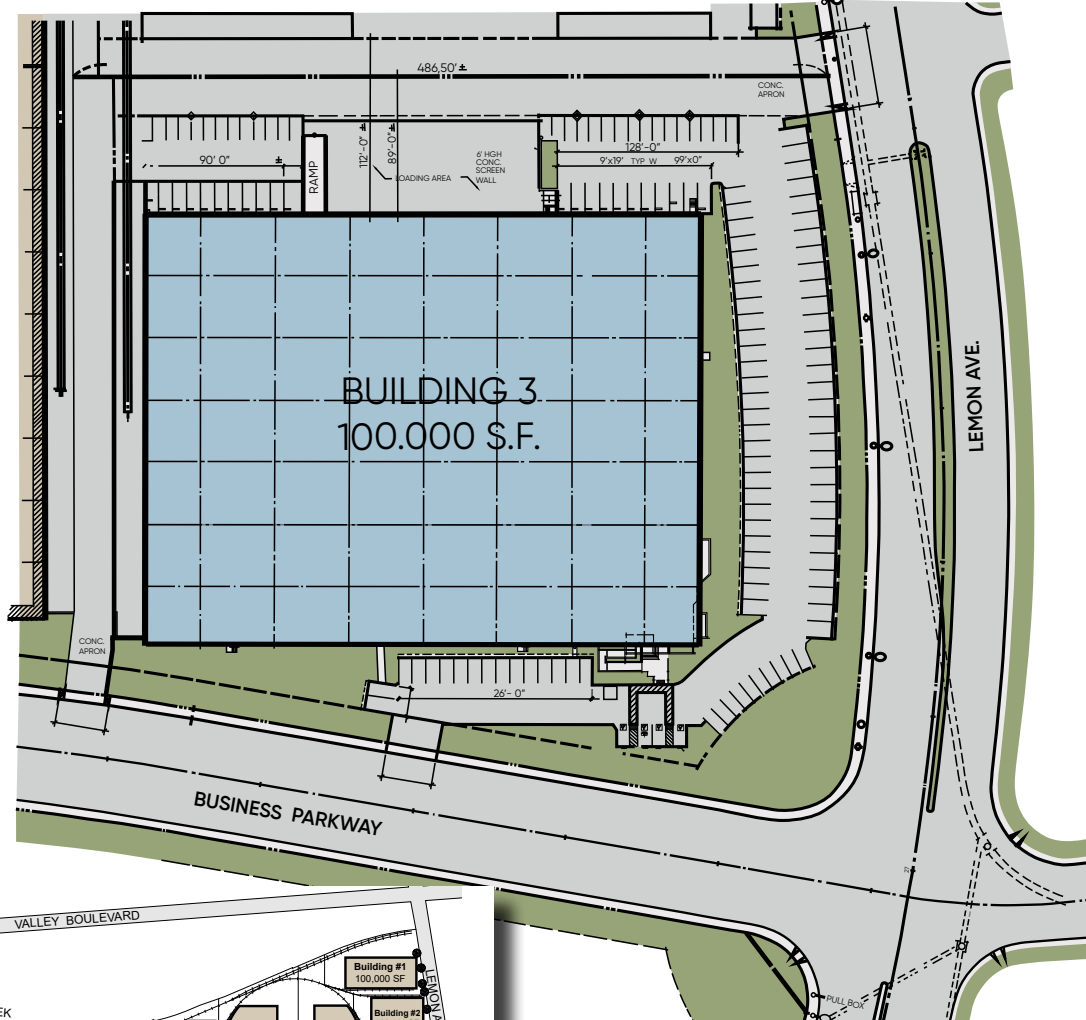

For more information, please contact:

TERRY BAKER
R.E. License #00711593 (CA)
Tel (562) 948-4341
tbaker@majesticrealty.com

KENT VALLEY
R.E. License #00324853 (CA)
Tel (562) 948-4343
kvalley@majesticrealty.com