

TAMIAMI TRAIL - U.S. 41 NORTHBOUND (FDOT)

TAMIAMI TRAIL - U.S. 41 SOUTHBOUND (FDOT)

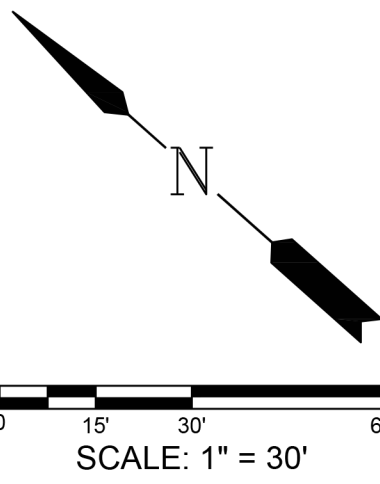

EX. 6' SIDEWALK

200' R.O.W.

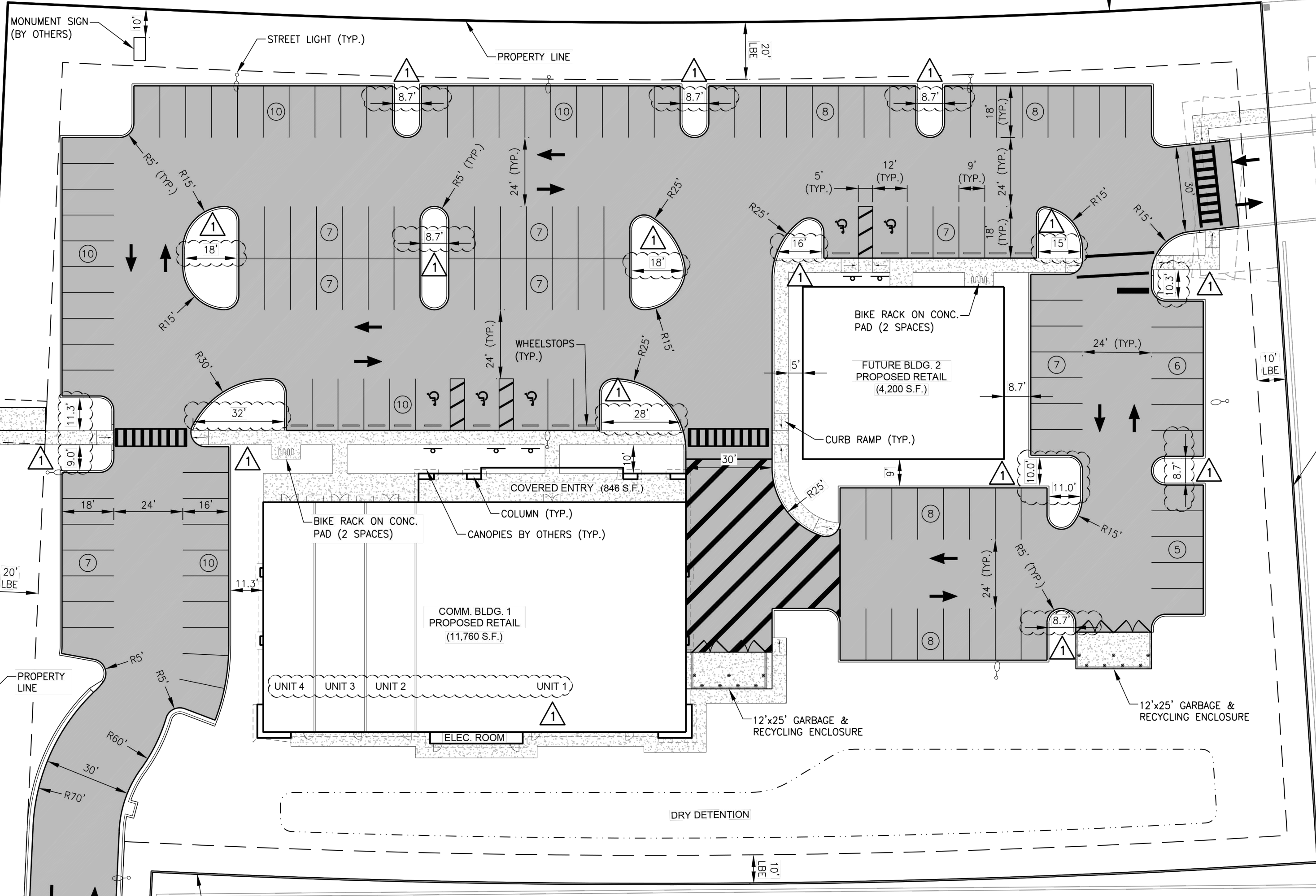

ZONED: PUD
USE: PROPOSED
MULTI-FAMILY
DEVELOPMENT UNDER
SEPARATE SDP

ZONED: PUD
USE: PROPOSED MULTI-FAMILY
DEVELOPMENT UNDER SEPARATE SDP

EX. GAS
STATION
DRIVEWAY

EX. 6' SIDEWALK

SOUTHWEST BOULEVARD (PUBLIC)

100' R.O.W.

MONUMENT SIGN
(BY OTHERS)

STREET LIGHT (TYP.)

PROPERTY LINE

PROPERTY LINE

PROPERTY LINE

MONUMENT SIGN
(BY OTHERS)

PROPERTY LINE

RELOCATED LIGHT
POLE & ELEC. BOX